

F.A. RTE.	SECTION	COUNTY	TOTAL SHEETS	SHEET NO.
619	TO RS-5 & I	LASALLE	214	176
STA. 910+75.00		TO STA. 911+18.92		
FED. ROAD DIST. NO.	ILLINOIS	FED. AID PROJECT		

FINAL SURVEY	DATE
SURVEYED	
PLOTTED	
NOTE BOOK	
AREAS CHECKED	
NO.	

ORIGINAL SURVEY	DATE
SURVEYED	
PLOTTED	
NOTE BOOK	
AREAS CHECKED	
NO.	

PLOT DATE = Aug 23, 2018 - 04:04:51 PM  
 FILE NAME = c:\pwork\pudat\bergtanunp\img\910+75.00.dwg  
 SCALE = 1/8" = 1' IN.  
 USER NAME = bergtanunp

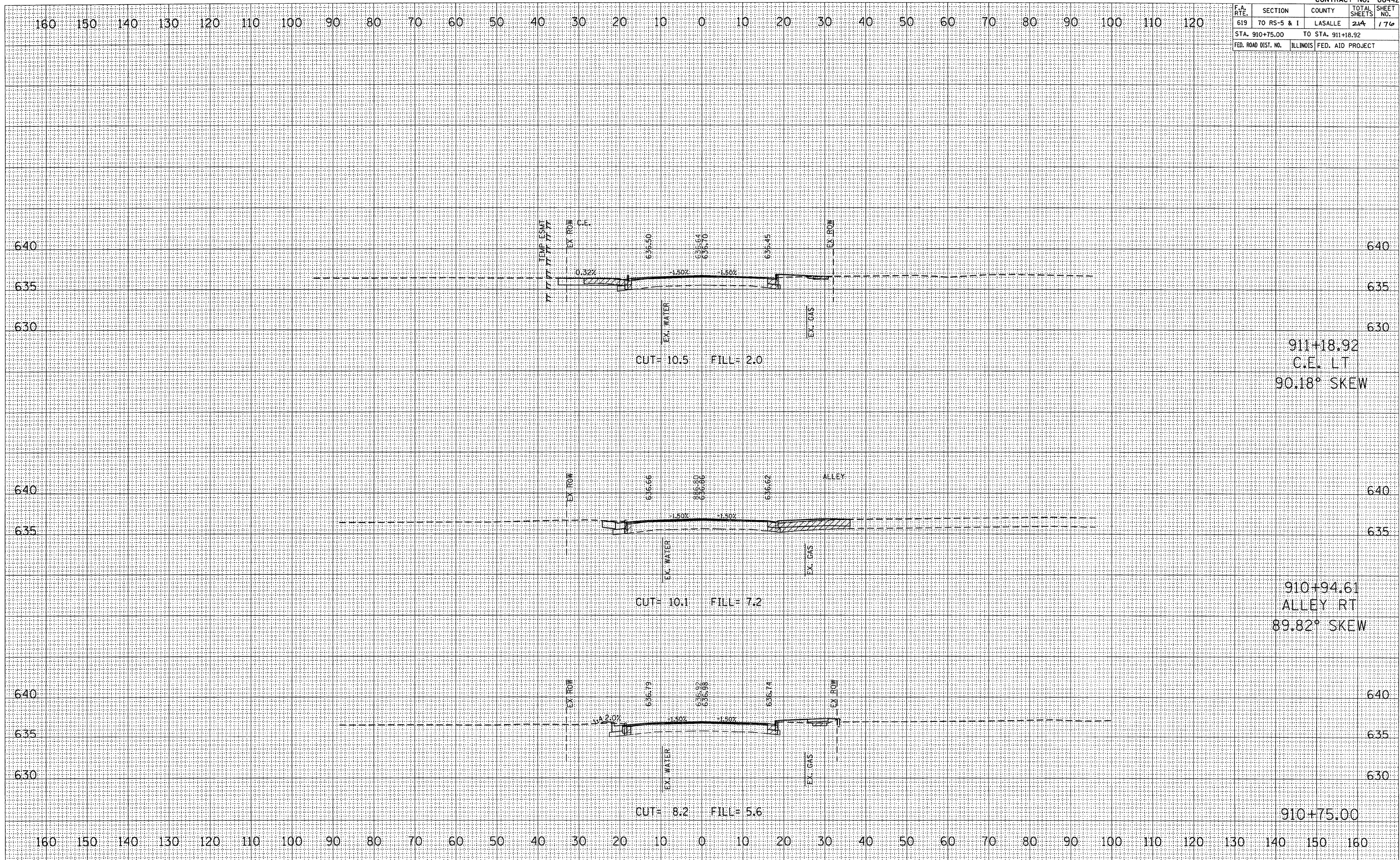

CROSS SECTION, STA 910+75.00 TO 911+18.92, FAP ROUTE 619 (IL 71)