

F.A. RTE.	SECTION	COUNTY	TOTAL SHEETS	SHEET NO.
619	TO RS-5 & 1	LASALLE	214	203
STA. 8+27.90		TO STA. 9+00.00		
FED. ROAD DIST. NO.		ILLINOIS FED. AID PROJECT		

FINAL SURVEY	BY	DATE
SURVEYED		
PLOTTED		
NOTE BOOK		
AREAS CHECKED		

ORIGINAL SURVEY	BY	DATE
SURVEYED		
PLOTTED		
AREAS CHECKED		

PLOT DATE = Sep 13, 2010 12:51:52 PM
 FILE NAME = C:\p001\brabbou\brabbou\brabbou.dwg
 PLOT SCALE = 10.0000 / 1" = 100.0000'
 USER NAME = brabbou

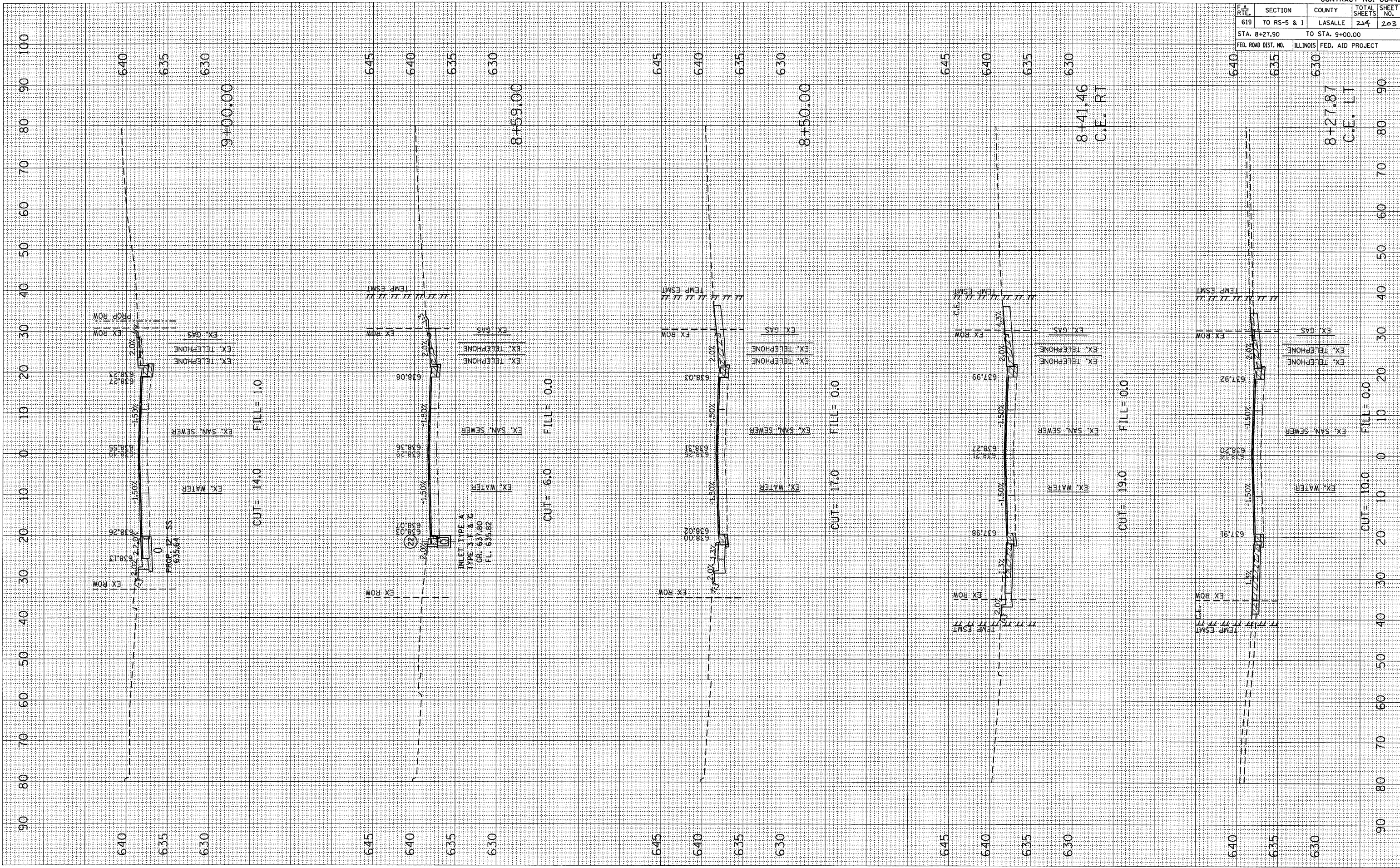

CROSS SECTIONS, STA 8+27.90 TO STA 9+00.00, W. WALNUT ST.