

DRAINAGE STRUCTURE IMPROVEMENT DETAIL LOCATION #18 STA. 1003 + 05

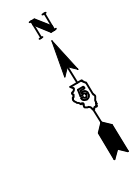

LOC. #18 STA. 1003+05		
ITEM# AND DESCRIPTION	UNIT	QUANTITY
25000210 Seeding, Class 2A	ACRE	0.005
25000400 Nitrogen Fert. Nutr.	POUND	0.45
25000500 Phosphorous Fert. Nutr.	POUND	0.45
25000600 Potassium Fert. Nutr.	POUND	0.45
25100115 Mulch Method 2	ACRE	0.005
28000250 Temp. Eros. Contr. Seeding	POUND	0.5
28000305 Ditch Check Temporary	FOOT	10
28000500 Inlet and Pipe Protection	EACH	1
54002010 Expansion Bolts 1/2	EACH	4
54248510 Concrete Collar	CU YD	0.13
X2010350 Tree Removal Acres, Special	ACRE	0.023

NOTE:

THE EXISTING STRUCTURE AT STATION 1003+05 IS A 4'x4' R.C. BOX CULVERT THAT IS IN GOOD CONDITION. THERE IS ALSO A 4'x4' R.C. BOX CULVERT IMMEDIATELY DOWNSTREAM THAT CARRIES THE FRONTAGE ROAD. THERE ARE TREES RESTRICTING FLOW AT BOTH ENDS OF THE FRONTAGE ROAD CULVERT. THE MAINLINE STRUCTURE HAS AN OFFSET MEDIAN INLET THAT IS CONNECTED TO THE BOX WITH A 15" R.C.C.P. THE 15" PIPE HAS SEPARATED FROM THE INLET BOX AND IS CAUSING A SINKHOLE IN THE MEDIAN.

THE PROPOSED SCOPE OF WORK IS TO EXCAVATE TO AND SEAL THE SEPARATED JOINT WITH A CONCRETE COLLAR. THE COST OF THE EXCAVATION REQUIRED TO PERFORM THIS WORK WILL BE INCLUDED IN THE VARIOUS PAY ITEMS AND NO ADDITIONAL COMPENSATION WILL BE ALLOWED. ALSO, THE TREES AT EACH END OF THE FRONTAGE ROAD STRUCTURE SHALL BE REMOVED TO ALLOW FOR IMPROVED FLOW TO AND AWAY FROM THAT STRUCTURE.

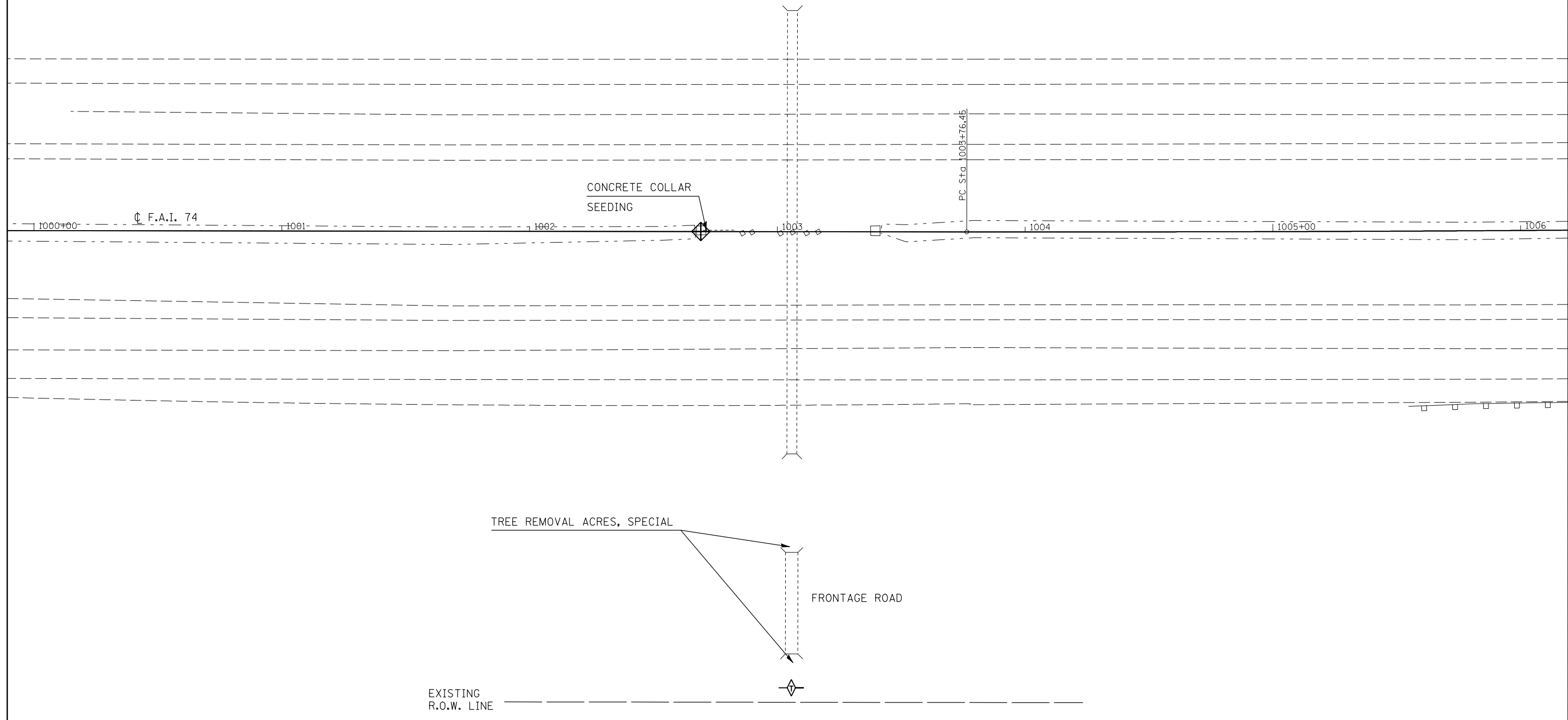

FILE NAME =	USER NAME = hoganbj	DESIGNED - BJM	REVISED -	STATE OF ILLINOIS DEPARTMENT OF TRANSPORTATION	DRAINAGE STRUCTURE IMPROVEMENT DETAIL LOCATION #18 STA. 1003 + 05	F.A.I. RTE. =	SECTION	COUNTY	TOTAL SHEETS	SHEET NO.	
		DRAWN -	REVISED -			74	(57-20(1),21,22)RS-3	McLean	150	68	
	PLOT SCALE = 40.0000' / IN.	CHECKED -	REVISED -			SCALE: 1" = 20'		SHEET NO. OF SHEETS STA. TO STA.		CONTRACT NO. 70550	
	PLOT DATE = 10/21/2010	DATE - 09/23/10	REVISED -			ILLINOIS FED. AID PROJECT					