

DRAINAGE STRUCTURE IMPROVEMENT DETAIL

LOCATION #21 STA. 18+00

WESTBOUND ON RAMP (RAMP AC)



LOC. #21 STA. 18+00 WB ON-RAMP "AC"		
ITEM # AND DESCRIPTION	UNIT	QUANTITY
21400100 Grading and Shaping Ditches	FOOT	305
25000210 Seeding, Class 2A	ACRE	0.133
25000400 Nitrogen Fert. Nutr.	POUND	11.97
25000500 Phosphorous Fert. Nutr.	POUND	11.97
25000600 Potassium Fert. Nutr.	POUND	11.97
25100115 Mulch Method 2	ACRE	0.133
28000250 Temp. Eros. Contr. Seeding	POUND	13.3
28000305 Ditch Check Temporary	FOOT	15
28000500 Inlet and Pipe Protection	EACH	2
Z0005305 Box Culverts To Be Cleaned	FOOT	30

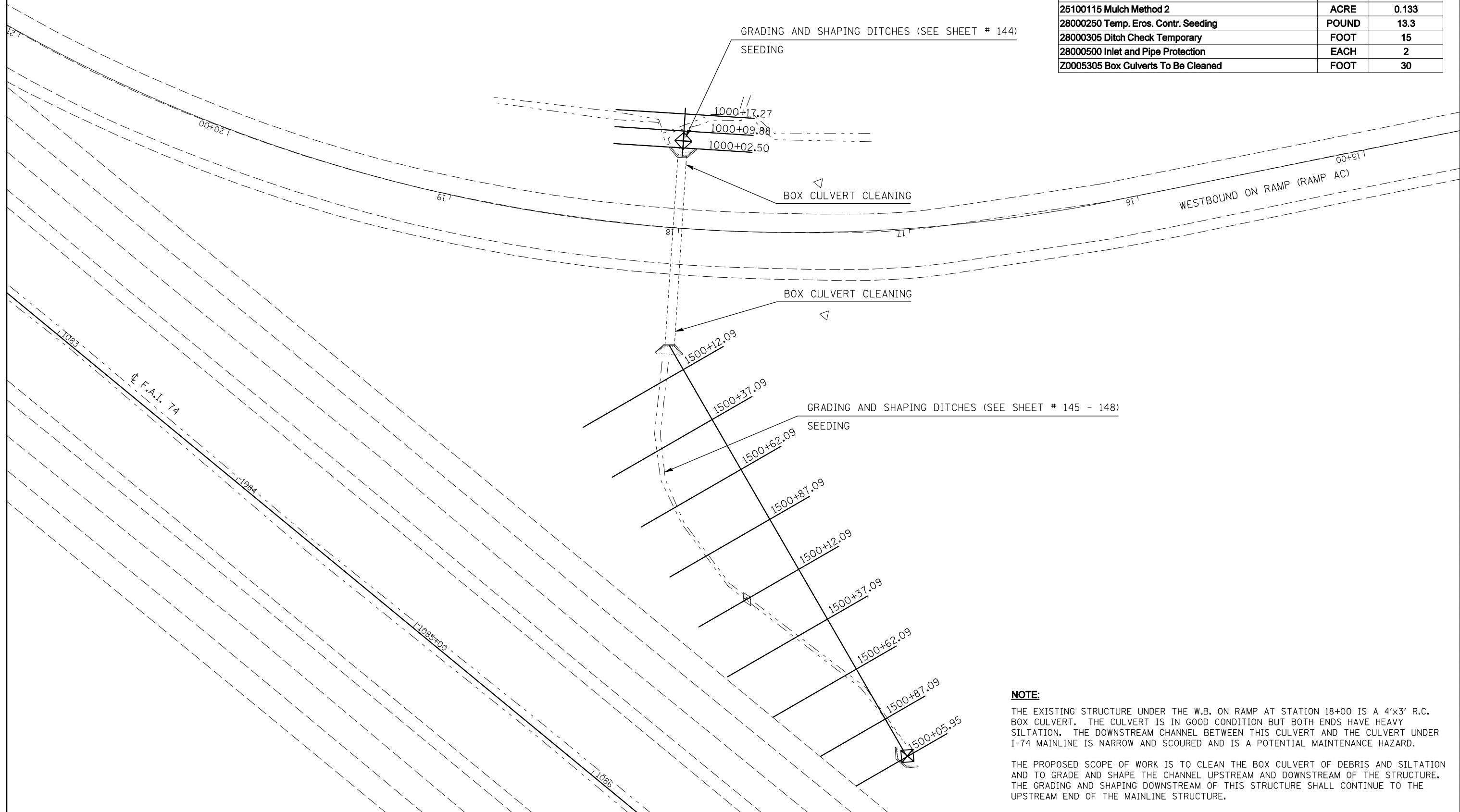

NOTE:
 THE EXISTING STRUCTURE UNDER THE W.B. ON RAMP AT STATION 18+00 IS A 4'x3' R.C. BOX CULVERT. THE CULVERT IS IN GOOD CONDITION BUT BOTH ENDS HAVE HEAVY SILTATION. THE DOWNSTREAM CHANNEL BETWEEN THIS CULVERT AND THE CULVERT UNDER I-74 MAINLINE IS NARROW AND SCOURED AND IS A POTENTIAL MAINTENANCE HAZARD.

THE PROPOSED SCOPE OF WORK IS TO CLEAN THE BOX CULVERT OF DEBRIS AND SILTATION AND TO GRADE AND SHAPE THE CHANNEL UPSTREAM AND DOWNSTREAM OF THE STRUCTURE. THE GRADING AND SHAPING DOWNSTREAM OF THIS STRUCTURE SHALL CONTINUE TO THE UPSTREAM END OF THE MAINLINE STRUCTURE.

FILE NAME =	USER NAME = hoganbj	DESIGNED - BJM	REVISED -	STATE OF ILLINOIS DEPARTMENT OF TRANSPORTATION	DRAINAGE STRUCTURE IMPROVEMENT DETAIL			F.A.I. RTE. =	SECTION	COUNTY	TOTAL SHEETS	SHEET NO.
ct:\pw\work\pwwork\hoganbj\0158340\0570650-shr-sm_struct_det.dgn		DRAWN -	REVISED -		LOCATION #21 STA. 18+00			74	(57-20(1),21,22RS-3	McLean	150	71
PLOT SCALE = 40.0000' / IN.		CHECKED -	REVISED -		SCALE: 1" = 20'	SHEET NO.	OF SHEETS	STA.	TO STA.	CONTRACT NO. 70550		
PLOT DATE = 10/21/2010		DATE - 09/23/10	REVISED -		ILLINOIS FED. AID PROJECT							