

F.A.I. RTE.	SECTION	COUNTY	TOTAL SHEETS	SHEET NO.
•	CM PATCHING 2011-1	••	10	1
••CHAMPAIGN & VERMILION ILLINOIS CONTRACT NO. 70876				
• 57 & 74				

D-95-053-10

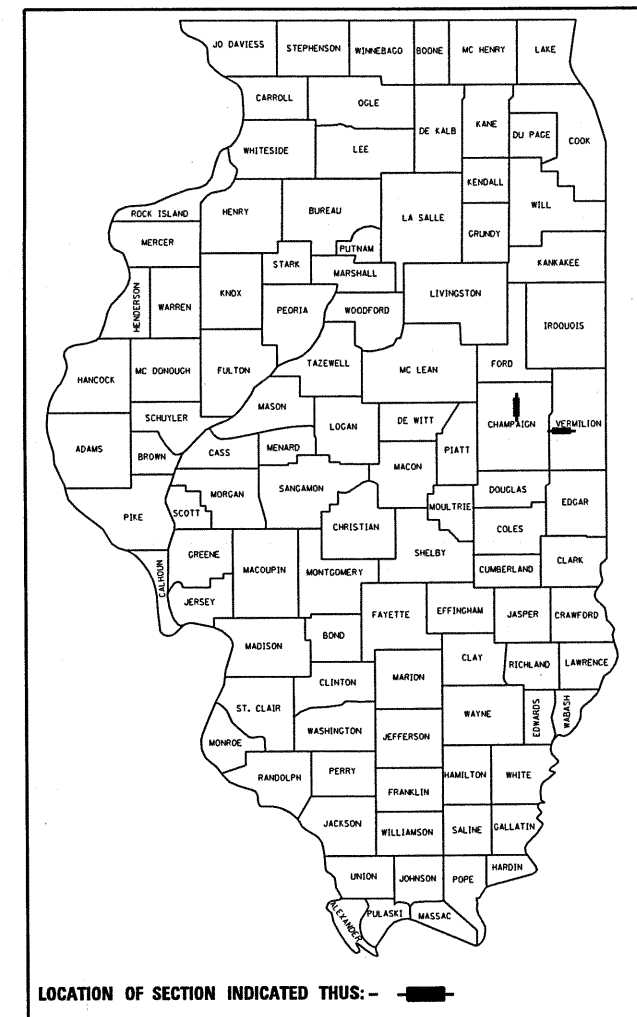

STATE OF ILLINOIS  
DEPARTMENT OF TRANSPORTATION  
DIVISION OF HIGHWAYS  
**PROPOSED  
HIGHWAY PLANS**

**FAI 57 & FAI 74 (I-57 & I-74)  
SECTION CM PATCHING 2011-1**

**CHAMPAIGN & VERMILION COUNTIES**  
C-95-053-10

FOR INDEX OF SHEETS, SEE SHEET NO. 2  
FOR SUMMARY OF QUANTITIES, SEE SHEET NO. 5

CURRENT ADT =	<u>FAI 57</u>	<u>FAI 74</u>
	21,800 (2009)	24,100 (2009)

DESIGN DESIGNATION  
INTERSTATE  
N/A

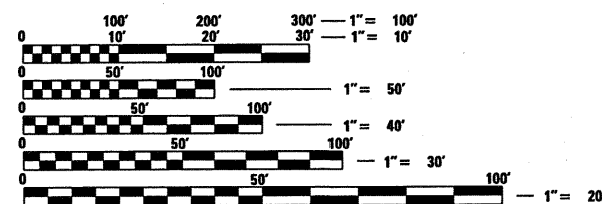

FULL SIZE PLANS HAVE BEEN PREPARED USING STANDARD ENGINEERING SCALES. REDUCED SIZED PLANS WILL NOT CONFORM TO STANDARD SCALES. IN MAKING MEASUREMENTS ON REDUCED PLANS, THE ABOVE SCALES MAY BE USED.

J.U.L.I.E.  
JOINT UTILITY LOCATION INFORMATION FOR EXCAVATION  
1-800-892-0123  
OR 811

PROJECT ENGINEER : KEVIN TRAPP (217) 465-4181  
PROJECT MANAGER : JEFF SHERER  
DESIGNER : RANDY AUSTIN  
CONTRACT NO. 70876

SEE PAGE 3 & 4 FOR LOCATION MAPS

FAI 57 - TOTAL LENGTH OF SECTION & PROJECT = 51,620.42 FEET = 9.777 MILES  
FAI 74 - TOTAL LENGTH OF SECTION & PROJECT = 135,153.8 FEET = 25.597 MILES

STATE OF ILLINOIS  
DEPARTMENT OF TRANSPORTATION  
DIVISION OF HIGHWAYS

SUBMITTED 10/20 20 10  
Joseph W. Anderson  
DEPUTY DIRECTOR OF HIGHWAYS, REGION ENGINEER

Dec 10 20 10  
Scott E. Still P.E. /bc  
acting ENGINEER OF DESIGN AND ENVIRONMENT

Dec 10 20 10  
Christine M. Reed /bc  
DIRECTOR OF HIGHWAYS, CHIEF ENGINEER

**PRINTED BY THE AUTHORITY  
OF THE STATE OF ILLINOIS**

## INDEX OF SHEETS

SHEET NO.	DESCRIPTION
1	COVER SHEET
2	INDEX OF SHEETS
2	GENERAL NOTES
2	LIST OF STANDARDS
3 & 4	LOCATION MAP
5	SUMMARY OF QUANTITIES
6-8	EXISTING TYPICAL SECTIONS
9-10	SCHEDULE OF QUANTITIES

## HIGHWAY STANDARDS

STANDARD NUMBER	NAME OF STANDARD
000001-06	STANDARD SYMBOLS, ABBREVIATIONS AND PATTERNS
001001-02	AREAS OF REINFORCEMENT BARS
001006	DECIMAL OF AND INCH AND OF A FOOT
420001-07	PAVEMENT JOINTS
420701-02	PAVEMENT FABRIC
442001-04	CLASS A PATCHES
442101-07	CLASS B PATCHES
701101-02	OFF-ROAD OPERATIONS, MULTILANE, 15', TO 24" FROM PAVEMENT EDGE
701400-05	APPROACH TO LANE CLOSURE, FREEWAY / EXPRESSWAY
701401-06	LANE CLOSURE, FREEWAY / EXPRESSWAY
701411-07	LANE CLOSURE, MULTILANE, AT ENTRANCE OR EXIT RAMP, FOR SPEEDS $\geq$ 45 MPH
701426-04	LANE CLOSURE, MULTILANE, INTERMITTENT OR MOVING OPERATIONS FOR SPEEDS $\geq$ 45 MPH
701901-01	TRAFFIC CONTROL DEVICES

## GENERAL NOTES

**G.N.-100**  
ENGLISH UNITS OF MEASUREMENT SHALL GOVERN OVER AND SUPERSEDE ANY METRIC UNITS SHOWN IN THIS CONTRACT. WHERE INCLUDED, METRIC UNITS ARE FOR INFORMATION ONLY.

**G.N.-442B – PATCHING SCHEDULES**  
THE PATCHING SCHEDULES INCLUDED IN THE PLANS REPRESENT THE BEST INFORMATION AVAILABLE AT THE TIME OF COMPLETION OF THE PLANS FOR LETTING. VARIATIONS IN LOCATION AND SIZES OF BOTH FULL-DEPTH AND PARTIAL-DEPTH PATCHES MAY OCCUR.

**G.N.-667**  
THE RESIDENT ENGINEER SHALL CONTACT THE PROGRAM DEVELOPMENT CHIEF OF SURVEYS PRIOR TO THE PRE-CONSTRUCTION CONFERENCE FOR INSTRUCTION AS TO SETTING OF TEMPORARY OR PERMANENT TIES FOR CENTERLINE ALIGNMENT CONTROL SURVEY MARKERS (PC'S, PT'S, AND PI'S). PROJECT IMPLEMENTATION PERSONNEL WILL BE RESPONSIBLE FOR SETTING THESE MARKERS.

**G.N.-1004.01**  
COARSE AGGREGATE GRADATION CA-10 MAY BE USED WHENEVER COARSE AGGREGATE CA-6 IS SPECIFIED IN THE STANDARD SPECIFICATIONS.

**NO COMMITMENTS**

FILE NAME *	USER NAME * craigre	DESIGNED - RLA	REVISED -	<b>STATE OF ILLINOIS DEPARTMENT OF TRANSPORTATION</b>	<b>INDEX OF SHEETS / GENERAL NOTES</b>	F.A.I. RTE.	SECTION	COUNTY	TOTAL SHEETS	SHEET NO.
c:\pwork\pilot\craigre\0239080\0570876\shg\gennote.dgn	DRAWN - RLA	REVISED -	*			CM PATCHING 2011-1	**	10	2	
PLOT SCALE = 40.0000 / IN.	CHECKED - JMS	REVISED -	**			CHAMPAIGN & VERMILION	CONTRACT NO. 70876			
PLOT DATE = 10/20/2010	DATE - 9/8/10	REVISED -	*			57 & 74	ILLINOIS FED. AID PROJECT			
				SCALE: N/A	SHEET NO. 1 OF 1 SHEETS	STA. N/A TO STA. N/A				

# LOCATION MAP

CHAMPAIGN COUNTY

I-57

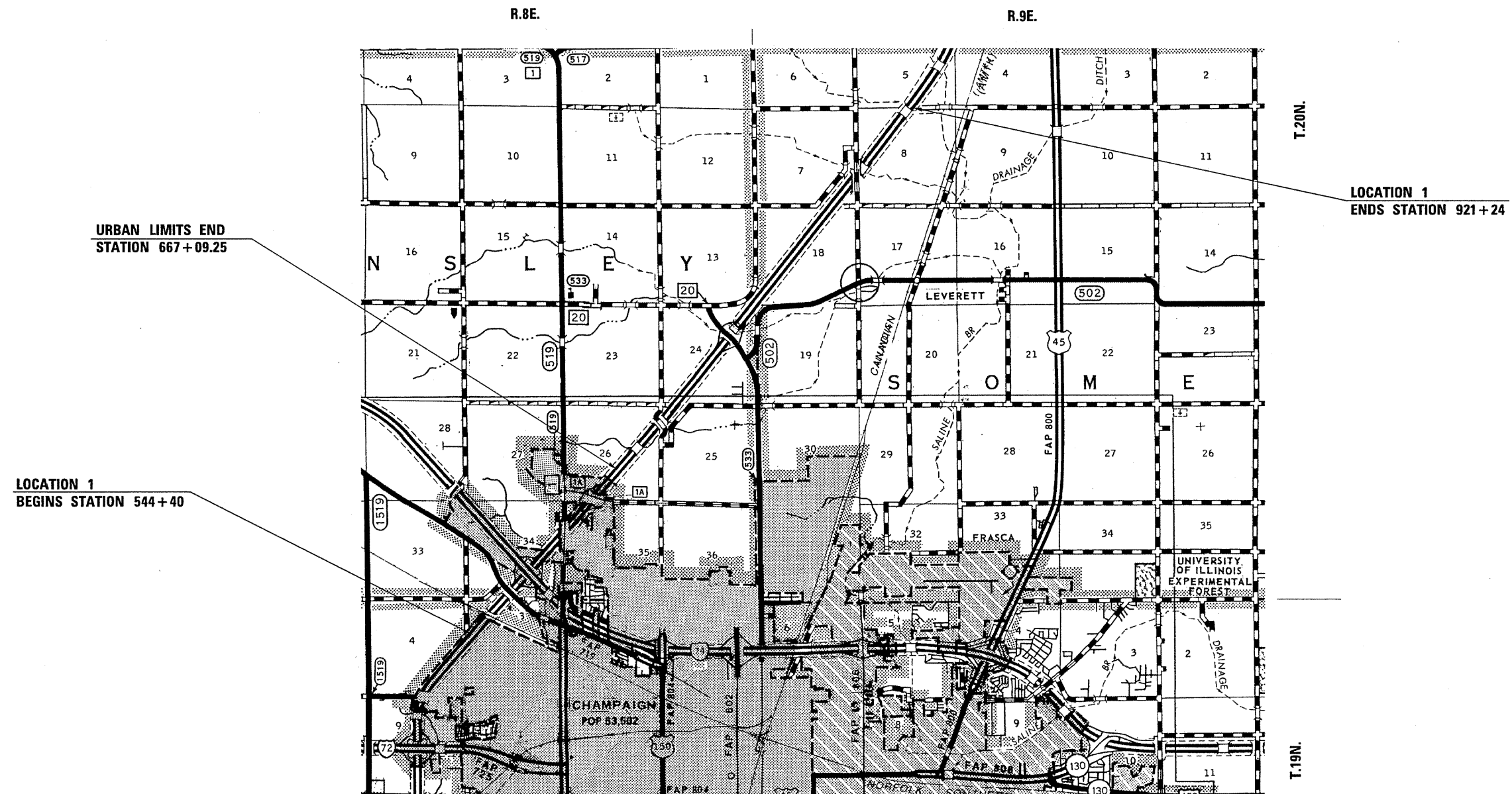

FILE NAME *	USER NAME * craigs	DESIGNED -	REVISED -
c:\pwwork\p\idot\craigs\d0239080\0570876-sht-cover.dgn		DRAWN -	REVISED -
		CHECKED -	REVISED -
		DATE -	REVISED -

**STATE OF ILLINOIS  
DEPARTMENT OF TRANSPORTATION**

<b>LOCATION MAPS</b>	
SCALE:	SHEET NO. 1 OF 1 SHEETS STA. N/A TO STA. N/A

F.A.I. RTE.	SECTION	COUNTY	TOTAL SHEETS	SHEET NO.
**	CM PATCHING 2011-1	*	10	3
*CHAMPAIGN & VERMILION			CONTRACT NO. 70876	
** 57 & 74 ILLINOIS FED. AID PROJECT				

# LOCATION MAP

## CHAMPAIGN & VERMILION COUNTIES

### I-74

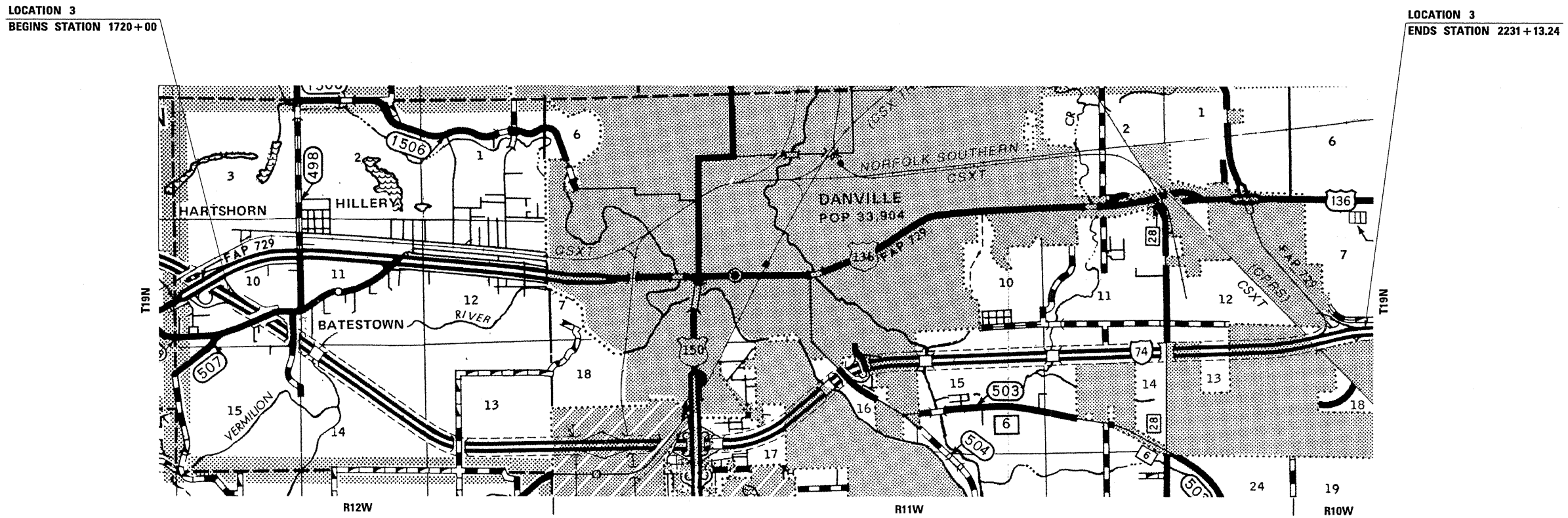
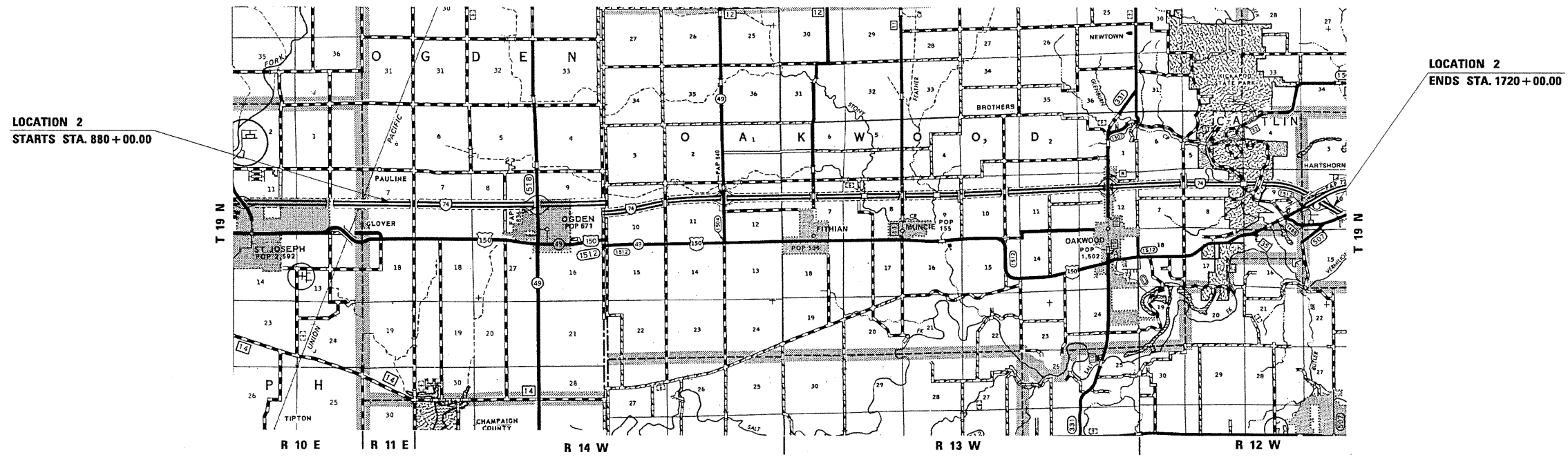

FILE NAME *	USER NAME * craig	DESIGNED -	REVISED -	<b>STATE OF ILLINOIS DEPARTMENT OF TRANSPORTATION</b>	<b>LOCATION MAPS</b>	F.A.I. RTE.	SECTION	COUNTY	TOTAL SHEETS	SHEET NO.	
ci:\pw_work\pwidot\craig\d0239888\0570876-shr-cover.dgn	PLOT SCALE = 48.0000' / IN.	DRAWN -	REVISED -			74	CM PATCHING 2011-1	*	10	4	
PLOT DATE = 10/20/2010	DATE -	CHECKED -	REVISED -			SCALE: SHEET NO. 1 OF 1 SHEETS STA. N/A TO STA. N/A		*CHAMPAIGN & VERMILION CONTRACT NO. 70876			
		DATE -	REVISED -			ILLINOIS FED. AID PROJECT					

# SUMMARY OF QUANTITIES

LOCATION OF WORK:

FAI-57 CHAMPAIGN CO. STATION 544+40.00 TO 921+24.00 RURAL-MULTILANE 100% STATE 0004	FAI-74 VERMILION COUNTY STATION 1053+86.00 TO 2231+13.24 RURAL-MULTILANE 100% STATE 0004
--	---

CONSTRUCTION TYPE CODE:

CODE NO	ITEM	UNIT	TOTAL QUANTITY		
44200620	CLASS A PATCHES, TYPE II, 14 INCH	SQ YD	58.0	58.0	
44200624	CLASS A PATCHES, TYPE III, 14 INCH	SQ YD	20.0	20.0	
44200628	CLASS A PATCHES, TYPE IV, 14 INCH	SQ YD	40.0	40.0	
44201007	CLASS B PATCHES, TYPE II, 13 INCH	SQ YD	16.0		16.0
44201031	CLASS B PATCHES, TYPE II, 15 INCH	SQ YD	8.0		8.0
44201035	CLASS B PATCHES, TYPE III, 15 INCH	SQ YD	64.0		64.0
44201037	CLASS B PATCHES, TYPE IV, 15 INCH	SQ YD	453.0		453.0
44201053	CLASS B PATCHES, TYPE IV, 17 INCH	SQ YD	27.0		27.0
44201299	DOWEL BARS 1 1/2"	EACH	460.0		460.0
44213000	PATCHING REINFORCEMENT	SQ YD	118.0	118.0	
44213100	PAVEMENT FABRIC	SQ YD	544.0		544.0
44213200	SAW CUTS	FOOT	1,862.0	506.0	1,356.0
44213204	TIE BARS 3/4"	EACH	220.0	40.0	180.0
67100100	MOBILIZATION	L SUM	1.0	0.3	0.7
70100420	TRAFFIC CONTROL AND PROTECTION, STANDARD 701411	EACH	36.0	8.0	28.0
70100800	TRAFFIC CONTROL AND PROTECTION, STANDARD 701401	L SUM	1.0	0.3	0.7
70103815	TRAFFIC CONTROL SURVEILLANCE	CAL DA	10.0	3.0	7.0
X0323583	SPEED INDICATOR SIGN	CAL DA	20.0	5.0	15.0
X7015005	CHANGEABLE MESSAGE SIGN	CAL DA	35.0	7.0	28.0

# EXISTING TYPICAL SECTIONS

## FAI ROUTE 57

NORTHBOUND LANES  
STATION 623+35.63 TO STATION 654+31.10

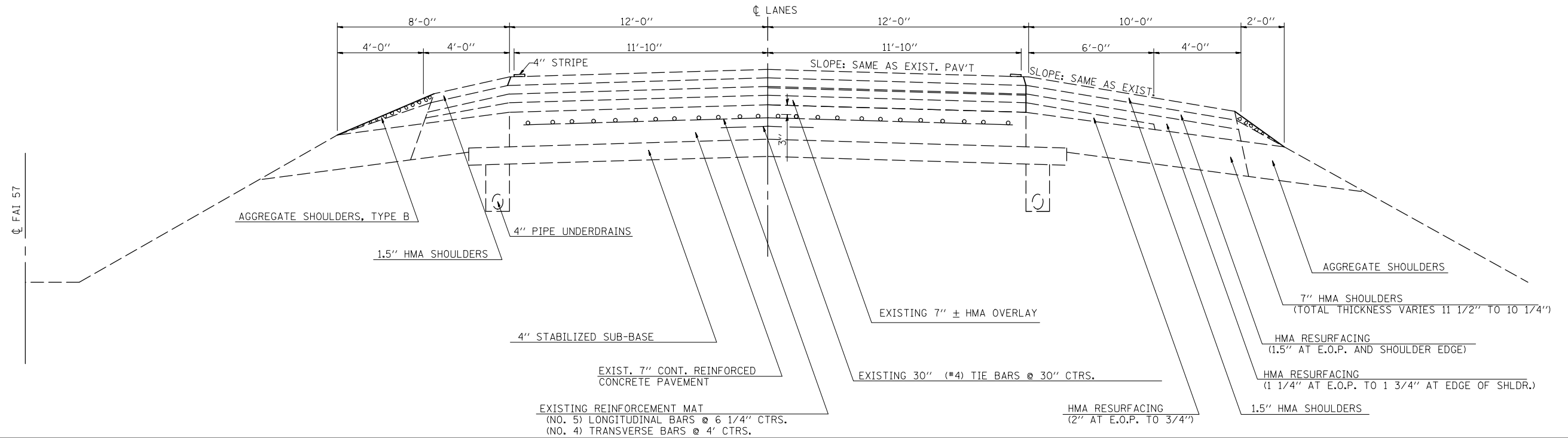

# EXISTING TYPICAL SECTIONS

## FAI ROUTE 57

SOUTHBOUND LANES  
STATION 623+35.63 TO STATION 921+24.04

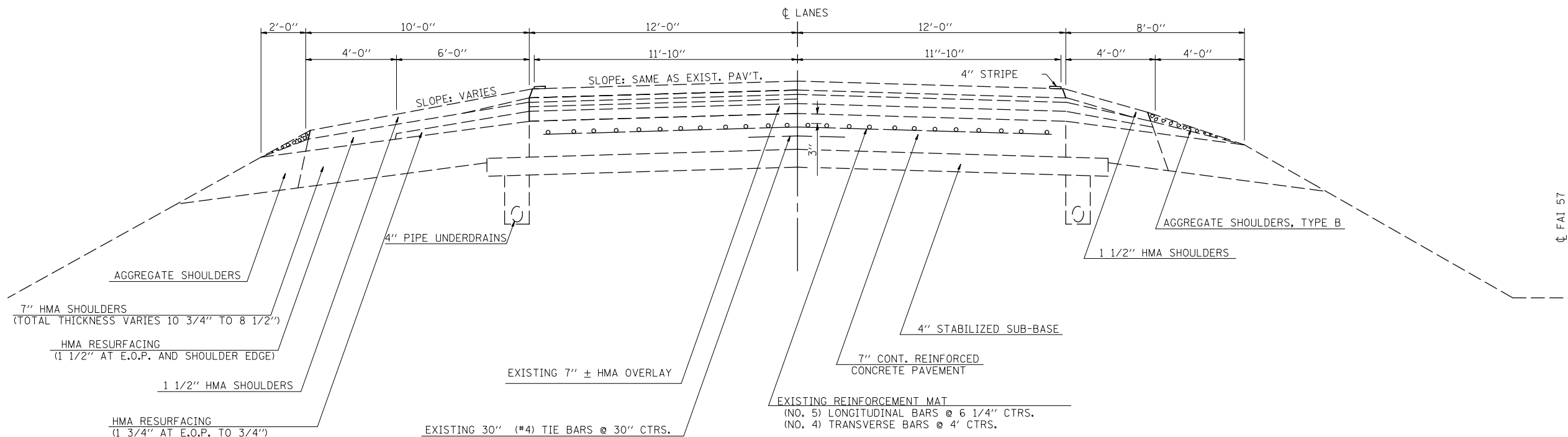

FILE NAME =	USER NAME = craige	DESIGNED -	REVISED -	<b>STATE OF ILLINOIS DEPARTMENT OF TRANSPORTATION</b>	<b>EXISTING TYPICAL SECTION</b>			F.A.I. RTE.	SECTION	COUNTY	TOTAL SHEETS	SHEET NO.
ct:\pw\work\pwidot\craige\d0239888\0570876-shr-typical.dgn	PLOT SCALE = 40.0000' / IN.	DRAWN -	REVISED -					57	CM PATCHING 2011-1	CHAMPAIGN	10	6
PLOT DATE = 10/20/2010	DATE -	CHECKED -	REVISED -		SCALE: N/A    SHEET NO. 1 OF 3 SHEETS    STA. N/A    TO STA. N/A			CONTRACT NO. 70876				
		DATE -	REVISED -		ILLINOIS FED. AID PROJECT							

# EXISTING TYPICAL SECTION FAI 74

STATION 880+00.00 TO STATION 1053+06.00 - CHAMPAIGN COUNTY  
STATION 1053+06.00 TO STATION 1616+00.00 - VERMILION COUNTY

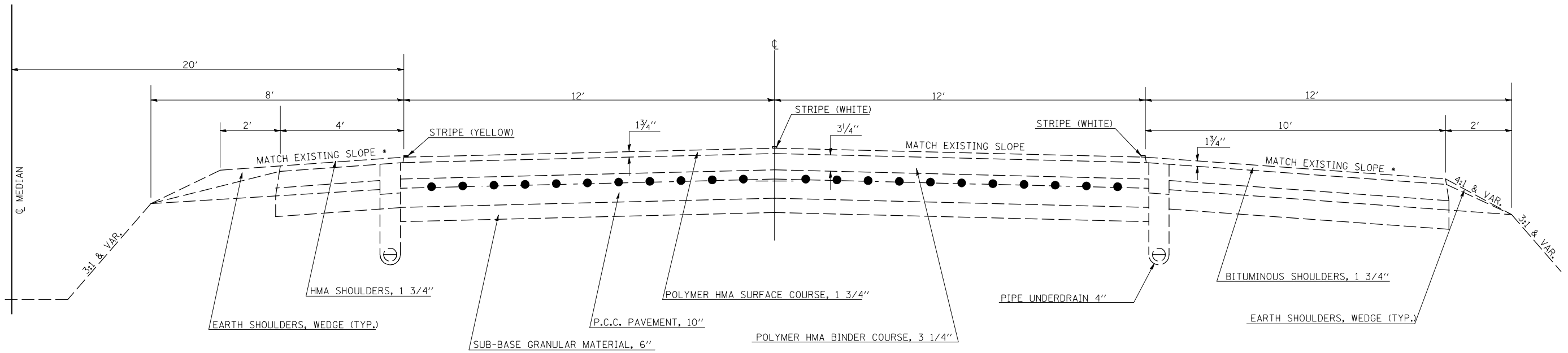

\*\* ALLOWABLE MINIMUM SHOULDER SLOPE = 4.0%  
ALLOWABLE MAXIMUM SHOULDER SLOPE = 6.0%

# EXISTING TYPICAL SECTION FAI 74

STA. 1616+00.00 TO STA. 1720+00.00  
112'

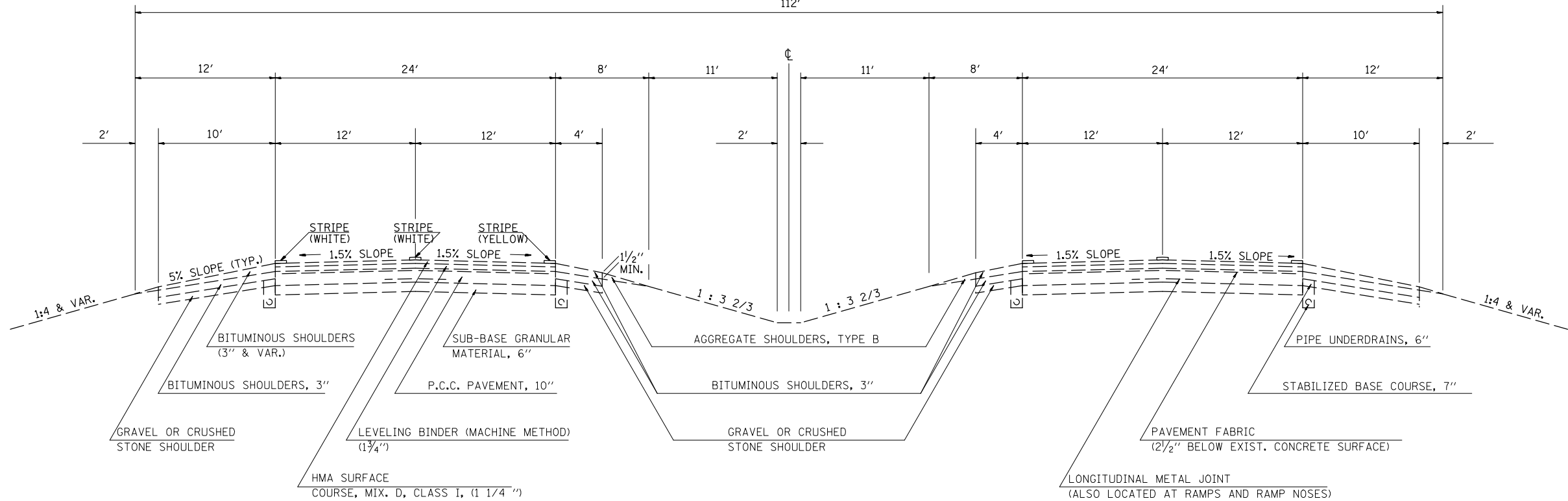

FILE NAME =	USER NAME = craigre	DESIGNED -	REVISED -
ct:\pw\work\p\dot\craigre\d0239080\0570076-sht-typical.dgn		DRAWN -	REVISED -
PLOT SCALE = 40.0000' / IN.		CHECKED -	REVISED -
PLOT DATE = 10/20/2010		DATE -	REVISED -

**STATE OF ILLINOIS  
DEPARTMENT OF TRANSPORTATION**

**EXISTING TYPICAL SECTION**

SCALE: N/A    SHEET NO. 2 OF 3 SHEETS    STA. N/A    TO STA. N/A

F.A.I. RTE.	SECTION	COUNTY	TOTAL SHEETS	SHEET NO.
74	CM PATCHING 2011-1	VERMILION	10	7
CONTRACT NO. 70876				
ILLINOIS FED. AID PROJECT				

# EXISTING TYPICAL SECTION

## FAI 74

STATION 1720+00.00 TO STATION 1908+00.00

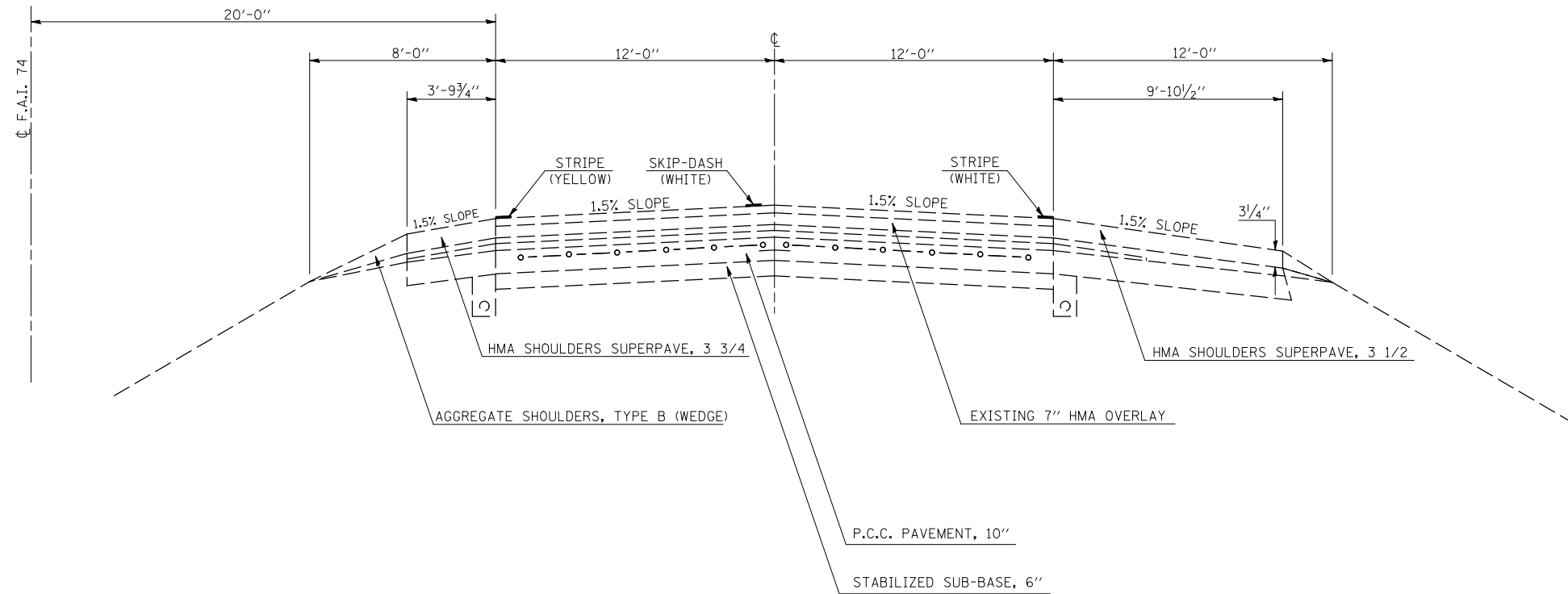

# EXISTING TYPICAL SECTION WITH COLLECTOR LANE

## FAI 74

STATION 1908+00.00 TO STATION 1951+50.00

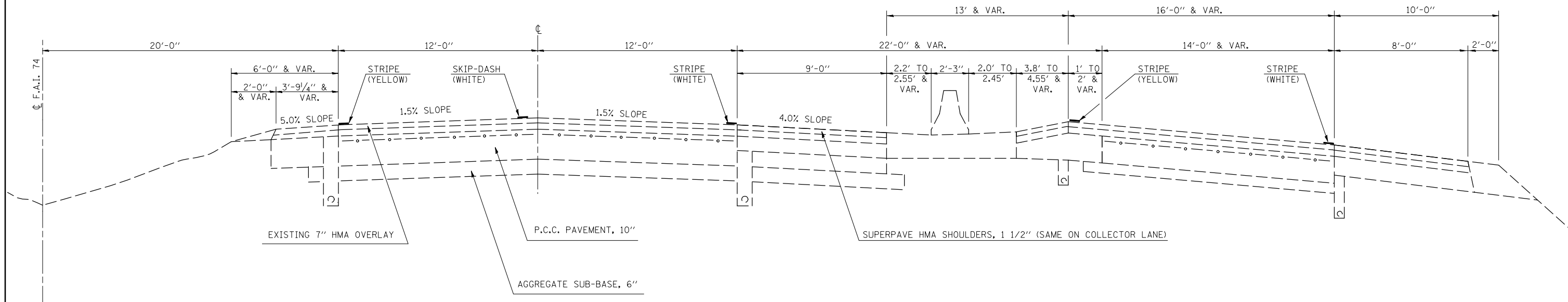

FILE NAME =	USER NAME = craigre	DESIGNED -	REVISED -
ct:\pw\work\pwidot\craigre\d0239888\0570876-sht-typical.dgn	76-sht-typical.dgn	DRAWN -	REVISED -
PLOT SCALE = 40.0000' / IN.		CHECKED -	REVISED -
PLOT DATE = 10/20/2010		DATE -	REVISED -

**STATE OF ILLINOIS  
DEPARTMENT OF TRANSPORTATION**

**EXISTING TYPICAL SECTION**

SCALE: N/A SHEET NO. 3 OF 3 SHEETS STA. N/A TO STA. N/A

F.A.I. RTE.	SECTION	COUNTY	TOTAL SHEETS	SHEET NO.
74	CM PATCHING 2011-1	VERMILION	10	8
CONTRACT NO. 70876				
ILLINOIS FED. AID PROJECT				



**SCHEDULE OF QUANTITIES  
TABULATION OF CLASS A PATCH, 14"  
I-57 MAINLINE (SOUTHBOUND)**

STATION	LOCATION	LANE	LENGTH	WIDTH	TYPE II	TYPE III	TYPE IV	SAWCUTS	TIE BARS	PATCHING REINFORCEMENT	
			(FT)	(FT)	44200620 (SQ. YD.)	44200624 (SQ. YD.)	44200628 (SQ. YD.)	44213200 (FT)	44213204 (EACH)	44213000 (SQ. YD.)	
668+05.53	I-57 MAINLINE	SBDL	30.0	6.0		20.0		84.0	15.0	20.0	
671+89.38	I-57 MAINLINE	SBDL	30.0	12.0			40.0	108.0	15.0	40.0	
676+68.38	I-57 MAINLINE	SBDL	6.0	12.0	8.0			60.0		8.0	
799+64.95	I-57 MAINLINE	SBPL	10.0	12.0	13.3			68.0		13.3	
799+64.95	I-57 MAINLINE	SBDL	10.0	12.0	13.3			68.0		13.3	
883+80.30	I-57 MAINLINE	SBDL	15.0	6.0	10.0			54.0		10.0	
885+41.16	I-57 MAINLINE	SBDL	20.0	6.0	13.3			64.0	10.0	13.3	
<b>NORTHBOUND AND SOUTHBOUND TOTALS</b>											
					<b>USE =</b>	<b>57.9</b>	<b>20.0</b>	<b>40.0</b>	<b>506.0</b>	<b>40.0</b>	<b>117.9</b>
						<b>58.0</b>	<b>20.0</b>	<b>40.0</b>	<b>506.0</b>	<b>40.0</b>	<b>118.0</b>

**SCHEDULE OF QUANTITIES  
 TABULATION OF CLASS B PATCH, 13", 15", 17"  
 I-74 MAINLINE (EASTBOUND & WESTBOUND)**

STATION	LOCATION	LANE	LENGTH	WIDTH	DEPTH	TYPE II	TYPE III	TYPE IV	DOWEL BARS	SAWCUTS	TIE BARS	PAVEMENT FABRIC
						13"-44201007		15"-44201037				
			(FT)	(FT)		15"-44201031	15"-44201035	17"-44201053	44201299	44213200	44213204	44213100
						(SQ. YD.)	(SQ. YD.)	(SQ. YD.)	(EACH)	(FT)	(EACH)	(SQ. YD.)
1698+69	I-74 MAINLINE	WBDL	6.0	12.0	13"	8.0			20.0	48.0		
1698+69	I-74 MAINLINE	WBPL	6.0	12.0	13"	8.0			20.0	48.0		
1080+03	I-74 MAINLINE	EBDL	12.0	12.0	15"		16.0		20.0	60.0		16.0
1105+46	I-74 MAINLINE	EBDL	12.0	12.0	15"		16.0		20.0	60.0		16.0
1242+31	I-74 MAINLINE	EBDL	30.0	12.0	15"			40.0	30.0	96.0	15.0	40.0
1688+64	I-74 MAINLINE	EBDL	100.0	12.0	15"			133.3	80.0	236.0	50.0	133.3
1889+20	I-74 MAINLINE	EBDL	30.0	12.0	15"			40.0	20.0	96.0	15.0	40.0
1106+01	I-74 MAINLINE	WBPL	60.0	12.0	15"			80.0	50.0	156.0	30.0	80.0
1108+64	I-74 MAINLINE	WBDL	70.0	12.0	15"			93.3	60.0	176.0	35.0	93.3
1239+53	I-74 MAINLINE	WBDL	12.0	12.0	15"		16.0		20.0	60.0		16.0
1239+97	I-74 MAINLINE	WBDL	50.0	12.0	15"			66.7	50.0	136.0	25.0	66.7
1240+34	I-74 MAINLINE	WBDL	12.0	12.0	15"		16.0		20.0	60.0		16.0
1612+08	I-74 MAINLINE	WBPL	6.0	12.0	15"	8.0			20.0	48.0		
1935+33	I-74 MAINLINE	WBDL	20.0	12.0	17"			26.7	30.0	76.0	10.0	26.7
<b>CLASS B PATCH TOTALS</b>						<b>24.0</b>	<b>64.0</b>	<b>480.0</b>	<b>460.0</b>	<b>1356.0</b>	<b>180.0</b>	<b>544.0</b>