

F.A.I. RTE.	SECTION	COUNTY	TOTAL SHEETS	SHEET NO.
39	57-(2,3,4)PATCHING-1	MCLEAN	16	1
		ILLINOIS	CONTRACT NO. 70878	

STATE OF ILLINOIS  
DEPARTMENT OF TRANSPORTATION

DIVISION OF HIGHWAYS

**PROPOSED  
HIGHWAY PLANS**

F.A.I. ROUTE 39 (I-39)  
SECTION 57(2,3,4)PATCHING-1

MCLEAN COUNTY

C-95-055-10  
PATCHING FROM I-55 TO WOODFORD COUNTY LINE

D-95-055-10

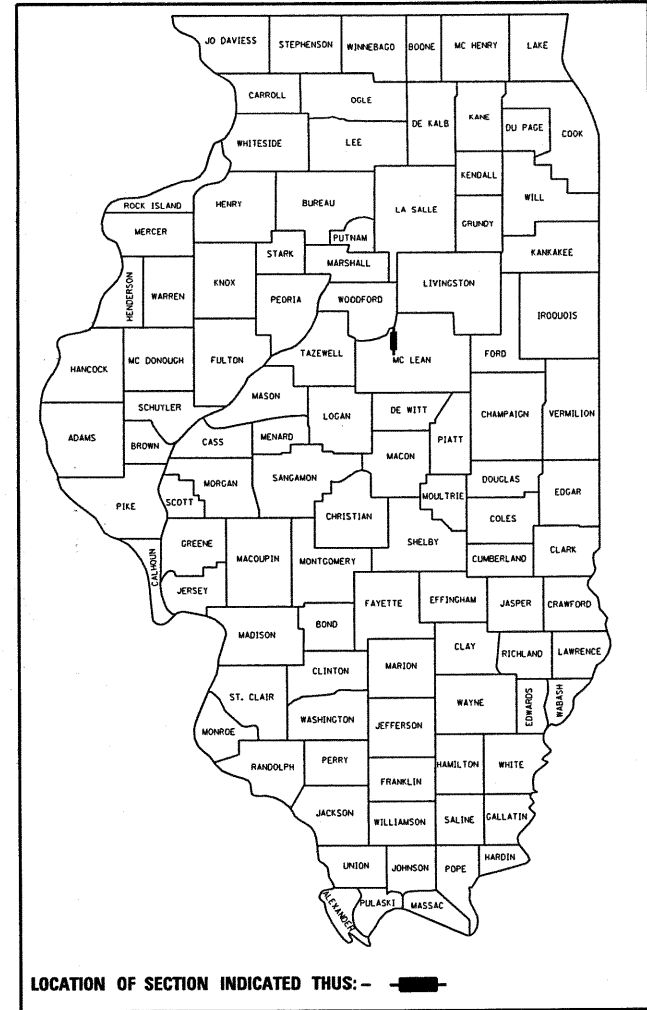

LOCATION OF SECTION INDICATED THUS: - [Black Box] -

FOR INDEX OF SHEETS, SEE SHEET NO. 2  
FOR SUMMARY OF QUANTITIES, SEE SHEET NO. 4

CURRENT ADT = 19,900 (2009)

DESIGN DESIGNATION  
INTERSTATE  
N/A

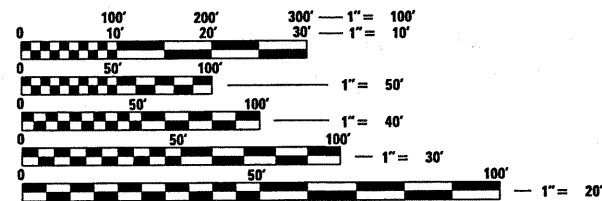

FULL SIZE PLANS HAVE BEEN PREPARED USING STANDARD ENGINEERING SCALES. REDUCED SIZED PLANS WILL NOT CONFORM TO STANDARD SCALES. IN MAKING MEASUREMENTS ON REDUCED PLANS, THE ABOVE SCALES MAY BE USED.

J.U.L.I.E.  
JOINT UTILITY LOCATION INFORMATION FOR EXCAVATION  
1-800-892-0123  
OR 811

PROJECT ENDS  
STATION 557+87.88

STATION EQUATION  
STA 377+24.54 (BK) =  
STA 377+00.00 (AH)

PROJECT BEGINS  
STATION 41+92 I-39 NB  
STATION 77+32 I-39 SB  
STATION 30+00 RAMP A  
STATION 10+00 RAMP B

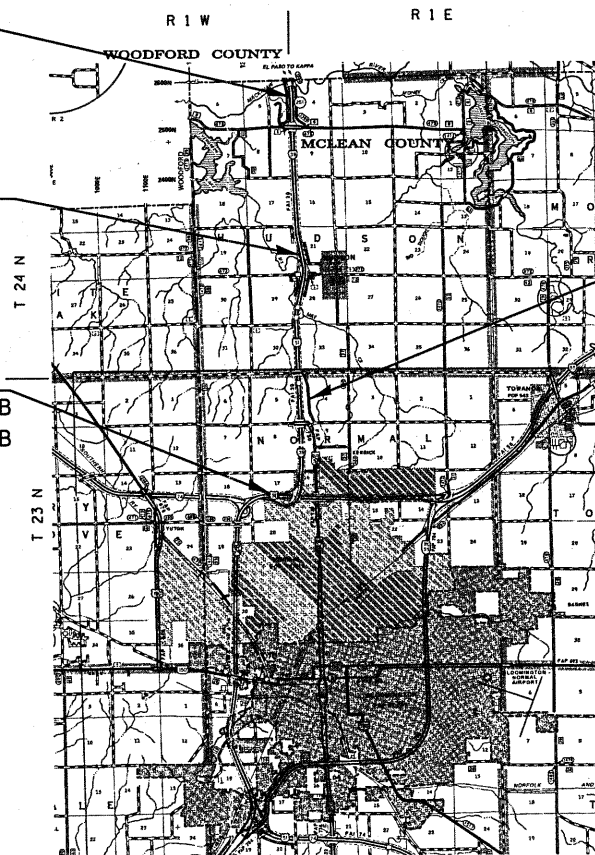

STA. 198+61.67

RURAL  
URBAN

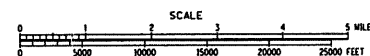

TOTAL LENGTH OF SECTION & PROJECT = 51,620.42 FEET = 9.777 MILES  
NET LENGTH OF SECTION & PROJECT = 51,620.42 FEET = 9.777 MILES

PROJECT ENGINEER : KEVIN TRAPP (217) 465-4181  
PROJECT MANAGER : JEFF SHERER  
DESIGNER : RANDY AUSTIN  
CONTRACT NO. 70878

STATE OF ILLINOIS  
DEPARTMENT OF TRANSPORTATION  
DIVISION OF HIGHWAYS

SUBMITTED October 25 20 10  
Joseph E. Lane DEPUTY DIRECTOR OF HIGHWAYS, REGION ENGINEER  
Dec 10 20 10  
Scott E. Stitt P.E. acting ENGINEER OF DESIGN AND ENVIRONMENT  
Dec 10 20 10  
Christine M. Reed DIRECTOR OF HIGHWAYS, CHIEF ENGINEER

PRINTED BY THE AUTHORITY  
OF THE STATE OF ILLINOIS

## INDEX OF SHEETS

SHEET NO.	DESCRIPTION
1	COVER SHEET
2	INDEX OF SHEETS
2	GENERAL NOTES
2	LIST OF STANDARDS
3	LOCATION MAP
4	SUMMARY OF QUANTITIES
5-10	EXISTING TYPICAL SECTIONS
11-15	SCHEDULE OF QUANTITIES
16	DETAILS OF EXISTING JOINTED P.C.C. PAVEMENT (HINGE-JOINT) AND ADJACENT P.C.C. SHOULDER

## HIGHWAY STANDARDS

STANDARD NUMBER	NAME OF STANDARD
000001-06	STANDARD SYMBOLS, ABBREVIATIONS AND PATTERNS
001001-02	AREAS OF REINFORCEMENT BARS
001006	DECIMAL OF AND INCH AND OF A FOOT
420001-07	PAVEMENT JOINTS
420101-04	24' ( 7.2m ) JOINTED PCC PAVEMENT
420106-04	36' ( 10.8m ) JOINTED PCC PAVEMENT
420701-02	PAVEMENT FABRIC
421001-02	BAR REINFORCEMENT FOR CRC PAVEMENT
421101-08	24' ( 7.2m ) CRC PAVEMENT ( WITH WIDE FLANGE BEAM TERMINAL JOINT )
442001-04	CLASS A PATCHES
442101-07	CLASS B PATCHES
701101-02	OFF-ROAD OPERATIONS, MULTILANE, 15', TO 24" FROM PAVEMENT EDGE
701400-05	APPROACH TO LANE CLOSURE, FREEWAY / EXPRESSWAY
701401-06	LANE CLOSURE, FREEWAY / EXPRESSWAY
701411-07	LANE CLOSURE, MULTILANE, AT ENTRANCE OR EXIT RAMP, FOR SPEEDS $\geq$ 45 MPH
701426-04	LANE CLOSURE, MULTILANE, INTERMITTENT OR MOVING OPERATIONS FOR SPEEDS $\geq$ 45 MPH
701901-01	TRAFFIC CONTROL DEVICES
701446-02	TWO LANE CLOSURE - FREEWAY/EXPRESSWAY

## GENERAL NOTES

### G.N.-100

ENGLISH UNITS OF MEASUREMENT SHALL GOVERN OVER AND SUPERSEDE ANY METRIC UNITS SHOWN IN THIS CONTRACT. WHERE INCLUDED, METRIC UNITS ARE FOR INFORMATION ONLY.

### G.N.-442B -- PATCHING SCHEDULES

THE PATCHING SCHEDULES INCLUDED IN THE PLANS REPRESENT THE BEST INFORMATION AVAILABLE AT THE TIME OF COMPLETION OF THE PLANS FOR LETTING. VARIATIONS IN LOCATION AND SIZES OF BOTH FULL-DEPTH AND PARTIAL-DEPTH PATCHES MAY OCCUR.

### G.N.-667

THE RESIDENT ENGINEER SHALL CONTACT THE PROGRAM DEVELOPMENT CHIEF OF SURVEYS PRIOR TO THE PRE-CONSTRUCTION CONFERENCE FOR INSTRUCTION AS TO SETTING OF TEMPORARY OR PERMANENT TIES FOR CENTERLINE ALIGNMENT CONTROL SURVEY MARKERS (PC'S, PT'S, AND PI'S). PROJECT IMPLEMENTATION PERSONNEL WILL BE RESPONSIBLE FOR SETTING THESE MARKERS.

### G.N.-1004.01

COARSE AGGREGATE GRADATION CA-10 MAY BE USED WHENEVER COARSE AGGREGATE CA-6 IS SPECIFIED IN THE STANDARD SPECIFICATIONS.

### NO COMMITMENTS

FILE NAME * c:\pwork\pwork\dot\bucklesj\d0239130\0572878-shr\gennote.dgn	USER NAME * bucklesj	DESIGNED - RLA	REVISED -	<b>STATE OF ILLINOIS DEPARTMENT OF TRANSPORTATION</b>	<b>INDEX OF SHEETS /GENERAL NOTES</b>		F.A.I. RTE.	SECTION	COUNTY	TOTAL SHEETS	SHEET NO.
	PLOT SCALE * 40.0000 / IN.	CHECKED - JMS	REVISED -		39	57(2,3,4)PATCHING-1	MCLEAN	16	2		
PLOT DATE * 10/19/2010	DATE - 9/8/10	REVISED -		SCALE: N/A	SHEET NO. 1 OF 1 SHEETS	STA. N/A TO STA. N/A	ILLINOIS FED. AID PROJECT				
CONTRACT NO. 70878											

# LOCATION MAP

**SOUTH SECTION**  
STA. 41+92.00 TO STA. 235+00.00

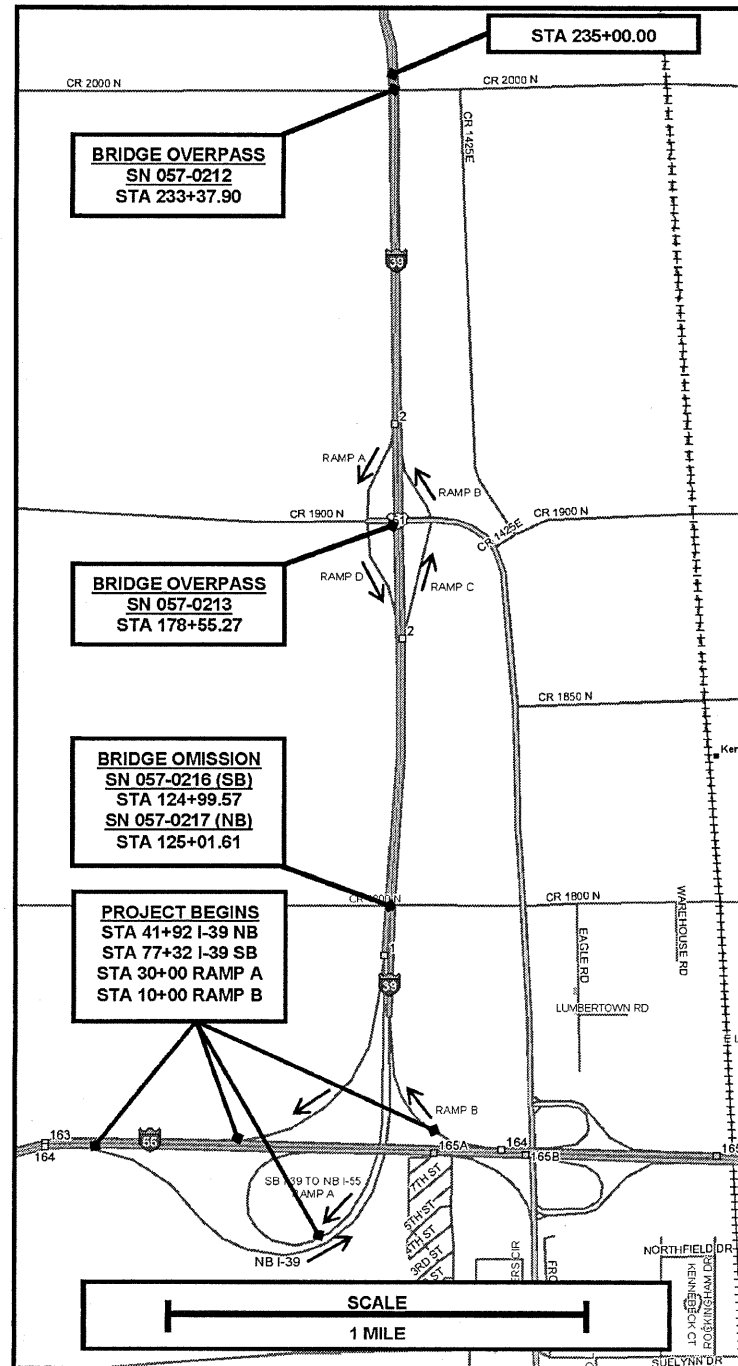

**CENTRAL SECTION**  
STA. 235+00.00 TO STA. 377+24.54

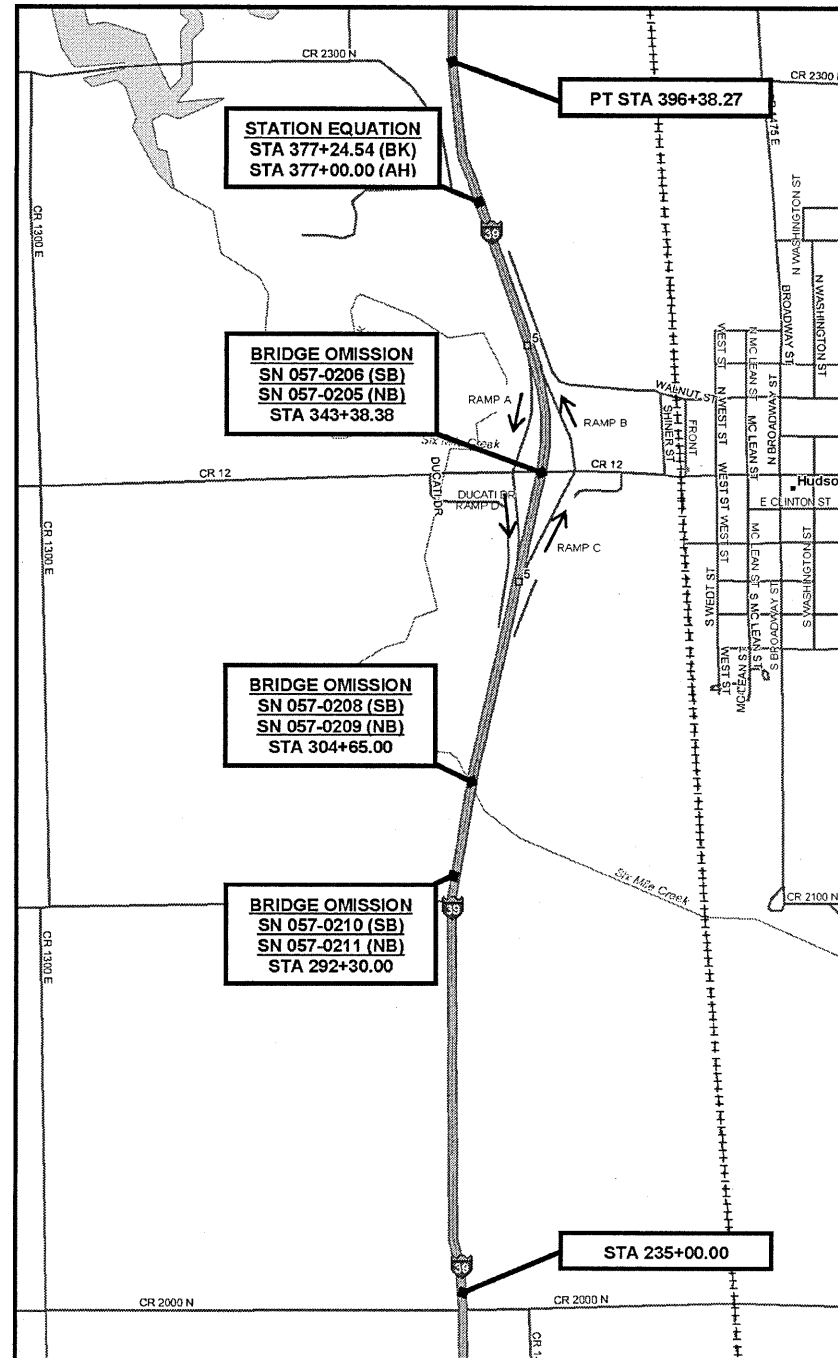

**NORTH SECTION**  
STA. 377+00.00 TO STA. 557+87.88

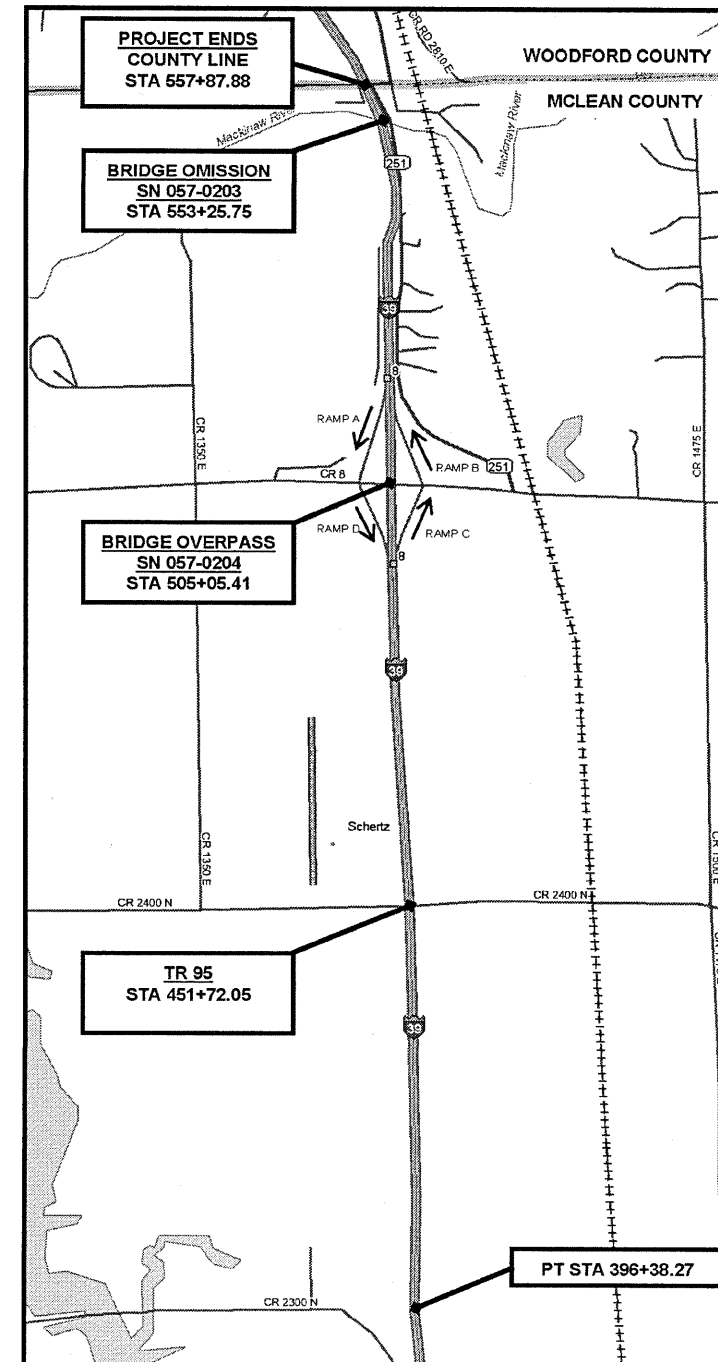

FILE NAME *	USER NAME * bucklesjj	DESIGNED -	REVISED -	<b>STATE OF ILLINOIS DEPARTMENT OF TRANSPORTATION</b>	<b>LOCATION MAP</b>	F.A.I. RTE.	SECTION	COUNTY	TOTAL SHEETS	SHEET NO.
at:\pwork\pwork\dot\bucklesjj\d0239130\0579878-shr-cover.dgn	DRAWN JJB	CHECKED -	REVISED -			39	57(2,3,4)PATCHING-1	MCLEAN	16	3
PLOT SCALE = 40.0000 / IN.	DATE -	REVISED -	REVISED -			CONTRACT NO. 70878				
PLOT DATE = 10/19/2010	DATE -	REVISED -	REVISED -			FED. ROAD DIST. NO. ILLINOIS FED. AID PROJECT				

## SUMMARY OF QUANTITIES

LOCATION OF WORK:

FAI-39 MCLEAN CO. STATION 41+92.0 TO 198+61.67 MULTILANE 100% STATE <u>0004</u>	FAI-39 MCLEAN CO. STATION 198+61.67 TO 557+87.88 RURAL-MULTILANE 100% STATE <u>0004</u>
--	--

CONSTRUCTION TYPE CODE:

CODE NO	ITEM	UNIT	TOTAL QUANTITY		
44200549	CLASS A PATCHES, TYPE I, 10 INCH	SQ YD	4.0		4.0
44200553	CLASS A PATCHES, TYPE II, 10 INCH	SQ YD	143.0		143.0
44200557	CLASS A PATCHES, TYPE III, 10 INCH	SQ YD	96.0		96.0
44200559	CLASS A PATCHES, TYPE IV, 10 INCH	SQ YD	313.0		313.0
44200982	CLASS B PATCHES, TYPE II, 11 INCH	SQ YD	110.0	86.0	24.0
44200986	CLASS B PATCHES, TYPE III, 11 INCH	SQ YD	20.0		20.0
44200988	CLASS B PATCHES, TYPE IV, 11 INCH	SQ YD	80.0	40.0	40.0
44201299	DOWEL BARS 1 1/2"	EACH	320.0	220.0	100.0
44213000	PATCHING REINFORCEMENT	SQ YD	556.0		556.0
44213100	PAVEMENT FABRIC	SQ YD	100.0	40.0	60.0
44213200	SAW CUTS	FOOT	3,347.0	1047.0	2,300.0
44213208	TIE BARS 1 1/4"	EACH	266.0	60.0	206.0
67100100	MOBILIZATION	L SUM	1.0	0.3	0.7
70100420	TRAFFIC CONTROL AND PROTECTION, STANDARD 701411	EACH	12.0	4.0	8.0
70100800	TRAFFIC CONTROL AND PROTECTION, STANDARD 701401	L SUM	1.0	0.3	0.7
70100815	TRAFFIC CONTROL AND PROTECTION, STANDARD 701446	L SUM	1.0	0.3	0.7
X0323583	SPEED INDICATOR SIGN	CAL DA	20.0	5.0	15.0
X7015005	CHANGEABLE MESSAGE SIGN	CAL DA	28.0	14.0	14.0

FILE NAME *	USER NAME * bucklesJJ	DESIGNED - RLA	REVISED -	<b>STATE OF ILLINOIS DEPARTMENT OF TRANSPORTATION</b>	<b>SUMMARY OF QUANTITIES</b>			F.A.I. RTE.	SECTION	COUNTY	TOTAL SHEETS	SHEET NO.
ct:\pwwork\pwwork\pwwork\bucklesJJ\d0239130\0572878-sh1-500.dgn		DRAWN - RLA	REVISED -		SCALE: N/A	SHEET NO. 1 OF 1 SHEETS	STA. N/A TO STA. N/A	39	57(2,3,4)PATCHING-1	MCLEAN	16	4
		CHECKED - JMS	REVISED -		CONTRACT NO. 70878							
		DATE - 9/13/10	REVISED -		ILLINOIS FED. AID PROJECT							

# EXISTING TYPICAL SECTION F.A.I. 39

I-39 A-55 INTERCHANGE

TYPICAL I-39 RAMPS AND I-39 MAINLINE WITH AUXILIARY LANE

STA. 41+92.00 I-39 NB TO STA. 110+00.00 I-39 NB

STA. 77+32.00 I-39 SB TO STA. 110+00.00 I-39 SB

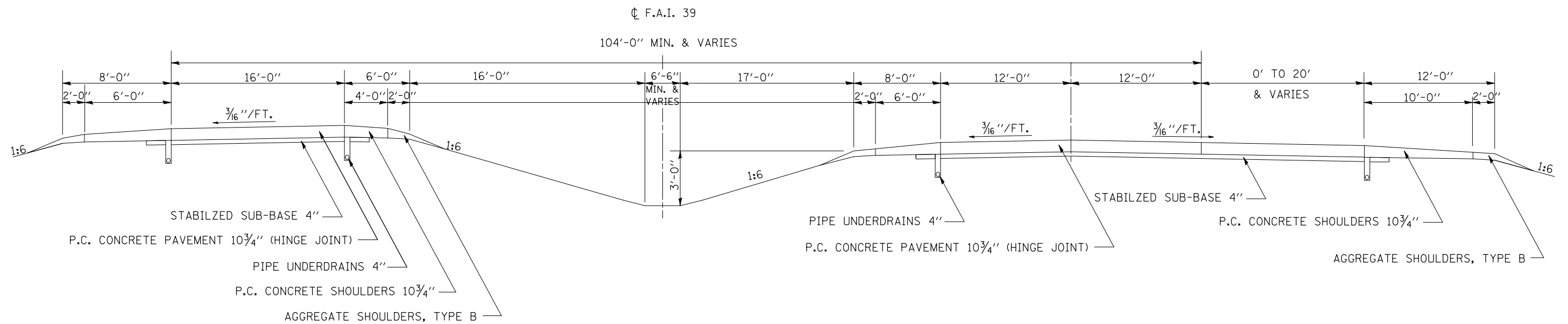

FILE NAME =	USER NAME = bucklesjj	DESIGNED - RLA	REVISED -	<b>STATE OF ILLINOIS DEPARTMENT OF TRANSPORTATION</b>	<b>EXISTING TYPICAL SECTION</b>				F.A.I. RTE. 39	SECTION 57(2,3,4)PATCHING-1	COUNTY MCLEAN	TOTAL SHEETS 16	SHEET NO. 5
ct:\pw\work\p\dot\bucklesjj\d0239130\0570878-sh-typical.dgn		DRAWN - RLA	REVISED -		SCALE: N/A	SHEET NO.	OF SHEETS	STA. N/A	TO STA. N/A	CONTRACT NO. 70878			
		CHECKED - JMS	REVISED -		ILLINOIS FED. AID PROJECT								
		DATE - 9/24-10	REVISED -										

# EXISTING TYPICAL SECTION F.A.I. 39

STA. 110+00.00 TO STA. 144+50.00

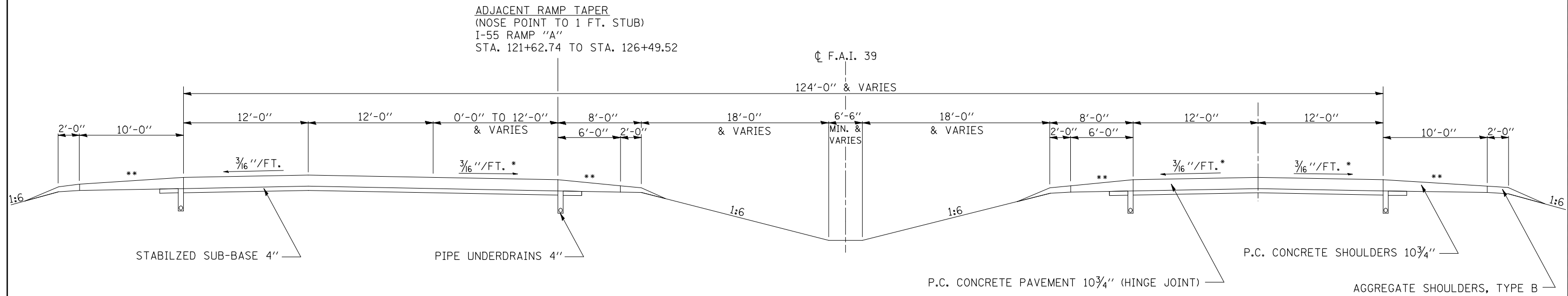

- \* SLOPE VARIES FOR SUPERELEVATION IN CURVES
- \*\* SLOPE VARIES IN SUPERELEVATION WITH MAXIMUM OF 0.08 FT/FT DIFFERENCE

FILE NAME =	USER NAME = bucklesjj	DESIGNED - RLA	REVISED -	<b>STATE OF ILLINOIS DEPARTMENT OF TRANSPORTATION</b>	<b>EXISTING TYPICAL SECTION</b>				F.A.I. RTE. 39	SECTION 57(2,3,4)PATCHING-1	COUNTY MCLEAN	TOTAL SHEETS 16	SHEET NO. 6
ct:\pw\work\p\dot\bucklesjj\d0239130\0570878-sh-t-typico1.dgn		DRAWN - RLA	REVISED -		SCALE: N/A	SHEET NO.	OF SHEETS	STA. N/A	TO STA. N/A	CONTRACT NO. 70878			
		CHECKED - JMS	REVISED -		ILLINOIS FED. AID PROJECT								
		DATE - 9/24-10	REVISED -										

# EXISTING TYPICAL SECTION F.A.I. 39

STA. 144+50.00 TO STA. 235+00.00

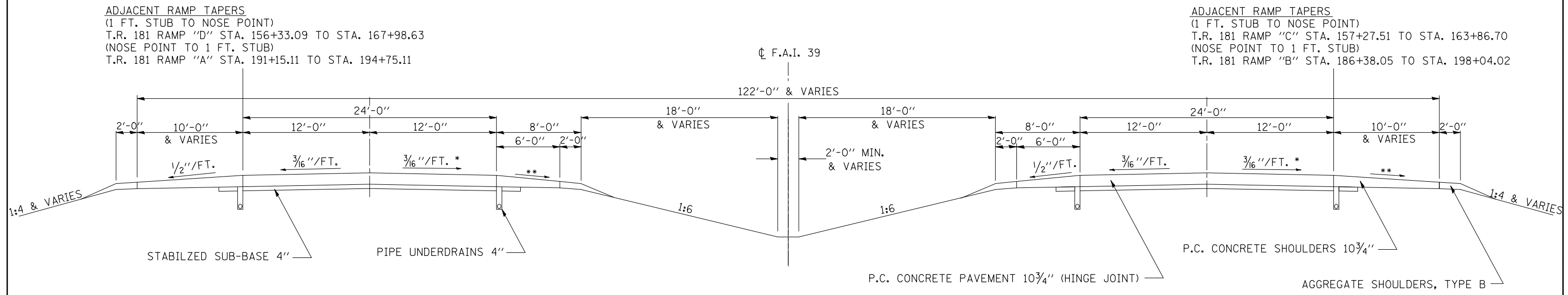

ADJACENT RAMP TAPERS  
 (1 FT. STUB TO NOSE POINT)  
 T.R. 181 RAMP "D" STA. 156+33.09 TO STA. 167+98.63  
 (NOSE POINT TO 1 FT. STUB)  
 T.R. 181 RAMP "A" STA. 191+15.11 TO STA. 194+75.11

ADJACENT RAMP TAPERS  
 (1 FT. STUB TO NOSE POINT)  
 T.R. 181 RAMP "C" STA. 157+27.51 TO STA. 163+86.70  
 (NOSE POINT TO 1 FT. STUB)  
 T.R. 181 RAMP "B" STA. 186+38.05 TO STA. 198+04.02

- \* SLOPE VARIES FOR SUPERELEVATION IN CURVES
- \*\* SLOPE VARIES IN SUPERELEVATION WITH MAXIMUM OF 0.08 FT/FT DIFFERENCE

FILE NAME =	USER NAME = bucklesJJ	DESIGNED - RLA	REVISED -	<b>STATE OF ILLINOIS DEPARTMENT OF TRANSPORTATION</b>	<b>EXISTING TYPICAL SECTION</b>				F.A.I. RTE.	SECTION	COUNTY	TOTAL SHEETS	SHEET NO.
ct:\pw\work\p\dot\bucklesJJ\d0239130\0570878-sh-typical.dgn		DRAWN - RLA	REVISED -		39	57(2,3,4)PATCHING-1	MCLEAN	16	7				
PLOT SCALE = 40.0000' / IN.		CHECKED - JMS	REVISED -		CONTRACT NO. 70878				ILLINOIS FED. AID PROJECT				
PLOT DATE = 10/19/2010		DATE - 9/24-10	REVISED -		SCALE: N/A	SHEET NO. OF SHEETS	STA. N/A TO STA. N/A						

# EXISTING TYPICAL SECTION F.A.I. 39

STA. 235 + 00.00 TO STA. 377 + 24.54

## STATION EQUATION

STA. 377 + 24.54 (BK.) =  
STA. 377 + 00.00 (AH.)

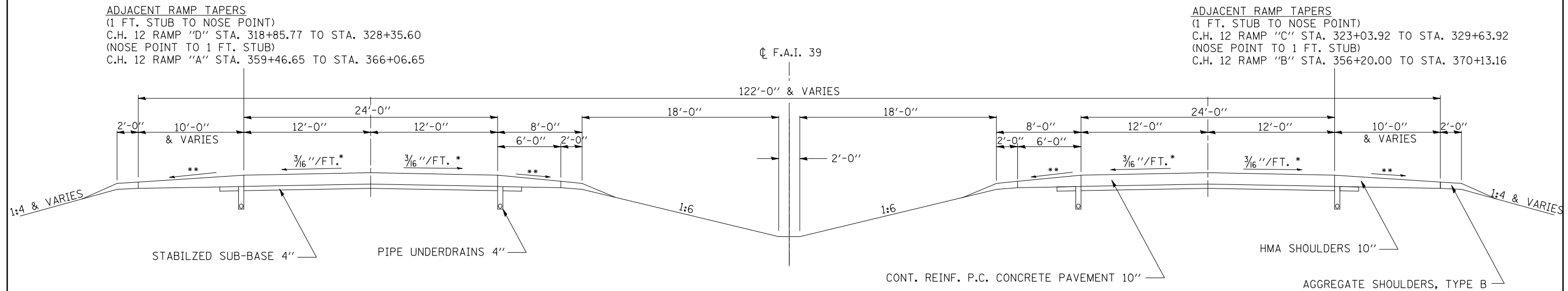

- \* SLOPE VARIES FOR SUPERELEVATION IN CURVES
- \*\* SLOPE VARIES IN SUPERELEVATION WITH MAXIMUM OF 0.08 FT/FT DIFFERENCE

FILE NAME =	USER NAME = bucklesjj	DESIGNED - RLA	REVISED -	<b>STATE OF ILLINOIS DEPARTMENT OF TRANSPORTATION</b>	<b>EXISTING TYPICAL SECTION</b>				F.A.I. RTE.	SECTION	COUNTY	TOTAL SHEETS	SHEET NO.		
ct:\pw\work\p\dot\bucklesjj\d0239130\0570878-shr-typico1.dgn	PLOT SCALE = 40.0000' / IN.	DRAWN - RLA	REVISED -		SCALE: N/A	SHEET NO.	OF	SHEETS	STA. N/A	TO STA. N/A	39	57(2,3,4)PATCHING-1	MCLEAN	16	8
	PLOT DATE = 10/19/2010	CHECKED - JMS	REVISED -						CONTRACT NO. 70878						
		DATE - 9/24-10	REVISED -						ILLINOIS FED. AID PROJECT						



# EXISTING TYPICAL SECTION F.A.I. 39

STA. 377+00.00 TO STA. 511+11.00

## STATION EQUATION

STA. 377+24.54 (BK.) =

STA. 377+00.00 (AH.)

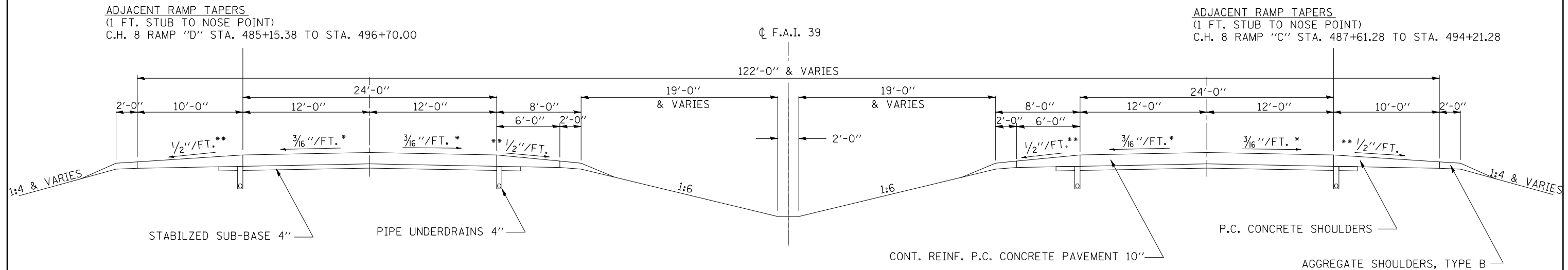

\* SLOPE VARIES FOR SUPERELEVATION IN CURVES

\*\* SLOPE VARIES IN SUPERELEVATION WITH MAXIMUM OF 0.08 FT/FT DIFFERENCE

FILE NAME =	USER NAME = bucklesjj	DESIGNED - RLA	REVISED -
ct:\pw\work\p\dot\bucklesjj\0239130\0570878-shr-typico1.dgn		DRAWN - RLA	REVISED -
	PLOT SCALE = 40.0000' / IN.	CHECKED - JMS	REVISED -
	PLOT DATE = 10/19/2010	DATE - 9/24-10	REVISED -

STATE OF ILLINOIS  
DEPARTMENT OF TRANSPORTATION

EXISTING TYPICAL SECTION

SCALE: N/A SHEET NO. OF SHEETS STA. N/A TO STA. N/A

F.A.I. RTE.	SECTION	COUNTY	TOTAL SHEETS	SHEET NO.
39	57(2,3,4)PATCHING-1	MCLEAN	16	9
CONTRACT NO. 70878				
ILLINOIS FED. AID PROJECT				

# EXISTING TYPICAL SECTION F.A.I. 39

STA. 511+11.00 TO STA. 557+87.88

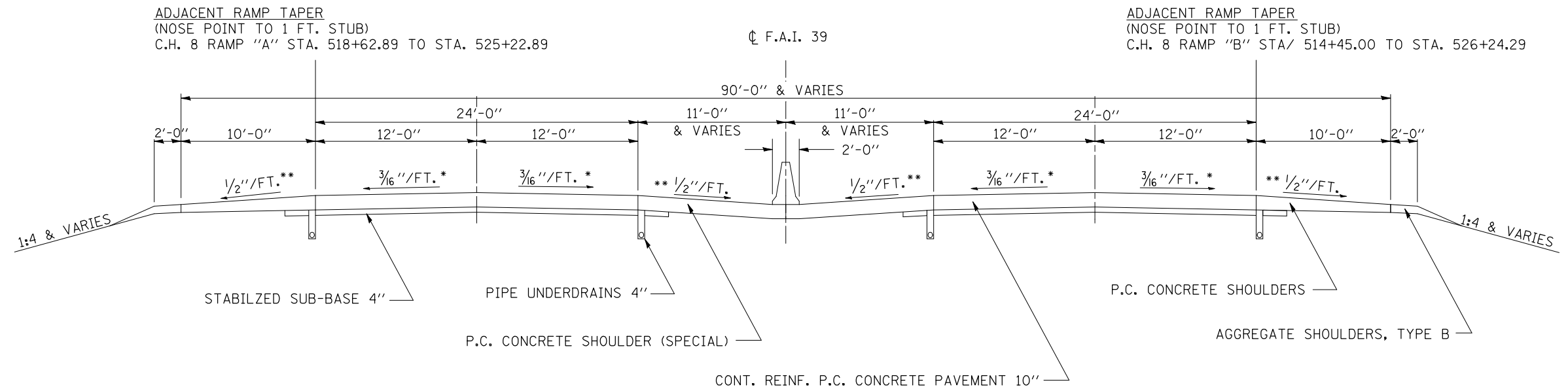

- \* SLOPE VARIES FOR SUPERELEVATION IN CURVES
- \*\* SLOPE VARIES IN SUPERELEVATION WITH MAXIMUM OF 0.08 FT/FT DIFFERENCE

FILE NAME =	USER NAME = bucklesJJ	DESIGNED - RLA	REVISED -	<b>STATE OF ILLINOIS DEPARTMENT OF TRANSPORTATION</b>	<b>EXISTING TYPICAL SECTION</b>				F.A.I. RTE.	SECTION	COUNTY	TOTAL SHEETS	SHEET NO.	
ct:\pw\work\p\dot\bucklesJJ\d0239130\0570878-shr-typico1.dgn	DRAWN - RLA	CHECKED - JMS	REVISED -		SCALE: N/A	SHEET NO.	OF SHEETS	STA. N/A	TO STA. N/A	39	57(2,3,4)PATCHING-1	MCLEAN	16	10
PLOT SCALE = 40.0000 ' / IN.	DATE - 9/24-10	REVIS	REVISED -		CONTRACT NO. 70878									
PLOT DATE = 10/19/2010	REVIS	REVISED -	ILLINOIS FED. AID PROJECT											

**SCHEDULE OF QUANTITIES  
TABULATION OF CLASS A PATCH, 10"  
I-39 MAINLINE (NORTHBOUND)**

STATION	LOCATION	LANE	LENGTH	WIDTH	TYPE I	TYPE II	TYPE III	TYPE IV	SAWCUTS	TIE BARS	PATCHING REINFORCEMENT
			(FT)	(FT)	44200549 (SQ. YD.)	44200553 (SQ. YD.)	44200557 (SQ. YD.)	44200559 (SQ. YD.)	44213200 (FT)	44213208 (EACH)	44213000 (SQ. YD.)
249+00	I-39 MAINLINE	NBDL	6.0	12.0		8.0			60.0		8.0
263+75	I-39 MAINLINE	NBDL	40.0	6.0				26.7	104.0	20.0	26.7
264+50	I-39 MAINLINE	NBDL	40.0	12.0				53.3	128.0	20.0	53.3
272+50	I-39 MAINLINE	NBDL	15.0	6.0		10.0			54.0		10.0
278+00	I-39 MAINLINE	NBDL	6.0	12.0		8.0			60.0		8.0
283+60	I-39 MAINLINE	NBDL	6.0	12.0		8.0			60.0		8.0
286+00	I-39 MAINLINE	NBDL	6.0	12.0		8.0			60.0		8.0
287+50	I-39 MAINLINE	NBDL	6.0	12.0		8.0			60.0		8.0
309+00	I-39 MAINLINE	NBDL	20.0	6.0		13.3			64.0	10.0	13.3
338+00	I-39 MAINLINE	NBDL	20.0	12.0				26.7	88.0	10.0	26.7
341+50	I-39 MAINLINE	NBDL	10.0	12.0		13.3			68.0		13.3
359+40	I-39 MAINLINE	NBDL	6.0	6.0	4.0				36.0		4.0
360+60	I-39 MAINLINE	NBDL	40.0	6.0				26.7	104.0	20.0	26.7
376+30	I-39 MAINLINE	NBDL	12.0	12.0			16.0		72.0		16.0
403+30	I-39 MAINLINE	NBDL	30.0	12.0				40.0	138.0	30.0	40.0
453+00	I-39 MAINLINE	NBDL	15.0	12.0			20.0		93.0		20.0
456+70	I-39 MAINLINE	NBDL	10.0	12.0		13.3			78.0		13.3
472+56	I-39 MAINLINE	NBDL	6.0	12.0		8.0			66.0		8.0
510+20	I-39 MAINLINE	NBDL	6.0	12.0		8.0			66.0		8.0
<b>PAGE SUBTOTALS OF CLASS A PATCH, 10 INCH</b>					<b>4.0</b>	<b>105.9</b>	<b>36.0</b>	<b>173.4</b>	<b>1459.0</b>	<b>110.0</b>	<b>319.3</b>

**SCHEDULE OF QUANTITIES  
TABULATION OF CLASS A PATCH, 10"  
I-39 MAINLINE (SOUTHBOUND)**

STATION	LOCATION	LANE	LENGTH	WIDTH	TYPE I	TYPE II	TYPE III	TYPE IV	SAWCUTS	TIE BARS	PATCHING REINFORCEMENT
			(FT)	(FT)	44200549 (SQ. YD.)	44200553 (SQ. YD.)	44200557 (SQ. YD.)	4400982 (SQ. YD.)	44213200 (FT)	Z0075300 (EACH)	44213000 (SQ. YD.)
237+00	I-39 MAINLINE	SBDL	50.0	6.0				33.3	124.0	25.0	33.3
240+10	I-39 MAINLINE	SBDL	35.0	12.0				46.7	118.0	18.0	46.7
282+90	I-39 MAINLINE	SBDL	15.0	6.0		10.0			54.0		10.0
296+10	I-39 MAINLINE	SBDL	30.0	6.0			20.0		84.0	15.0	20.0
312+60	I-39 MAINLINE	SBDL	45.0	12.0				60.0	138.0	23.0	60.0
326+00	I-39 MAINLINE	SBDL	30.0	6.0			20.0		84.0	15.0	20.0
363+50	I-39 MAINLINE	SBDL	10.0	12.0		13.3			68.0		13.3
386+80	I-39 MAINLINE	SBDL	10.0	12.0		13.3			78.0		13.3
494+75	I-39 MAINLINE	SBDL	15.0	12.0			20.0		93.0		20.0
<b>PAGE SUBTOTALS OF CLASS A PATCH, 10 INCH</b>					<b>0.0</b>	<b>36.6</b>	<b>60.0</b>	<b>140.0</b>	<b>841.0</b>	<b>96.0</b>	<b>236.6</b>

**SCHEDULE OF QUANTITIES  
TABULATION OF CLASS B PATCH, 11"  
I-39 MAINLINE (NORTHBOUND)**

STATION	LOCATION	LANE	LENGTH	WIDTH	TYPE I	TYPE II	TYPE III	TYPE IV	DOWEL BARS	SAWCUTS	TIE BARS	PAVEMENT FABRIC
			(FT)	(FT)	44200978 (SQ. YD.)	44200982 (SQ. YD.)	44200986 (SQ. YD.)	44200988 (SQ. YD.)	44201299 (EACH)	44213200 (FT)	44213208 (EACH)	44213100 (SQ. YD.)
103+00	I-39 MAINLINE	NBDL	30.0	12.0				40.0	30.0	126.0	30.0	40.0
108+50	I-39 MAINLINE	NBDL	6.0	12.0		8.0			20.0	54.0		
118+00	I-39 MAINLINE	NBDL	6.0	12.0		8.0			20.0	54.0		
156+25	I-39 MAINLINE	NBDL	10.0	12.0		13.3			20.0	66.0		
187+75	I-39 MAINLINE	NBDL	6.0	12.0		8.0			20.0	54.0		
211+85	I-39 MAINLINE	NBDL	6.0	12.0		8.0			20.0	54.0		
235+70	I-39 MAINLINE	NBDL	30.0	12.0				40.0	30.0	126.0	30.0	40.0
<b>PAGE SUBTOTALS OF CLASS B PATCH, 11 INCH</b>					<b>0.0</b>	<b>45.3</b>		<b>80.0</b>	<b>160.0</b>	<b>534.0</b>	<b>60.0</b>	<b>80.0</b>

**SCHEDULE OF QUANTITIES  
TABULATION OF CLASS B PATCH, 11"  
I-39 MAINLINE (SOUTHBOUND)**

STATION	LOCATION	LANE	LENGTH	WIDTH	TYPE I	TYPE II	TYPE III	TYPE IV	DOWEL BARS	SAWCUTS	TIE BARS	PAVEMENT FABRIC
			(FT)	(FT)	44200978 (SQ. YD.)	44200982 (SQ. YD.)	44200986 (SQ. YD.)	44200988 (SQ. YD.)	44201299 (EACH)	44213200 (FT)	44213208 (EACH)	44213100 (SQ. YD.)
107+00	I-39 MAINLINE	SBDL	6.0	12.0		8.0			20.0	54.0		
110+00	I-39 MAINLINE	SBDL	6.0	12.0		8.0			20.0	54.0		
113+00	I-39 MAINLINE	SBDL	6.0	12.0		8.0			20.0	54.0		
137+00	I-39 MAINLINE	SBDL	6.0	12.0		8.0			20.0	54.0		
149+00	I-39 MAINLINE	SBDL	6.0	12.0		8.0			20.0	54.0		
192+50	I-39 MAINLINE	SBDL	6.0	12.0		8.0			20.0	54.0		
211+00	I-39 MAINLINE	SBDL	6.0	12.0		8.0			20.0	54.0		
234+30	I-39 MAINLINE	SBDL	6.0	12.0		8.0			20.0	54.0		
235+00	I-39 MAINLINE	SBDL	15.0	12.0			20.0		20.0	81.0		20.0
<b>PAGE SUBTOTALS OF CLASS A PATCH, 11 INCH</b>					0.0	64.0	20.0	0.0	180.0	513.0	0.0	20.0

**SCHEDULE OF QUANTITIES  
TABULATION OF CLASS A & B PATCHES**

CLASS A PATCH, 10" TOTALS	TYPE I	TYPE II	TYPE III	TYPE IV	SAWCUTS	TIE BARS	PATCHING REINFORCEMENT
	<b>44200549</b> (SQ. YD.)	<b>44200553</b> (SQ. YD.)	<b>44200557</b> (SQ. YD.)	<b>44200559</b> (SQ. YD.)	<b>44213200</b> (FT)	<b>44213208</b> (EACH)	<b>44213000</b> (SQ. YD.)
<b>NORTHBOUND</b>	<b>4.0</b>	<b>106.0</b>	<b>36.0</b>	<b>173.0</b>	<b>1459.0</b>	<b>110.0</b>	<b>319.0</b>
<b>SOUTHBOUND</b>	<b>0.0</b>	<b>37.0</b>	<b>60.0</b>	<b>140.0</b>	<b>841.0</b>	<b>96.0</b>	<b>237.0</b>
<b>TOTAL</b>	<b>4.0</b>	<b>143.0</b>	<b>96.0</b>	<b>313.0</b>	<b>2300.0</b>	<b>206.0</b>	<b>556.0</b>

CLASS B PATCH, 11" TOTALS	TYPE I	TYPE II	TYPE III	TYPE IV	SAWCUTS	TIE BARS	DOWEL BARS	PAVEMENT FABRIC
	<b>44200978</b> (SQ. YD.)	<b>44200982</b> (SQ. YD.)	<b>44200986</b> (SQ. YD.)	<b>44200988</b> (SQ. YD.)	<b>44213200</b> (FT)	<b>44213208</b> (EACH)	<b>44201299</b> (EACH)	<b>44213100</b> (SQ. YD.)
<b>NORTHBOUND</b>	<b>0.0</b>	<b>46.0</b>	<b>0.0</b>	<b>80.0</b>	<b>534.0</b>	<b>60.0</b>	<b>140.0</b>	<b>80.0</b>
<b>SOUTHBOUND</b>	<b>0.0</b>	<b>64.0</b>	<b>20.0</b>	<b>0.0</b>	<b>513.0</b>	<b>0.0</b>	<b>180.0</b>	<b>20.0</b>
<b>TOTAL</b>	<b>0.0</b>	<b>110.0</b>	<b>20.0</b>	<b>80.0</b>	<b>1047.0</b>	<b>60.0</b>	<b>320.0</b>	<b>100.0</b>

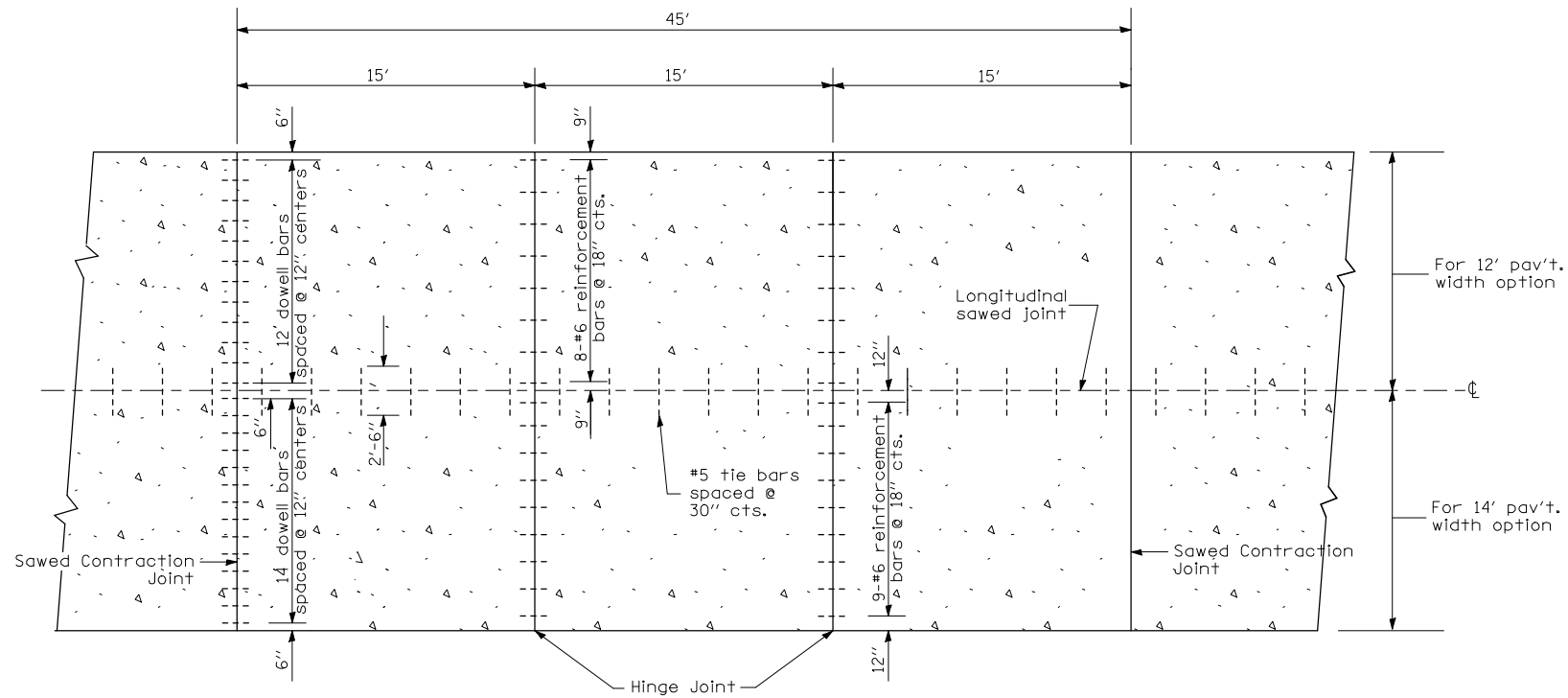

**PLAN**  
**EXISTING JOINTED PORTLAND CEMENT CONCRETE PAVEMENT**

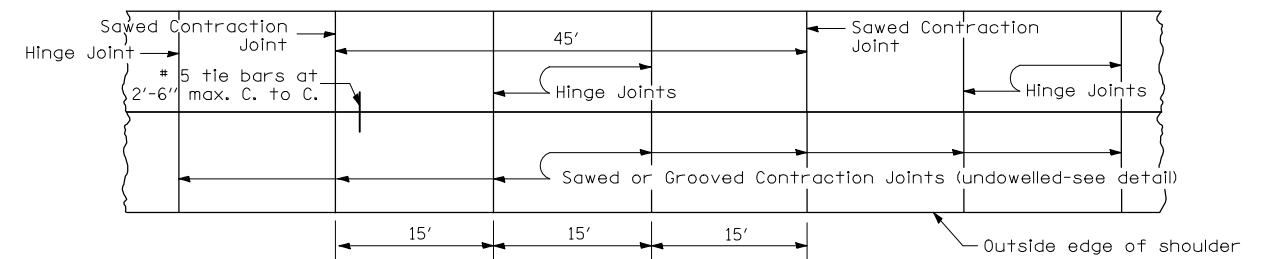

**PLAN**  
**TYPICAL P.C.C. PAVED SHOULDER ADJACENT TO JOINTED PAVEMENT**

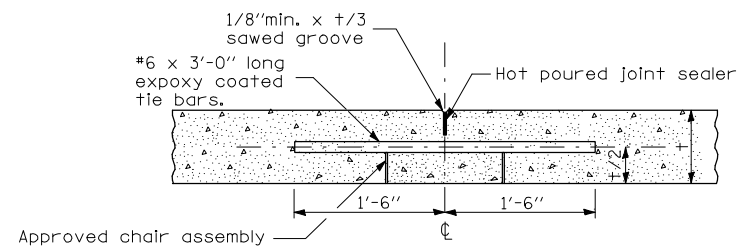

**DETAIL OF HINGE JOINT**

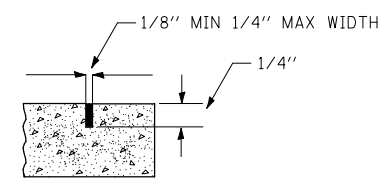

**DETAIL OF**  
**Sawed or Grooved**  
**Contraction Joint**  
**For**  
**TYPICAL P.C.C. PAVED SHOULDER**

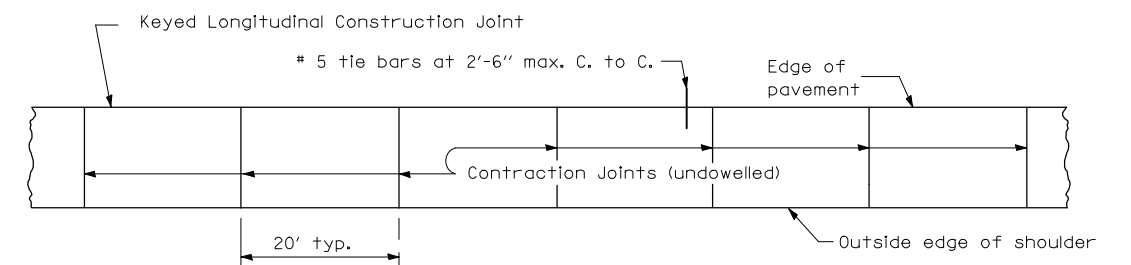

**PLAN**  
**TYPICAL P.C.C. PAVED SHOULDER ADJACENT TO CONTINUOUSLY REINFORCED PAVEMENT**

**GENERAL NOTE**

#4 tie bars may be used when the pavement is less than 9" thick.

FILE NAME =	USER NAME = bucklesjj	DESIGNED -	REVISED -
ct:\pw_work\pwwork\backlesjj\d0239130\N570878-sht-details.dgn		DRAWN -	REVISED -
PLOT SCALE = 40.0000' / IN.		CHECKED -	REVISED -
PLOT DATE = 10/19/2010		DATE -	REVISED -

**STATE OF ILLINOIS**  
**DEPARTMENT OF TRANSPORTATION**

**DETAILS OF EXISTING JOINTED P.C.C. PAVEMENT (HINGE-JOINTED)**  
**AND ADJACENT P.C.C. SHOULDER**

SCALE: N/A SHEET NO. 1 OF 1 SHEETS STA. N/A TO STA. N/A

F.A.I. RTE.	SECTION	COUNTY	TOTAL SHEETS	SHEET NO.
39	57(2,3,4)PATCHING-1	MCLEAN	16	16
CONTRACT NO. 70878			ILLINOIS FED. AID PROJECT	