

SEC 24, T15N, R11W, 3RD PM

F.A. RTE.	SECTION	COUNTY	TOTAL SHEETS	SHEET NO.
8173	(69-HB)BR	MORGAN	63	23
STA. 91+00		TO STA. 97+00		
FED. ROAD DIST. NO.		ILLINOIS FED. AID PROJECT		
CONTRACT NO. 72837				

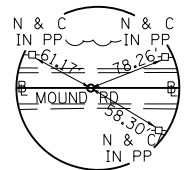

POT STA 94+96.13
P.K. & CAP IN CHIS "X"

PLAN	DATE
SURVEYED	
PLOTTED	
CHECKED	
BY	
NO. OF WAY CHECKED	
CADD FILE NAME	

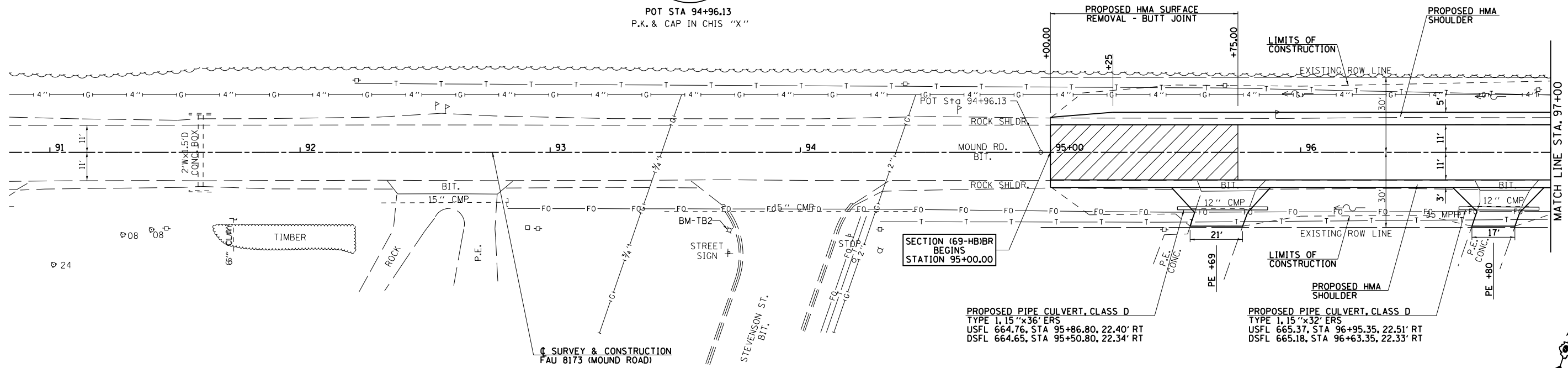

SECTION (69-HB)BR
BEGINS
STATION 95+00.00

PROPOSED PIPE CULVERT, CLASS D
TYPE 1, 15"x36" ERS
USFL 664.76, STA 95+86.80, 22.40' RT
DSFL 664.65, STA 95+50.80, 22.34' RT

PROPOSED PIPE CULVERT, CLASS D
TYPE 1, 15"x32" ERS
USFL 665.37, STA 96+95.35, 22.51' RT
DSFL 665.18, STA 96+63.35, 22.33' RT

SEC 25, T15N, R11W, 3RD PM

PROFILE	DATE
SURVEYED	
PLOTTED	
CHECKED	
BY	
NO. OF WAY CHECKED	
STRUCTURE NOTATIONS CHKD	

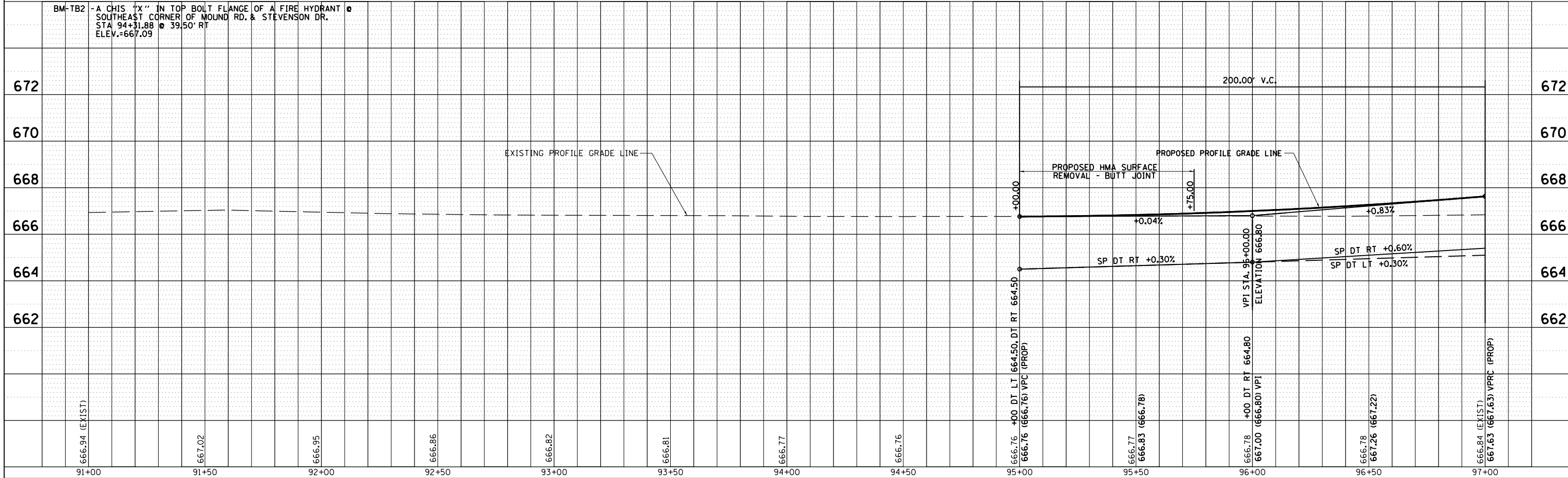

FAU 8173 (MOUND ROAD) ROADWAY PLAN & PROFILE, STA 91+00 TO STA 97+00