

Notes:
See sheet 19B of 27 for Sections C-C & D-D and View E-E.
 $a_{10}(E)$, $a_{11}(E)$, $c_{10}(E)$ and $c_{11}(E)$ bar spacings measured along \varnothing Rdwy.

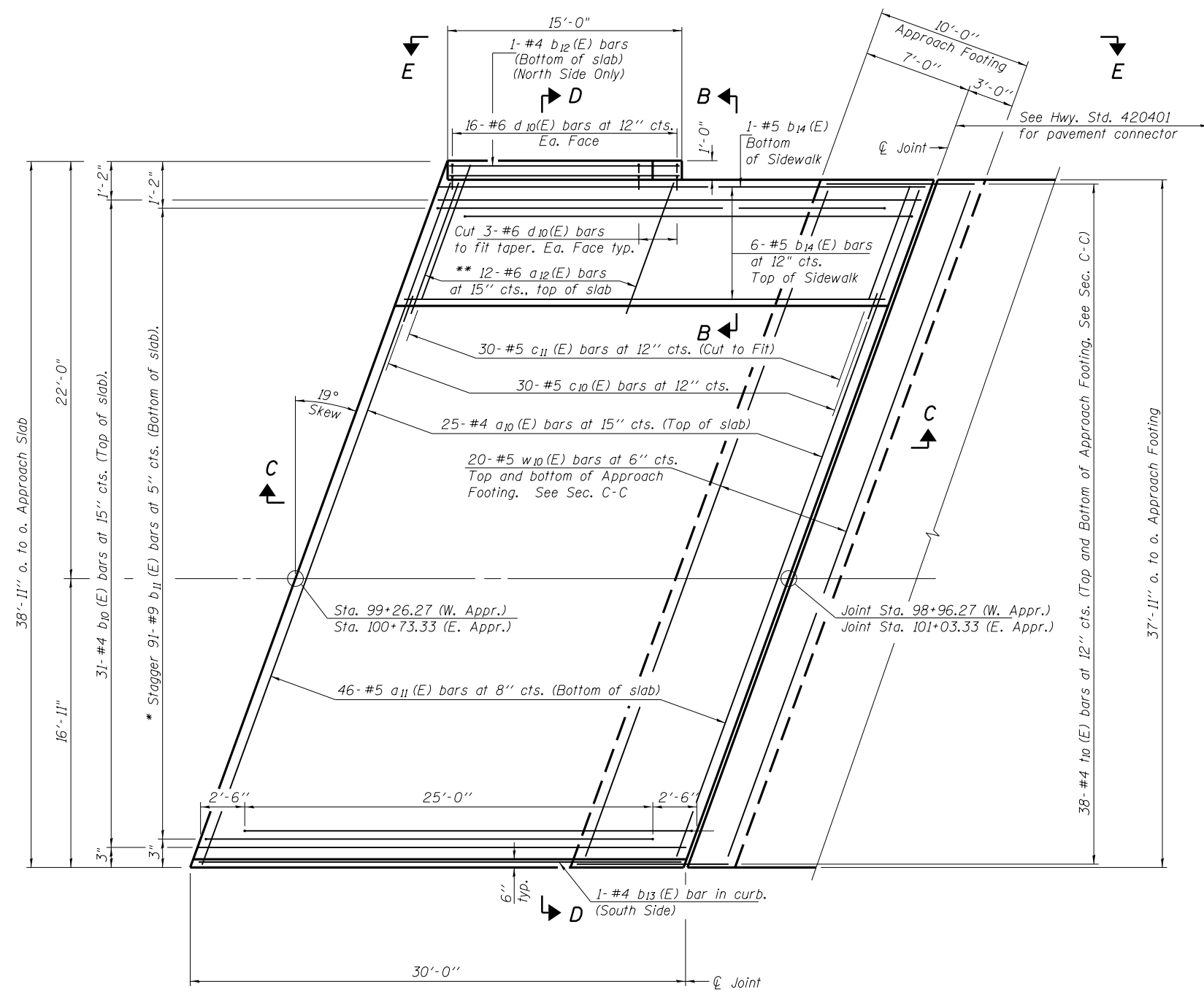

PLAN

(East Approach shown, West Approach Similar)

- * Tilt #9 $b_{11}(E)$ bars as required to maintain clearance.
- ** Space between $a_{10}(E)$ bars at parapet.

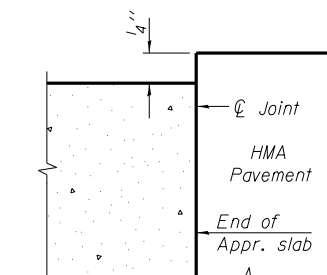

FLEXIBLE PAVEMENT

DETAIL A

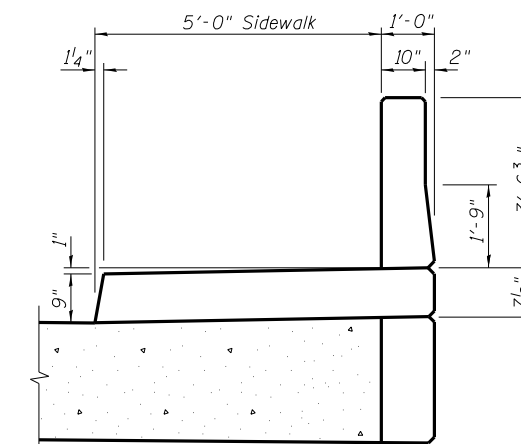

VIEW B-B

DESIGNED	BAN
CHECKED	JOH
DRAWN	TAC
CHECKED	BAN

(Sheet 1 of 2)

BRIDGE APPROACH SLAB DETAILS
MOUND ROAD (FAU ROUTE 8173)
OVER ILLINOIS ROUTE 104
SECTION (69-HB)BR
MORGAN COUNTY
STATION 100+00.00
STRUCTURE NO. 069-0521

HU CHISON ENGINEERING, INC.
 JACKSONVILLE, ILLINOIS
 Date: 12/21/07