

3:59:44 PM

10/28/2010

P:\09f\iles\090044\Work Order 1 (IL 9 over LaHarpe Creek)\CADD Sheets\0672B05-sht-Cover.dgn

STATE OF ILLINOIS
DEPARTMENT OF TRANSPORTATION
DIVISION OF HIGHWAYS

PROPOSED
HIGHWAY PLANS

FAP ROUTE 685 (IL 9)
SECTION (117, 118) RS-4, 119 RS-1; 118 B-1
PROJECT; ACF - 0685(031)
STRUCTURE RECONSTRUCTION & PAVING
HANCOCK COUNTY

F.A.P. RTE.	SECTION	COUNTY	TOTAL SHEETS	SHEET NO.
685	(117,118)RS-4,119RS-1;118B-1	HANCOCK	101	1
FED. ROAD DIST. NO. 6		ILLINOIS	CONTRACT NO. 72B05	

D-96-532-07

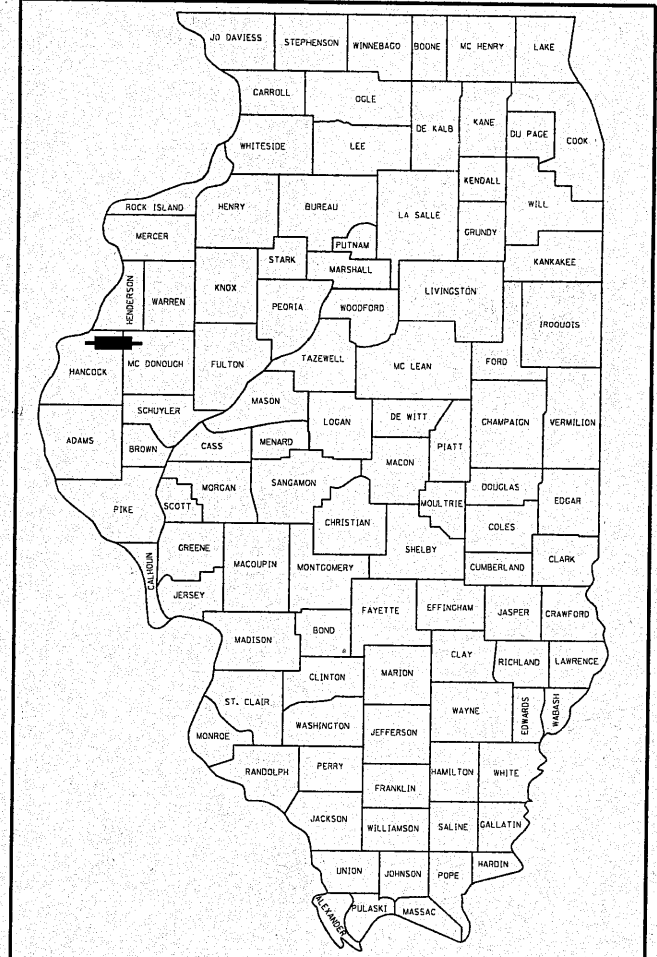

LOCATION OF SECTION INDICATED THUS: - [black bar] -

STATE OF ILLINOIS
DEPARTMENT OF TRANSPORTATION
DIVISION OF HIGHWAYS

SUBMITTED *November 3, 2010*
Rep. 2 Draft
DEPUTY DIRECTOR OF HIGHWAYS, REGION ENGINEER

Dec 10, 2010
Scott E. Stitt, P.E.
ENGINEER OF DESIGN AND ENVIRONMENT

Dec 10, 2010
Christine M. Reeder
DIRECTOR OF HIGHWAYS, CHIEF ENGINEER

PLANS PREPARED BY:
KLINGNER & ASSOCIATES, P.C.
Engineers • Architects • Surveyors

606 North 24th Street, Quincy, IL 62450
4510 Perry Gravel Road, Hannibal, MO 63450
618 N. 4th Street, Suite 100, Burlington, IA 52601
49 North Prairie Street, Galena, IL 62421

Ph: (217) 223-3670 - Fax: (217) 223-3683
Ph: (573) 721-9920 - Fax: (573) 221-0912
Ph: (319) 752-1636 - Fax: (319) 752-3625
Ph: (309) 342-4842 - Fax: (309) 341-1181

Internet Address: www.klingner.com

STATE OF ILLINOIS DESIGN FIRM # 1842738

PRINTED BY THE AUTHORITY OF THE STATE OF ILLINOIS

FOR INDEX OF SHEETS, AND HIGHWAY STANDARDS SEE SHEET NO. 2

DESIGN DESIGNATION:
FAP 695
MINOR ARTERIAL (NON-URBAN)
ADT = 2150 (2027) 1750 (2009)
%SU = 8
%MU = 5

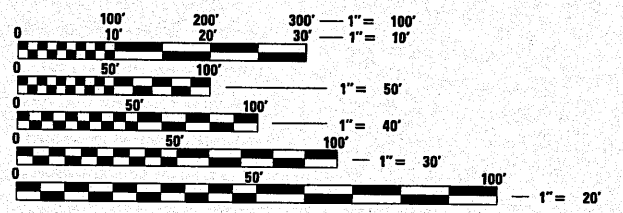

FULL SIZE PLANS HAVE BEEN PREPARED USING STANDARD ENGINEERING SCALES. REDUCED SIZED PLANS WILL NOT CONFORM TO STANDARD SCALES. IN MAKING MEASUREMENTS ON REDUCED PLANS, THE ABOVE SCALES MAY BE USED.

J.U.L.I.E.
JOINT UTILITY LOCATION INFORMATION FOR EXCAVATION
1-800-892-0123
OR 811

PROJECT ENGINEER: JOHN NEGANGARD (217) 782-6990
TEAM ENGINEER: MARK DUST (217) 785-0597

CONTRACT NO. 72B05

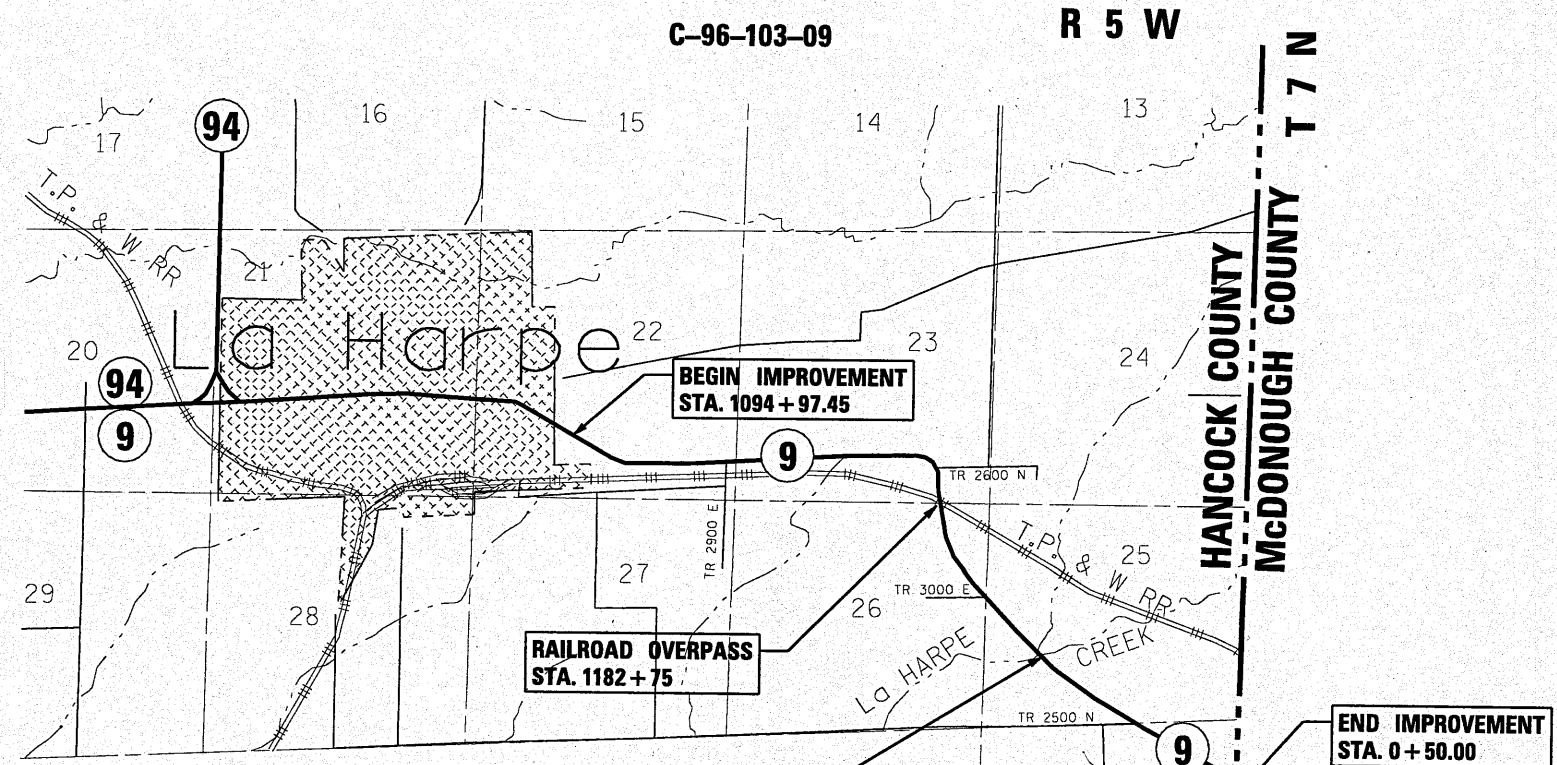

STA. 1219 + 54.00
PROPOSED S.N. 034-0528
104'-0" BK TO BK ABUTMENTS
44" WEB PLATE GIRDER (COMPOSITE)
1 SPAN OVER LAHARPE CREEK

STATION EQUATION:
STA. 1262 + 55.89 AH =
STA. 1263 + 31.52 AH

STATION EQUATION:
STA. 1269 + 77.10 BK =
STA. 0 + 00.00 AH

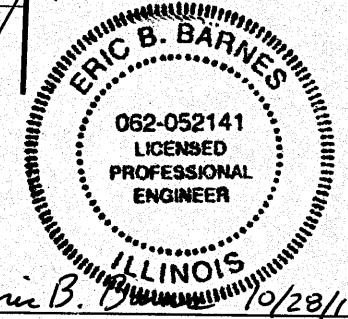

Eric B. Barnes 10/28/10
ERIC B. BARNES DATE
REGISTERED PROFESSIONAL ENGINEER
STATE OF ILLINOIS NO. 062-052141
LICENSE EXPIRES NOVEMBER 30, 2011

LOCATION MAP
SCALE: 1" = 2000'
GROSS/NET LENGTH OF SECTION = 17,454.02 FT = 3.306 MILES