 PCC SURFACE REMOVAL (BUTT JOINT)
 HOT-MIX ASPHALT SURFACE REMOVAL (BUTT JOINT)

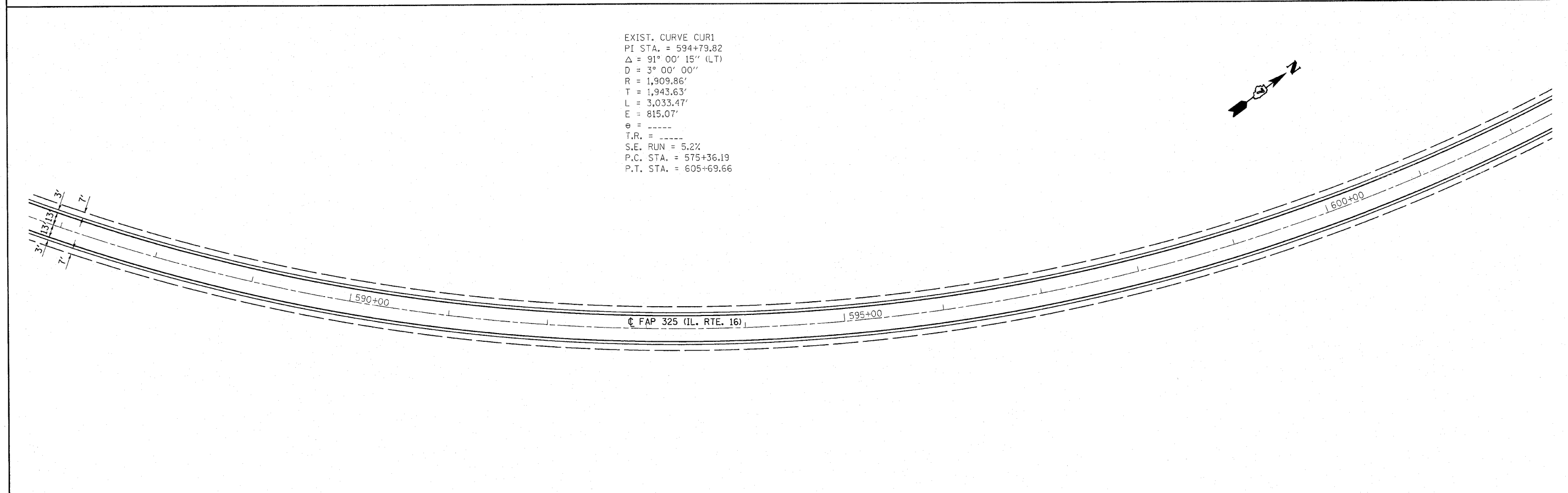

EXIST. CURVE CUR1
 PI STA. = 594+79.82
 $\Delta = 91^\circ 00' 15''$ (LT)
 $D = 3^\circ 00' 00''$
 $R = 1,909.86'$
 $T = 1,943.63'$
 $L = 3,033.47'$
 $E = 815.07'$
 $e = \text{-----}$
 $T.R. = \text{-----}$
 $S.E. \text{ RUN} = 5.2\%$
 $P.C. \text{ STA.} = 575+36.19$
 $P.T. \text{ STA.} = 605+69.66$

FILE NAME = c:\pwork\pwork\swartzr\40186245\077	USER NAME = swartzr	DESIGNED -	REVISED -	STATE OF ILLINOIS DEPARTMENT OF TRANSPORTATION	PLAN SHEET		F.A.P. RTE. 325	SECTION 9RS-2, 10RS-4	COUNTY SHELBY	TOTAL SHEETS 46	SHEET NO. 17
	PLOT SCALE = 50,0000' / IN.	CHECKED -	REVISED -		REVISED -	SCALE: 50	SHEET NO. 1 OF 17 SHEETS	STA. 572+00 TO STA. 602+00	CONTRACT NO. 74460		ILLINOIS FED. AID PROJECT
PLOT DATE = 10/22/2010	DATE -	REVISED -	REVISED -								