

STATE OF ILLINOIS  
DEPARTMENT OF TRANSPORTATION  
DIVISION OF HIGHWAYS

**PROPOSED  
HIGHWAY PLANS**

FAI ROUTE 70 PROJECT: HSIP-070-2(234)044  
SECTION 3-(3,4,5)-1  
MISCELLANEOUS STRIPING  
BOND COUNTY

C-98-006-11

F.A.I. RTE.	SECTION	COUNTY	TOTAL SHEETS	SHEET NO.
70	3-(3,4,5)-1	BOND	16	1
		ILLINOIS	CONTRACT NO. 76E53	

D-88-009-11

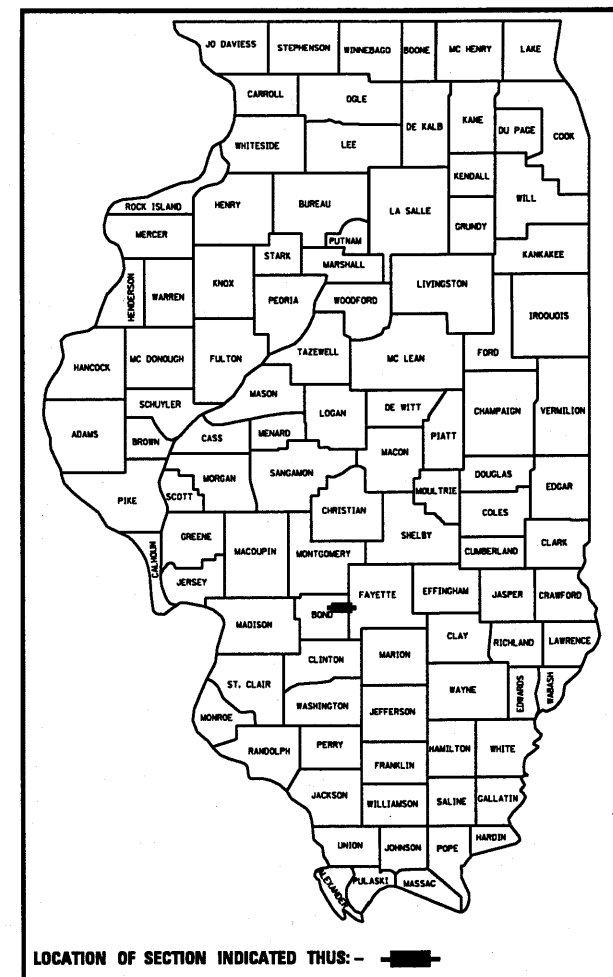

FOR INDEX OF SHEETS, SEE SHEET NO. 2

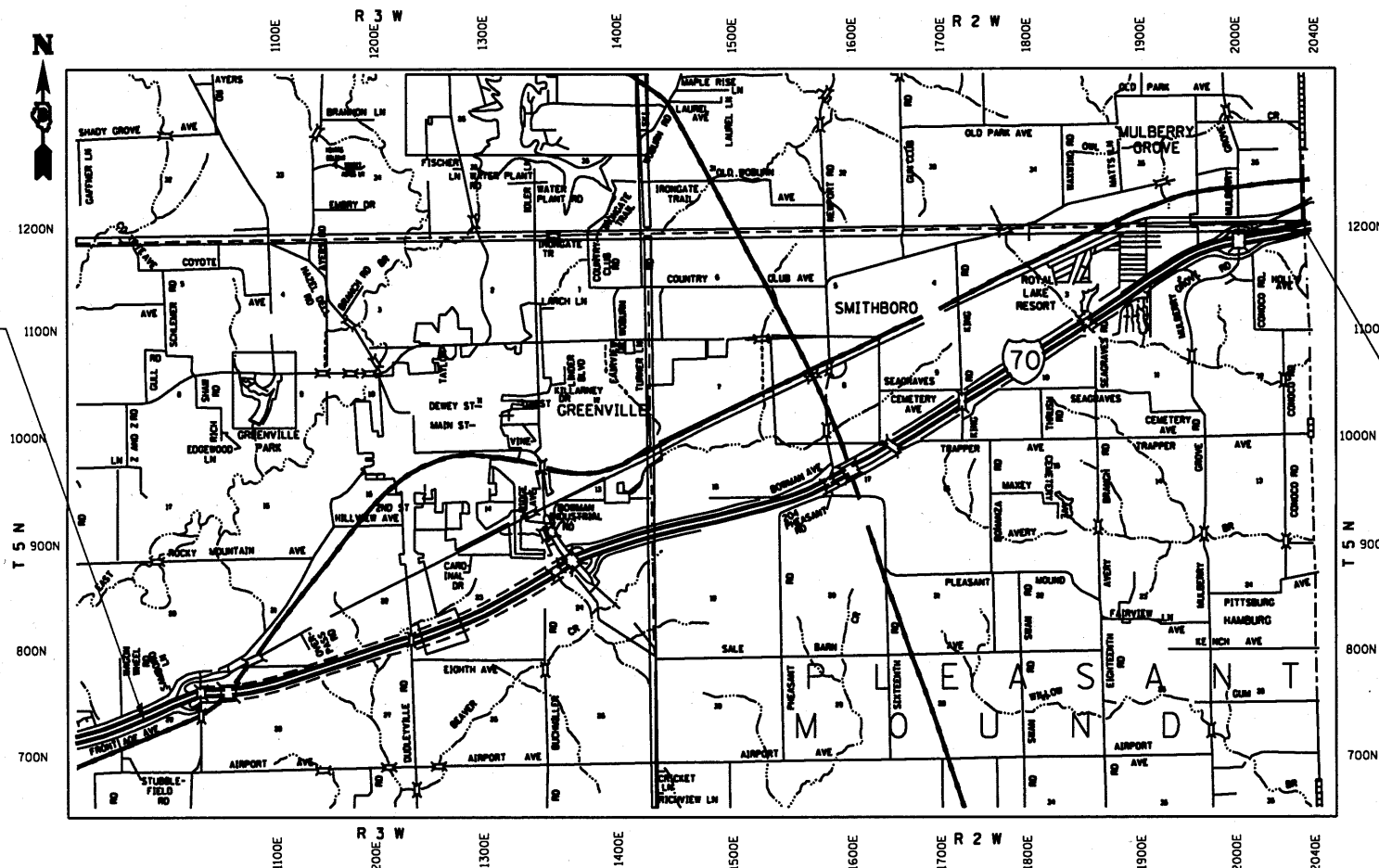

BEGIN PROJECT  
STA. 2330+00  
LAT. 38°50'60"N  
LONG. 89°27'47"W

END PROJECT  
STA. 3033+65  
LAT. 38°54'58"N  
LONG. 89°15'23"W

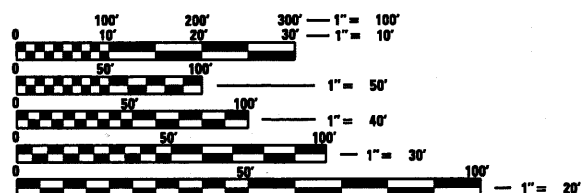

FULL SIZE PLANS HAVE BEEN PREPARED USING STANDARD ENGINEERING SCALES. REDUCED SIZED PLANS WILL NOT CONFORM TO STANDARD SCALES. IN MAKING MEASUREMENTS ON REDUCED PLANS, THE ABOVE SCALES MAY BE USED.

J.U.L.I.E.  
JOINT UTILITY LOCATION INFORMATION FOR EXCAVATION  
1-800-892-0123  
OR 811

PROJECT ENGINEER: TIM PADGETT (618) 346-3325  
PROJECT MANAGER: JEFF ABEL (618) 346-3283

CONTRACT NO. 76E53

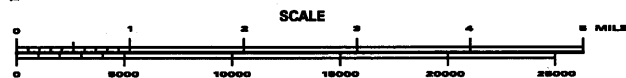

GROSS LENGTH = 70,365 FT. = 13.327 MILE  
NET LENGTH = 70,365 FT. = 13.327 MILE

STATE OF ILLINOIS  
DEPARTMENT OF TRANSPORTATION  
DIVISION OF HIGHWAYS

SUBMITTED 10/24 2010  
Mary Ramie  
DEPUTY DIRECTOR OF HIGHWAYS, REGION ENGINEER

Dec 10 2010  
Scott E. Stett, P.E.  
Acting ENGINEER OF DESIGN AND ENVIRONMENT

Dec 10 2010  
Christine M. Reed  
DIRECTOR OF HIGHWAYS, CHIEF ENGINEER

**PRINTED BY THE AUTHORITY  
OF THE STATE OF ILLINOIS**

GENERAL NOTES:

1. UTILITY INTERFERENCE IS NOT ANTICIPATED ON THIS CONTRACT. SHOULD THIS PROVE OTHERWISE DURING THE IMPLEMENTATION OF THE CONTRACT, NO ADDITIONAL COMPENSATION SHALL BE DUE THE CONTRACTOR AS A RESULT. THE CONTRACTOR IS REMINDED THAT JULIE MUST BE CONTACTED TO LOCATE ANY AND ALL UTILITIES WITHIN THE PROJECT LIMITS. THE JOINT UTILITY LOCATING INFORMATION FOR EXCAVATORS (JULIE) SYSTEM PHONE NUMBER IS (800) 892-0123.
2. THE CONTRACTOR SHALL VERIFY ALL DIMENSIONS AND CONDITIONS IN THE FIELD PRIOR TO CONSTRUCTION AND ORDERING MATERIALS.
3. PROPER ADHESIVE (P-50) SHALL BE APPLIED TO THE GROOVED SURFACE PRIOR TO THE INSTALLATION OF THE PAVEMENT MARKING TAPE.
4. ADDITIONAL PAVEMENT MARKING REMOVAL REQUIRED ADJACENT TO THE PROPOSED GROOVING AS REQUIRED BY THE RESIDENT ENGINEER SHALL NOT BE PAID FOR SEPARATELY BUT SHALL BE INCLUDED IN THE COST OF THE GROOVING FOR RECESSED PAVEMENT MARKING PAY ITEMS.
5. PROPOSED PAVEMENT MARKINGS SHALL BE PLACED AT THE CURRENT LOCATIONS OF THE EXISTING PAVEMENT MARKINGS THROUGHOUT THE PROJECT LIMITS EXCEPT WHERE EXISTING MARKINGS FALL ON A JOINT OR SHOULDER. IN THIS CASE, EXISTING MARKINGS SHALL REMAIN IN PLACE AND NEW MARKINGS SHALL BE PLACED IN PROPER LOCATION. IN NO CASE SHALL NEW MARKING BE PLACED WITHIN 2 INCHES OF AN EXISTING JOINT.

INDEX OF SHEETS

- 1 COVER SHEET
- 2 INDEX OF SHEETS, STANDARDS, GENERAL NOTES
- 3 SUMMARY OF QUANTITIES
- 4 SCHEDULES
- 5-16 PLAN SHEETS

TRAFFIC CONTROL:

1. TRAFFIC CONTROL DEVICES MAY BE SKID MOUNTED.
2. FLAGMEN SHALL BE PRESENT DURING ALL CLOSURE HOURS, INCLUDING LUNCH HOUR, AND NO ADDITIONAL COMPENSATION SHALL BE ALLOWED.

COMMITMENTS:

NONE.

STANDARDS:

701426-04  
 780001-02  
 701101-02  
 701901-01

FILE NAME *	USER NAME * alfords	DESIGNED -	REVISED -	<b>STATE OF ILLINOIS DEPARTMENT OF TRANSPORTATION</b>	<b>GENERAL NOTES, INDEX OF SHEETS, COMMITMENTS AND STANDARDS</b>	F.A.I. RTE.	SECTION	COUNTY	TOTAL SHEETS	SHEET NO.	
ci:\pwork\pwork\alfords\8232415\87653-aht-plan.dgn		DRAWN -	REVISED -			70	3-(3,4,5)-1	BOND	16	2	
PLOT SCALE = 183.6465' / IN.		CHECKED -	REVISED -			<b>CONTRACT NO. 7653</b>					
PLOT DATE = 10/28/2018		DATE -	REVISED -			SCALE:	SHEET NO.	OF	SHEETS	STA.	TO STA.

# SUMMARY OF QUANTITIES

SUMMARY OF QUANTITIES			90% FED. 10% STATE TOTAL QUANTITIES	BOND COUNTY 0021	CONSTRUCTION TYPE CODE	
CODE NO	ITEM	UNIT				
67100100	MOBILIZATION	L SUM	1	1		
78003130	PREFORMED PLASTIC PAVEMENT MARKING, TYPE B - LINE 6"	FOOT	299235	299235		
78003140	PREFORMED PLASTIC PAVEMENT MARKING, TYPE B - LINE 8"	FOOT	6015	6015		
X7830074	GROOVING FOR RECESSED PAVEMENT MARKING 7"	FOOT	299235	299235		
X7830076	GROOVING FOR RECESSED PAVEMENT MARKING 9"	FOOT	6015	6015		

**CONTRACT NO. 7653**

PREFORMED PLASTIC PAVEMENT MARKING T-B LINE 8 INCH				
Sta.	TO	Sta.	GRV RCSD PVT MRKG 9"	WHITE GORE LINE
			(FOOT)	(FOOT)
SOLID WHITE				
2385+40	TO	2389+10 Rt.	740	740
2387+40	TO	2388+25 Lt.	85	85
2397+60	TO	2401+70 Lt.	820	820
2398+35	TO	2399+00 Rt.	65	65
2631+85	TO	2636+55 Rt.	940	940
2633+05	TO	2634+70 Lt.	165	165
2643+75	TO	2648+00 Lt.	850	850
2644+85	TO	2648+40 Rt.	355	355
2988+00	TO	2991+55 Rt.	710	710
2996+05	TO	2997+35 Lt.	130	130
3012+15	TO	3015+90 Lt.	750	750
3013+35	TO	3014+00 Rt.	65	65
SKIP DASH				
2386+00 Lt.			60	60
2400+00 Rt.			40	40
2633+00 Lt.			60	60
2649+00 Rt.			80	80
2996+00 Lt.			60	60
3014+00 Rt.			40	40
TOTAL:			6015	6015

PREFORMED PLASTIC PAVEMENT MARKING T-B LINE 6 INCH				
Sta.	TO	Sta.	GRV RCSD PVT MRKG 7"	WHITE GORE LINE
			(FOOT)	(FOOT)
SOLID YELLOW EDGE				
2330+00	TO	2470+71.56 L/R	28,143.10	28,143.10
2500+00	TO	3033+65 L/R	106,730	106,730
WHITE SKP DASH				
2330+00	TO	2470+71.56 L/R	7,035.78	7,035.78
2500+00	TO	3033+65 L/R	26,682.50	26,682.50
SOLID WHITE EDGE				
2330+00	TO	2382+45 L/R	10,490	10,490
2382+45	TO	2389+10 Lt.	665	665
2389+10	TO	2397+60 L/R	1,700	1,700
2397+60	TO	2404+35 Rt.	675	675
2404+35	TO	2470+71.56 L/R	13,273.10	13,273.10
2500+00	TO	2628+80 L/R	25,760	25,760
2628+80	TO	2636+55 Lt.	775	775
2636+55	TO	2643+75 L/R	1,440	1,440
2643+75	TO	2651+15 Rt.	740	740
2651+15	TO	2985+70 L/R	66,910	66,910
2985+70	TO	2991+55 Lt.	585	585
2991+55	TO	2996+05 L/R	900	900
2996+05	TO	2996+80 Rt.	75	75
2996+80	TO	3012+15 L/R	3,070	3,070
3012+15	TO	3013+35 Rt.	120	120
3014+00	TO	3018+65 Rt.	465	465
3018+65	TO	3033+65 L/R	3,000	3,000
TOTAL:			299234	299234

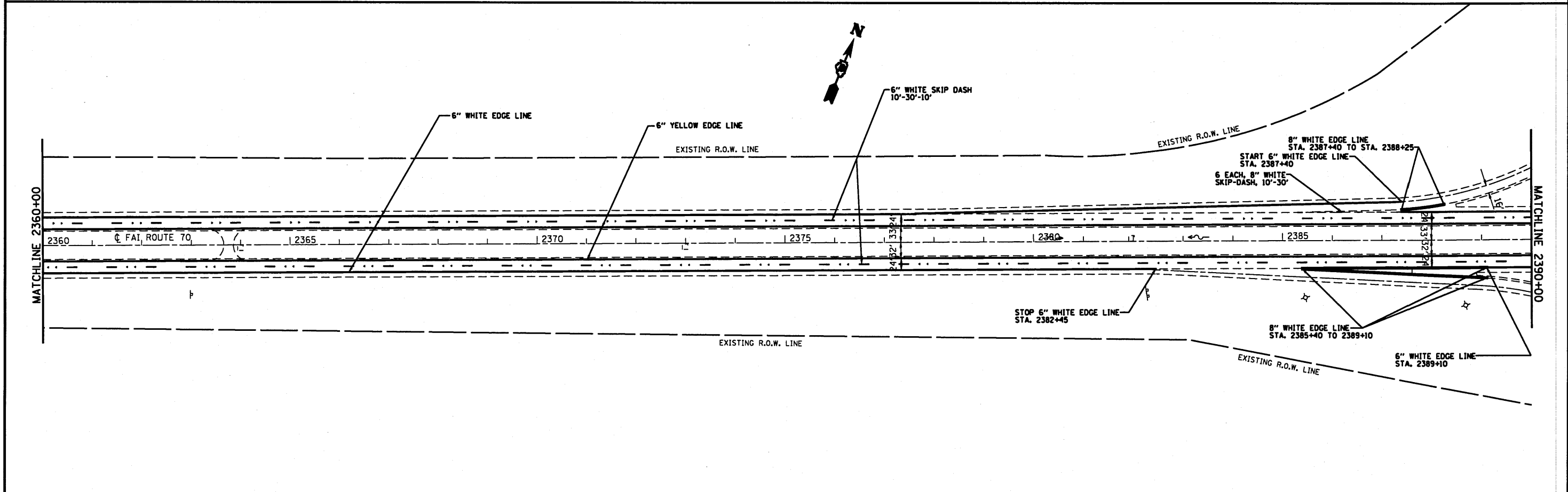
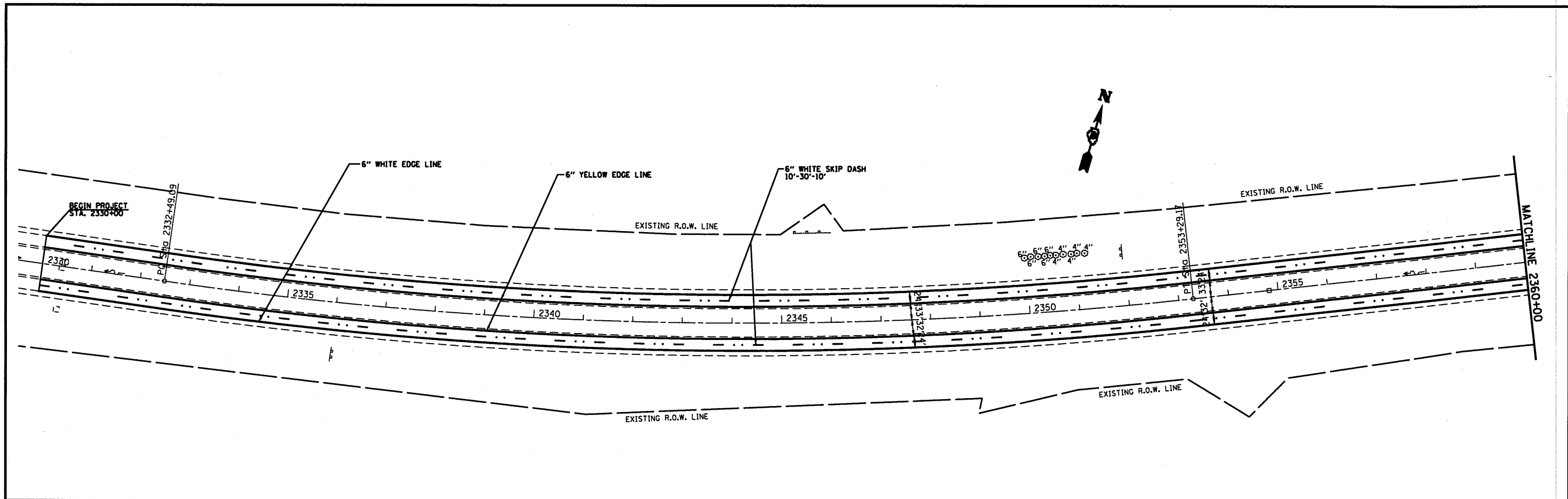

FILE NAME =	USER NAME = a1fordb	DESIGNED -	REVISED -	<b>STATE OF ILLINOIS DEPARTMENT OF TRANSPORTATION</b>	<b>PLAN SHEETS</b>			F.A.I. RTE.	SECTION	COUNTY	TOTAL SHEETS	SHEET NO.
c:\pwwork\pwwidat\alfordb\8232415\d87653-sh1-plan.dgn		DRAWN -	REVISED -					70	3-13,4,5-1		16	5
PLOT SCALE = 207.2929' / IN.		CHECKED -	REVISED -		SCALE: SHEET NO. OF SHEETS STA. TO STA.			BOND	CONTRACT NO. 76E53			
PLOT DATE = 10/28/2018		DATE -	REVISED -					ILLINOIS FED. AID PROJECT				

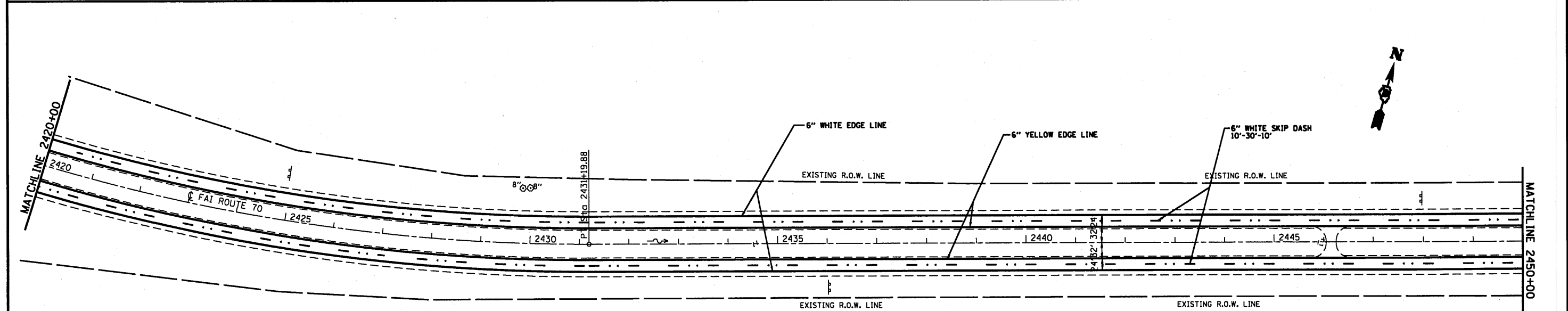
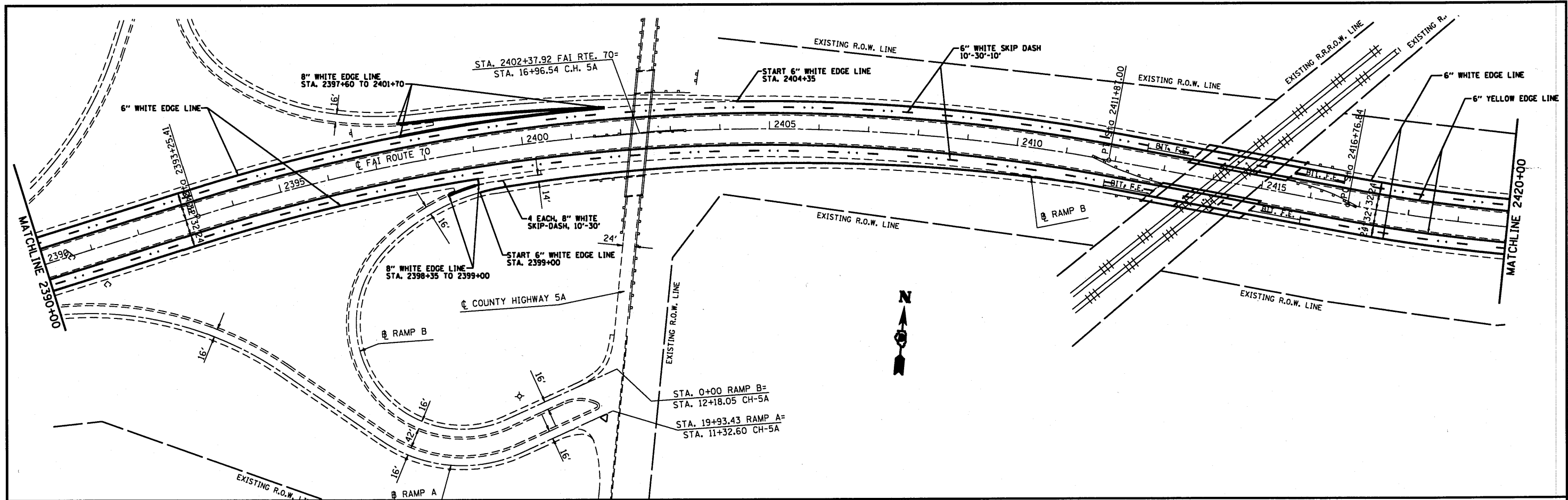

FILE NAME *	USER NAME * alfordb	DESIGNED -	REVISED -	<b>STATE OF ILLINOIS DEPARTMENT OF TRANSPORTATION</b>	<b>PLAN SHEETS</b>			F.A.I. RTE.	SECTION	COUNTY	TOTAL SHEETS	SHEET NO.			
c:\pwwork\pwwid\alfordb\232415\087653-ahs-plan.dgn		DRAWN -	REVISED -		SCALE:	SHEET NO.	OF	SHEETS	STA.	TO STA.	70	3-(3,4,5)-1	BOND	16	6
		CHECKED -	REVISED -										<b>CONTRACT NO. 76E53</b>		
		DATE -	REVISED -										FED. ROAD DIST. NO. ILLINOIS FED. AID PROJECT		

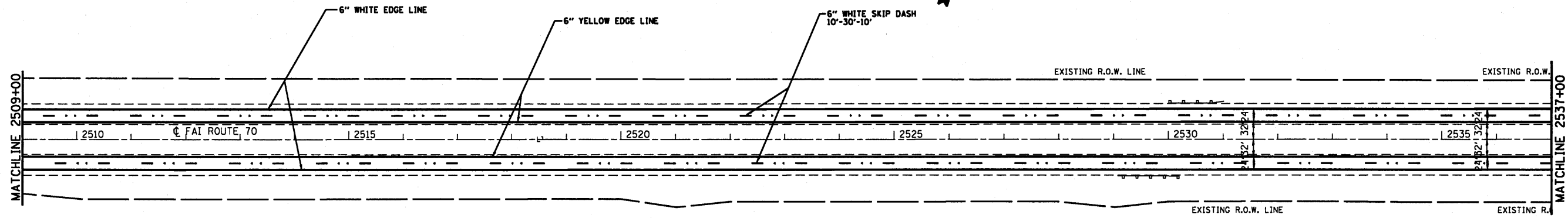
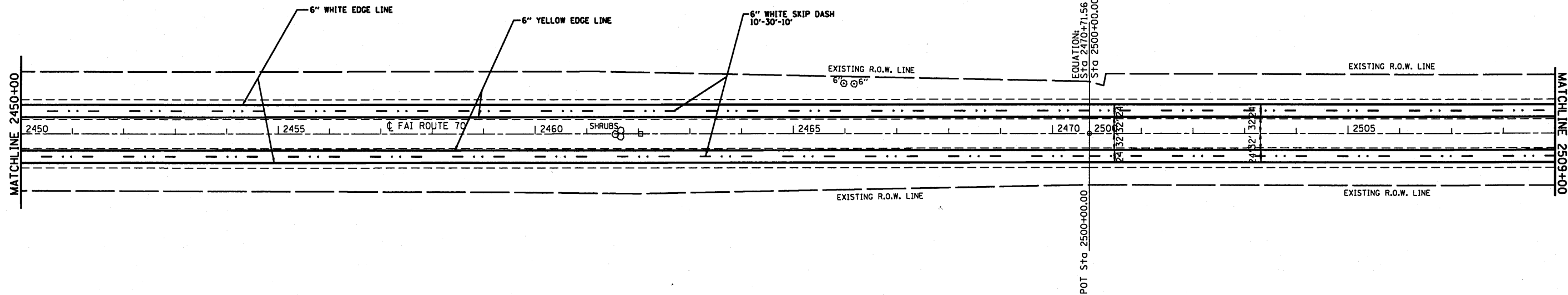

FILE NAME = c:\pwwork\psidot\alfordb\0232415\087653-sht-plan.dgn	USER NAME = alfordb	DESIGNED -	REVISED -	<b>STATE OF ILLINOIS DEPARTMENT OF TRANSPORTATION</b>	<b>PLAN SHEETS</b>			F.A.I. RTE.	SECTION	COUNTY	TOTAL SHEETS	SHEET NO.	
	PLOT SCALE = 287.2429' / IN.	CHECKED -	REVISED -					70	3-(3,4,5)-1	BOND	16	7	
	PLOT DATE = 18/28/2018	DATE -	REVISED -		REVISED -	SCALE:	SHEET NO.	OF SHEETS	STA.	TO STA.	<b>CONTRACT NO. 76E53</b>		
											FED. ROAD DIST. NO.	ILLINOIS FED. AID PROJECT	

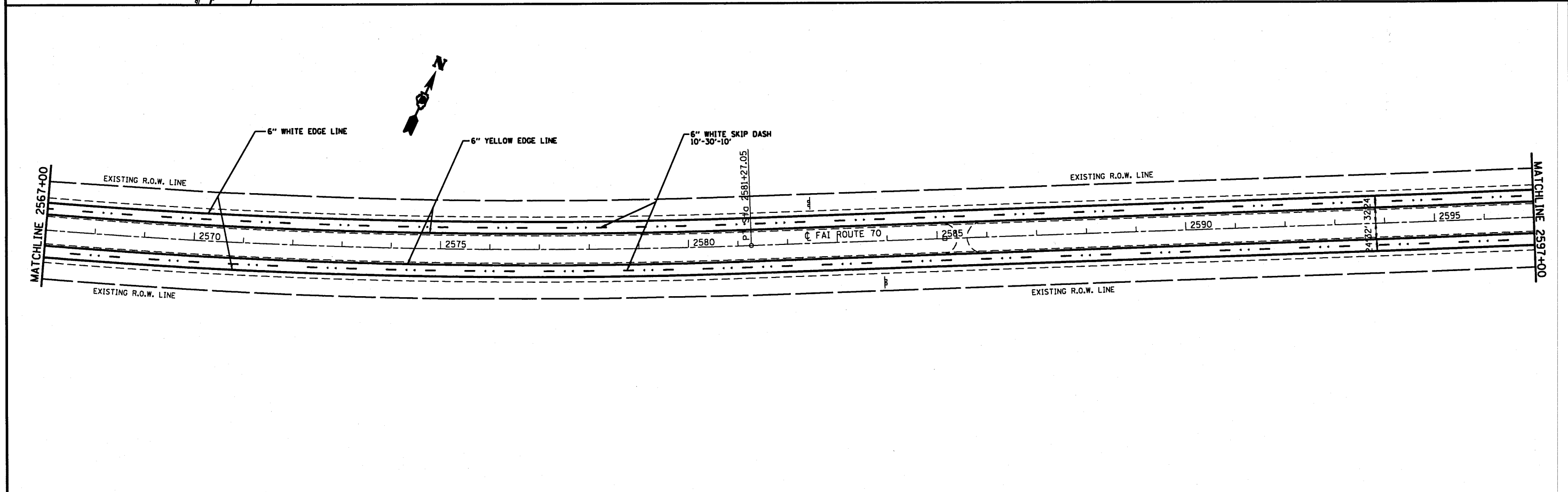
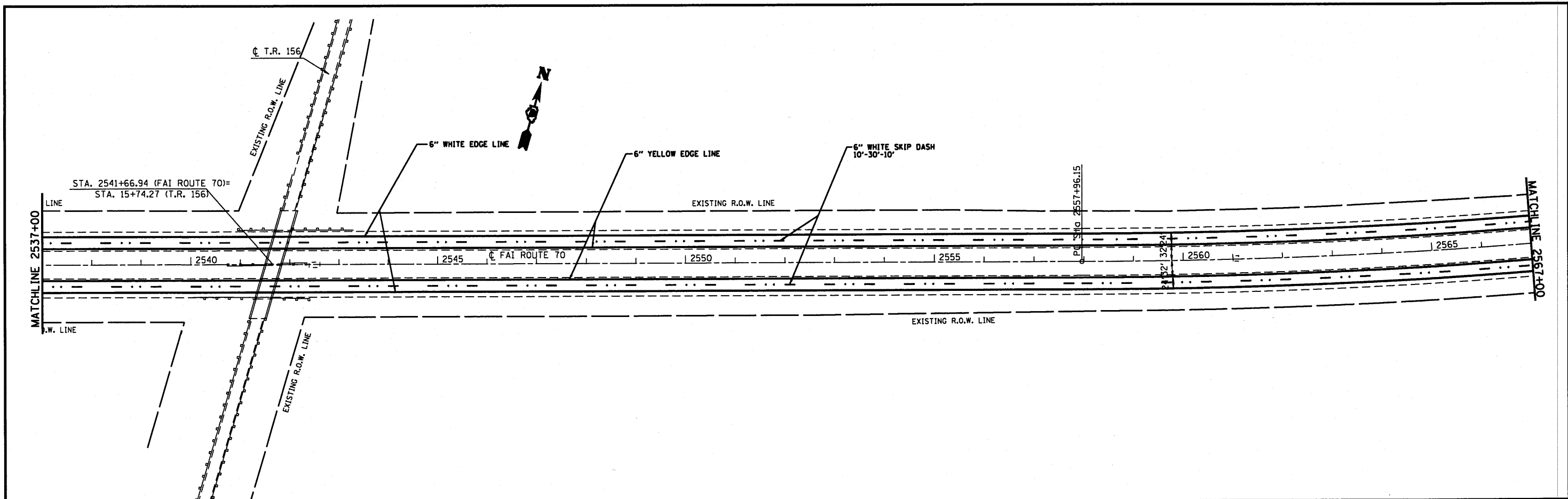

FILE NAME *	USER NAME * alfordb	DESIGNED -	REVISED -	<b>STATE OF ILLINOIS DEPARTMENT OF TRANSPORTATION</b>	<b>PLAN SHEETS</b>			F.A.I. RTE.	SECTION	COUNTY	TOTAL SHEETS	SHEET NO.
c:\pwwork\pwwork\alfordb\8232415\87653-sht-plan.dgn	PLOT SCALE = 287.2929' / IN.	DRAWN -	REVISED -					70	3-(3,4,5)-1	BOND	16	8
PLOT DATE = 10/28/2018	DATE -	CHECKED -	REVISED -		CONTRACT NO. 76E83							
					SCALE:	SHEET NO.	OF	SHEETS	STA.	TO STA.	FED. ROAD DIST. NO. [ILLINOIS] FED. AID PROJECT	





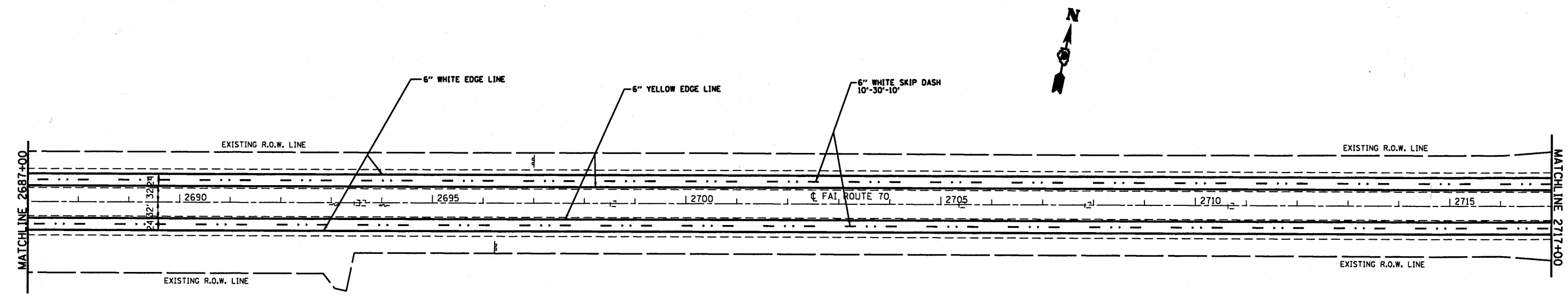
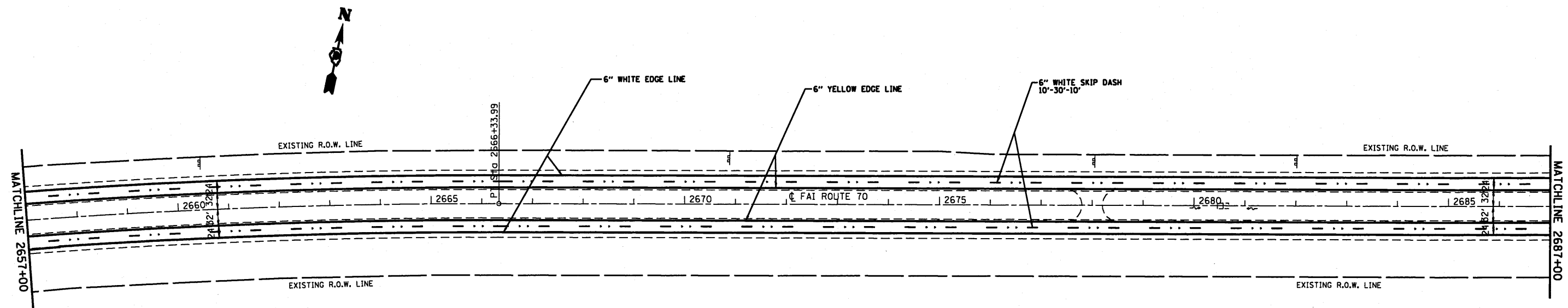

FILE NAME =	USER NAME = alfordb	DESIGNED -	REVISED -
c:\pwork\pwork\alfordb\0232415\d876	53-ah-plot.dgn	DRAWN -	REVISED -
	PLOT SCALE = 287.2929' / IN.	CHECKED -	REVISED -
	PLOT DATE = 10/28/2018	DATE -	REVISED -

**STATE OF ILLINOIS  
DEPARTMENT OF TRANSPORTATION**

PLAN SHEETS				
SCALE:	SHEET NO.	OF SHEETS	STA.	TO STA.

F.A.I. RTE.	SECTION	COUNTY	TOTAL SHEETS	SHEET NO.
70	3-(3,4,5)-1	BOND	16	10
CONTRACT NO. 76E83				
FED. ROAD DIST. NO. ILLINOIS FED. AID PROJECT				

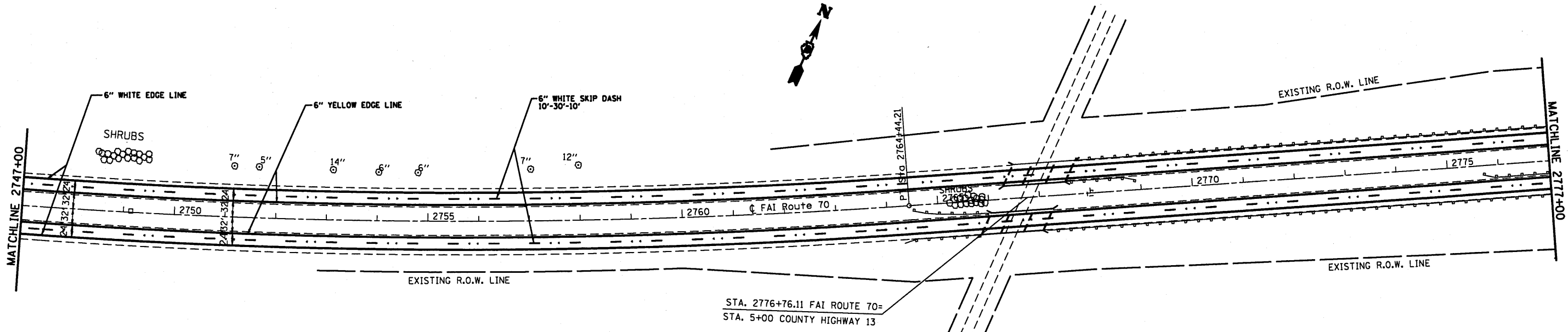
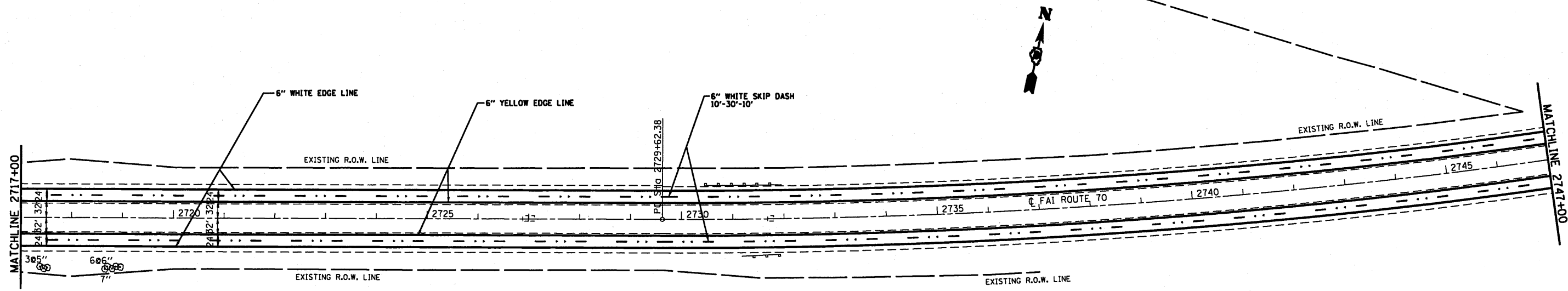

FILE NAME =	USER NAME = alfordb	DESIGNED -	REVISED -
c:\pwork\pvidat\alfordb\d8232415\d876	53-sht-plan.dgn	DRAWN -	REVISED -
	PLOT SCALE = 287.2929' / IN.	CHECKED -	REVISED -
	PLOT DATE = 10/28/2018	DATE -	REVISED -

**STATE OF ILLINOIS  
DEPARTMENT OF TRANSPORTATION**

**PLAN SHEETS**

SCALE:	SHEET NO.	OF	SHEETS	STA.	TO STA.
--------	-----------	----	--------	------	---------

F.A.I. RTE.	SECTION	COUNTY	TOTAL SHEETS	SHEET NO.
70	3-(3,4,5)-1		16	11
FED. ROAD DIST. NO. ILLINOIS FED. AID PROJECT			CONTRACT NO. 76E83	



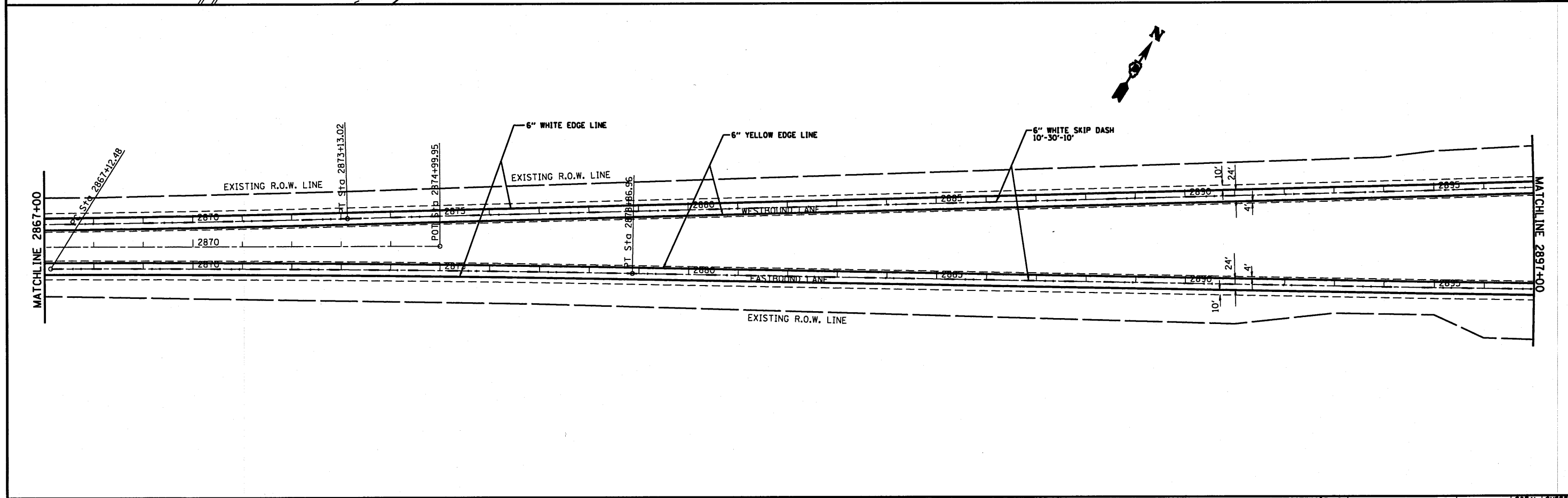
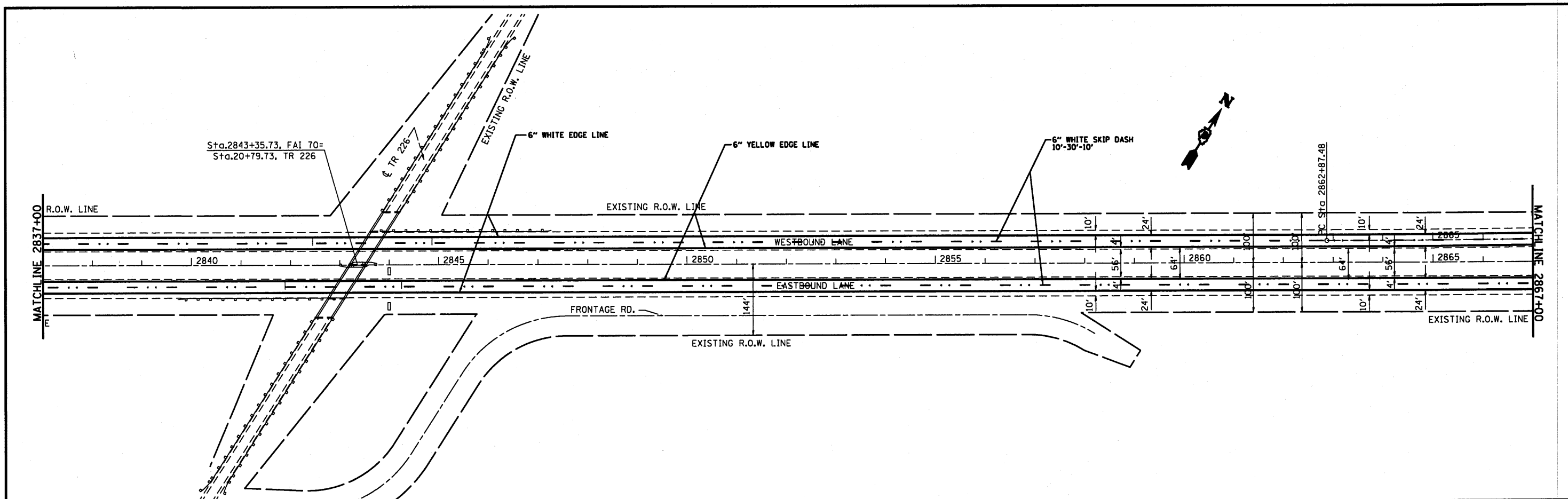

FILE NAME = c:\pwwork\pwwork\alfordb\8232415\d876	USER NAME = alfordb	DESIGNED -	REVISED -	<b>STATE OF ILLINOIS DEPARTMENT OF TRANSPORTATION</b>	<b>PLAN SHEETS</b>			F.A.I. RTE. = 70	SECTION = 3-(3,4,5)-1	COUNTY = BOND	TOTAL SHEETS = 16	SHEET NO. = 13
	53-sht-plan.dgn	DRAWN -	REVISED -		SCALE: _____	SHEET NO. _____	OF SHEETS _____	STA. _____	TO STA. _____	CONTRACT NO. 76653		
PLOT SCALE = 287.2929' / IN.	CHECKED -	REVISED -			FED. ROAD DIST. NO. _____   ILLINOIS FED. AID PROJECT							
PLOT DATE = 10/28/2018	DATE -	REVISED -										

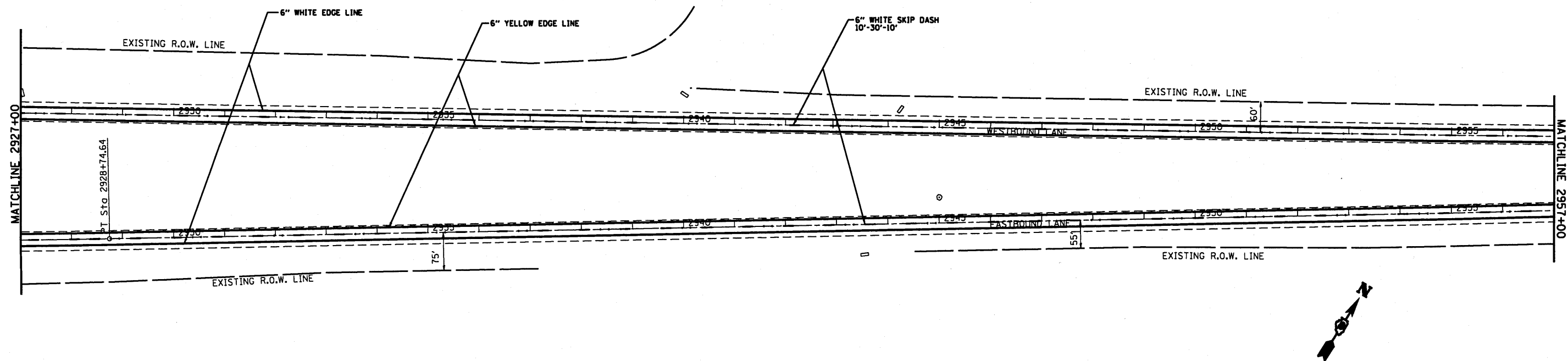
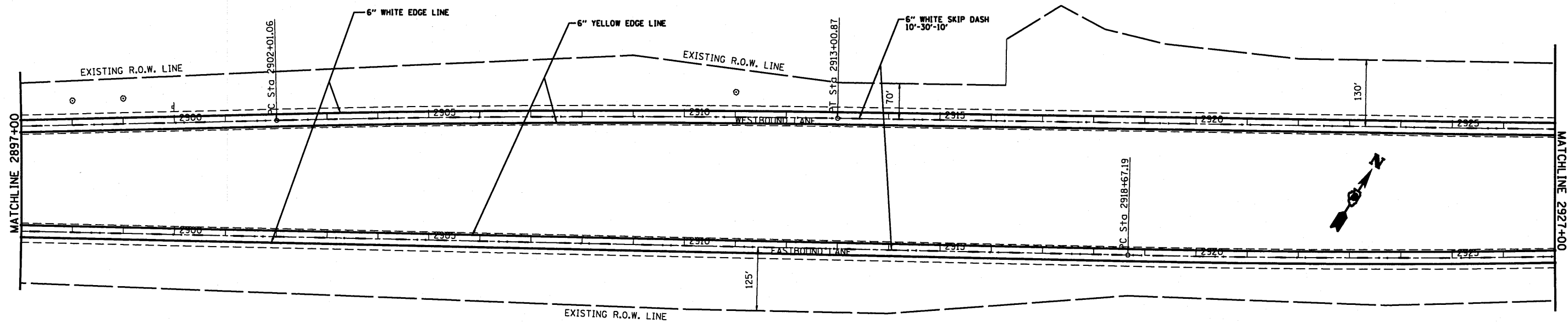

FILE NAME =	USER NAME = aifordb	DESIGNED -	REVISED -	<b>STATE OF ILLINOIS DEPARTMENT OF TRANSPORTATION</b>	<b>PLAN SHEETS</b>			F.A.I. RTE.	SECTION	COUNTY	TOTAL SHEETS	SHEET NO.	
c:\pwwork\puidot\alfordb\0232415\087683-shr-plan.dgn		DRAWN -	REVISED -		SCALE:	SHEET NO.	OF SHEETS	STA.	TO STA.	70	3-(3,4,5)-1	BOND	16 14
		CHECKED -	REVISED -									CONTRACT NO. 76EB3	
		DATE -	REVISED -									ILLINOIS FED. AID PROJECT	

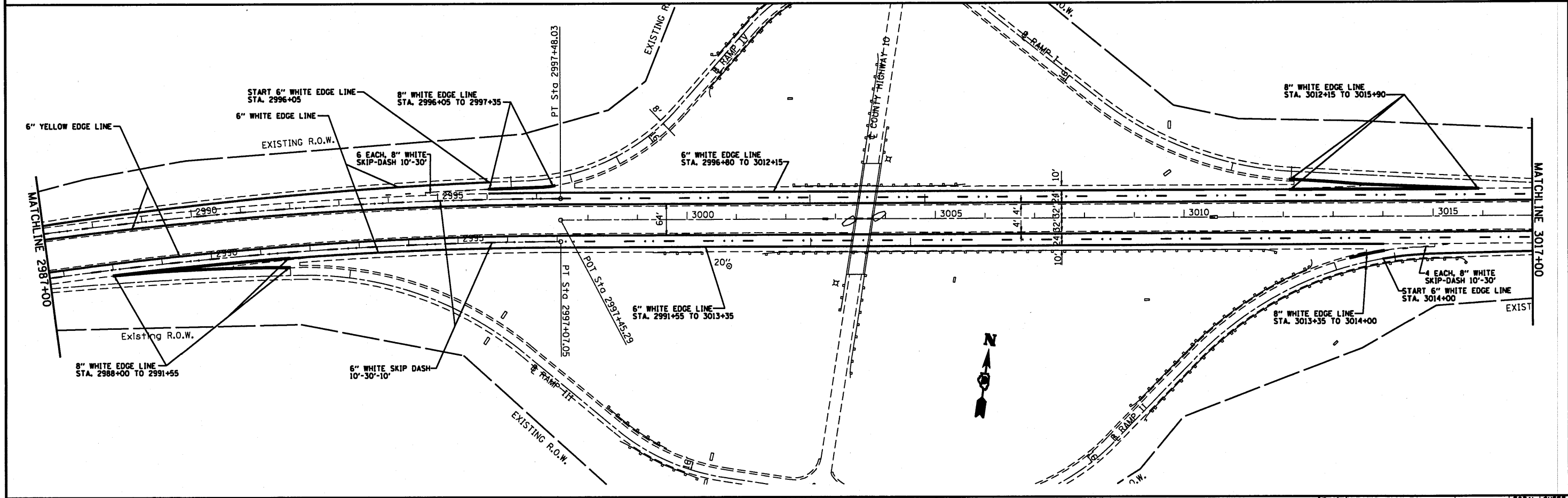
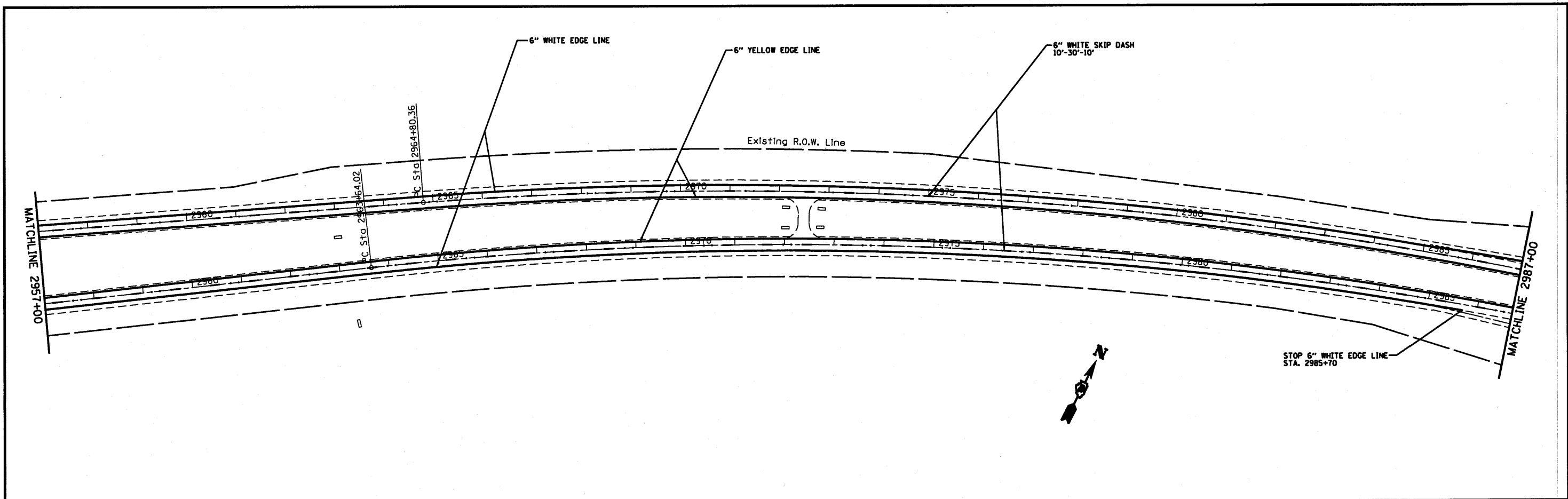

FILE NAME =	USER NAME = aifordb	DESIGNED -	REVISED -	<b>STATE OF ILLINOIS DEPARTMENT OF TRANSPORTATION</b>	<b>PLAN SHEETS</b>			F.A.I. RTE.	SECTION	COUNTY	TOTAL SHEETS NO.			
c:\pr-work\pwidot\elfordb\08232415\087653-ah-plot.dgn		DRAWN -	REVISED -		SCALE:	SHEET NO.	OF SHEETS	STA.	TO STA.	70	3-(3,4,5)-1	BOND	16	15
		CHECKED -	REVISED -									CONTRACT NO. 76EB3		
		DATE -	REVISED -							FED. ROAD DIST. NO.	ILLINOIS FED. AID PROJECT			

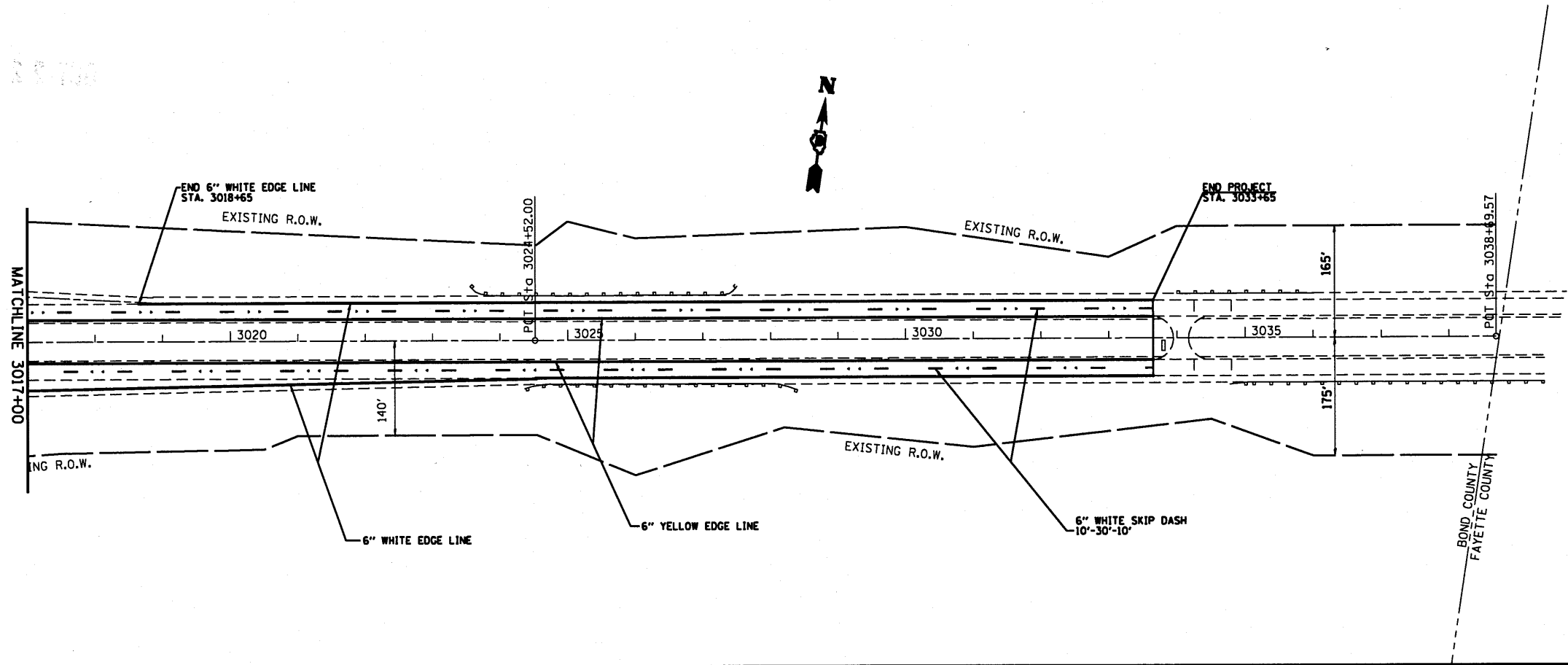

FILE NAME =	USER NAME = alfordb	DESIGNED -	REVISED -
c:\pwwork\pwwork\alfordb\8232415\d876	53-shr-plan.dgn	DRAWN -	REVISED -
	PLOT SCALE = 287.2929' / IN.	CHECKED -	REVISED -
	PLOT DATE = 10/28/2018	DATE -	REVISED -

**STATE OF ILLINOIS  
DEPARTMENT OF TRANSPORTATION**

<b>PLAN SHEETS</b>			
SCALE:	SHEET NO.	OF SHEETS	STA. TO STA.

F.A.I. RTE.	SECTION	COUNTY	TOTAL SHEETS	SHEET NO.
70	3-(3,4,5)-1	BOND	16	16
CONTRACT NO. 76E83				
FED. ROAD DIST. NO. ILLINOIS FED. AID PROJECT				