

INDEX OF SHEETS

1	COVER SHEET, INDEX OF SHEET, LOCATION MAP
2	SUMMARY OF QUANTITIES
3-4	SCHEDULE OF QUANTITIES
5	TYPICAL SECTIONS
6	PAVEMENT DESIGN, ENTRANCE DETAILS, AND HORIZONTAL & VERTICAL CONTROL
7	TRAFFIC CONTROL PLAN
8-10	PLAN AND PROFILE
11-13	STORM WATER POLLUTION PREVENTION AND STRIPING PLAN
	BRIDGE DRAWINGS
14	GENERAL PLAN AND ELEVATION
15	RIPRAP AND PILE LAYOUT
16-19	TOP OF SLAB & BRIDGE APPROACH SLAB ELEVATIONS
20	FRAMING PLAN
21	SUPERSTRUCTURE
22	SUPERSTRUCTURE DETAILS
23	DIAPHRAGM DETAILS
24	BRIDGE APPROACH SLAB DETAILS
25-26	63" PPC BULB T-BEAM
27	WEST ABUTMENT DETAILS
28	EAST ABUTMENT DETAILS
29	HP PILE DETAILS
30	BAR SPLICER ASSEMBLY AND MECHANICAL SPLICER DETAILS
31	BORING LOGS
32-38	CROSS SECTIONS
39	INLET BOX, SPECIAL AND STRIPING DETAILS

STATE OF ILLINOIS  
DEPARTMENT OF TRANSPORTATION

PLANS FOR  
PROPOSED LOCAL AGENCY IMPROVEMENT  
FEDERAL-AID HBP PROJECT  
HIGHWAY BRIDGE PROGRAM

F.A.S. 1365  
SECTION 10-00650-00-BR  
COUNTY HIGHWAY 33 OVER TOMAHAWK CREEK  
LASALLE COUNTY

PROJECT NO. BRS-1365(113)  
JOB NO. C-93-061-10  
CONTRACT NO. 87448

2011

SCALES: PLAN 1" = 20'  
PROFILE HORZ. 1" = 20'  
PROFILE VERT. 1" = 5'  
CROSS SECTIONS 1" = 5'

STATE LOCATION MAP

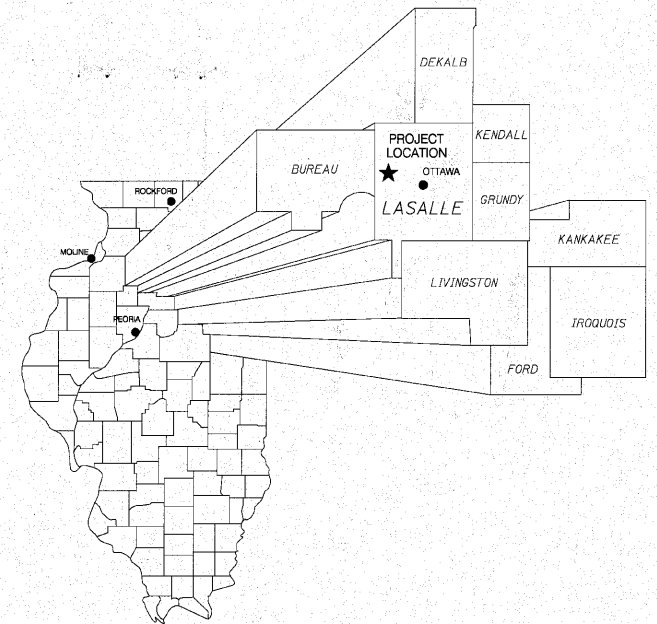

STANDARDS

000001-06	STANDARD SYMBOLS, ABBREVIATIONS AND PATTERNS
280001-05	TEMPORARY EROSION CONTROL SYSTEMS
420401-08	BRIDGE APPROACH PAVEMENT CONNECTOR
515001-03	NAME PLATE FOR BRIDGES
601101-01	CONCRETE HEADWALL FOR PIPE DRAIN
630001-09	STEEL PLATE BEAM GUARDRAIL
630301-05	SHOULDER WIDENING FOR TYPE 1 (SPECIAL) GUARDRAIL TERMINALS
631031-09	TRAFFIC BARRIER TERMINAL, TYPE 6
635006-03	REFLECTOR AND TERMINAL MARKER PLACEMENT
635011-02	REFLECTOR MARKER AND MOUNTING DETAILS
666001-01	RIGHT OF WAY MARKERS
667101-01	PERMANENT SURVEY MARKERS
701201-04	LANE CLOSURE, 2L 2W, DAY ONLY, FOR SPEEDS > 45 MPH
701301-04	LANE CLOSURE, 2L 2W, SHORT TIME OPERATIONS
701901-01	TRAFFIC CONTROL DEVICES
720011-01	METAL POSTS FOR SIGNS, MARKERS & DELINEATORS
728001-01	TELESCOPING STEEL SIGN SUPPORT
729001-01	APPLICATIONS OF TYPES A & B METAL POSTS (FOR SIGNS & MARKERS)
780001-02	TYPICAL PAVEMENT MARKINGS
B.L.R. 17-4	TRAFFIC CONTROL DEVICES - DAY LABOR CONSTRUCTION
B.L.R. 22-6	TYPICAL APPLICATION OF TRAFFIC CONTROL DEVICES FOR CONSTRUCTION ON RURAL LOCAL HIGHWAYS (TWO-LANE TWO WAY RURAL TRAFFIC) (ROAD CLOSED TO THRU TRAFFIC)

DESIGN CRITERIA:

DESIGN SPEED: 50 MPH - COUNTY HIGHWAY 33			
FUNCTIONAL CLASSIFICATION	HIGHWAY	ADT (2021)	TRUCKS (12%)
MAJOR COLLECTOR (RURAL)	FAS RTE. 1365	950	114



CO. HIGHWAY 33 = 1,250 FEET = 0.237 MILES

RANGE 1 EAST OF 3RD P.M.

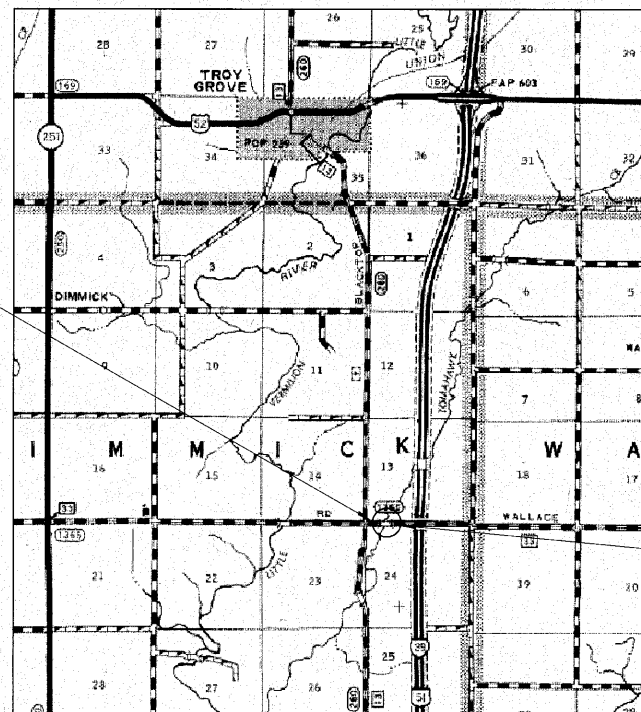

CO. HIGHWAY 33  
SECTION BEGINS  
STA 12+00.00



CO. HIGHWAY 33  
SECTION ENDS  
STA 24+50.00

LOCATION MAP

APPROVED Oct. 27, 2010  
*James Q. Kujawa*  
LASALLE COUNTY ENGINEER

PASSED 11-8 2010  
*Gregory D. [Signature]*  
DISTRICT 3 PROJECT IMPLEMENTATION ENGINEER

RELEASING FOR BID BASED 11-8 2010  
ON LIMITED REVIEW  
*George F. [Signature]*  
DEPUTY DIRECTOR OF HIGHWAYS, REGION 3 ENGINEER

STATE OF ILLINOIS  
DEPARTMENT OF TRANSPORTATION



DATE: 10/26/2010  
EXPIRES 11/30/2011



Land Surveying - Transportation - Structural  
Environmental - Architecture  
809 East Second Street Dixon, Illinois 61021  
Phone 815.284.3381 Fax 815.284.3385  
Design Firm #184-000918  
www.willetthofmann.com