

BENCHMARK: Chis. "Δ" on top of Hub Guard SW Corner of Bridge, El. 620.55

BENCHMARK: RR Spike in Corner Fence Post @ West Side of Field Entrance East of Bridge 45.01' Rt. of Sta. 22+10.73, El. 620.64

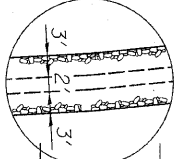

- NOTES:**
- EXISTING ROAD SIGNS TO BE REMOVED AND REPLACED AS DIRECTED BY THE ENGINEER.
 - PROPOSED FENCE TO BE INSTALLED BY PROPERTY OWNER.

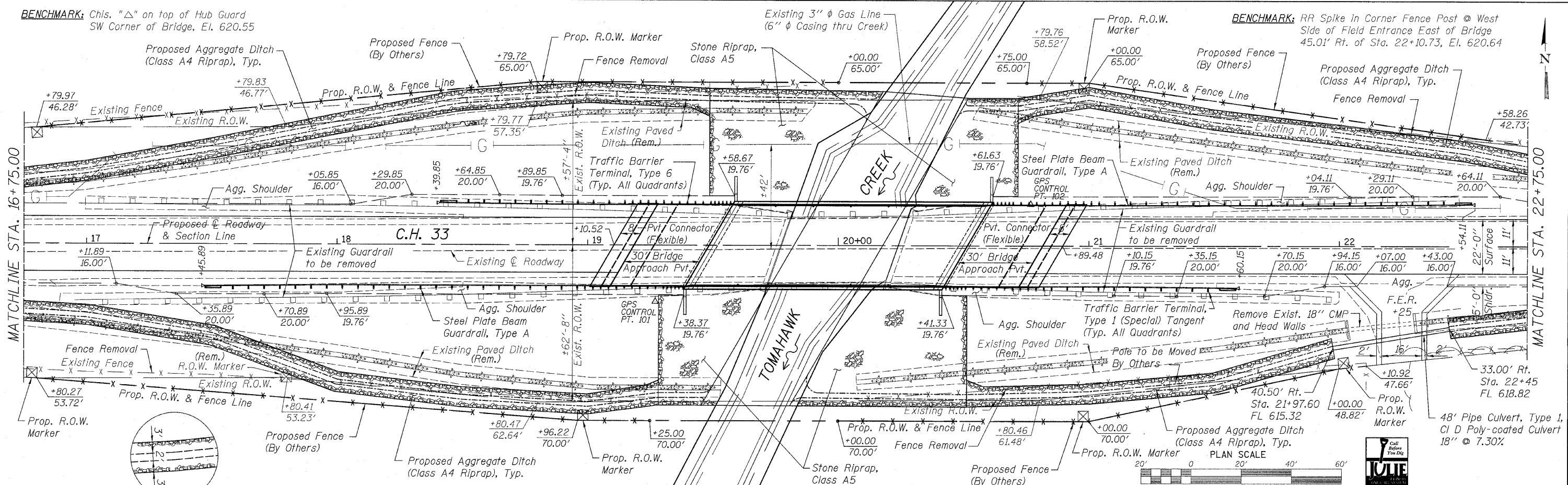
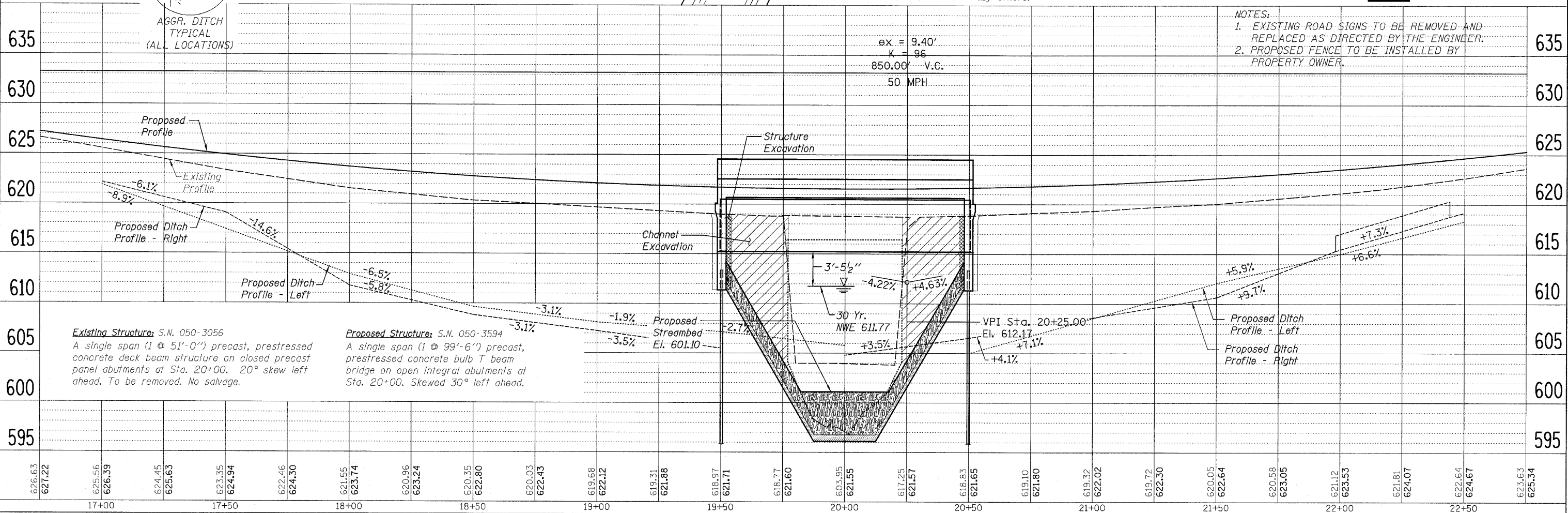

Existing Structure: S.N. 050-3056
A single span (1 @ 51'-0") precast, prestressed concrete deck beam structure on closed precast panel abutments at Sta. 20+00. 20° skew left ahead. To be removed. No salvage.

Proposed Structure: S.N. 050-3594
A single span (1 @ 99'-6") precast, prestressed concrete bulb T beam bridge on open integral abutments at Sta. 20+00. Skewed 30° left ahead.

<p>WILLET, HOFMANN & ASSOCIATES, INC. CONSULTING ENGINEERS 808 East Second Street Dixon, IL 61021 Phone: 815.284.3381 Fax: 815.284.3386 Design Firm # 104-0016 www.willett-hofmann.com</p>	USER NAME =	DESIGNED -	REVISED -	<p>LASALLE COUNTY COUNTY HIGHWAY 33 TOMAHAWK BRIDGE REPLACEMENT</p>	<p>COUNTY HIGHWAY 33 - PLAN & PROFILE</p>	F.A.S. RTE.	SECTION	COUNTY	TOTAL SHEETS	SHEET NO.
	PLOT SCALE =	CHECKED -	REVISED -			1365	10-00650-00-BR	LASALLE	39	9
	PLOT DATE =	DATE	REVISED -			STA. 16+75.00 TO STA. 22+75.00	CONTRACT NO. 87448			
						FED. ROAD DIST. NO. 7 ILLINOIS FED. AID PROJECT BRS-1365(113)				