

PLAN	SURVEYED	DATE
	PLOTTED	BY
	NOTED	CHECKED
	BY	NO. OF WAYS CHECKED
	DATE	PAID FILE NAME
	NO.	

CONSTRUCTION BEGINS STA. 12+00.00

CO. HIGHWAY 13

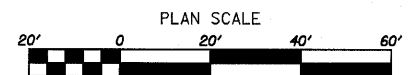
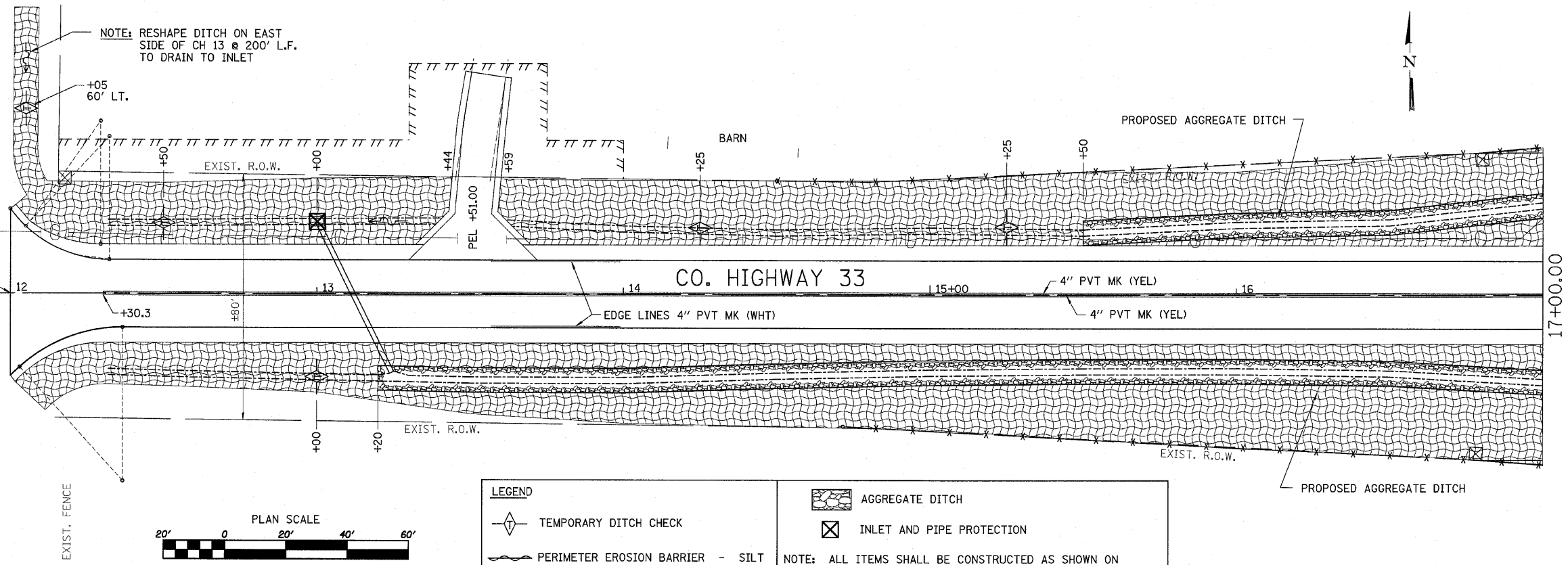

LEGEND

- TEMPORARY DITCH CHECK
- PERIMETER EROSION BARRIER - SILT FILTER FENCE OR OTHER AS APPROVED BY THE ENGINEER
- EROSION CONTROL BLANKET
- AGGREGATE DITCH
- INLET AND PIPE PROTECTION

NOTE: ALL ITEMS SHALL BE CONSTRUCTED AS SHOWN ON STANDARD 280001 AND AS DIRECTED BY THE ENGINEER. MAINTENANCE AND CLEANING OF THE EROSION CONTROL ITEMS SHALL BE INCLUDED IN THE RESPECTIVE EROSION CONTROL PAY ITEM.

PROFILE	SURVEYED	DATE
	PLOTTED	BY
	NOTED	CHECKED
	BY	NO. OF WAYS CHECKED
	DATE	PAID FILE NAME
	NO.	

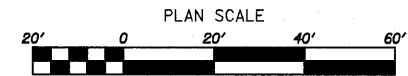
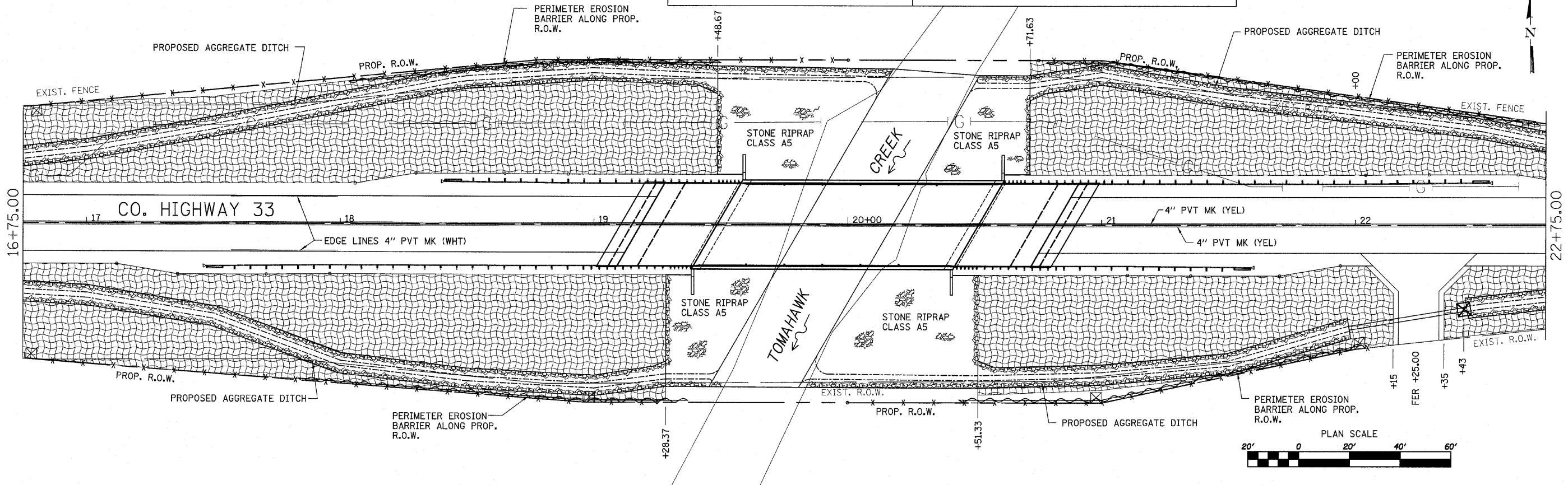

s:\projects\1156006_CHSS_Lasalle_County\Design\CH33.dgn

WILLET, HOFMANN & ASSOCIATES, INC.
CONSULTING ENGINEERS
 809 East Second Street Dixon, IL 61021
 Phone 815.294.3351 Fax 815.294.3365
 Design Firm # 184-00918
 www.willett-hofmann.com

USER NAME =	DESIGNED -	REVISED -
PLT SCALE =	DRAWN -	REVISED -
PLT DATE =	CHECKED -	REVISED -
	DATE -	REVISED -

LASALLE COUNTY
COUNTY HIGHWAY 33
TOMAHAWK BRIDGE REPLACEMENT

STORM WATER POLLUTION PREVENTION AND STRIPING PLAN

F.A.S. RTE.	SECTION	COUNTY	TOTAL SHEETS	SHEET NO.
1365	10-00650-00-BR	LASALLE	39	11
STA. 12+05.00 TO STA. 17+00.00		CONTRACT NO. 87448		
FED. ROAD DIST. NO. 7 ILLINOIS		FED. AID PROJECT BR5-1365(13)		