

DATE	
BY	
SURVEYED	
PLOTTED	
TEMPLATE	
NOTE BOOK	
AREAS CHECKED	
NO.	

DATE	
BY	
SURVEYED	
PLOTTED	
TEMPLATE	
NOTE BOOK	
AREAS CHECKED	
NO.	

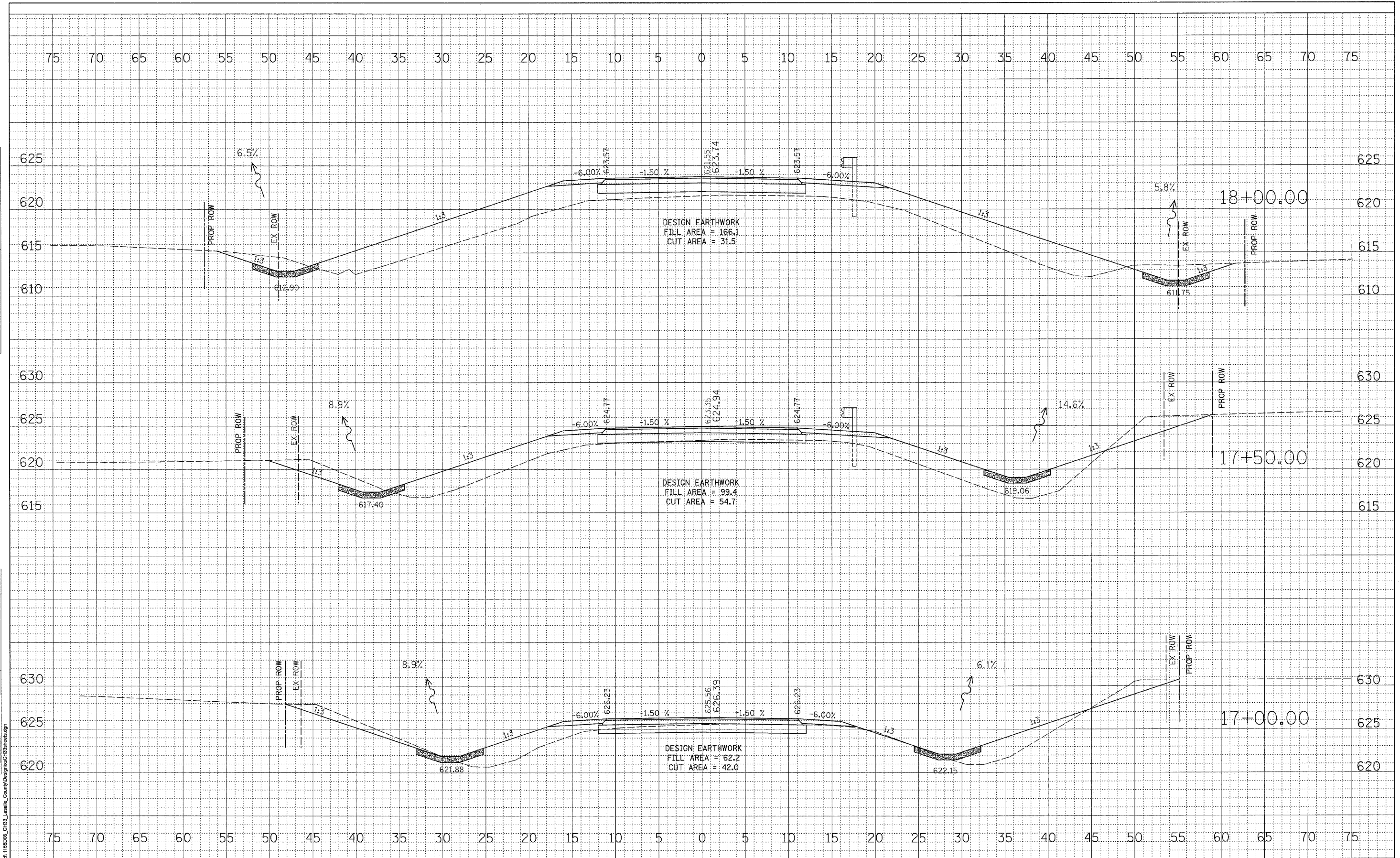

**WILLET, HOFMANN & ASSOCIATES, INC.**  
 CONSULTING ENGINEERS  
 809 East Second Street Dixon, IL 61021  
 Phone 815.284.3381 Fax 815.284.3385  
 Design Firm # 184-0081B  
 www.willetthofmann.com

USER NAME =	DESIGNED -	REVISED -
PLOT SCALE =	DRAWN -	REVISED -
PLOT DATE =	CHECKED -	REVISED -
	DATE -	REVISED -

**LASALLE COUNTY**  
**COUNTY HIGHWAY 33**  
**TOMAHAWK BRIDGE REPLACEMENT**

**C.H. 33 - Cross Sections**

F.A.S. RTE.	SECTION	COUNTY	TOTAL SHEETS	SHEET NO.
1365	10-00650-00-BR	LASALLE	39	34
STA. 17+00.00 TO STA. 18+00.00		CONTRACT NO. 87448		
FED. ROAD DIST. NO. 7 ILLINOIS		FED. AID PROJECT BRS-1365(113)		