

DATE	
BY	
FINAL SURVEY	SURVEYED
NOTE BOOK	PLOTTED
NO.	TEMPLATE
	AREAS CHECKED

DATE	
BY	
ORIGINAL SURVEY	SURVEYED
NOTE BOOK	PLOTTED
NO.	TEMPLATE
	AREAS CHECKED

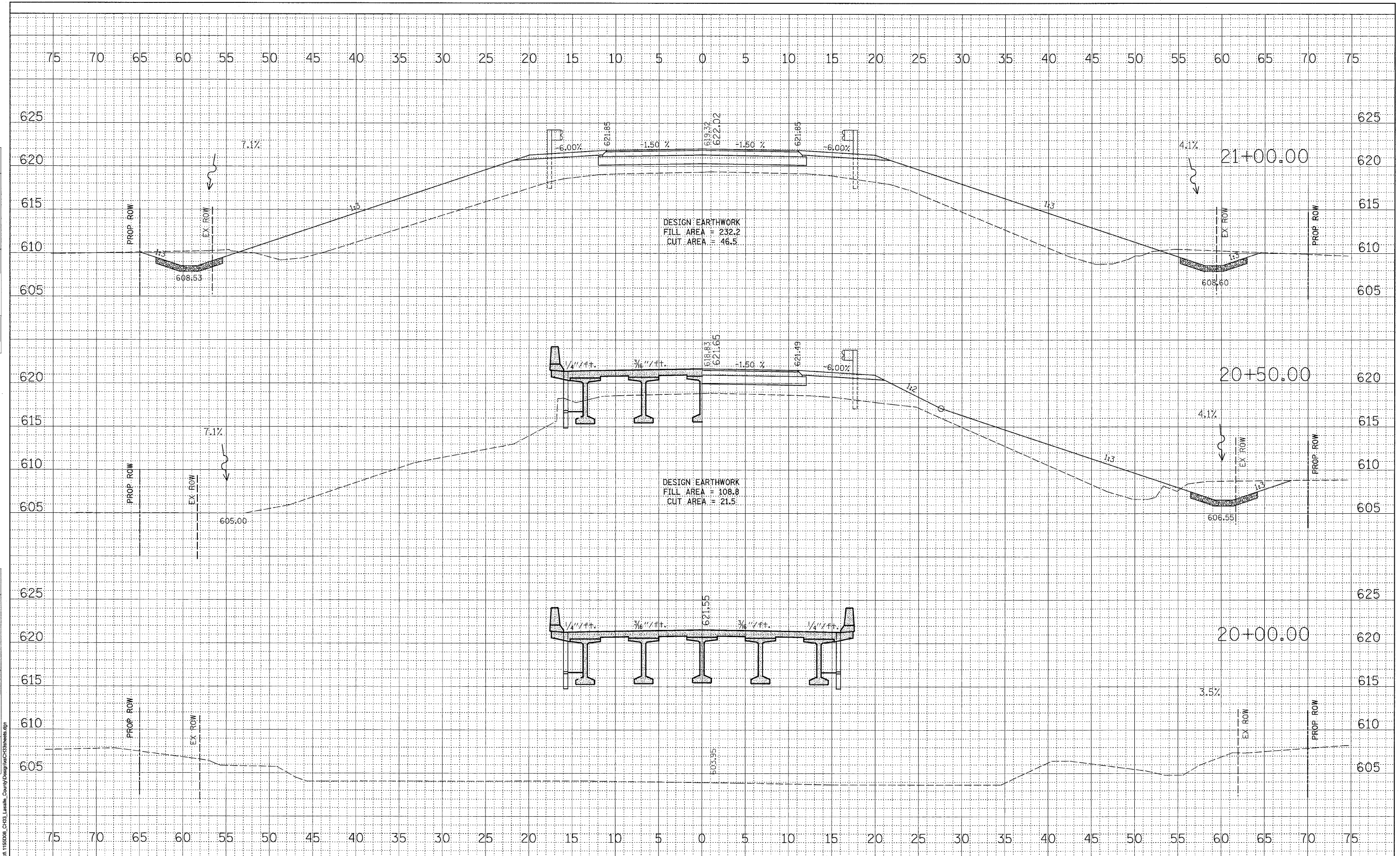

FILE NAME = s:\Sheet\155006_C133_Lasalle_County\Design\C133Sheet3.dgn

WILLET, HOFMANN & ASSOCIATES, INC.
CONSULTING ENGINEERS
 809 East Second Street Dixon, IL 61021
 Phone 815-294-3391 Fax 815-294-3385
 Design Firm # 184-00918
 www.willett-hofmann.com

USER NAME =	DESIGNED -	REVISED -
PLOT SCALE =	DRAWN -	REVISED -
PLOT DATE =	CHECKED -	REVISED -
	DATE -	REVISED -

LASALLE COUNTY
COUNTY HIGHWAY 33
TOMAHAWK BRIDGE REPLACEMENT

C.H. 33 - Cross Sections

F.A.S. RTE.	SECTION	COUNTY	TOTAL SHEETS	SHEET NO.
1365	10-00650-00-BR	LASALLE	39	36
STA. 20+00.00 TO STA. 21+00.00		CONTRACT NO. 87448		
FED. ROAD DIST. NO. 7 ILLINOIS		FED. AID PROJECT BRS-1365(113)		