

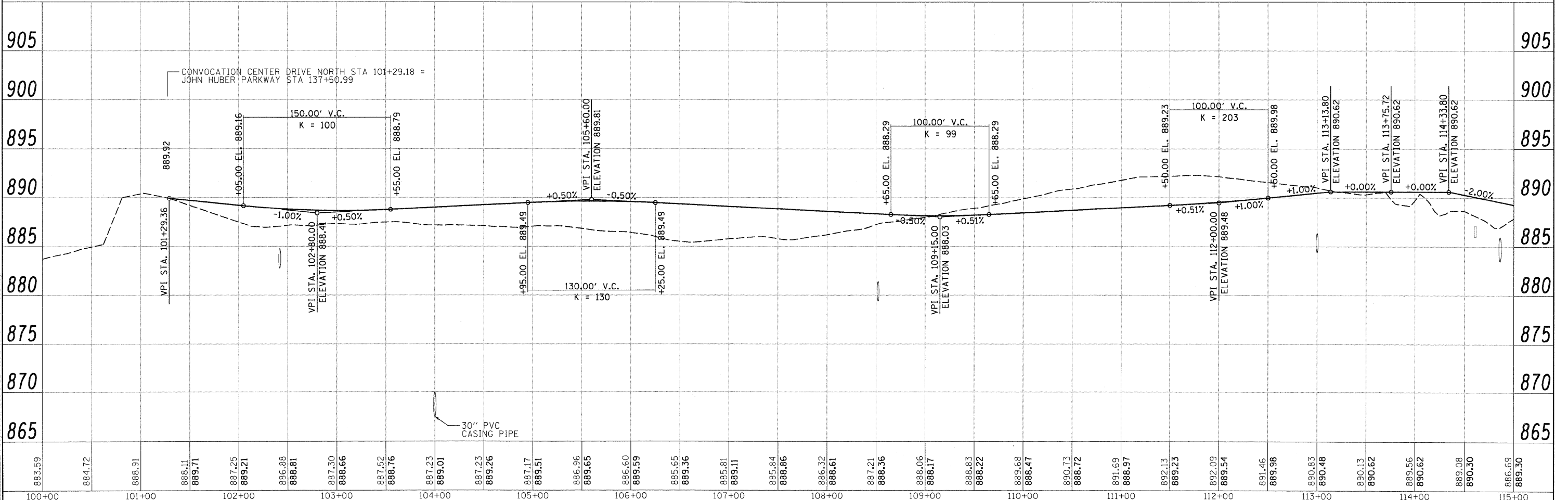

Hanson Professional Services Inc.

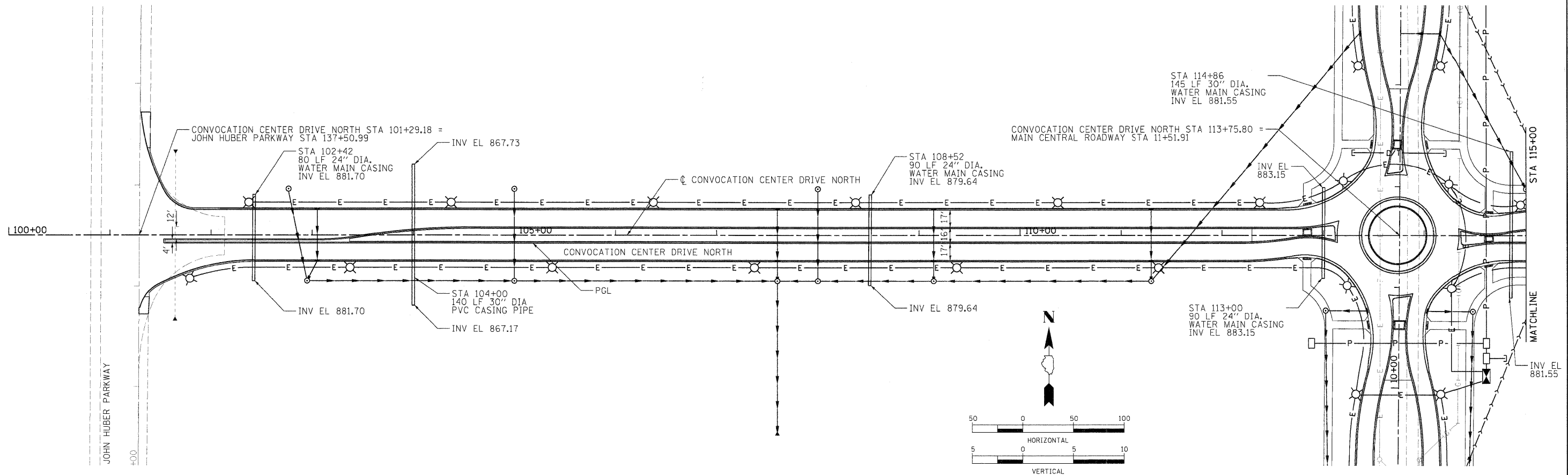

LAYOUT: 09/09/10 HUS0024H
DRAWN: MWH 09/09/10 HUS0024H
REVIEWED: CRC 11/05/2010

FILE NAME = C:\143-SAN-CCDN.dgn

USER NAME = Huser00411
PLOT SCALE = 50.000' / in.
PLOT DATE = 11/05/2010

DESIGNED - CRC
DRAWN - MWH
CHECKED - CRC
DATE - 11/04/10

REVISED -
REVISED -
REVISED -
REVISED -

**STATE OF ILLINOIS
DEPARTMENT OF TRANSPORTATION**

**NORTHERN ILLINOIS UNIVERSITY
WEST CAMPUS EXPANSION
CONVOCATION CENTER DRIVE NORTH SANITARY SEWER**

SCALE: 1" = 50' SHEET NO. OF SHEETS STA. 100+00 TO STA. 115+00

F.A.P. RTE. 567	SECTION 06-00002-00-PV	COUNTY DEKALB	TOTAL SHEETS 148	SHEET NO. 31
ILLINOIS FED. AID PROJECT			CONTRACT NO. 87476	