

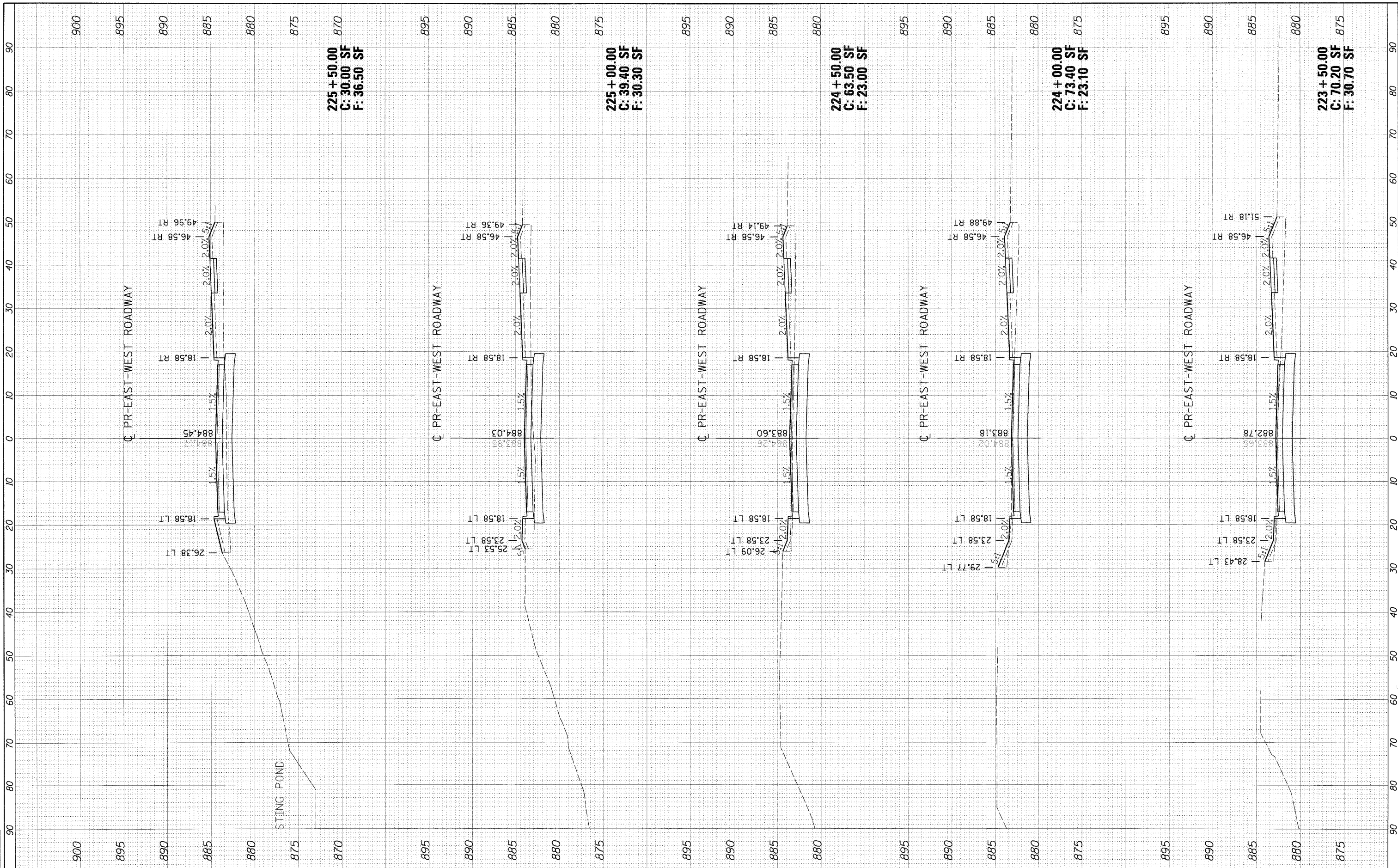

LAYOUT MWH 08/31/10  
 DRAWN MWH 11/04/10  
 REVIEWED DPA 11/04/10



225 + 50.00  
 C: 30.00 SF  
 F: 36.50 SF

225 + 00.00  
 C: 39.40 SF  
 F: 30.30 SF

224 + 50.00  
 C: 63.50 SF  
 F: 23.00 SF

224 + 00.00  
 C: 73.40 SF  
 F: 23.10 SF

223 + 50.00  
 C: 70.20 SF  
 F: 30.70 SF

FILE NAME =  
 I:\Jobs\81581\81581\CADD\Road\Sheet\C-382-KS-EASTWEST.dgn

USER NAME = MWH  
 PLOT SCALE = AS SHOWN  
 PLOT DATE = 11/05/2010

DESIGNED - DPA  
 DRAWN - MWH  
 CHECKED - DPA  
 DATE 11/04/10

REVISED -  
 REVISED -  
 REVISED -  
 REVISED -

**STATE OF ILLINOIS  
 DEPARTMENT OF TRANSPORTATION**

**EAST-WEST ROADWAY SOUTH CROSS SECTIONS  
 NORTHERN ILLINOIS UNIVERSITY  
 FAR WEST CAMPUS EXPANSION**

SCALE: AS SHOWN SHEET NO. OF SHEETS STA. 223+50.00 TO STA. 225+50.00

| F.A. RTE.                 | SECTION        | COUNTY | TOTAL SHEETS | SHEET NO. |
|---------------------------|----------------|--------|--------------|-----------|
| 567                       | 06-00002-00-PV | DEKALB | 148          | 107       |
| CONTRACT NO. 87476        |                |        |              |           |
| ILLINOIS FED. AID PROJECT |                |        |              |           |