

F.A.P. RTE.	SECTION	COUNTY	TOTAL SHEETS	SHEET NO.
116	12ORS-2, 4RS-3	Jasper	18	1
		ILLINOIS	CONTRACT NO. 94985	

STATE OF ILLINOIS
DEPARTMENT OF TRANSPORTATION
DIVISION OF HIGHWAYS
**PROPOSED
HIGHWAY PLANS**

FOR INDEX OF SHEETS, SEE SHEET NO. 2

STATION EQUATIONS

STA. 789 + 54.7 BK. = STA. 789 + 74.3 AH.
 STA. 830 + 75.3 BK. = STA. 830 + 75.1 AH.
 STA. 838 + 00.8 BK. = STA. 838 + 00.0 AH.
 STA. 1345 + 87.8 BK. = STA. 1345 + 92.4 AH.
 STA. 1356 + 31.4 BK. = STA. 107 + 70.0 AH.

FAP ROUTE 116 (ILL 130)
SECTION 12ORS-2, 4RS-3
PROJECT: F-0116 (055)
HMA RESURFACING
JASPER COUNTY

C-97-032-03

D-97-019-03



PROPOSED IMPROVEMENT
SECTION 12ORS-2
JASPER COUNTY
BEGINS STA 762+00.00

PROPOSED IMPROVEMENT
SECTION 4RS-3
JASPER COUNTY
BEGINS ENDS STA 65+57.50

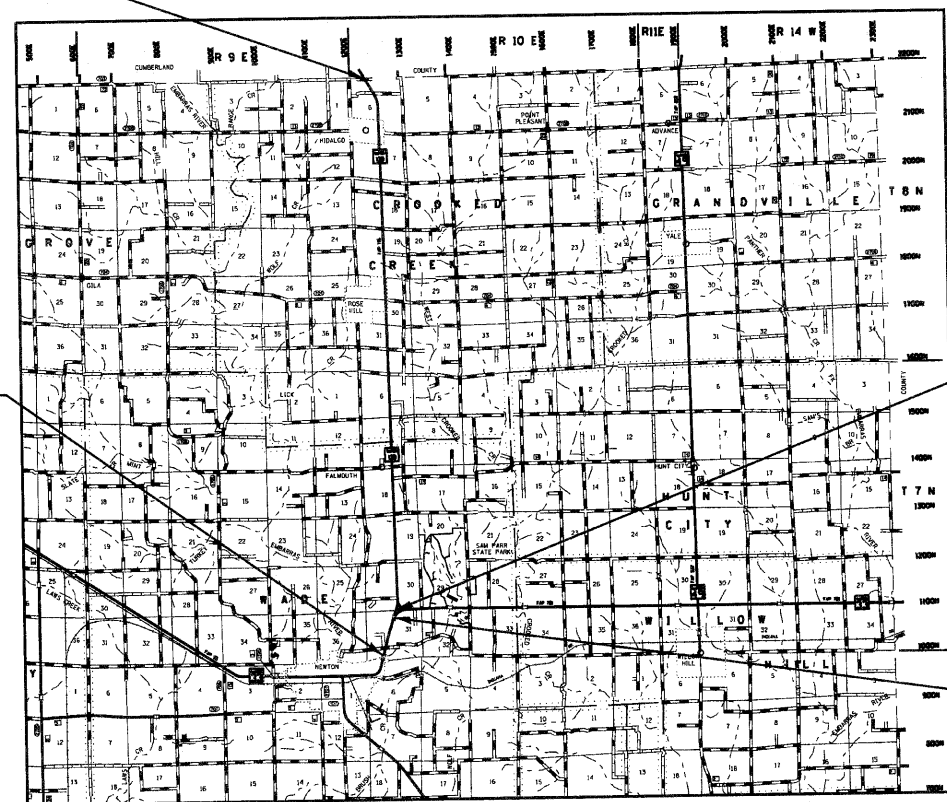

SECTION 12ORS-2 ENDS
SECTION 4RS-3 BEGINS
STA 1356+31.40BK =
STA 107+70.00AH

BRIDGE OMISSION
STA 101+45.50 TO
STA 99+74.50

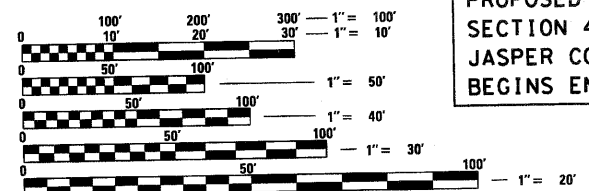

FULL SIZE PLANS HAVE BEEN PREPARED USING STANDARD ENGINEERING SCALES. REDUCED SIZED PLANS WILL NOT CONFORM TO STANDARD SCALES. IN MAKING MEASUREMENTS ON REDUCED PLANS, THE ABOVE SCALES MAY BE USED.

J.U.L.I.E.
JOINT UTILITY LOCATION INFORMATION FOR EXCAVATION
1-800-892-0123
OR 811

PROJECT ENGINEER: MARK DAUGHERTY
PROJECT MANAGER: JOYCE HEMMEN

GROSS LENGTH = 63,617.70 FT. = 12.04 MILE
NET LENGTH = 63,449.70 FT. = 12.02 MILE

STATE OF ILLINOIS
DEPARTMENT OF TRANSPORTATION
DIVISION OF HIGHWAYS

SUBMITTED Oct 26 2010
Roscoe Druehl
DEPUTY DIRECTOR OF HIGHWAYS, REGION ENGINEER

December 10 2010
Scott E. Stett
acting ENGINEER OF DESIGN AND ENVIRONMENT

December 10 2010
Christine M. Reade
DIRECTOR OF HIGHWAYS, CHIEF ENGINEER

**PRINTED BY THE AUTHORITY
OF THE STATE OF ILLINOIS**

CONTRACT NO. 94985

GENERAL NOTES

THE PROPOSED PROJECT IS LOCATED ON US IL 130 IN JASPER COUNTY. THE PROJECT BEGINS AT THE CUMBERLAND/JASPER COUNTY LINE AND EXTENDS SOUTH TO THE EMBARRAS RIVER BRIDGE. THE WORK INCLUDED IN SECTION 120RS-2, 4RS-3, CONSISTS OF PAVEMENT PATCHING, MILLING, HOT-MIX ASPHALT BINDER COURSE AND HOT-MIX ASPHALT SURFACE COURSE, AGGREGATE SHOULDER AND INSTALLATION OF A CONTINUOUS COUNT SITE WITH LOOPS IN THE PAVEMENT, AND ANY OTHER WORK NECESSARY TO COMPLETE THE SECTION.

THE CONTRACTOR SHALL PROVIDE INTERNET ACCESS TO THE HOT-MIX ASPHALT PLANT QUALITY CONTROL LAB SO THAT HOT-MIX ASPHALT PLANT REPORTS CAN BE E-MAILED TO THE DISTRICT HEADQUARTERS. THIS WORK SHALL BE INCLUDED IN THE COST OF HOT-MIX ASPHALT ITEMS.

HOT-MIX ASPHALT MATERIALS (PRIME COAT) SHALL BE EITHER RC-70 OR AN EMULSIFIED POLYMER PRIME SS-1HP OR SS-1H.

AGGREGATE SHOULDERS, TYPE B SHALL BE CRUSHED STONE, CRUSHED CONCRETE, OR RAP.

AGGREGATE SURFACE COURSE, TYPE B SHALL BE CRUSHED STONE OR CRUSHED CONCRETE.

PAVEMENT MARKING SHALL BE APPLIED IN ACCORDANCE WITH SECTION 780 OF THE STANDARD SPECIFICATIONS. SHORT TERM PAVEMENT MARKING SHALL BE APPLIED TO THE MILLED SURFACE AND HOT-MIX ASPHALT SURFACE COURSE AS SPECIFIED IN SECTION 703 OF THE STANDARD SPECIFICATIONS. TEMPORARY TAPE SHALL BE USED ON THE SURFACE COURSE AND PAINT SHALL BE USED ON MILLED SURFACE.

THE TOTAL QUANTITY OF PAINT PAVEMENT MARKING - LINE 4 INCH CONSISTS OF 19,804 FEET OF YELLOW AND 125,204 FEET OF WHITE.

THE EXISTING PAVEMENT SHALL BE PATCHED IN ACCORDANCE WITH SECTION 442 OF THE STANDARD SPECIFICATIONS AND THE SPECIAL PROVISIONS. THE QUANTITY OF PATCHING SHOWN ON THE PLANS IS AN ESTIMATE ONLY AND THE FINAL LOCATIONS AND QUANTITY SHALL BE DETERMINED BY THE ENGINEER IN THE FIELD.

THE FOLLOWING RATES OF APPLICATION HAVE BEEN USED IN CALCULATING PLAN QUANTITIES:

AGGREGATE (PRIME COAT) 4.0 LB/SQ YD
 BIT MATLS (PRIME COAT) 0.1 GAL/SQ YD
 BITUMINOUS CONCRETE 112 LBS/SQ YD/INCH

THE FOLLOWING MIXTURE REQUIREMENTS ARE APPLICABLE FOR THIS PROJECT:

LEVEL BINDER

MIXTURE USE: LEVEL BINDER, 3/4"
 APPLICATION: HOT-MIX ASPHALT SURFACE COURSE, MIX "C", N70
 PG GRADE: PG 64-22
 DESIGN AIR VOIDS: 4.0% @ NDESIGN = 70
 MIXTURE COMPOSITION: IL-9.5
 FRICTION AGGREGATE: NA

SURFACE

MIXTURE USE: SURFACE COURSE - 1 1/2"
 APPLICATION: HOT-MIX ASPHALT SURFACE COURSE, MIX "C", N70
 PG GRADE: PG 64-22
 DESIGN AIR VOIDS: 4.0% @ NDESIGN = 70
 MIXTURE COMPOSITION: IL-9.5
 FRICTION AGGREGATE: MIXTURE C

INCIDENTAL

MIXTURE USE: INCIDENTAL BITUMINOUS SURFACE (DRIVEWAYS)
 APPLICATION: HOT-MIX ASPHALT SURFACE COURSE, MIX "C" N70
 PG GRADE: PG 64-22
 DESIGN AIR VOIDS: 4.0% @ NDESIGN = 70
 MIXTURE COMPOSITION: IL-9.5
 FRICTION AGGREGATE: MIXTURE C

PAVEMENT PATCHING

MIXTURE USE: PAVEMENT PATCHING AND PARTIAL DEPTH PAVEMENT PATCHING
 APPLICATION: HOT-MIX ASPHALT BINDER COURSE, IL 19.0, N70
 PG GRADE: PG 64-22
 DESIGN AIR VOIDS: 4.0% @ NDESIGN = 70
 MIXTURE COMPOSITION: IL - 19.0
 FRICTION AGGREGATE: N/A

INDEX OF SHEETS

SHEET NO.	ITEM
1	COVER SHEET
2	INDEX OF SHEETS, GENERAL NOTES, AND LIST OF APPLICABLE HIGHWAY STANDARDS
3	SUMMARY OF QUANTITIES
4	TYPICAL SECTIONS
5	DETAILS
6	ENTRANCE SCHEDULE AND MAILBOX TURNOUT DETAIL
7	SCHEDULES
8-18	PLAN SHEETS

THE FOLLOWING STANDARDS ARE A PART OF THESE PLANS AND ARE INCLUDED AFTER SHEET NO. 18

STD. NO.	DESCRIPTION
000001-06	STANDARD SYMBOLS, ABBREVIATIONS AND PATTERNS
001006	DECIMAL OF AN INCH AND OF A FOOT
442201-03	CLASS C AND D PATCHES
701006-03	OFF-RD OPERATIONS, 2L, 2W, 15' FROM PAVEMENT EDGE
701011-02	OFF-RD MOVING OPERATIONS, 2L, 2W, DAY ONLY
701301-04	LANE CLOSURE, 2L, 2W, SHORT TIME OPERATIONS
701306-03	LANE CLOSURE, 2L, 2W, SLOW MOVING OPERATIONS DAY ONLY, FOR SPEEDS >=45 MPH
701311-03	LANE CLOSURE, 2L, 2W, MOVING OPERATIONS - DAY ONLY
701336-06	LANE CLOSURE, 2L, 2W, WORK AREAS IN SERIES, FOR SPEEDS >=45 MPH
701901-01	TRAFFIC CONTROL DEVICES
780001-02	TYPICAL PAVEMENT MARKINGS
781001-03	TYPICAL APPLICATIONS RAISED REFLECTIVE PAVEMENT MARKERS

FILE NAME = c:\pwork\pwork\hemmerje\d8240815\0794985-sht-gennote.dgn	USER NAME = hemmerje	DESIGNED -	REVISED -	STATE OF ILLINOIS DEPARTMENT OF TRANSPORTATION	GENERAL NOTES & INDEX OF SHEETS				F.A.P. RTE.	SECTION	COUNTY	TOTAL SHEETS	SHEET NO.
	PLOT SCALE = 100.0000' / IN.	CHECKED -	REVISED -		SCALE:	SHEET NO.	OF	SHEETS	STA.	TO STA.	116	120RS-2, 4RS-3	Jasper
PLOT DATE = 10/27/2010	DATE -	REVISED -							ILLINOIS FED. AID PROJECT CONTRACT NO. 94985				

801.FED/201.STATE

SUMMARY OF QUANTITIES			TOTAL QUANTITIES	CONSTRUCTION TYPE CODE		
CODE NO	ITEM	UNIT		0005		
40200800	AGGREGATE SURFACE COURSE, TYPE B	TON	607	607		
40600100	BITUMINOUS MATERIALS (PRIME COAT)	GALLON	18281	18281		
40600300	AGGREGATE (PRIME COAT)	TON	366	366		
40600635	LEVELING BINDER (MACHINE METHOD), N70	TON	7678	7678		
40600895	CONSTRUCTING TEST STRIP	EACH	1	1		
40600982	HOT-MIX ASPHALT SURFACE REMOVAL - BUTT JOINT	SQ YD	505	505		
40600990	TEMPORARY RAMP	SQ YD	142	142		
40603315	HOT-MIX ASPHALT SURFACE COURSE, MIX "C", N70	TON	15356	15356		
40800050	INCIDENTAL HOT-MIX ASPHALT SURFACING	TON	422	422		
44000151	HOT-MIX ASPHALT SURFACE REMOVAL, 1/2"	SQ YD	182808	182808		
44201815	CLASS D PATCHES, TYPE II, 14 INCH	SQ YD	5746	5746		
44201819	CLASS D PATCHES, TYPE III, 14 INCH	SQ YD	1104	1104		
44201821	CLASS D PATCHES, TYPE IV, 14 INCH	SQ YD	308	308		
48101200	AGGREGATE SHOULDERS, TYPE B	TON	5245	5245		
66700205	PERMANENT SURVEY MARKERS, TYPE I	EACH	9	9		
67000500	ENGINEER'S FIELD OFFICE, TYPE B	CAL MO	6	6		
67100100	MOBILIZATION	L SUM	1	1		
70100460	TRAFFIC CONTROL AND PROTECTION, STANDARD 701306	L SUM	1	1		
70100600	TRAFFIC CONTROL AND PROTECTION, STANDARD 701336	L SUM	1	1		
70300100	SHORT-TERM PAVEMENT MARKING	FOOT	25380	25380		
70300220	TEMPORARY PAVEMENT MARKING - LINE 4"	FOOT	145009	145009		
70301000	WORK ZONE PAVEMENT MARKING REMOVAL	SQ FT	2115	2115		
* 78001110	PAINT PAVEMENT MARKING - LINE 4"	FOOT	145009	145009		
* 78100100	RAISED REFLECTIVE PAVEMENT MARKER	EACH	793	793		
* 88600100	DETECTOR LOOP, TYPE I	FOOT	154	154		
* X0300780	PIEZO ELECTRIC SENSOR CABLE IN CONDUIT	FOOT	45	45		
* X0323015	PIEZO ELECTRIC AXLE SENSOR, CLASS II	FOOT	26	26		
X0323016	ELECTRIC CABLE IN CONDUIT = 14-7STRAND XHHW XLP-600V	FOOT	102	102		
X4421000	PARTIAL DEPTH PATCHING	TON	6313	6313		
X4422000	PARTIAL DEPTH REMOVAL (VARIABLE DEPTH)	SQ YD	28184	28184		
Z0025500	FURNISHING AND INSTALLING PROPERTY MARKERS	EACH	7	7		
Δ Z0076600	TRAINEES	HOUR	500	500		

Δ 0042
*Specialty Items

FILE NAME =	USER NAME = teasleyck	DESIGNED -	REVISED -	STATE OF ILLINOIS DEPARTMENT OF TRANSPORTATION	SUMMARY OF QUANTITIES	F.A.P. RTE.	SECTION	COUNTY	TOTAL SHEETS	TOTAL SHEET NO.	
c:\pwork\pwork\teasleyck\20240815\074985-shr-500.dgn		DRAWN -	REVISED -			116	120RS-2, 4RS-3	Jasper	18	3	
PLOT SCALE = 100.0000' / IN.		CHECKED -	REVISED -			CONTRACT NO. 94985					
PLOT DATE = 10/27/2010		DATE -	REVISED -			ILLINOIS FED. AID PROJECT					

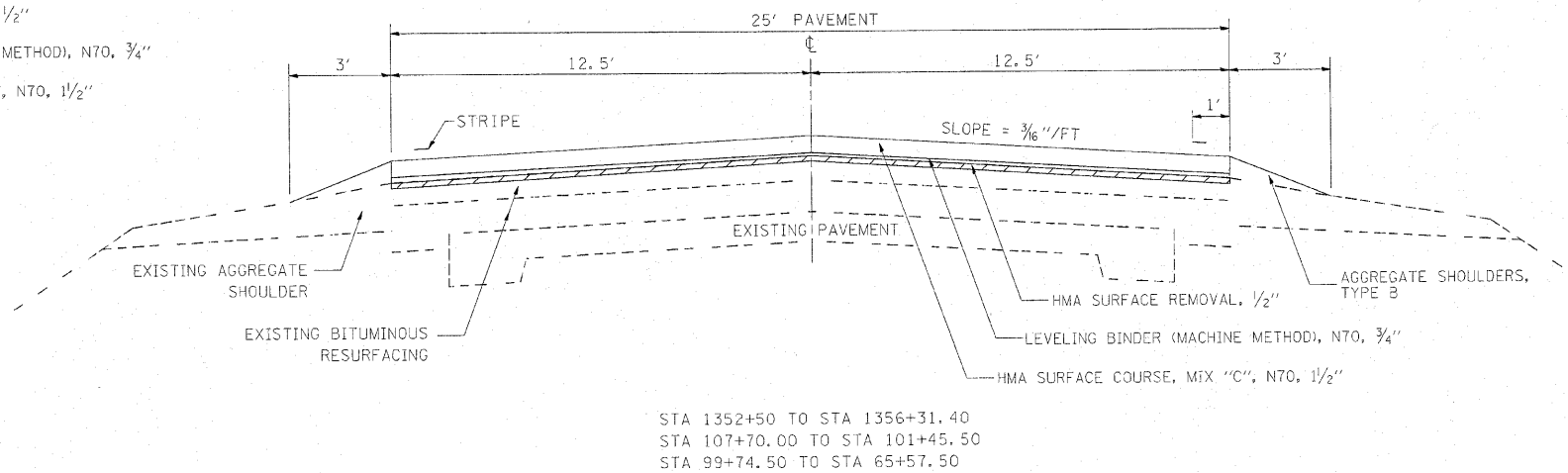
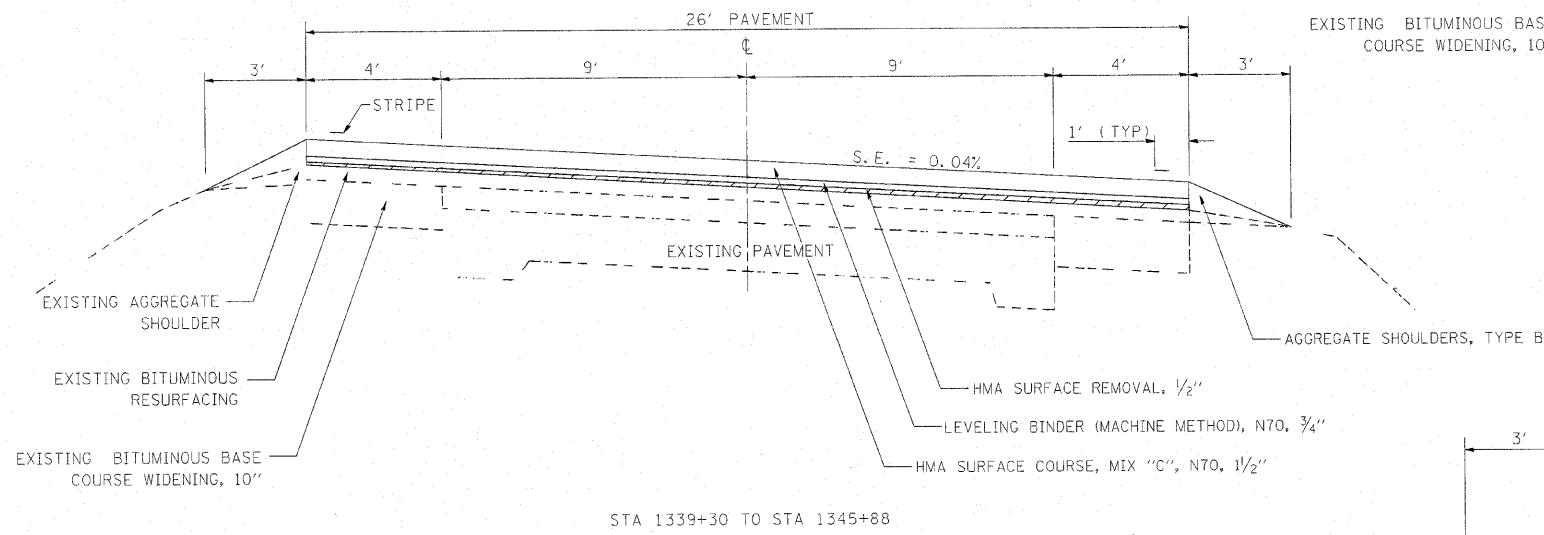
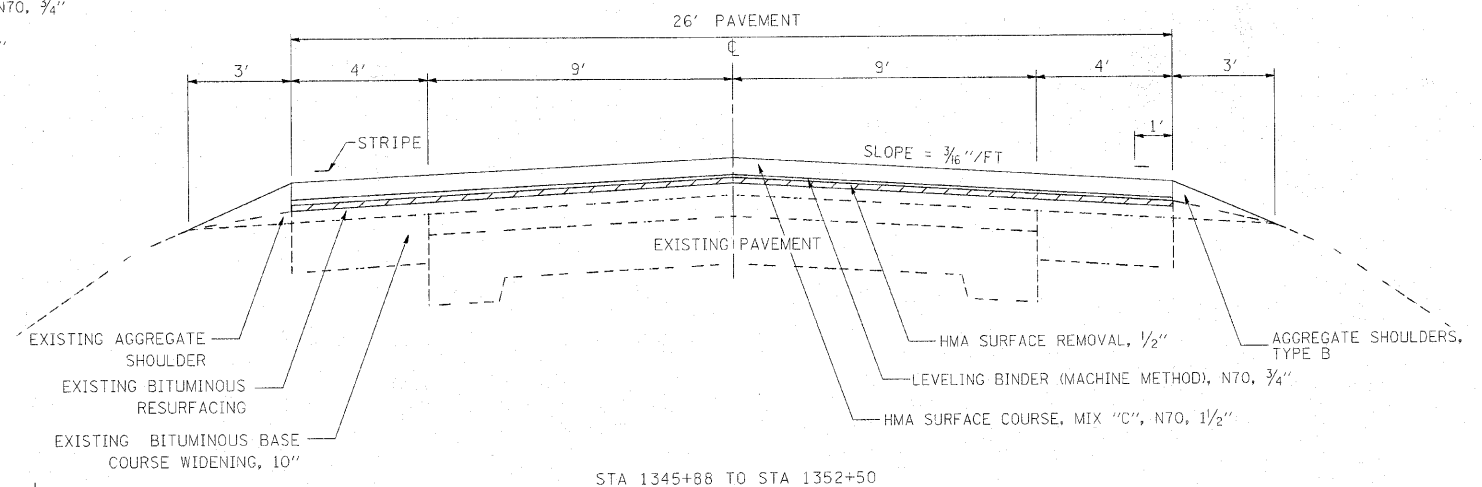
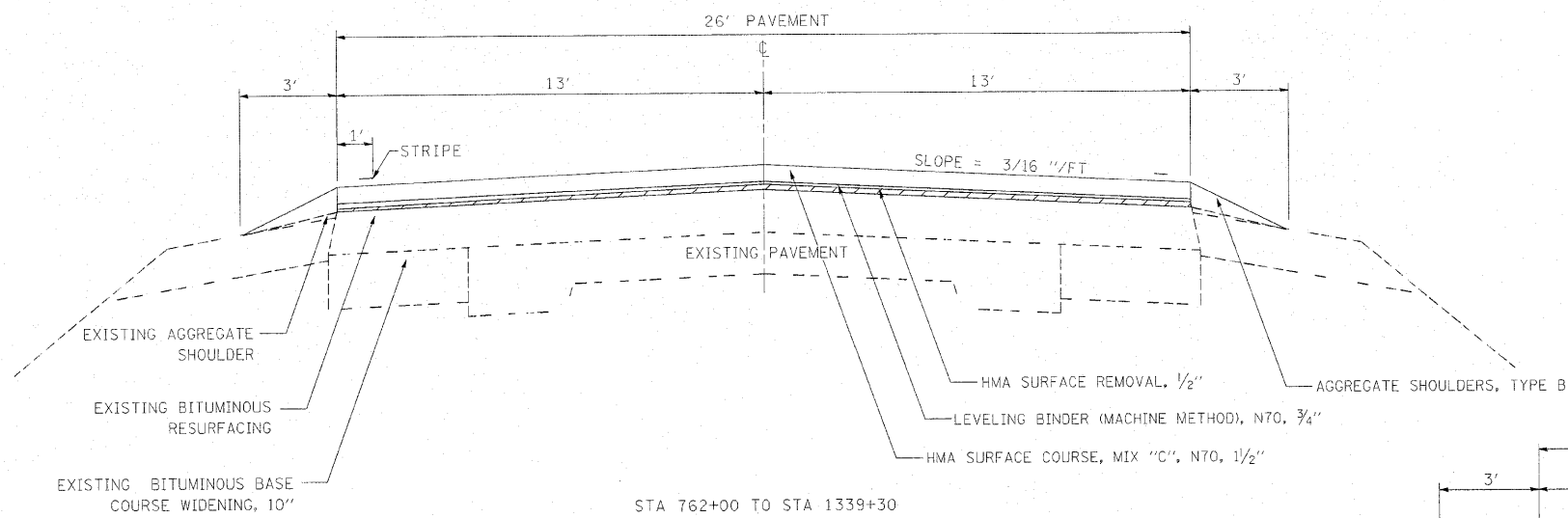

FILE NAME =	USER NAME = #USER#	DESIGNED -	REVISED -	STATE OF ILLINOIS DEPARTMENT OF TRANSPORTATION	TYPICAL SECTIONS				F.A.P. RTE.	SECTION	COUNTY	TOTAL SHEETS	SHEET NO.
#FILE#		DRAWN -	REVISED -		SCALE:	SHEET NO.	OF	SHEETS	STA.	TO STA.	Jasper	18	4
		CHECKED -	REVISED -								CONTRACT NO. 94985		
		DATE -	REVISED -								ILLINOIS FED. AID PROJECT		

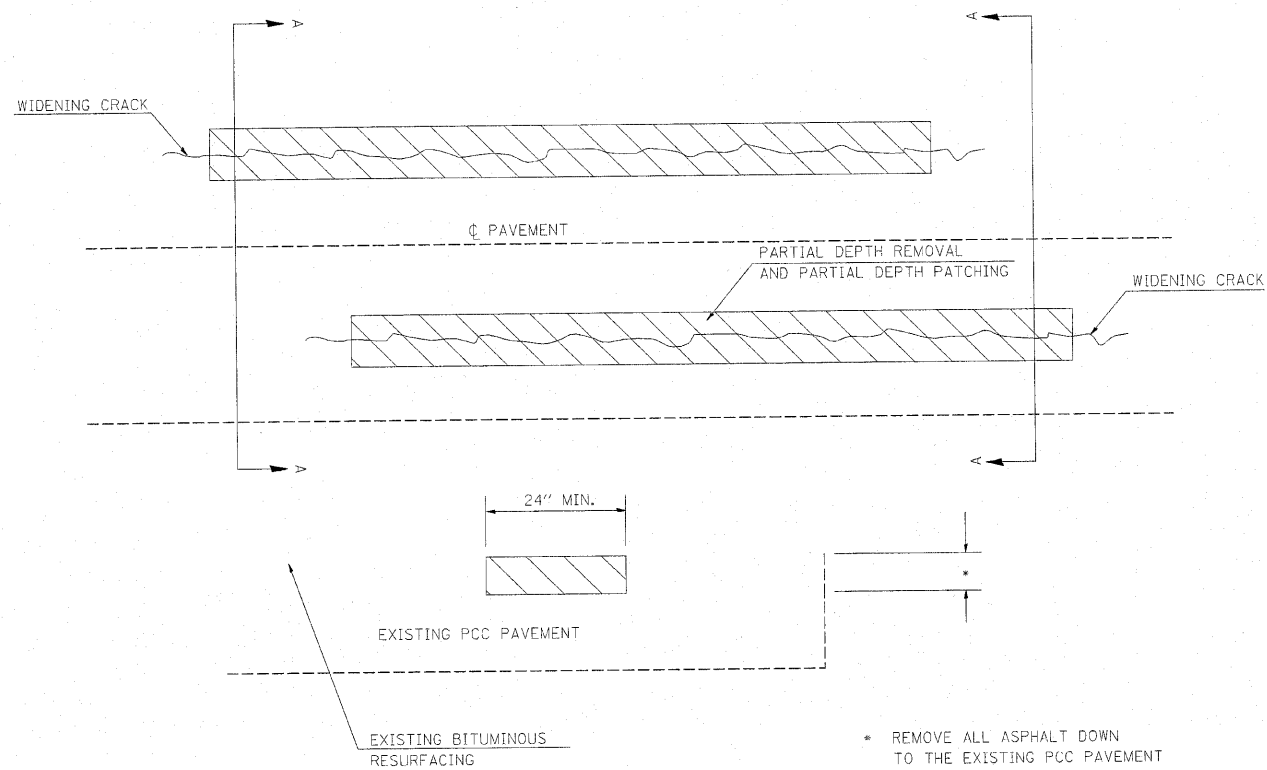

SECTION A-A

PARTIAL DEPTH PATCHING DETAIL

• REMOVE ALL ASPHALT DOWN TO THE EXISTING PCC PAVEMENT
ESTIMATE ASPHALT THICKNESS IS 4"

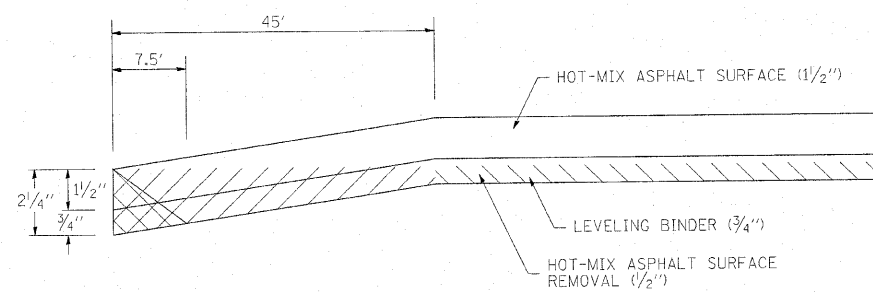

- HOT-MIX ASPHALT SURFACE REMOVAL BUTT JOINT
- HOT-MIX ASPHALT SURFACE REMOVAL (1/2")
- TEMPORARY RAMP

BUTT JOINT DETAIL

STA 762+00 TO STA 762+45
STA 101+90.5 TO STA 101+45.5
STA 99+74.5 TO STA 99+29.5
STA 66+02.5 TO STA 65+57.5

FILE NAME = #FILE#	USER NAME = #USER#	DESIGNED -	REVISED -	STATE OF ILLINOIS DEPARTMENT OF TRANSPORTATION	DETAILS			F.A.P. RTE. 116	SECTION 120RS-2, 4RS-3	COUNTY Jasper	TOTAL SHEETS 18	SHEET NO. 5
	PLOT SCALE = #SCALE#	DRAWN -	REVISED -		SCALE:	SHEET NO.	OF	SHEETS	STA.	TO STA.	ILLINOIS FED. AID PROJECT CONTRACT NO. 94985	
PLOT DATE = #DATE#	DATE -	CHECKED -	REVISED -									

PAVEMENT MARKING SCHEDULE		SHORT-TERM PAVEMENT MARKING	WORK-ZONE PAVEMENT MARKING REMOVAL	TEMPORARY PAVEMENT MARKING LINE - 4"	PAINT PAVEMENT MARKING LINE, 4"	RAISED REFLECTIVE PAVEMENT MARKERS
STATION TO STATION		FT	(SQ FT)	(FOOT)	(FOOT)	(EACH)
762+00.0	789+54.7	1102	92	6098	6098	34
789+74.3	830+75.3	1640	137	9120	9120	51
830+75.1	838+00.8	290	24	1632	1632	9
838+00.0	1345+87.8	20315	1693	116687	116687	635
1345+92.4	1356+31.4	416	35	2338	2338	13
107+70.0	65+57.5	1617	134	9134	9134	51
		25380	2115	145009	145009	793

FURNISHING AND INSTALLING PROPERTY MARKERS		QUANTITY
LOCATION	DESCRIPTION	EACH
SOUTH 1/4 CORNER SEC 6	FOUND PK NAIL	1
APPROX STA 930+70	FOUND PK NAIL	1
NORTHWEST COR. SOUTHEAST 1/4 SEC 31	FOUND PK NAIL	1
SOUTH 1/4 CORNER SEC 31	FOUND RR SPIKE	1
NORTH 1/4 CORNER SEC 6	FOUND PK NAIL	1
NORTHEAST CORNER NORTHWEST 1/4 SEC 18	FOUND RR SPIKE	1
SOUTH 1/4 CORNER SEC 19	FOUND PK NAIL	1
TOTAL		7

PAVING SCHEDULE		BITUMINOUS MATERIALS PRIME COAT	AGGREGATE (PRIME COAT)	LEVELING BINDER (MACHINE METHOD), N70	HOT-MIX ASPHALT SURFACE REMOVAL - BUTT JOINT	TEMPORARY RAMP	HOT-MIX ASPHALT SURFACE COURSE, MIX "C", N 70	HOT-MIX ASPHALT SURFACE REMOVAL, 1/2"	AGGREGATE SHOULDERS, TYPE B
STATION TO STATION		(TON)	(TON)	(FOOT)	(FOOT)	(EACH)	(TON)	SQ YD	(TON)
762+00.0	789+54.7	796	16	334	130	36	668	7958	229
789+74.3	830+75.3	1185	24	498			995	11847	338
830+75.1	838+00.8	210	4	88			176	2097	62
838+00.0	1345+87.8	14672	293	6162			12325	146720	4198
1345+92.4	1356+31.4	296	6	125			249	2960	83
107+70.0	65+57.5	1122	23	471	375	106	943	11226	335
		18281	366	7678	505	142	15356	182808	5245

PERMANENT SURVEY MARKERS		QUANTITY
LOCATION	DESCRIPTION	EACH
780+21.9	PC	1
789+54.7 BK = 789+74.3 AH	PT	1
817+25.1	PC	1
830+75.6 BK = 830+75.1 AH	PT	1
877+00.00	PI	1
1011+00.00	PI	1
1246+00.00	PI	1
1339+29.8	PC	1
1345+87.8 BK = 1345+92.4 A	PT	1
TOTAL		9

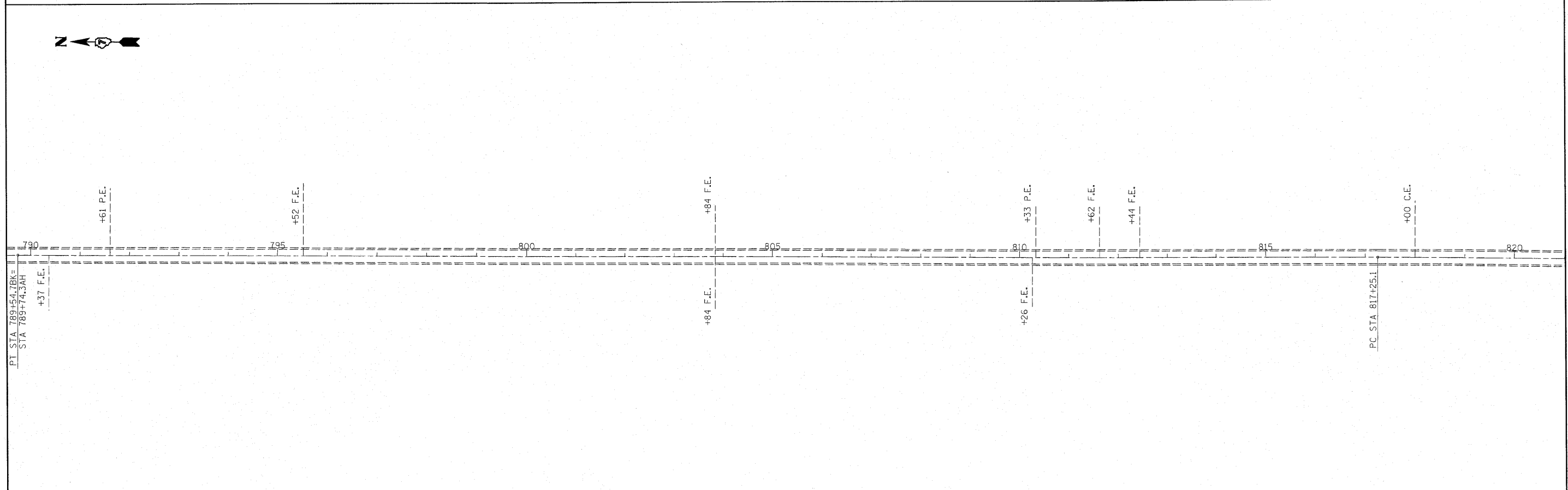
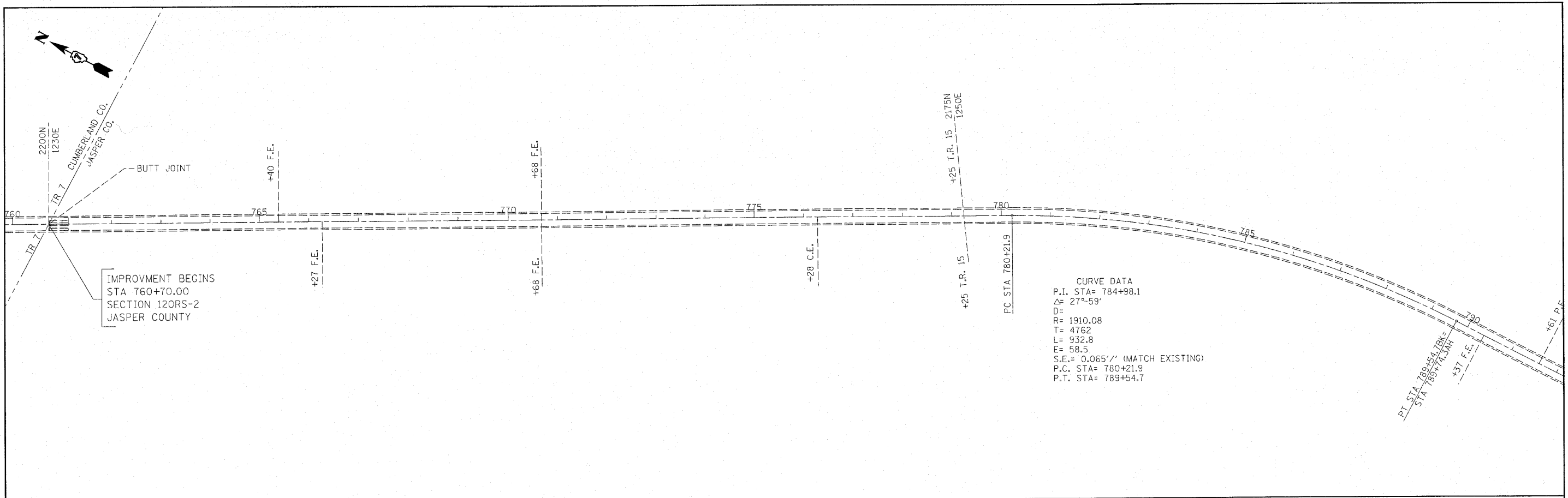

FILE NAME = c:\pwwork\pwwidat\teesleyck\d0240815\079	USER NAME = teesleyck	DESIGNED -	REVISED -	STATE OF ILLINOIS DEPARTMENT OF TRANSPORTATION	PLAN SHEET			F.A.P. RTE.	SECTION	COUNTY	TOTAL SHEETS	SHEET NO.
	4985-ahp-plan.dgn	DRAWN -	REVISED -		STA 760+00 TO STA 820+00			116	12ORS-2, 4RS-3	Jasper	18	8
PLOT SCALE = 100.0000' / IN.	CHECKED -	REVISED -	REVISED -		SCALE:	SHEET NO.	OF SHEETS	STA.	TO STA.	ILLINOIS FED. AID PROJECT		
PLOT DATE = 10/27/2010	DATE -	REVISED -	REVISED -		CONTRACT NO. 94985							



CURVE DATA
 P.I. STA= 824+00.2
 $\Delta = 2^{\circ}15'$
 $D = 0^{\circ}10'$
 $R = 343377.5$
 $T = 675.1$
 $L = 1350$
 $E = 6.6$
 S.E. = MATCH EXISTING
 P.C. STA= 817+25.1
 P.T. STA= 830+75.3

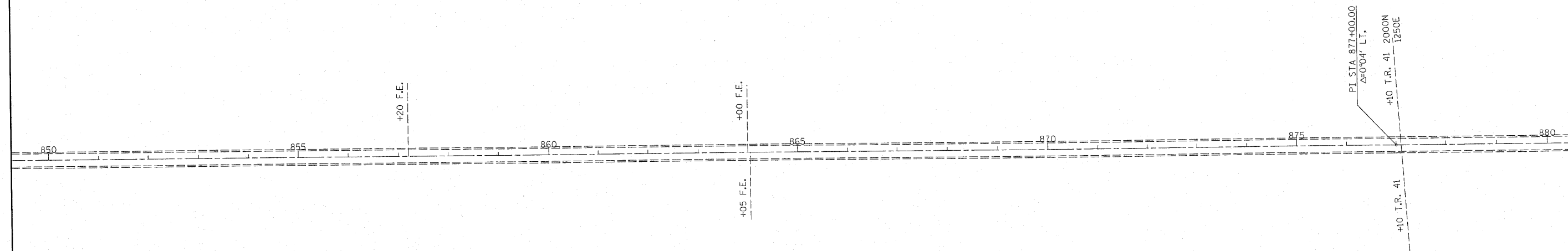
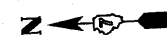
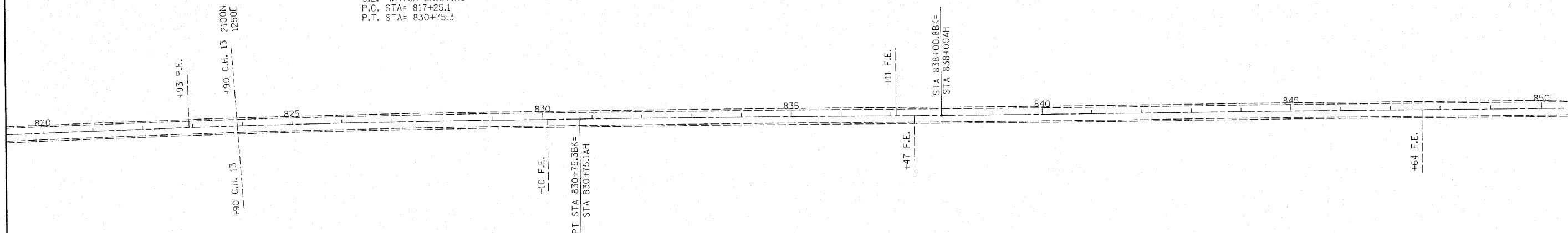

FILE NAME =
 c:\pw\work\p\dot\teesleyck\d0240815\07

USER NAME = teesleyck
 4985-sht-plan.dgn
 PLOT SCALE = 100.0000' / IN.
 PLOT DATE = 10/27/2010

DESIGNED -
 DRAWN -
 CHECKED -
 DATE -

REVISED -
 REVISED -
 REVISED -
 REVISED -

STATE OF ILLINOIS
 DEPARTMENT OF TRANSPORTATION

PLAN SHEET
 STA 820+00 TO STA 880+00

SCALE: SHEET NO. OF SHEETS STA. TO STA.

F.A.P. RTE.	SECTION	COUNTY	TOTAL SHEETS	SHEET NO.
116	120RS-2, 4RS-3	Jasper	18	9
CONTRACT NO. 94985			ILLINOIS FED. AID PROJECT	

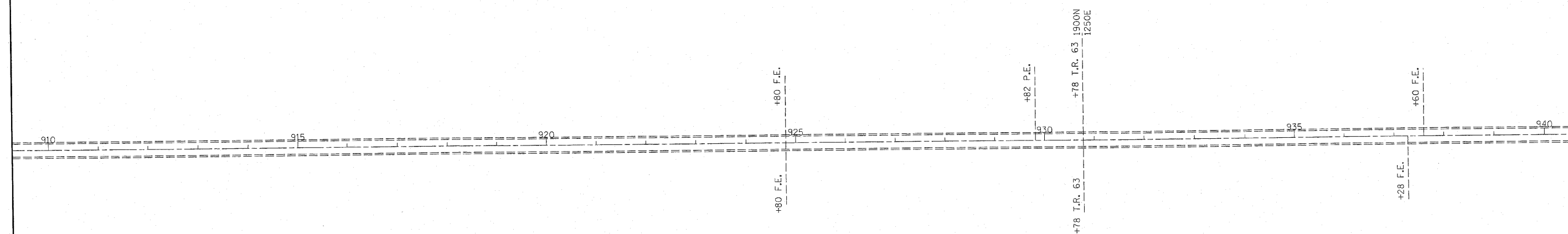
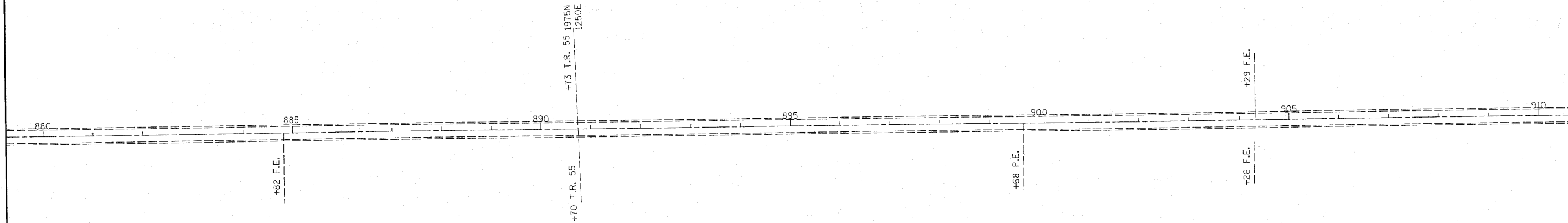

FILE NAME =	USER NAME = teasleyck	DESIGNED -	REVISED -
ca:\pwwork\pwwork\teasleyck\0240815\07	4985-shht-plan.dgn	DRAWN -	REVISED -
	PLOT SCALE = 1/80.00000 ' / IN.	CHECKED -	REVISED -
	PLOT DATE = 10/27/2010	DATE -	REVISED -

**STATE OF ILLINOIS
DEPARTMENT OF TRANSPORTATION**

**PLAN SHEET
STA 880+00 TO STA 940+00**

SCALE: SHEET NO. OF SHEETS STA. TO STA.

F.A.P. RTE.	SECTION	COUNTY	TOTAL SHEETS	SHEET NO.
116	120RS-2, 4RS-3	Jasper	18	10
CONTRACT NO. 94985				
ILLINOIS FED. AID PROJECT				

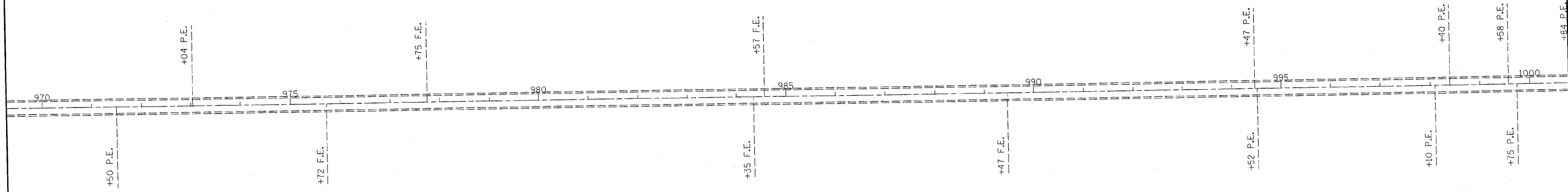
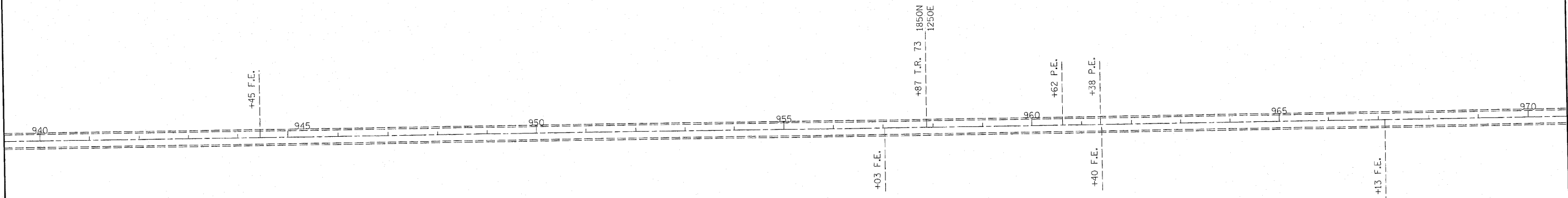

FILE NAME =	USER NAME = teasleyok	DESIGNED -	REVISED -
c:\pwwork\pwwork\teasleyok\d0240815\074985-ehs-plan.dgn		DRAWN -	REVISED -
PLOT SCALE = 100.0000' / IN.		CHECKED -	REVISED -
PLOT DATE = 10/27/2010		DATE -	REVISED -

**STATE OF ILLINOIS
DEPARTMENT OF TRANSPORTATION**

PLAN SHEET			
STA 940+00 TO STA 1000+00			
SCALE:	SHEET NO.	OF SHEETS	STA. TO STA.

F.A.P. RTE.	SECTION	COUNTY	TOTAL SHEETS	SHEET NO.
116	12ORS-2, 4RS-3	Jasper	18	11
CONTRACT NO. 94985				
ILLINOIS FED. AID PROJECT				

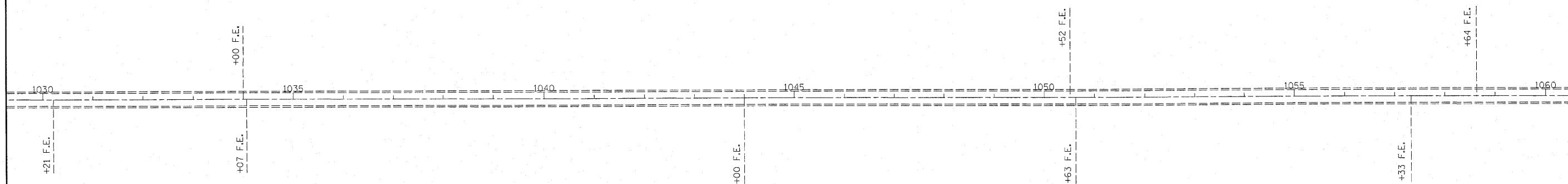
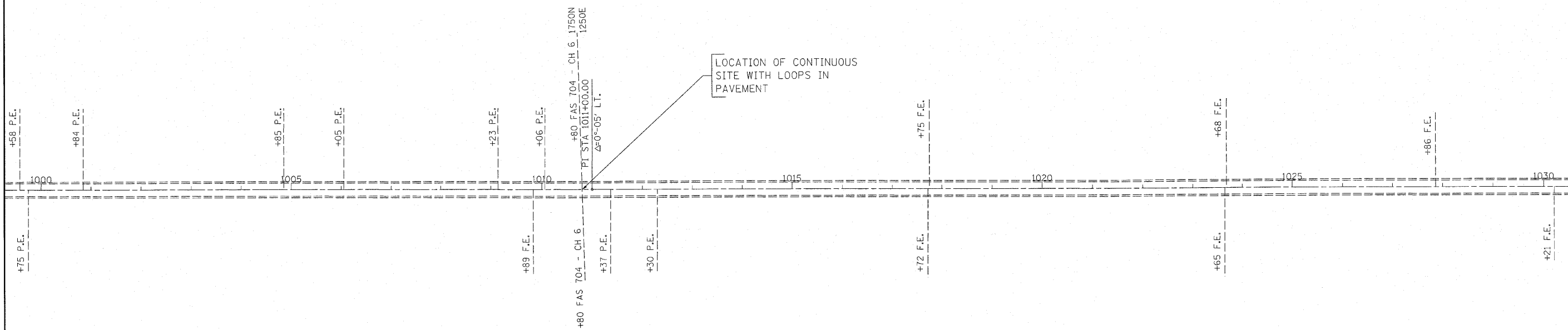

FILE NAME = c:\pwwork\p\idot\teesleyck\d0240815\074985-sh1-plan.dgn	USER NAME = teesleyck	DESIGNED -	REVISED -	STATE OF ILLINOIS DEPARTMENT OF TRANSPORTATION	PLAN SHEET STA 1000+00 TO STA 1060+00				F.A.P. RTE.	SECTION	COUNTY	TOTAL SHEETS	SHEET NO.		
	PLOT SCALE = 100.0000 "/> <td>DATE = 12/27/2010</td> <td>CHECKED -</td> <td>REVISED -</td> <td>SCALE:</td> <td>SHEET NO.</td> <td>OF</td> <td>SHEETS</td> <td>STA.</td> <td>TO STA.</td> <td>116</td> <td>120RS-2, 4RS-3</td> <td>Jasper</td> <td>18</td> <td>12</td>	DATE = 12/27/2010	CHECKED -		REVISED -	SCALE:	SHEET NO.	OF	SHEETS	STA.	TO STA.	116	120RS-2, 4RS-3	Jasper	18
CONTRACT NO. 94985															
ILLINOIS FED. AID PROJECT															

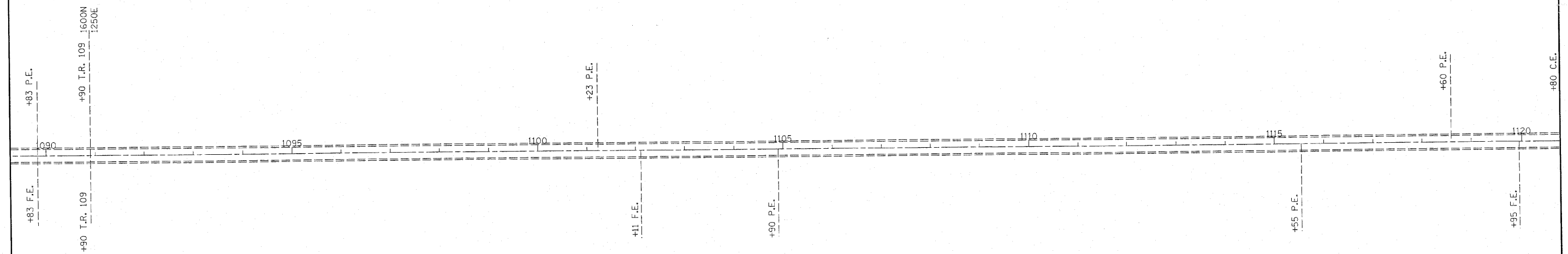
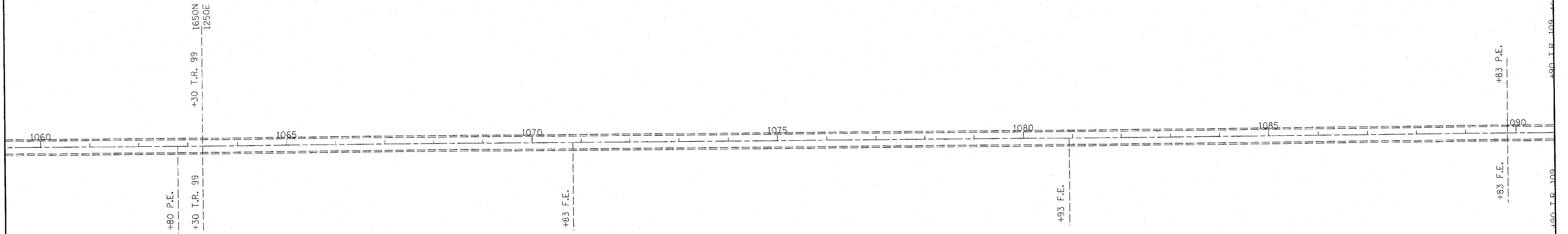

FILE NAME =
c:\pwork\pwork\teasleyk\d0240815\07

USER NAME = teasleyk
4985-ahd-plot.dgn
PLOT SCALE = 100.0000' / IN.
PLOT DATE = 10/27/2010

DESIGNED -
DRAWN -
CHECKED -
DATE -

REVISED -
REVISED -
REVISED -
REVISED -

**STATE OF ILLINOIS
DEPARTMENT OF TRANSPORTATION**

**PLAN SHEET
STA 1060+00 TO STA 1120+00**

SCALE: SHEET NO. OF SHEETS STA. TO STA.

F.A.P. RTE.	SECTION	COUNTY	TOTAL SHEETS	SHEET NO.
116	120RS-2, 4RS-3	Jasper	18	13
CONTRACT NO. 94985			ILLINOIS FED. AID PROJECT	

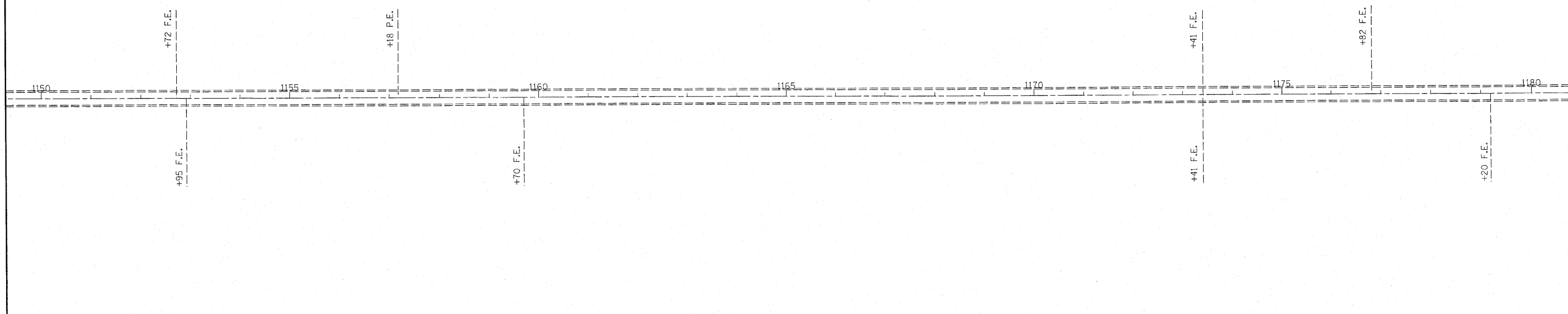
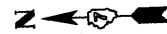
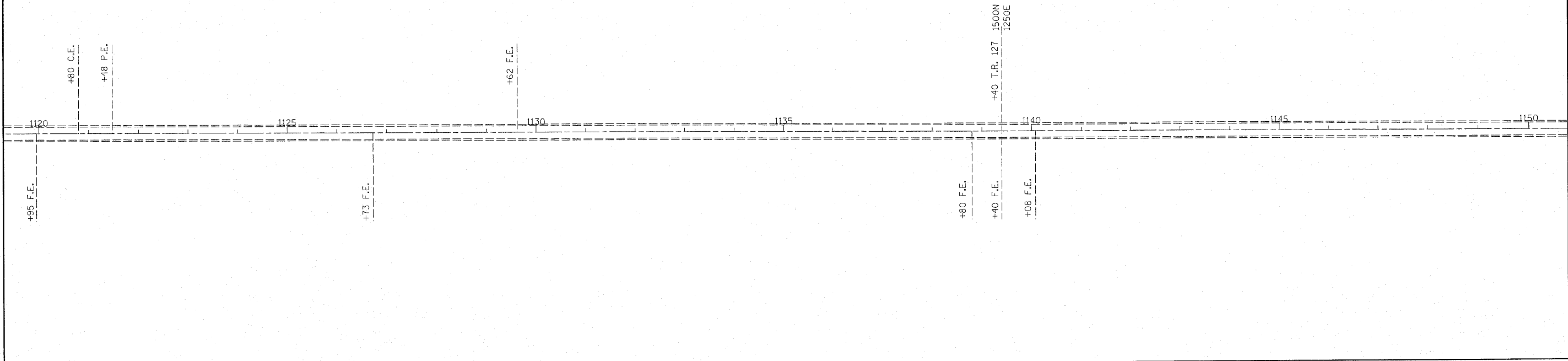

FILE NAME = c:\pw_work\pwidot\teasleyck\0240815\074985-sht-plan.dgn	USER NAME = teasleyck	DESIGNED -	REVISED -	STATE OF ILLINOIS DEPARTMENT OF TRANSPORTATION	PLAN SHEET STA 1120+00 TO STA 1180+00			F.A.P. RTE.	SECTION	COUNTY	TOTAL SHEETS	SHEET NO.
	PLOT SCALE = 100.0000' / IN.	CHECKED -	REVISED -		116	120RS-2, 4RS-3	Jasper	18	14			
PLOT DATE = 10/27/2010	DATE -	REVISED -	REVISED -		SCALE:	SHEET NO. OF SHEETS	STA. TO STA.	ILLINOIS FED. AID PROJECT				
CONTRACT NO. 94985												

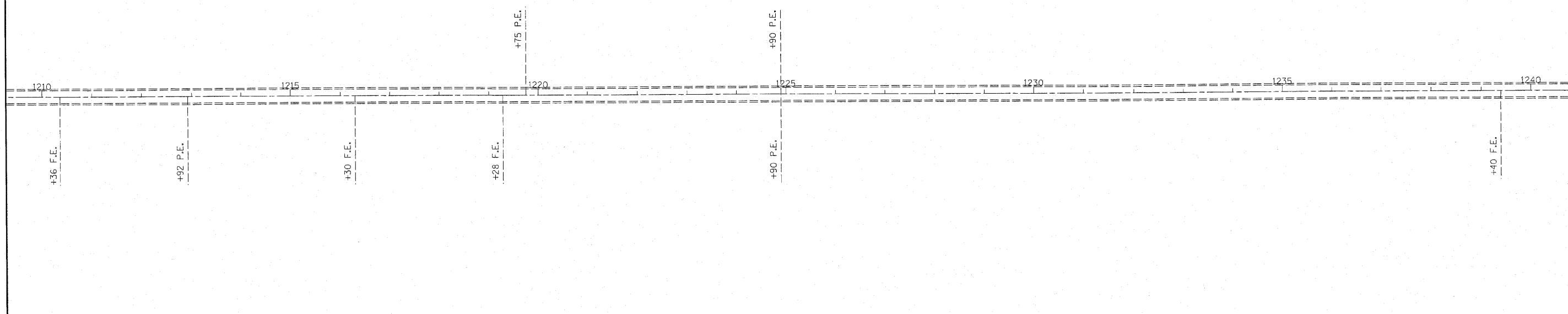
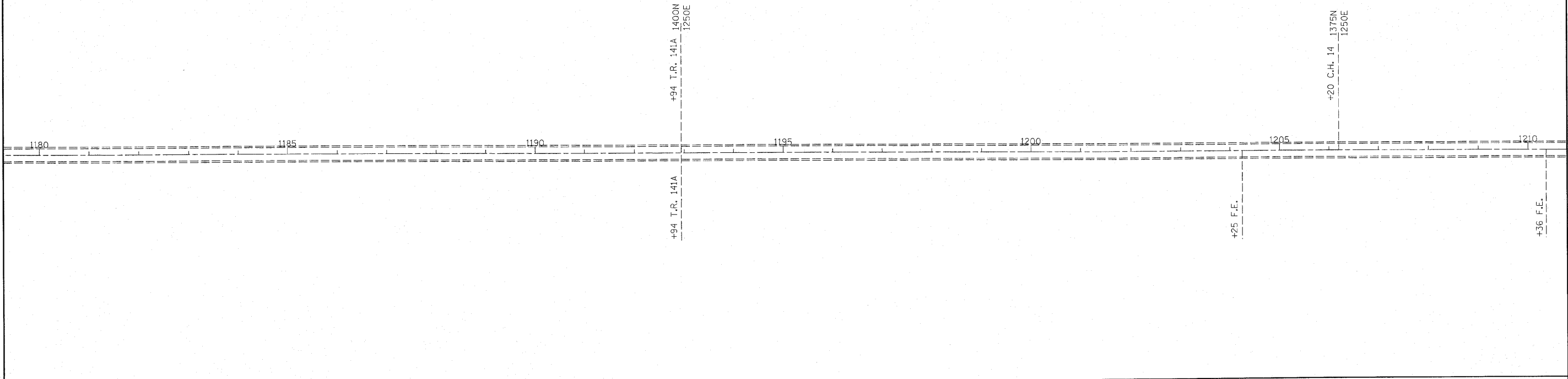

FILE NAME =
 c:\pwork\pwork\teasleyck\0240815\074

USER NAME = teasleyck
 94985-shr-plan.dgn
 PLOT SCALE = 100.0000' / IN.
 PLOT DATE = 10/27/2010

DESIGNED -
 DRAWN -
 CHECKED -
 DATE -

REVISED -
 REVISED -
 REVISED -
 REVISED -

**STATE OF ILLINOIS
 DEPARTMENT OF TRANSPORTATION**

PLAN SHEET
STA 1180+00 TO STA 1240+00
 SCALE: SHEET NO. OF SHEETS STA. TO STA.

F.A.P. RTE.	SECTION	COUNTY	TOTAL SHEETS	SHEET NO.
116	12ORS-2, 4RS-3	Jasper	18	15
CONTRACT NO. 94985				
ILLINOIS FED. AID PROJECT				

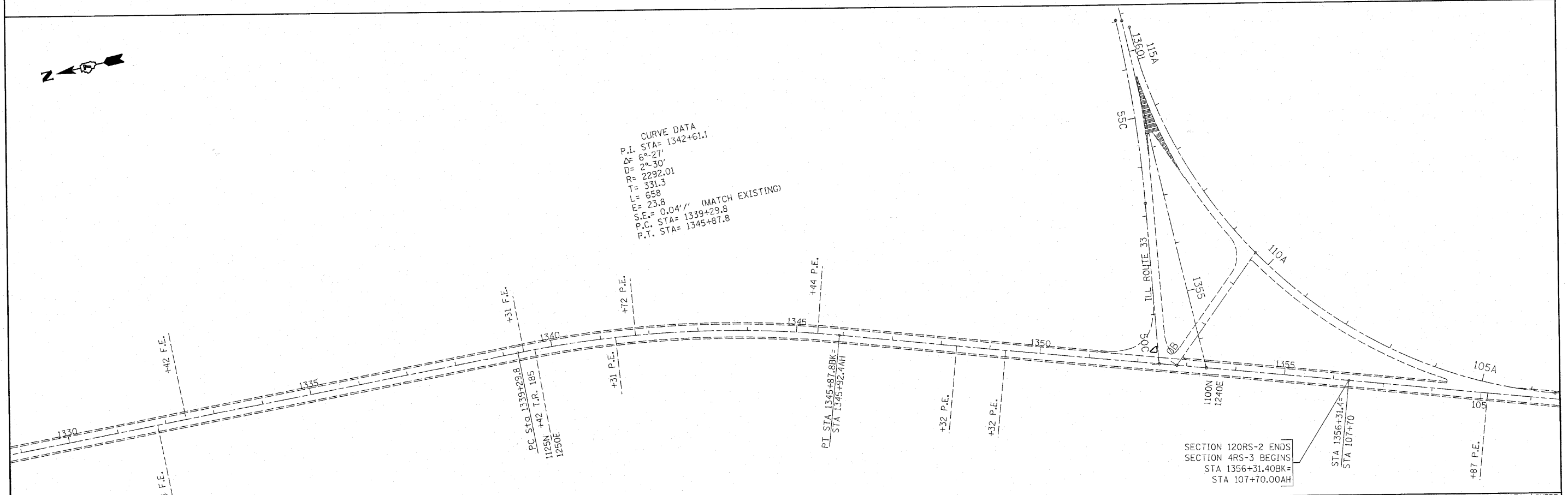
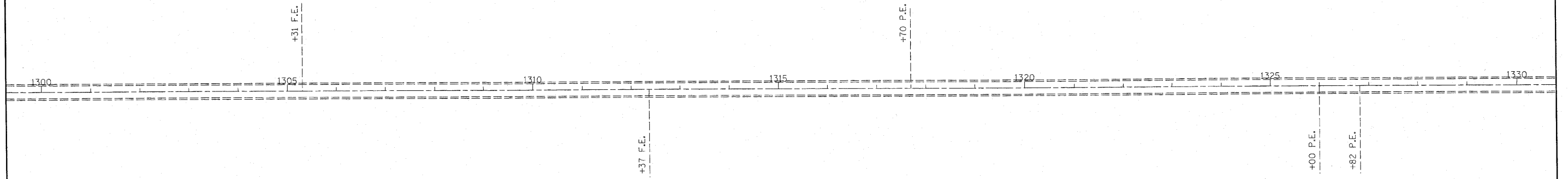

FILE NAME =
 c:\pwork\pudot\teesleyck\d0248815\D74985-shr-plan.dgn

USER NAME = teesleyck
 PLOT SCALE = 1/8" = 100.0000' / IN.
 PLOT DATE = 10/27/2010

DESIGNED -
 DRAWN -
 CHECKED -
 DATE -

REVISED -
 REVISED -
 REVISED -
 REVISED -

**STATE OF ILLINOIS
 DEPARTMENT OF TRANSPORTATION**

**PLAN SHEET
 STA 1300+00 TO STA 105+00**

SCALE: SHEET NO. OF SHEETS STA. TO STA.

F.A.P. RTE.	SECTION	COUNTY	TOTAL SHEETS	SHEET NO.
116	120RS-2, 4RS-3	Jasper	18	17
CONTRACT NO. 94985			ILLINOIS FED. AID PROJECT	

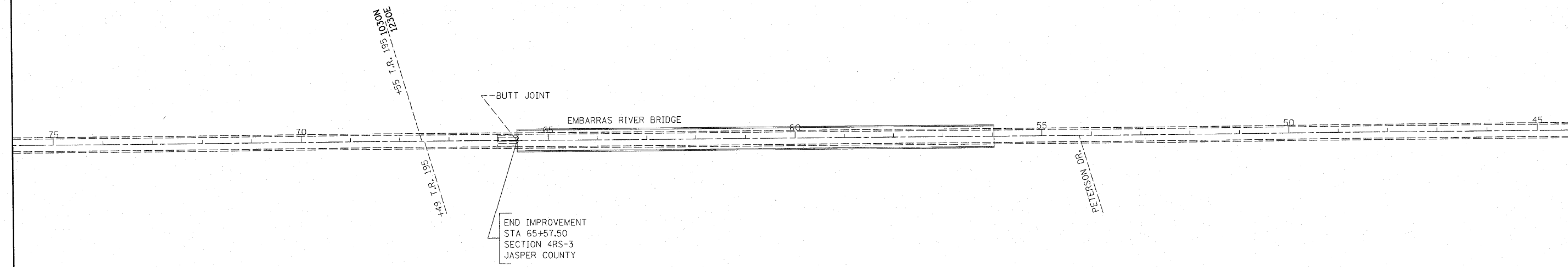
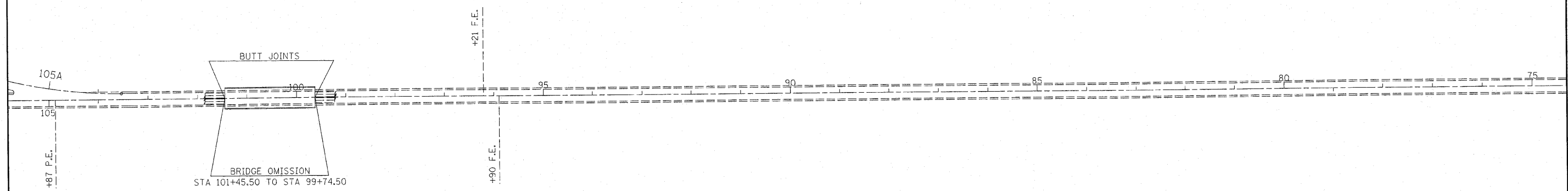

FILE NAME = c:\pv_work\pavdot\toasleyc\0240815\074985-sht-plan.dgn	USER NAME = toasleyc	DESIGNED -	REVISED -	STATE OF ILLINOIS DEPARTMENT OF TRANSPORTATION	PLAN SHEET			F.A.P. RTE.	SECTION	COUNTY	TOTAL SHEETS	SHEET NO.
	PLOT SCALE = 100.0000' / IN.	DRAWN -	REVISED -		STA 105+00 TO STA 45+00			116	12ORS-2, 4RS-3	Jasper	18	18
	PLOT DATE = 10/27/2010	CHECKED -	REVISED -		SCALE:	SHEET NO. OF SHEETS	STA. TO STA.	ILLINOIS FED. AID PROJECT				
		DATE -	REVISED -									