

ROUTE NO.	SECTION	CITY	TOTAL SHEETS	SHEET NO.
05-00001-00-RP		OREANA	46	12
FED. ROAD DIST. NO.	ILLINOIS	PROJECT	HPP-0913 (001)	

CONTRACT NUMBER 95537

NO.	BY	DATE
1	MAP	1-30-04
2	MAP	1-30-04
3	MAP	1-30-04
4	MAP	1-30-04
5	MAP	1-30-04
6	MAP	1-30-04
7	MAP	1-30-04
8	MAP	1-30-04
9	MAP	1-30-04
10	MAP	1-30-04
11	MAP	1-30-04
12	MAP	1-30-04
13	MAP	1-30-04
14	MAP	1-30-04
15	MAP	1-30-04
16	MAP	1-30-04
17	MAP	1-30-04
18	MAP	1-30-04
19	MAP	1-30-04
20	MAP	1-30-04
21	MAP	1-30-04
22	MAP	1-30-04
23	MAP	1-30-04
24	MAP	1-30-04
25	MAP	1-30-04
26	MAP	1-30-04
27	MAP	1-30-04
28	MAP	1-30-04
29	MAP	1-30-04
30	MAP	1-30-04
31	MAP	1-30-04
32	MAP	1-30-04
33	MAP	1-30-04
34	MAP	1-30-04
35	MAP	1-30-04
36	MAP	1-30-04
37	MAP	1-30-04
38	MAP	1-30-04
39	MAP	1-30-04
40	MAP	1-30-04
41	MAP	1-30-04
42	MAP	1-30-04
43	MAP	1-30-04
44	MAP	1-30-04
45	MAP	1-30-04
46	MAP	1-30-04
47	MAP	1-30-04
48	MAP	1-30-04
49	MAP	1-30-04
50	MAP	1-30-04
51	MAP	1-30-04
52	MAP	1-30-04
53	MAP	1-30-04
54	MAP	1-30-04
55	MAP	1-30-04
56	MAP	1-30-04
57	MAP	1-30-04
58	MAP	1-30-04
59	MAP	1-30-04
60	MAP	1-30-04
61	MAP	1-30-04
62	MAP	1-30-04
63	MAP	1-30-04
64	MAP	1-30-04
65	MAP	1-30-04
66	MAP	1-30-04
67	MAP	1-30-04
68	MAP	1-30-04
69	MAP	1-30-04
70	MAP	1-30-04
71	MAP	1-30-04
72	MAP	1-30-04
73	MAP	1-30-04
74	MAP	1-30-04
75	MAP	1-30-04
76	MAP	1-30-04
77	MAP	1-30-04
78	MAP	1-30-04
79	MAP	1-30-04
80	MAP	1-30-04
81	MAP	1-30-04
82	MAP	1-30-04
83	MAP	1-30-04
84	MAP	1-30-04
85	MAP	1-30-04
86	MAP	1-30-04
87	MAP	1-30-04
88	MAP	1-30-04
89	MAP	1-30-04
90	MAP	1-30-04
91	MAP	1-30-04
92	MAP	1-30-04
93	MAP	1-30-04
94	MAP	1-30-04
95	MAP	1-30-04
96	MAP	1-30-04
97	MAP	1-30-04
98	MAP	1-30-04
99	MAP	1-30-04
100	MAP	1-30-04

INBRIDGE & ASSOCIATES, INC.
Consulting Engineers
1670 SOUTH TAYLORVILLE ROAD
DECATUR, ILLINOIS 62521
Illinois License 184-001255

VILLAGE OF OREANA, ILLINOIS
SAFE TEA-LU PROJECT
PLAN AND PROFILE
BELLE STREET
STATION 28+00.00 TO 34+50.00

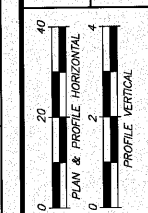

SHEET NO.
12
OF
46

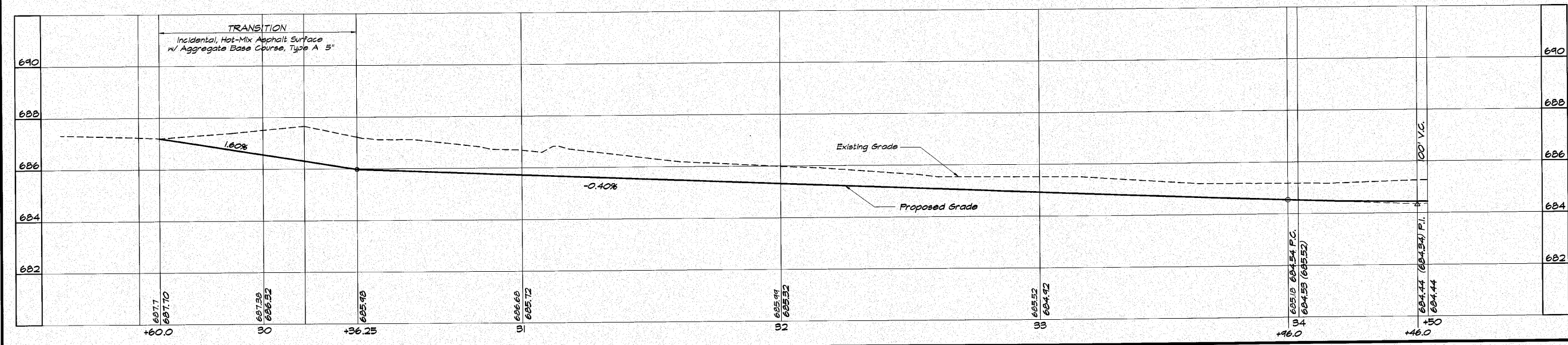
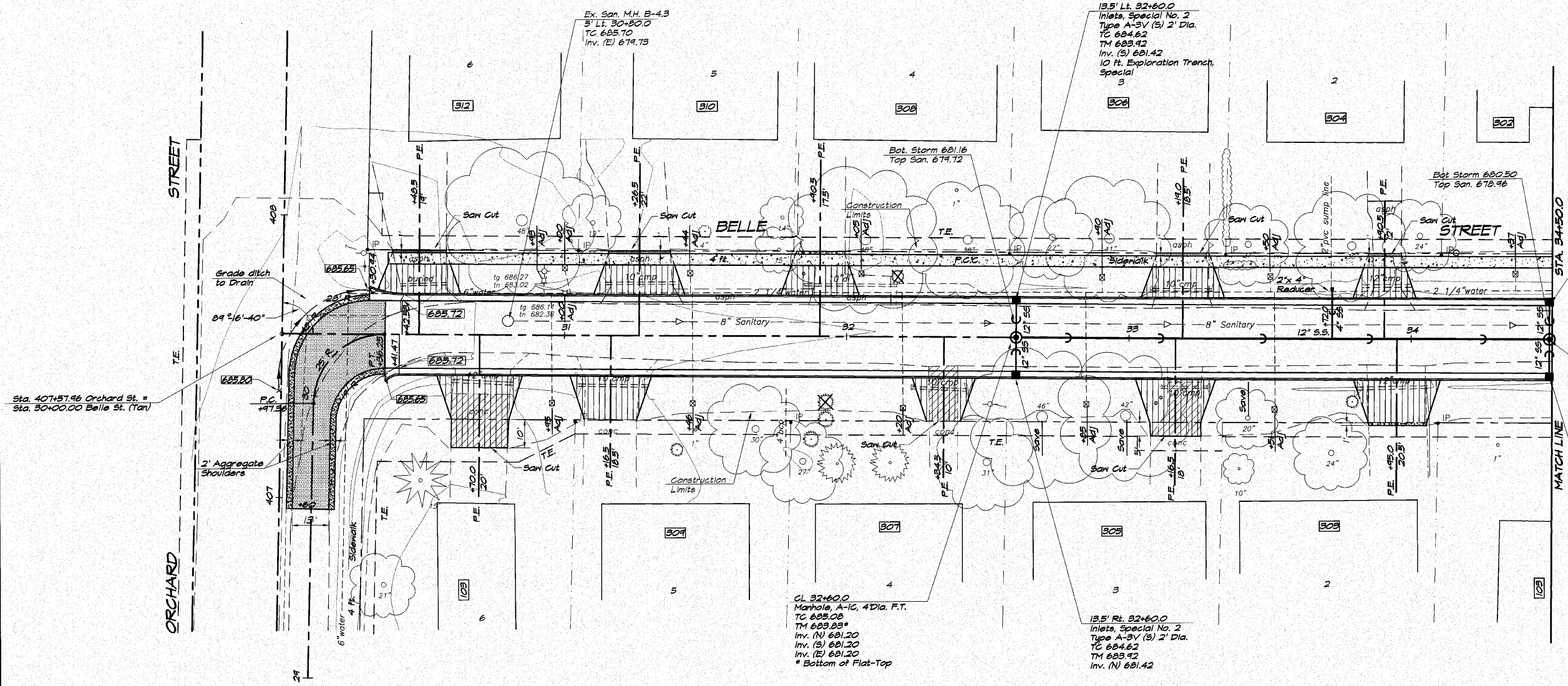

Sta. 40+51.96 Orchard St. =
Sta. 30+00.00 Belle St. (Tan)

13.5' Lt. 34+49.0
Inlets, Special No. 1
Type A-3 (S) 2' Dia.
TC 683.97
TM 683.27
Inv. (S) 680.77

CL 34+49.0
Manhole, A-1C, 4' Dia. F.T.
TC 684.43
TM 683.18*
Inv. (N) 680.50
Inv. (S) 680.50
Inv. (W) 680.50
Inv. (E) 680.30
* Bottom of Flat-Top

13.5' Rt. 34+49.0
Inlets, Special No. 1
Type A-3 (S) 2' Dia.
TC 683.97
TM 683.27
Inv. (S) 680.77

CL 32+60.0
Manhole, A-1C, 4' Dia. F.T.
TC 683.08
TM 683.85*
Inv. (N) 681.20
Inv. (S) 681.20
Inv. (E) 681.20
* Bottom of Flat-Top

13.5' Rt. 32+60.0
Inlets, Special No. 2
Type A-3V (S) 2' Dia.
TC 684.62
TM 683.92
Inv. (N) 681.42

Ex. San. M.H. B-4.3
5' Lt. 30+80.0
TC 685.70
Inv. (E) 679.73

13.5' Lt. 32+60.0
Inlets, Special No. 2
Type A-3V (S) 2' Dia.
TC 684.62
TM 683.92
Inv. (S) 681.42
10 Ft. Exploration Trench,
Special
3

Bot. Storm 681.16
Top San. 679.72

Bot. Storm 680.50
Top San. 679.96