

ROAD CLASSIFICATION: *MASOR COLLECTOR*  
 DESIGN SPEED: 50 M.P.H.

ADT:  
 (2009) = 1100  
 (2029) = 1400  
 PC = 1349  
 SU = 38  
 MU = 13  
 DHV<sub>20</sub> = 140

JOINT UTILITY LOCATING INFORMATION  
 FOR EXCAVATIONS (J.U.L.I.E.)  
 PHONE 1-800-892-0123

STATE OF ILLINOIS  
 DEPARTMENT OF TRANSPORTATION  
 DIVISION OF HIGHWAYS

PLANS FOR PROPOSED ROADWAY IMPROVEMENTS

FEDERAL-AID S.T.R. & T.A.R.P. PROJECT  
*FAS 873, CH3*

Franklin County, Illinois  
 Section *08-00171-00-RS*  
 Project *RS-0873(112)*  
 JOB *C-99-527-09*

RTE.	SECTION	COUNTY	TOTAL SHEETS	SHEET NO.
<i>FAS 873</i>	<i>08-00171-00-RS</i>	FRANKLIN	6	1

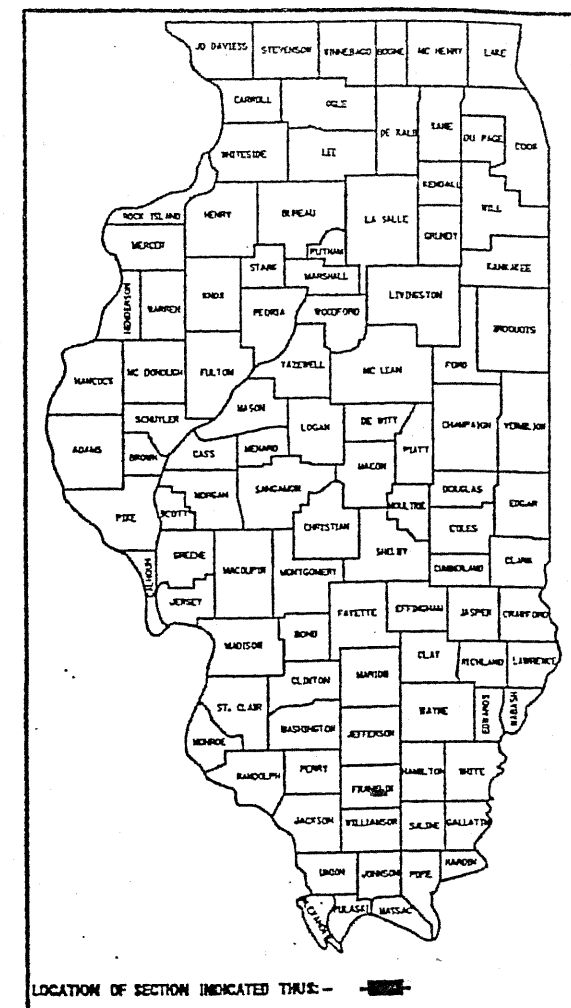

SHEET NO.	TITLE
1	COVER SHEET AND SUMMARY OF QUANTITIES
2	MISCELLANEOUS DETAILS
3	TYPICAL SECTIONS AND MISCELLANEOUS DETAILS
4-6	PLAN

STANDARDS

- 701006-03
- 701201-04
- 701301-04
- 701306-03
- 701311-03
- 701901-01
- 780001-02
- BLR 24-2

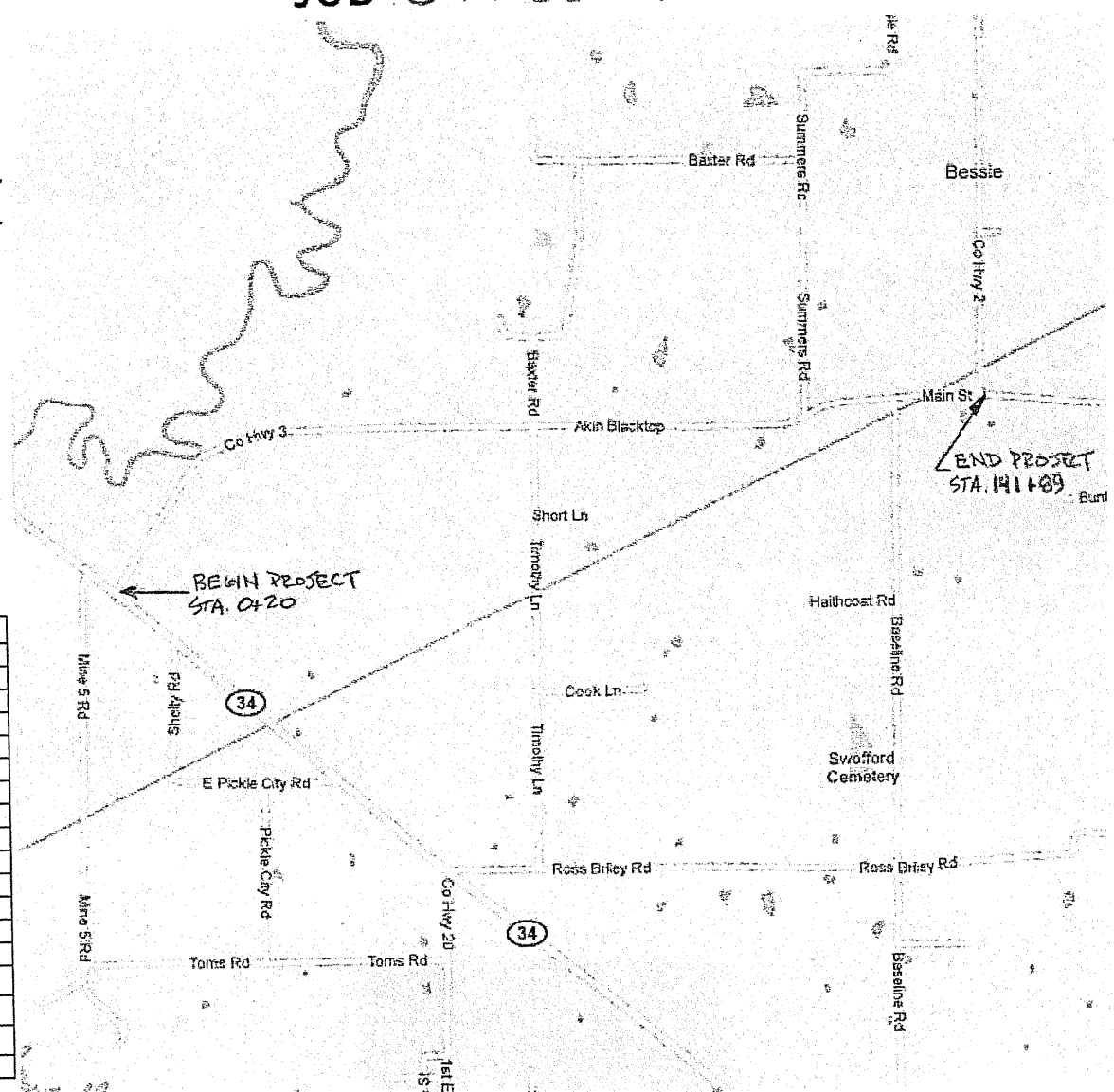

LOCATION MAP  
 NET LENGTH = 2.683 MILES (14,165 FEET)

SUMMARY OF QUANTITIES			
CODE NO.	PAY ITEM	UNIT	TOTAL
40200800	AGGREGATE SURFACE COURSE, TYPE B	TON	54
40600100	BITUMINOUS MATERIALS (PRIME COAT)	GALLON	259
40600982	HOT-MIX ASPHALT SURFACE REMOVAL	SQ YD	266
	-BUTT JOINT		
40603085	HOT-MIX ASPHALT BINDER COURSE,	TON	4,170
	IL 19.0, N70		
40603315	HOT-MIX ASPHALT SURFACE COURSE,	TON	3,393
	MIX "C", N70		
<i>X4401198</i>	HOT-MIX ASPHALT SURFACE REMOVAL	SQ YD	635
	-VARIABLE DEPTH		
48100100	AGGREGATE SHOULDERS, TYPE A	TON	3,550
67100100	MOBILIZATION	L SUM	1
70300100	SHORT-TERM PAVEMENT MARKING	FOOT	1,417
78000100	PAINT PAVEMENT MARKING - LETTERS & SYMBOLS	<i>SQ FT</i>	122.4
78000110	PAINT PAVEMENT MARKING - LINE 4"	FOOT	42,881
78000180	PAINT PAVEMENT MARKING - LINE 24"	FOOT	60
*20048665	RAILROAD PROTECTIVE LIABILITY INSURANCE	L SUM	1

△ SPECIALTY ITEMS  
 \* SEE SPECIAL PROVISIONS

CONTRACT NO. *99432*

STATE OF ILLINOIS  
 DEPARTMENT OF TRANSPORTATION

APPROVED *8-13-2010*  
  
 FRANKLIN COUNTY HIGHWAY ENGINEER

PASSED *8/31/2010*  
  
 DISTRICT 9 ENGINEER OF LOCAL ROADS & STREETS

RELEASING FOR BID  
 BASED ON LIMITED  
 REVIEW *8-31-2010*  
  
 DEPUTY DIRECTOR OF HIGHWAYS, REGION 5 ENGINEER

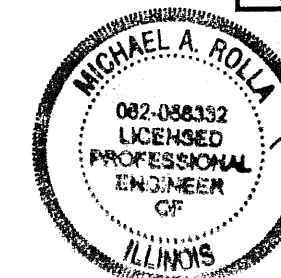

MICHAEL A. ROLLA  
 ILLINOIS REGISTERED PROFESSIONAL ENGINEER  
 #062-056332  
 LIC. EXPIRES NOVEMBER 30, 2011

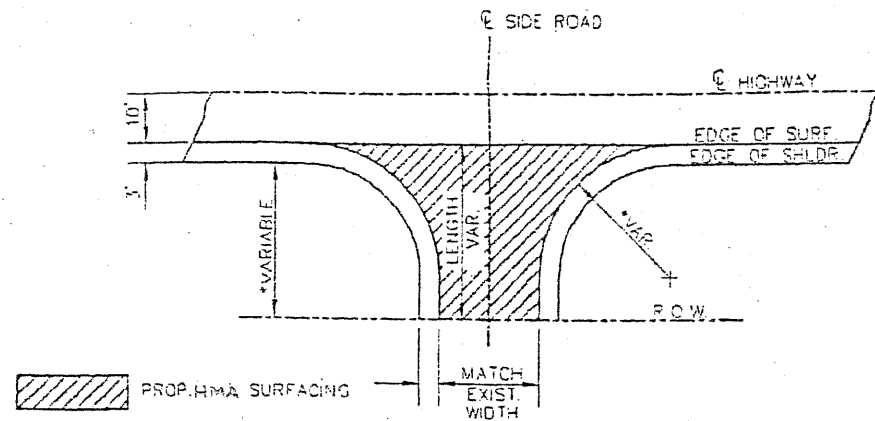

AS DIRECTED BY THE ENGINEER

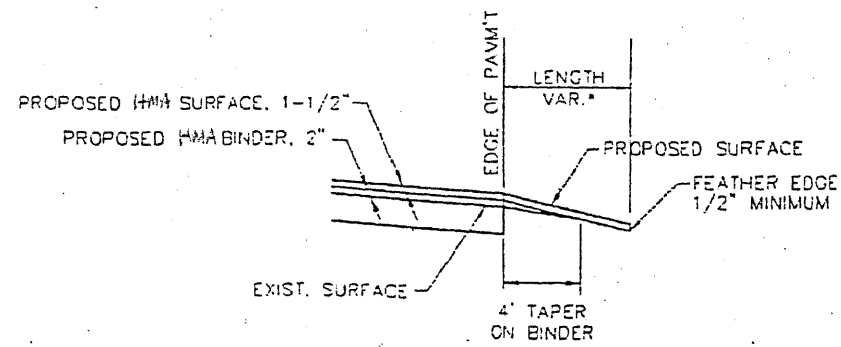

SIDEROAD DETAILS

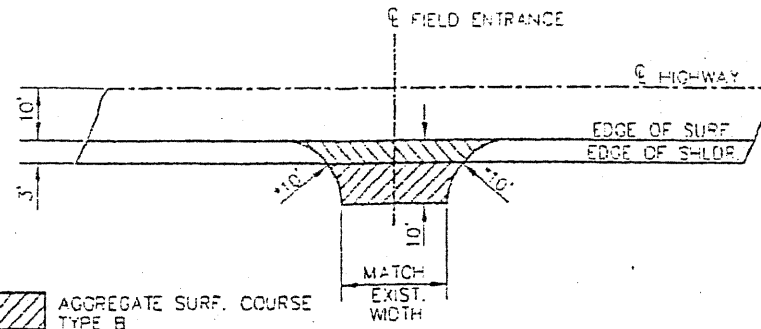

AS DIRECTED BY THE ENGINEER

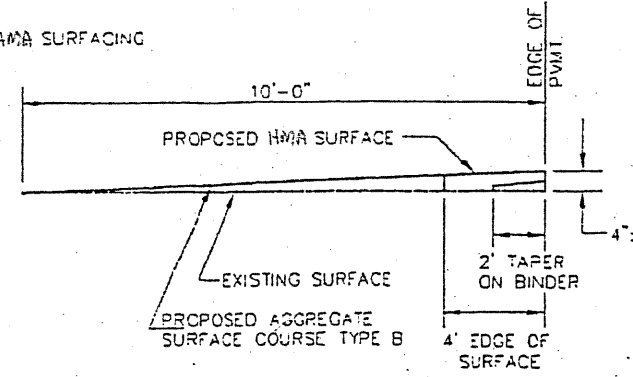

FIELD ENTRANCE DETAILS

FIELD ENTRANCE QUANTITIES		
ENTRANCES	AGGREGATE SURFACE COURSE TYPE B, TON	HOT MIX ASPHALT SURFACE COURSE, MIX "C", N70, TON
ONE (1) ENTRANCE	3	1
TOTAL = 18 ENTRANCES	54	18

PRIVATE ENTRANCE QUANTITIES		
ENTRANCES	BITUMINOUS MATERIALS (PRIME COAT) GALLON	HOT MIX ASPHALT SURFACE COURSE, MIX "C", N70, TON
ONE (1) ENTRANCE	8	4
TOTAL = 26 ENTRANCES	208	104

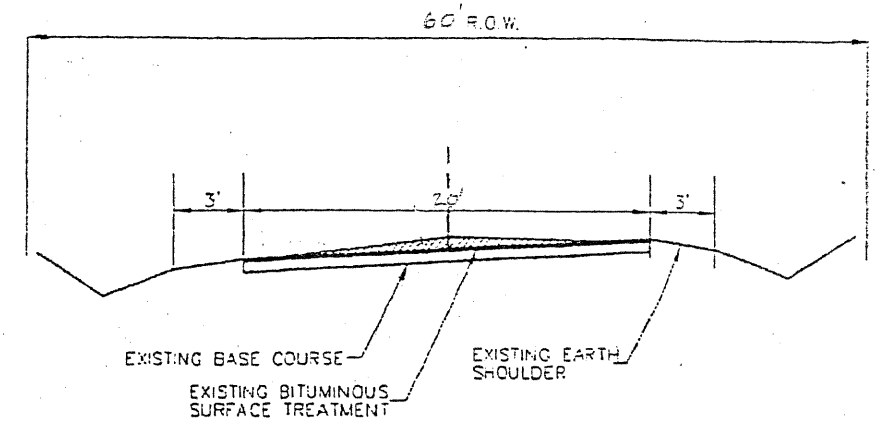

TYPICAL EXISTING SUPERELEVATED SECTION

SIDEROAD ENTRANCE QUANTITIES	
LOCATION	HOT MIX ASPHALT SURFACE COURSE, MIX "C", N70, TON
RT. STA. 74+27	5
LT. STA. 74+30	7
LT. STA. 114+84	6
RT. STA. 128+64	8
LT. STA. 141+30	25
TOTAL = 5 ENTRANCES	51

MAILBOX TURNOUT QUANTITIES		
TURNOUT	BITUMINOUS MATERIALS (PRIME COAT) GALLON	HOT MIX ASPHALT SURFACE COURSE, MIX "C", N70, TON
ONE (1) TURNOUT	3	2
TOTAL = 17 TURNOUTS	51	34

MISCELLANEOUS DETAILS

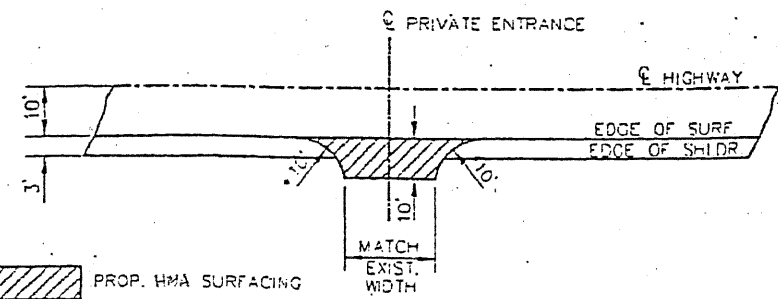

AS DIRECTED BY THE ENGINEER

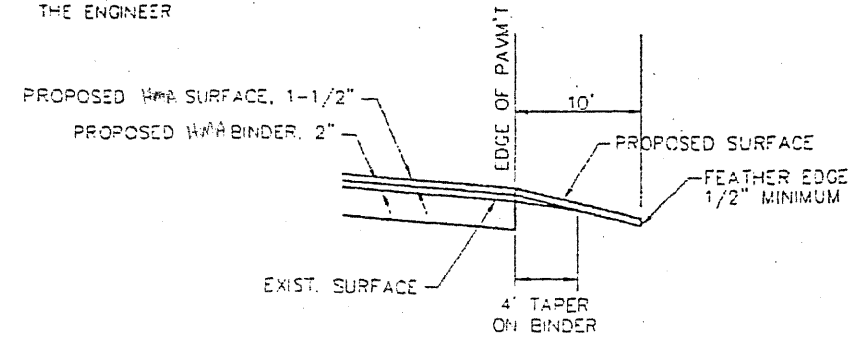

PRIVATE ENTRANCE DETAILS

ROUTE	SECTION	COUNTY	TOTAL SHEETS	SHEET NO.
FAS 873	06-0017(-00-PS	FRANKLIN	6	3
CONTRACT No.:				

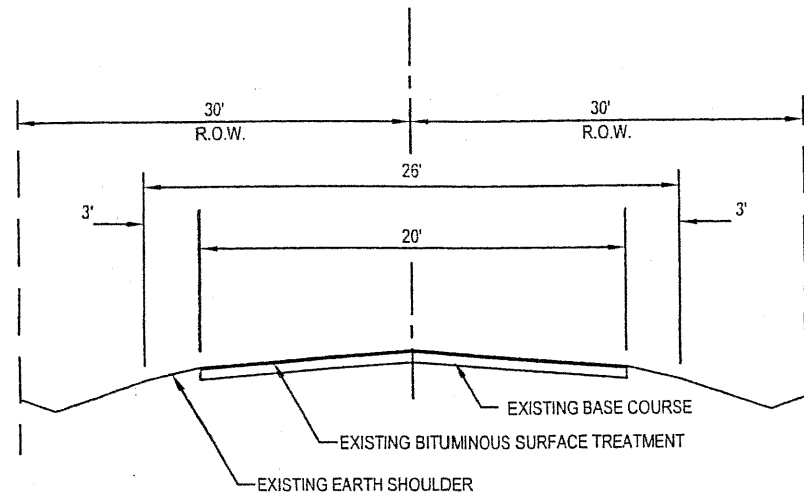

TYPICAL EXISTING SECTION

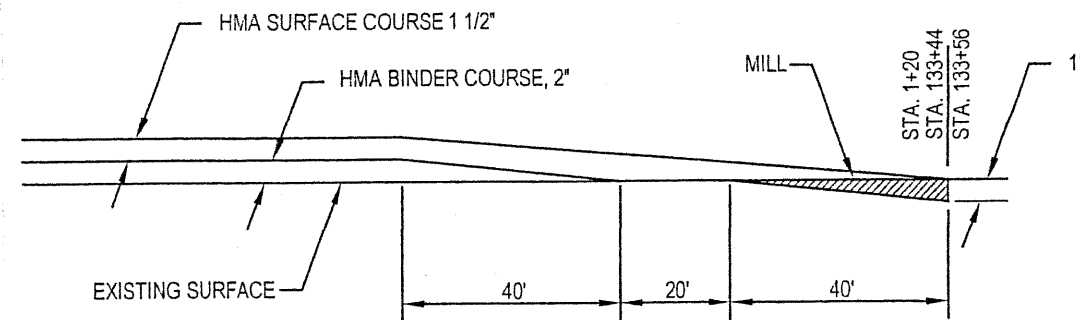

BUTT JOINT

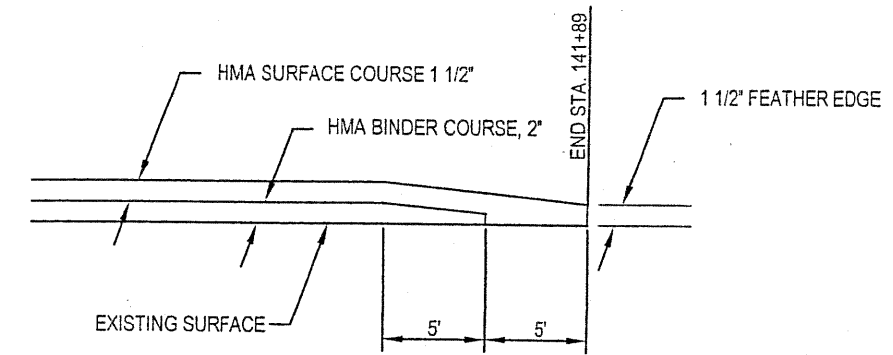

ENDING FEATHER JOINT

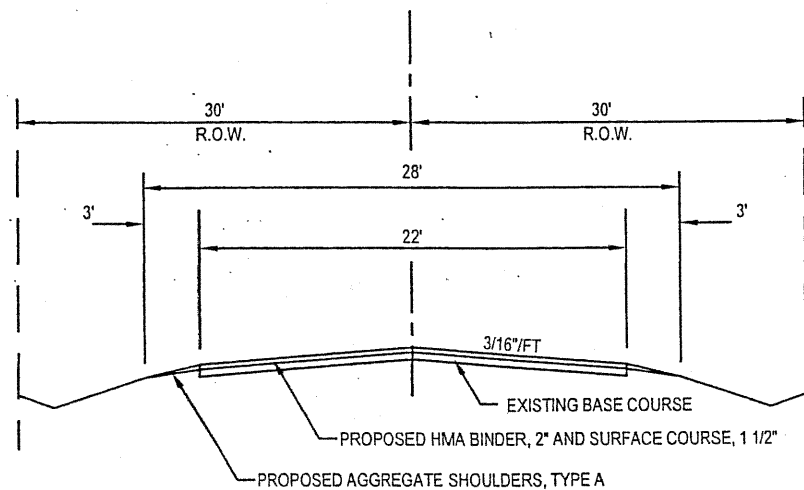

TYPICAL PROPOSED SECTION

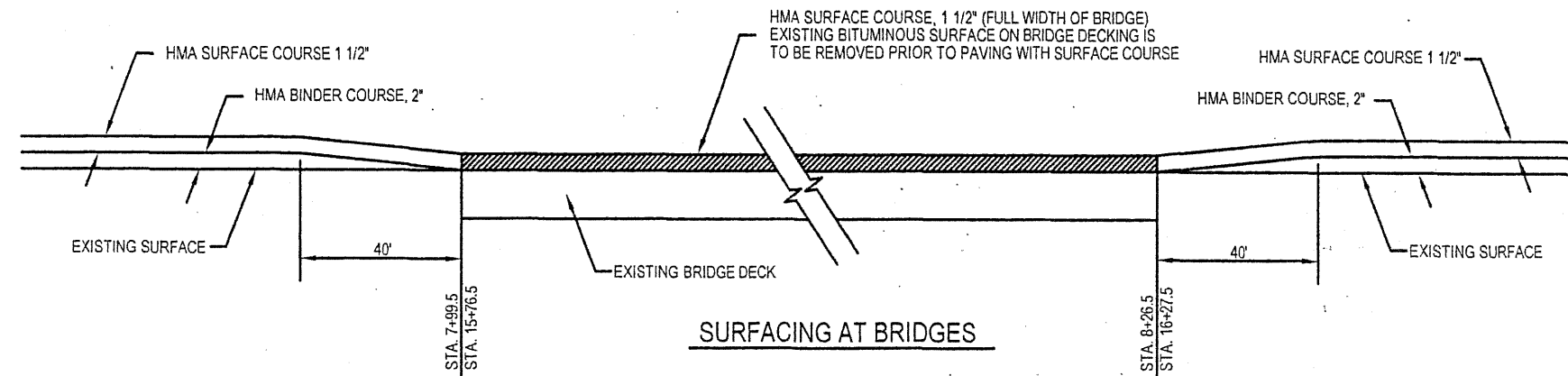

SURFACING AT BRIDGES

SCHEDULE OF PAVEMENT MARKING LINE, 4"							
EASTBOUND LANE			WESTBOUND LANE				
STATION	NO PASSING (YELLOW SOLID)	CENTERLINE (YELLOW DASHED)	STATION	NO PASSING (YELLOW SOLID)	CENTERLINE (YELLOW DASHED)	STATION	EDGE LINE (WHITE SOLID)
0+12 TO 15+52		385	15+52 TO 23+62		202.5	0+12 TO 141+89	28005
15+52 TO 25+00	948		23+60 TO 32+75	913			
25+00 TO 40+98		399.5	40+98 TO 49+49		212.75		
40+98 TO 47+83	685		49+49 TO 56+74	725			
49+49 TO 61+09		290	61+09 TO 68+78		192.25		
61+09 TO 64+03	294		68+78 TO 72+14	336			
68+78 TO 75+27		162.25	75+27 TO 83+57		207.5		
75+27 TO 82+95	768		83+57 TO 91+79	822			
83+57 TO 92+34		219.25	92+34 TO 101+39		226.25		
92+34 TO 100+77	843		101+39 TO 108+77	738			
101+39 TO 106+75		134	108+77 TO 114+69		148		
106+75 TO 133+50	2675		114+69 TO 125+29	1060			
133+50 TO 141+89		209.75	125+29 TO 130+93		141		
			130+93 TO 139+79	886			
			139+79 TO 141+89		52.5		
TOTALS	6213	1799.75		5480	1382.75	TOTALS	28005

TYPICAL SECTIONS  
& MISCELLANEOUS DETAILS

ROUTE	SECTION	COUNTY	TOTAL SHEETS	SHEET NO.
FAS 873	02-0C171-00-RS	FRANKLIN	6	4
CONTRACT No.:				

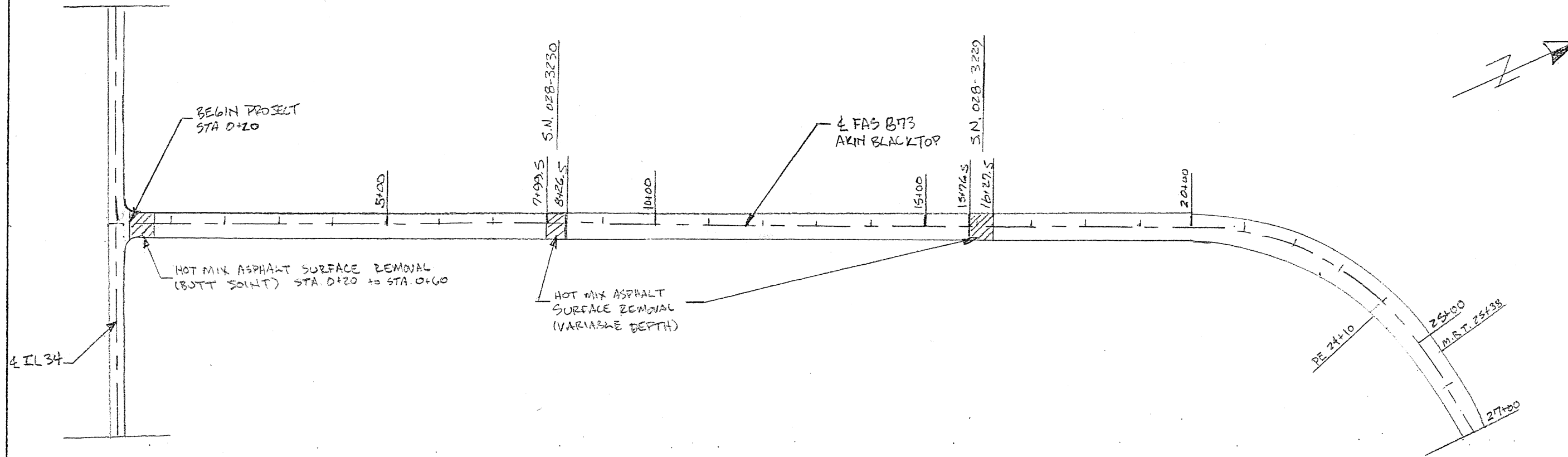

SCALE: 1" = 200'

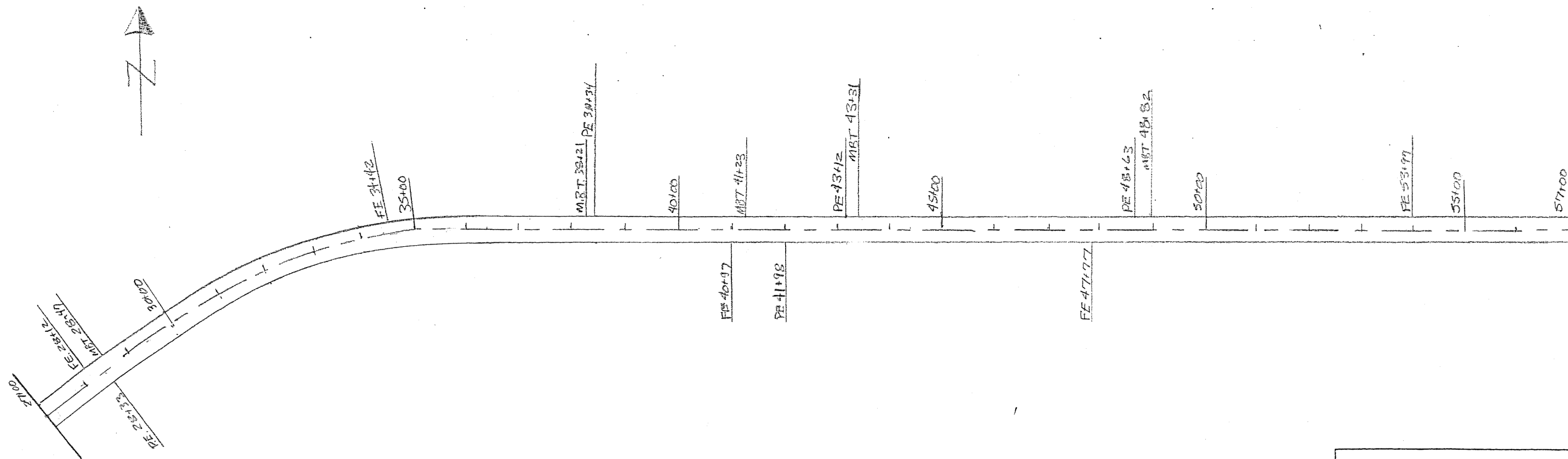

PLAN  
STATION 0+20 TO 57+00

ROUTE	SECTION	COUNTY	TOTAL SHEETS	SHEET NO.
FAS 873	08-0011-00-RS	FRANKLIN	6	5
CONTRACT No.:				

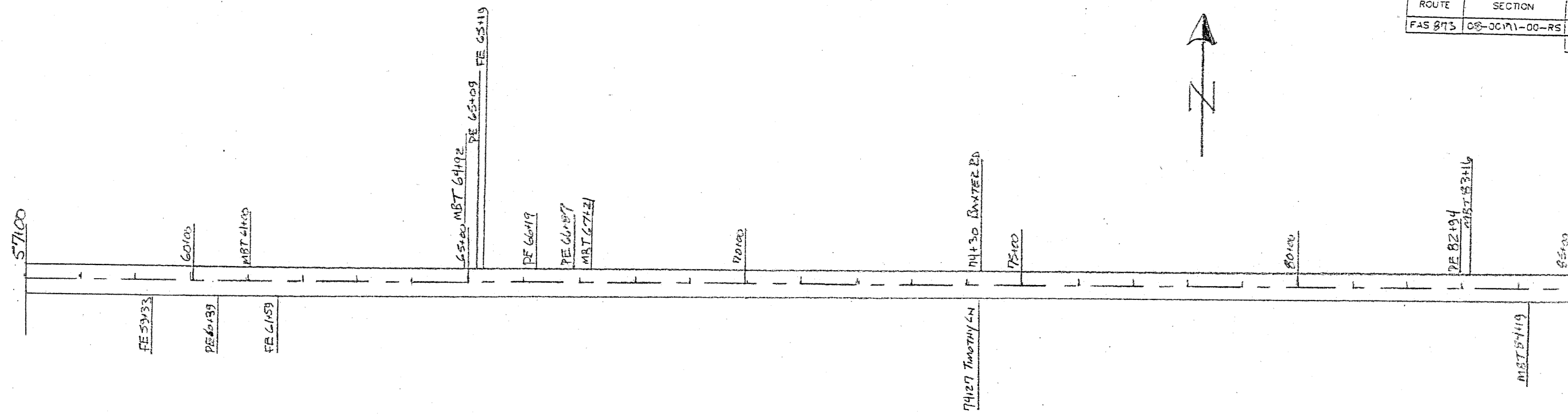

SCALE: 1" = 200'

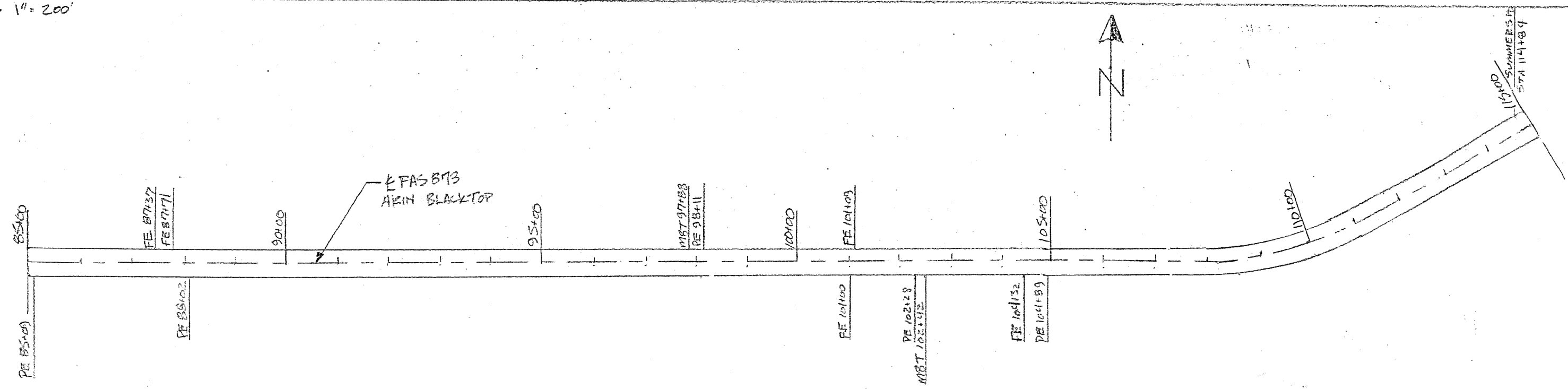

PLAN  
STATION 57+00 TO 115+00

SCALE: 1" = 200'

ROUTE	SECTION	COUNTY	TOTAL SHEETS	SHEET NO.
FAS 873	08-0011-00-RS	FRANKLIN	6	6
CONTRACT No.:				

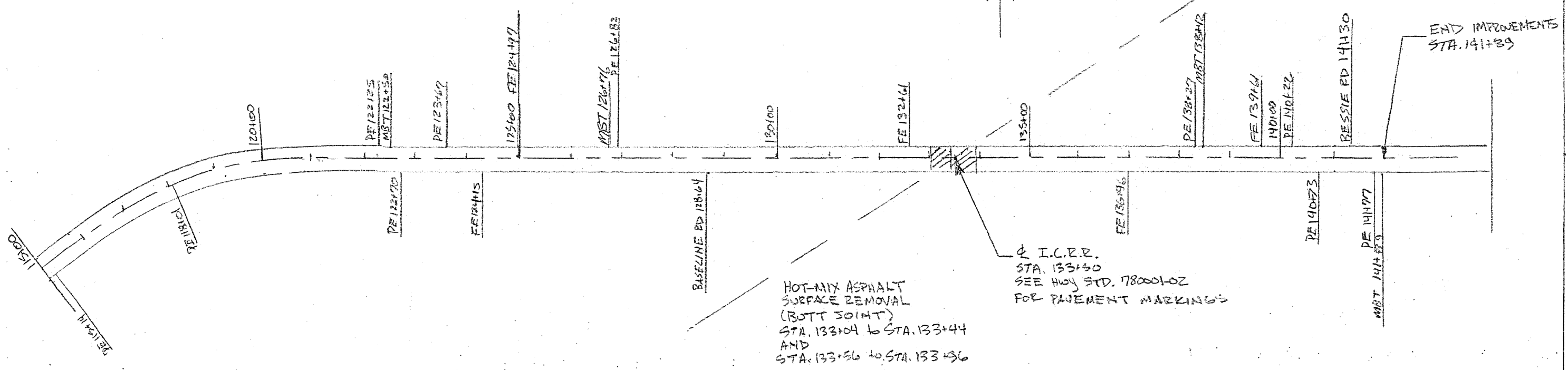
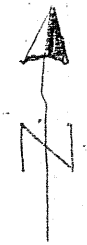

PLAN  
STATION 135+00 TO 141+89