

STATE OF ILLINOIS
DEPARTMENT OF TRANSPORTATION
DIVISION OF HIGHWAYS

**PROPOSED
HIGHWAY PLANS**

F.A.P. ROUTE 824 (U.S. RTE. 45)
SECTION (13,14,14-1Z)RS-3

PROJECT: ACF-0824(022)
RESURFACING

CUMBERLAND COUNTY

C-97-089-07

FOR INDEX OF SHEETS, SEE SHEET NO. 2

ADT = 2150 (2013)

F.A.P. RTE.	SECTION	COUNTY	TOTAL SHEETS	SHEET NO.
824	(13,14,14-1Z)RS-3	CUMBERLAND	15	1
		ILLINOIS	CONTRACT NO. 74258	

D-97-049-07

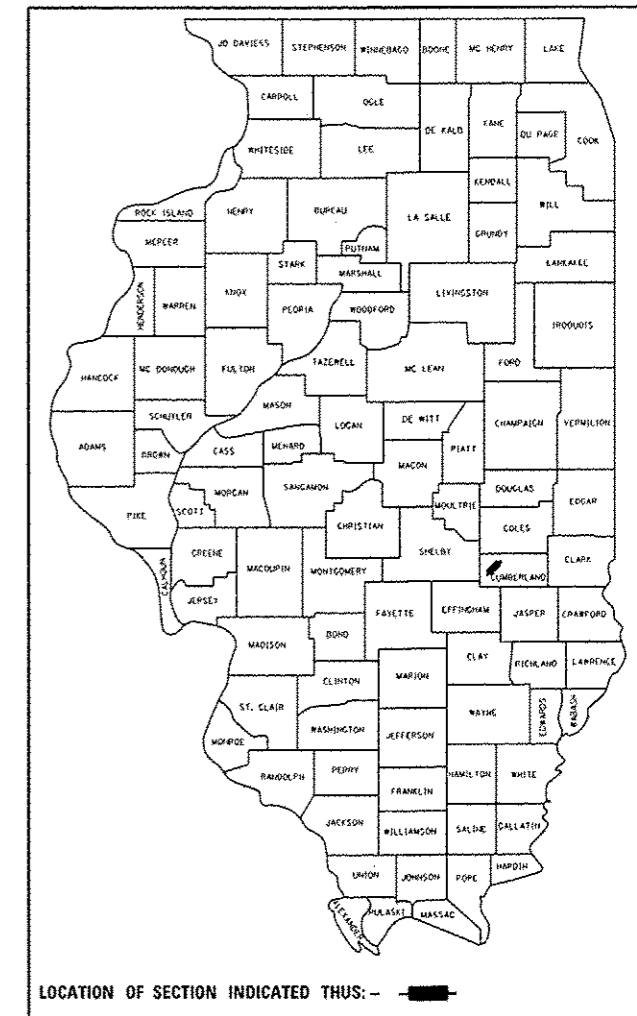

PROJECT BEGINS:
STA. 771 + 40

PROJECT ENDS:
STA. 1010 + 90

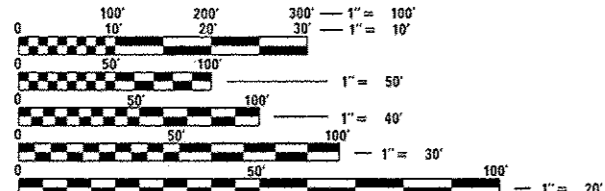

FULL SIZE PLANS HAVE BEEN PREPARED USING STANDARD ENGINEERING SCALES. REDUCED SIZED PLANS WILL NOT CONFORM TO STANDARD SCALES. IN MAKING MEASUREMENTS ON REDUCED PLANS, THE ABOVE SCALES MAY BE USED.

J.U.L.I.E.
JOINT UTILITY LOCATION INFORMATION FOR EXCAVATION
1-800-892-0123
OR 811

PROJECT ENGINEER: TOM RONAN
PROJECT MANAGER: KALEB HIRTZEL
PHONE: (217)-342-8314
CONTRACT NO. 74258

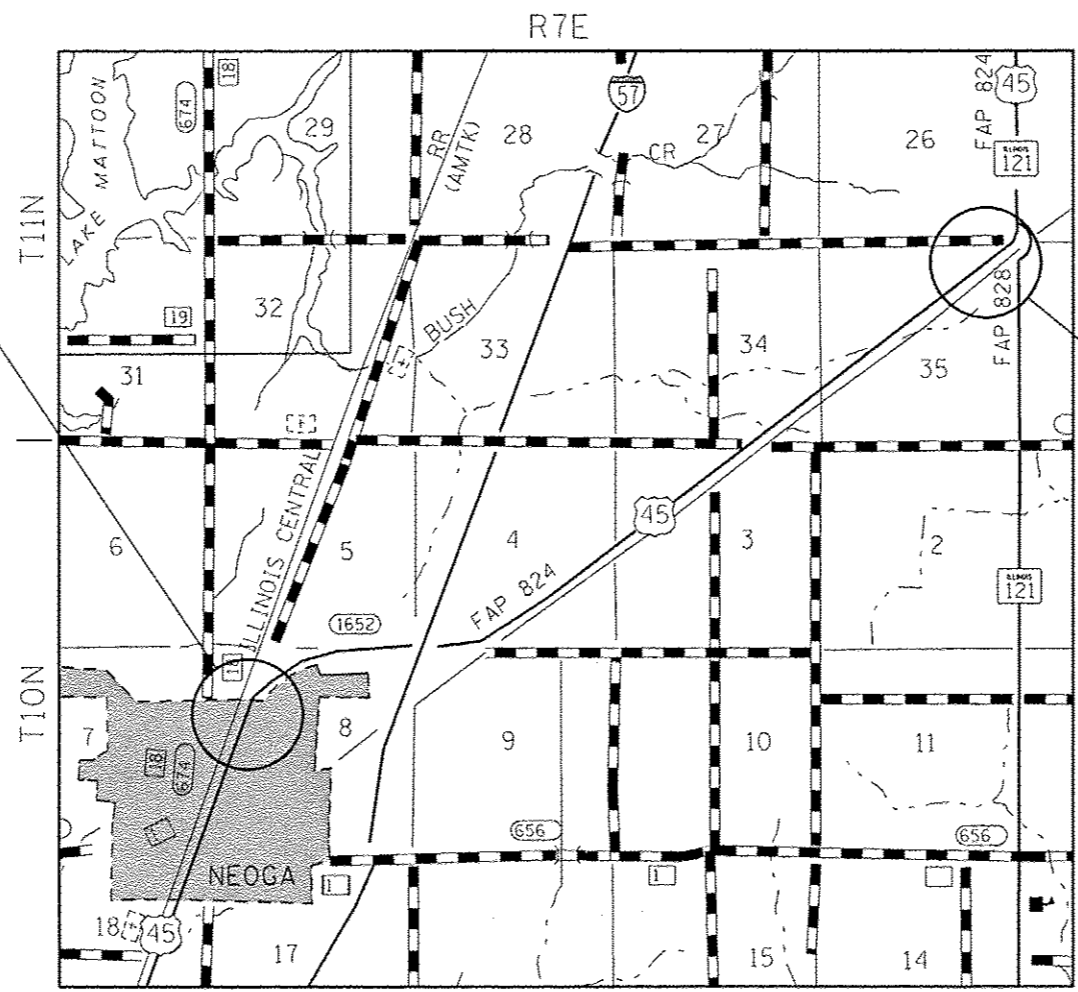

GROSS LENGTH = 23,950 FT. = 4.54 MILES
NET LENGTH = 23,950 FT. = 4.54 MILES

STATE OF ILLINOIS
DEPARTMENT OF TRANSPORTATION
DIVISION OF HIGHWAYS

SUBMITTED September 29, 2014
Roger L. Dinkel (10/3)
DEPUTY DIRECTOR OF HIGHWAYS, REGION ENGINEER

Dec 18, 2014
John D. Baranzelli PE
ENGINEER OF DESIGN AND ENVIRONMENT

Dec 18, 2014
Omer Osman PE
DIRECTOR OF HIGHWAYS/CHIEF ENGINEER

PRINTED BY THE AUTHORITY
OF THE STATE OF ILLINOIS

INDEX OF SHEETS

SHEET NO.	ITEM
1	COVER SHEET
2	INDEX OF SHEETS AND GENERAL NOTES
3-4	SUMMARY OF QUANTITIES
5-7	TYPICAL SECTIONS
8	CONSTRUCTION DETAILS
9	SCHEDULE OF QUANTITIES
10	ENTRANCE SCHEDULE
11	TIE POINTS
12-15	PAVEMENT MARKING DETAILS

THE FOLLOWING STANDARDS ARE A PART OF THESE PLANS AND ARE INCLUDED AFTER SHEET NO. 15:

STD. NO.	DESCRIPTION
000001-06	STANDARD SYMBOLS, ABBREVIATIONS AND PATTERNS
001006	DECIMAL OF AN INCH AND OF A FOOT
406201-01	MAILBOX TURNOUT
442201-03	CLASS C AND D PATCHES
482001-02	HMA SHOULDER ADJACENT TO FLEXIBLE PAVEMENT
642006	SHOULDER RUMBLE STRIPS, 8 IN
667101-02	PERMANENT SURVEY MARKERS
701001-02	OFF-ROAD OPERATIONS, 2L, 2W, MORE THAN 15' AWAY
701006-05	OFF-RD OPERATIONS, 2L, 2W, 15' TO 24" FROM PAVEMENT EDGE
701011-04	OFF-RD MOVING OPERATIONS, 2L, 2W, DAY ONLY
701201-04	LANE CLOSURE, 2L, 2W, DAY ONLY, FOR SPEEDS >= 45 MPH
701301-04	LANE CLOSURE, 2L, 2W, SHORT TIME OPERATIONS
701306-03	LANE CLOSURE, 2L, 2W, SLOW MOVING OPERATIONS DAY ONLY, FOR SPEEDS >= 45 MPH
701311-03	LANE CLOSURE 2L, 2W, MOVING OPERATIONS - DAY ONLY
701326-04	LANE CLOSURE, 2L, 2W, PAVEMENT WIDENING, FOR SPEEDS >= 45 MPH
701901-04	TRAFFIC CONTROL DEVICES
780001-05	TYPICAL PAVEMENT MARKINGS
781001-03	TYPICAL APPLICATIONS RAISED REFLECTIVE PAVEMENT MARKERS

GENERAL NOTES

THIS SECTION SHALL BE CONSTRUCTED IN ACCORDANCE WITH THE PLANS; THE "STANDARD SPECIFICATIONS FOR ROAD AND BRIDGE CONSTRUCTION" ADOPTED JANUARY 1, 2012; AND THE SPECIAL PROVISIONS INCLUDED IN THE PROPOSAL.

THIS PROJECT IS LOCATED ON FAP ROUTE 824 (US 45) IN CUMBERLAND COUNTY, FROM 11TH STREET IN NEOGA TO 0.2 MILES SOUTH OF IL 121. THE WORK INCLUDED IN SECTION (13,14,14-12)RS-3 CONSISTS OF PAVEMENT PATCHING, MILLING, HOT-MIX ASPHALT RESURFACING, HOT-MIX ASPHALT SHOULDERS, AGGREGATE WEDGE SHOULDER, PAVEMENT MARKING, AND ANY OTHER WORK NECESSARY TO COMPLETE THE SECTION.

PAVEMENT MARKING SHALL BE APPLIED IN ACCORDANCE WITH SECTION 780 OF THE STANDARD SPECIFICATIONS. SHORT TERM PAVEMENT MARKING SHALL BE APPLIED TO THE MILLED SURFACE, BITUMINOUS MATERIALS (PRIME COAT), LEVELING BINDER AND HOT-MIX ASPHALT SURFACE COURSE AS SPECIFIED IN SECTION 703 OF THE STANDARD SPECIFICATIONS. TEMPORARY TAPE SHALL BE USED ON THE SURFACE COURSE AND PAINT SHALL BE USED ON MILLED SURFACES.

THE TOTAL QUANTITY OF PAINT PAVEMENT MARKING-LINE 4" CONSISTS OF 47,900 FEET OF WHITE AND 6,354 FEET OF YELLOW.

THE TOTAL QUANTITY OF RAISED REFLECTIVE PAVEMENT MARKERS IS 300 TWO-WAY AMBER MARKERS.

GENERAL NOTES (Cont' d)

THE MATERIAL USED FOR AGGREGATE WEDGE SHOULDERS, TYPE B SHALL BE CRUSHED STONE, CRUSHED CONCRETE OR RAP. THE MATERIAL USED FOR AGGREGATE SURFACE COURSE, TYPE B AND AGGREGATE FOR TEMPORARY ACCESS SHALL BE CRUSHED STONE OR CRUSHED CONCRETE.

THE EXISTING PAVEMENT SHALL BE PATCHED IN ACCORDANCE WITH SECTION 442 OF THE STANDARD SPECIFICATIONS AND THE SPECIAL PROVISIONS. THE QUANTITY OF PATCHING SHOWN ON THE PLANS IS AN ESTIMATE ONLY AND THE FINAL LOCATIONS AND QUANTITY SHALL BE DETERMINED BY THE ENGINEER IN THE FIELD.

THE PAY ITEM TEMPORARY RAMP HAS BEEN INCLUDED FOR THE CONSTRUCTION OF TEMPORARY RAMPS IN ACCORDANCE WITH ARTICLE 406.08 OF THE STANDARD SPECIFICATIONS. THE COST SHALL INCLUDE BOTH THE INSTALLATION AND THE REMOVAL OF THE TEMPORARY RAMPS.

THE RESIDENT ENGINEER SHALL BE THE SOLE JUDGE CONCERNING THE CURING TIME FOR THE VARIOUS HOT-MIX ASPHALT LIFTS.

THE CONTRACTOR SHALL PROVIDE INTERNET ACCESSIBILITY TO THE HOT-MIX ASPHALT PLANT QUALITY CONTROL LAB SO THAT HOT-MIX ASPHALT PLANT REPORTS CAN BE E-MAILED TO THE DISTRICT HEADQUARTERS. THIS WORK SHALL BE INCLUDED IN THE COST OF ALL HOT-MIX ASPHALT ITEMS.

A UNIFORMLY STRAIGHT SAW CUT SHALL BE MADE AT LOCATIONS WHERE PROPOSED NEW CONSTRUCTION WILL ABUT EXISTING HOT-MIX ASPHALT SURFACES. THE SAW CUT SHALL BE MADE FULL DEPTH THROUGH THE EXISTING SURFACE. THIS WORK WILL BE CONSIDERED INCLUDED IN THE COST OF THE CONTRACT ITEMS INVOLVED AND NO EXTRA COMPENSATION WILL BE ALLOWED.

THE HMA SURFACE REMOVAL AND RESURFACING SHALL BE DONE IN A MANNER THAT DOES NOT RESULT IN A GREATER ELEVATION DIFFERENTIAL BETWEEN OPEN LANES THAN ALLOWED BY ARTICLE 701.07 OF THE STANDARD SPECIFICATIONS.

THE FOLLOWING MIXTURE REQUIREMENTS ARE APPLICABLE FOR THIS PROJECT:

MIXTURE USE:	SURFACE COURSE	LEVEL BINDER
PG GRADE:	PG 64-22	PG 64-22
DESIGN AIR VOIDS:	4.0% @ NDESIGN = 70	4.0% @ NDESIGN = 70
MIXTURE COMPOSITION:	1L-9.5	1L-9.5
FRICITION AGGREGATE:	MIXTURE C	N/A

MIXTURE USE:	INCIDENTAL	CLASS D PATCHING
PG GRADE:	PG 64-22	PG 64-22
DESIGN AIR VOIDS:	4.0% @ NDESIGN = 70	4.0% @ NDESIGN = 70
MIXTURE COMPOSITION:	1L-9.5	1L-19.0
FRICITION AGGREGATE:	MIXTURE C	N/A

MIXTURE USE:	HMA SHOULDERS (2 1/4")	PARTIAL DEPTH PATCHING
PG GRADE:	PG 64-22	PG 64-22
DESIGN AIR VOIDS:	4.0% @ NDESIGN = 30	4.0% @ NDESIGN = 70
MIXTURE COMPOSITION:	1L-9.5L	1L-19.0
FRICITION AGGREGATE:	MIXTURE C	N/A

MIXTURE USE:	HMA SHOULDERS, 6 1/2"
PG GRADE:	PG 64-22
DESIGN AIR VOIDS:	4.0% @ NDESIGN = 30
MIXTURE COMPOSITION:	1L-19.0L
FRICITION AGGREGATE:	N/A

THE FOLLOWING RATES OF APPLICATION HAVE BEEN USED IN THE CALCULATING PLAN QUANTITIES:

AGGREGATE SURFACE COURSE	2.05 TONS/CU YD
AGGREGATE WEDGE SHOULDERS	2.05 TONS/CU YD
BITUMINOUS MATERIALS (PRIME COAT)	0.05 LBS/SO FT (MILLED SURFACE)
	0.025 LBS/SO FT (BETWEEN HMA LIFTS)
HOT-MIX ASPHALT	112 LBS/SO YD/INCH

FILE NAME =	USER NAME =	DESIGNED -	REVISED -	STATE OF ILLINOIS DEPARTMENT OF TRANSPORTATION		INDEX OF SHEETS, STANDARDS AND GENERAL NOTES		F.A.P. RTE.	SECTION	COUNTY	TOTAL SHEETS	SHEET NO.		
c:\pwwork\pwwork\staff\enck\0242588\0	74258-ast-index.dgn	DRAWN -	REVISED -			SCALE: N/A	SHEET 1	OF 1	SHEETS	STA.	TO STA.	824	13,14,14-12)RS-3	CUMBERLAND
Default	PLOT SCALE = (0.0,0.00) 1/16 in.	CHECKED -	REVISED -									CONTRACT NO. 74258		
	PLOT DATE = 9/29/2014	DATE -	REVISED -									ILLINOIS FED. AID PROJECT		

SUMMARY OF QUANTITIES			80% FED. 20% STATE TOTAL QUANTITIES	CONSTRUCTION TYPE CODE		
CODE NO	ITEM	UNIT	0005			
20200600	EXCAVATING AND GRADING EXISTING SHOULDER	UNIT	438	438		
40200800	AGGREGATE SURFACE COURSE, TYPE B	TON	14	14		
40201000	AGGREGATE FOR TEMPORARY ACCESS	TON	81	81		
40600275	BITUMINOUS MATERIALS (PRIME COAT)	POUND	49357	49357		
40600635	LEVELING BINDER (MACHINE METHOD), N70	TON	2682	2682		
40600990	TEMPORARY RAMP	SO YD	47	47		
40603315	HOT-MIX ASPHALT SURFACE COURSE, MIX "C", N70	TON	7054	7054		
40800050	INCIDENTAL HOT-MIX ASPHALT SURFACING	TON	49	49		
44000155	HOT-MIX ASPHALT SURFACE REMOVAL, 1 1/2"	SO YD	48158	48158		
44000158	HOT-MIX ASPHALT SURFACE REMOVAL, 2 1/4"	SO YD	18389	18389		
44201803	CLASS D PATCHES, TYPE II, 13 INCH	SO YD	507	507		
44201807	CLASS D PATCHES, TYPE III, 13 INCH	SO YD	69	69		
44201809	CLASS D PATCHES, TYPE IV, 13 INCH	SO YD	107	107		
48102100	AGGREGATE WEDGE SHOULDER, TYPE B	TON	1076	1076		

SUMMARY OF QUANTITIES			80% FED. 20% STATE TOTAL QUANTITIES	CONSTRUCTION TYPE CODE		
CODE NO	ITEM	UNIT	0005			
48203023	HOT-MIX ASPHALT SHOULDERS, 6 1/2"	SO YD	19448	19448		
48203100	HOT-MIX ASPHALT SHOULDERS	TON	344	344		
64200108	SHOULDER RUMBLE STRIPS, 8 INCH	FOOT	34053	34053		
66700205	PERMANENT SURVEY MARKERS, TYPE I	EACH	4	4		
67000500	ENGINEER'S FIELD OFFICE, TYPE B	CAL MO	4	4		
67100100	MOBILIZATION	L SUM	1	1		
70100450	TRAFFIC CONTROL AND PROTECTION, STANDARD 701201	L SUM	1	1		
70100460	TRAFFIC CONTROL AND PROTECTION, STANDARD 701306	L SUM	1	1		
70100500	TRAFFIC CONTROL AND PROTECTION, STANDARD 701326	L SUM	1	1		
70103815	TRAFFIC CONTROL SURVEILLANCE	CAL DA	14	14		
70300100	SHORT-TERM PAVEMENT MARKING	FOOT	10143	10143		
70300220	TEMPORARY PAVEMENT MARKING LINE 4"	FOOT	54254	54254		

① TYPICAL CROSS SECTION

- STA. 771+40 TO STA. 772+72 ②
- ② STA. 808+35 TO STA. 822+35 ③
- ③ STA. 831+43 TO STA. 832+79 ④

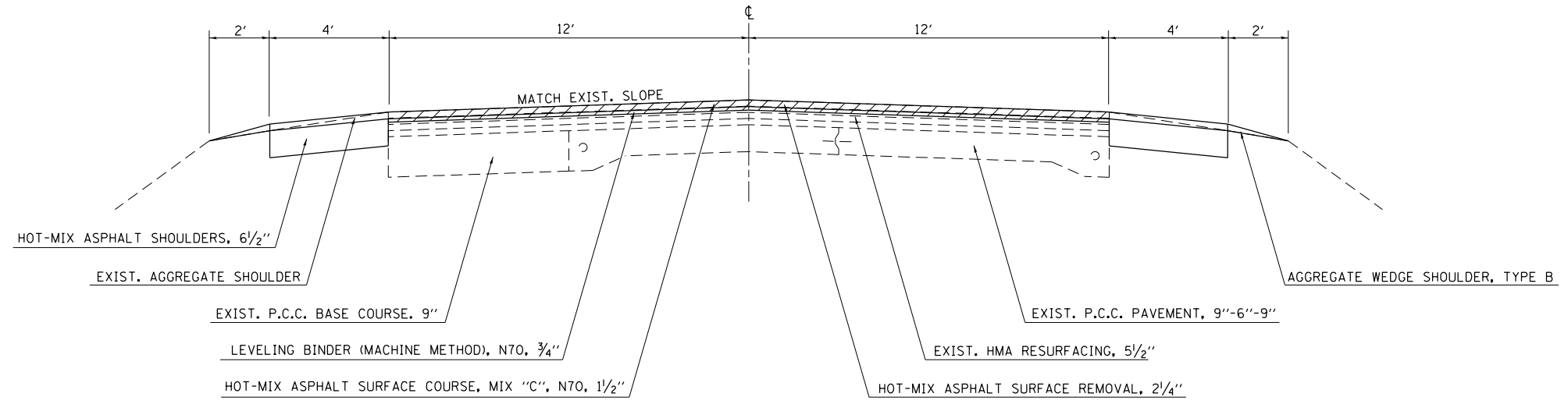

HOT-MIX ASPHALT SURFACE REMOVAL, 2 1/4"

NOTE: NOT DRAWN TO SCALE

② TYPICAL CROSS SECTION

- ① STA. 772+72 TO STA. 808+35 ①

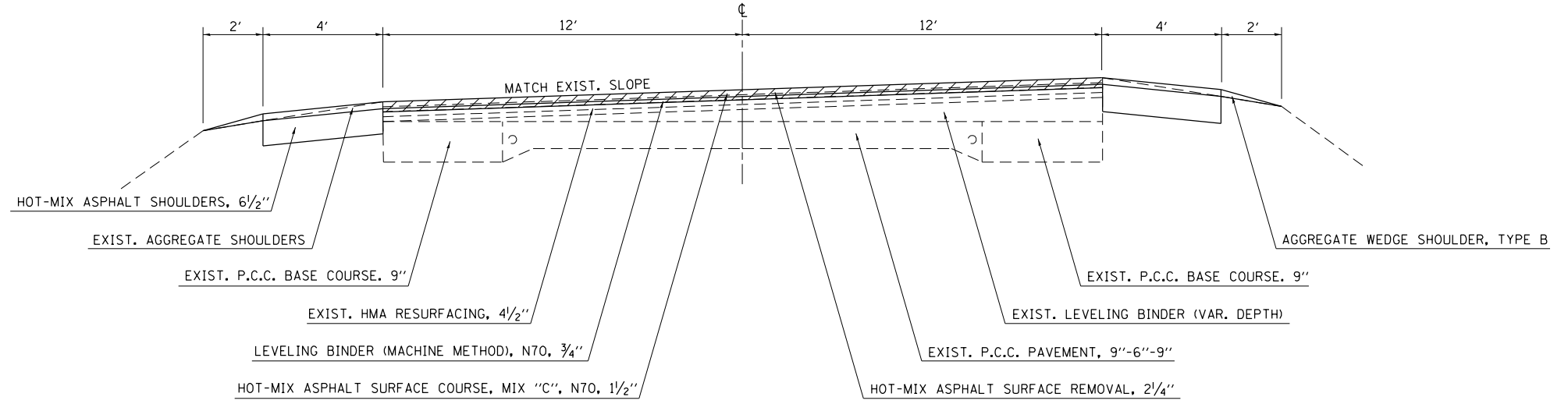

HOT-MIX ASPHALT SURFACE REMOVAL, 2 1/4"

NOTE: NOT DRAWN TO SCALE

FILE NAME =	USER NAME = steffenmk	DESIGNED -	REVISED -	STATE OF ILLINOIS DEPARTMENT OF TRANSPORTATION	TYPICAL CROSS SECTIONS			F.A.P. RTE.	SECTION	COUNTY	TOTAL SHEETS	SHEET NO.			
		DRAWN -	REVISED -		SCALE: N/A	SHEET 1	OF 3	SHEETS	STA.	TO STA.	824	(13,14,14-1Z)RS-2	CUMBERLAND	15	5
		CHECKED -	REVISED -								CONTRACT NO. 74258				
Default		DATE -	REVISED -								ILLINOIS FED. AID PROJECT				

③ TYPICAL CROSS SECTION

① STA. 822+35 TO STA. 831+43 ①

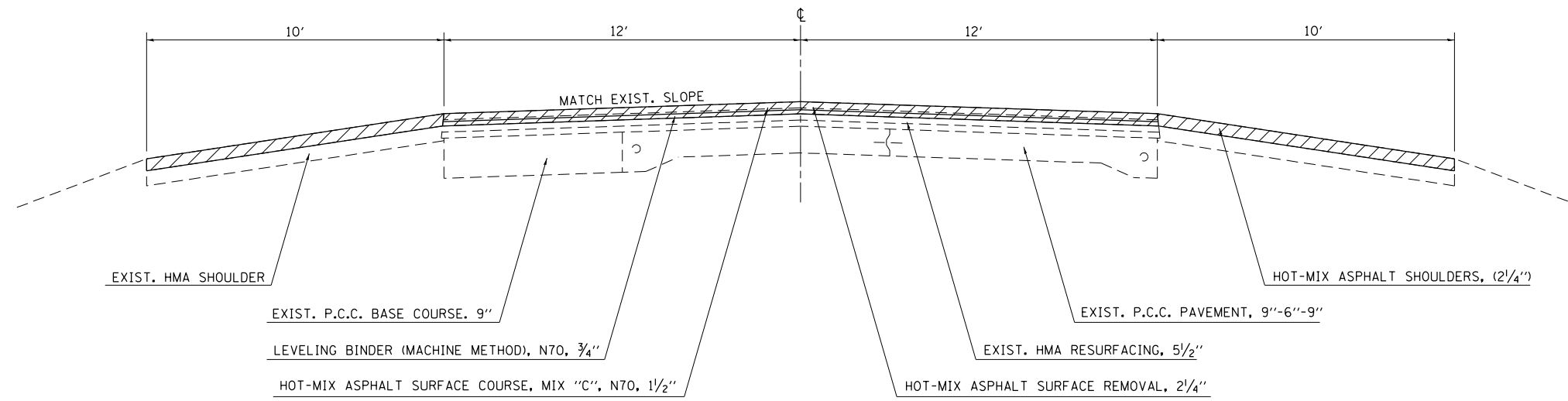

HOT-MIX ASPHALT SURFACE REMOVAL, 2 1/4"

NOTE: NOT DRAWN TO SCALE

④ TYPICAL CROSS SECTION

① STA. 832+79 TO STA. 838+20 ⑤
 ⑤ STA. 847+04 TO STA. 984+81 ⑥
 ⑥ STA. 993+32 TO STA. 1010+90

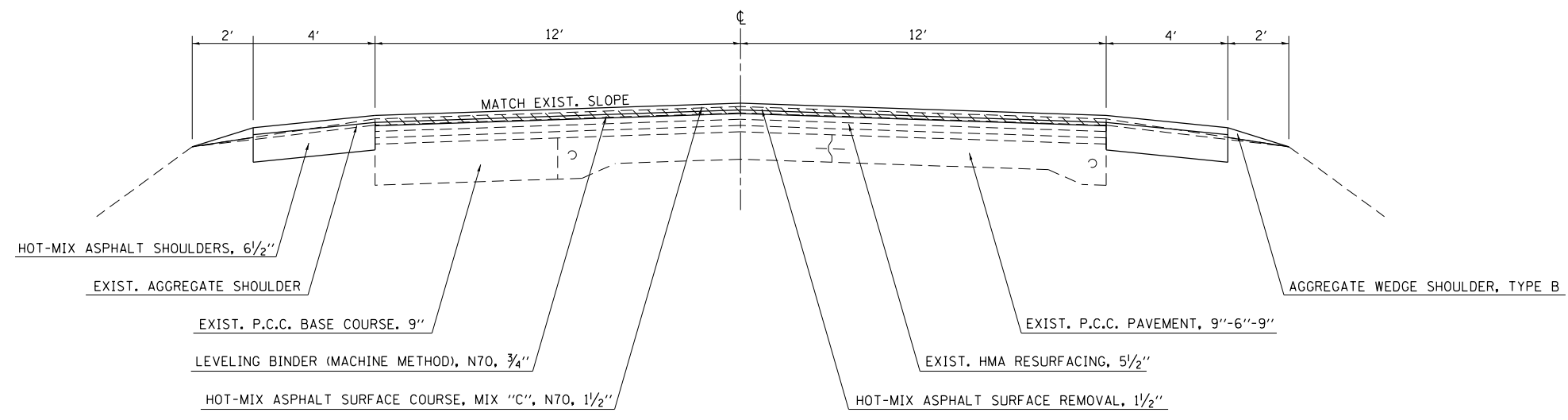

HOT-MIX ASPHALT SURFACE REMOVAL, 1 1/2"

NOTE: NOT DRAWN TO SCALE

FILE NAME =	USER NAME = steffenmk	DESIGNED -	REVISED -	STATE OF ILLINOIS DEPARTMENT OF TRANSPORTATION	TYPICAL CROSS SECTIONS			F.A.P. RTE.	SECTION	COUNTY	TOTAL SHEETS	SHEET NO.
ci:\pw\work\p\dot\steffenmk\d0242568\0774258-sht-typicals.dgn		DRAWN -	REVISED -		824	(13,14,14-1Z)RS-2	CUMBERLAND	15	6			
Default	PLOT SCALE = 100.0000' / in.	CHECKED -	REVISED -		SCALE: N/A SHEET 2 OF 3 SHEETS STA. TO STA.			CONTRACT NO. 74258				
	PLOT DATE = 9/29/2014	DATE -	REVISED -		ILLINOIS FED. AID PROJECT							

5 TYPICAL CROSS SECTION
 ④ STA. 838+20 TO STA. 847+04 ④

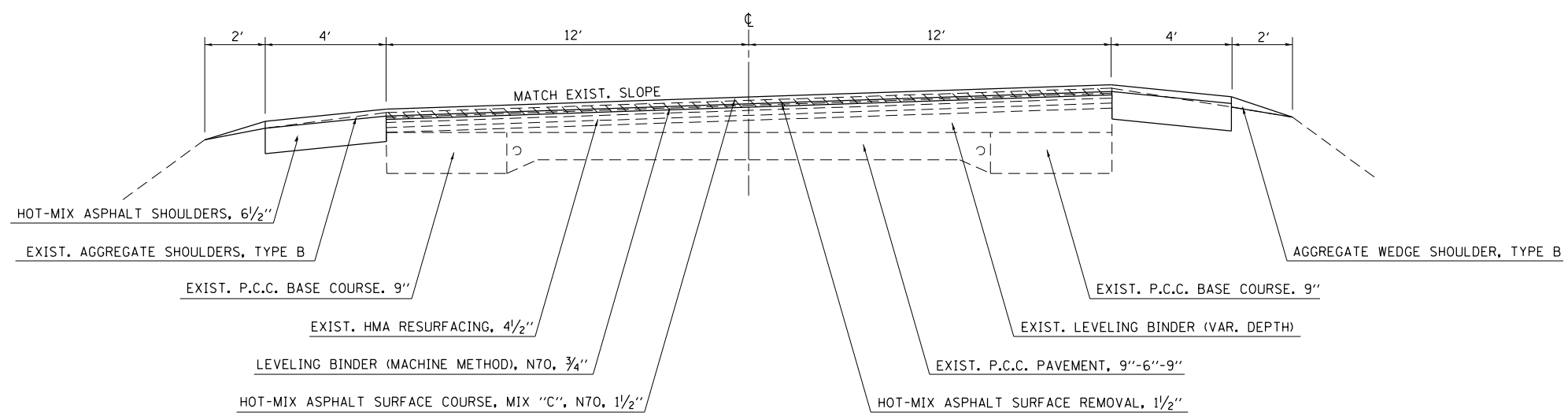

HOT-MIX ASPHALT SURFACE REMOVAL, 1 1/2"

NOTE: NOT DRAWN TO SCALE

6 TYPICAL CROSS SECTION
 ④ STA. 984+81 TO STA. 993+32 ④

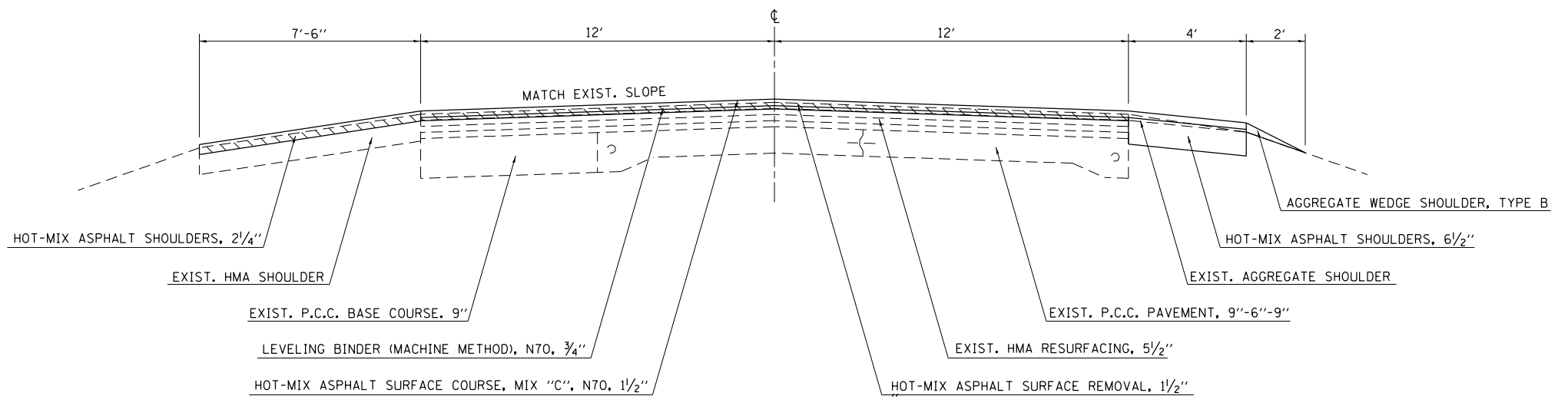

HOT-MIX ASPHALT SURFACE REMOVAL, 1 1/2"

NOTE: NOT DRAWN TO SCALE

FILE NAME =	USER NAME = steffenmk	DESIGNED -	REVISED -	STATE OF ILLINOIS DEPARTMENT OF TRANSPORTATION	TYPICAL CROSS SECTIONS			F.A.P. RTE.	SECTION	COUNTY	TOTAL SHEETS	SHEET NO.	
		DRAWN -	REVISED -		SCALE: N/A	SHEET 3 OF 3 SHEETS	STA.	TO STA.	824	(13,14,14-12)RS-2	CUMBERLAND	15	7
		CHECKED -	REVISED -					CONTRACT NO. 74258					
Default		DATE -	REVISED -		ILLINOIS FED. AID PROJECT								

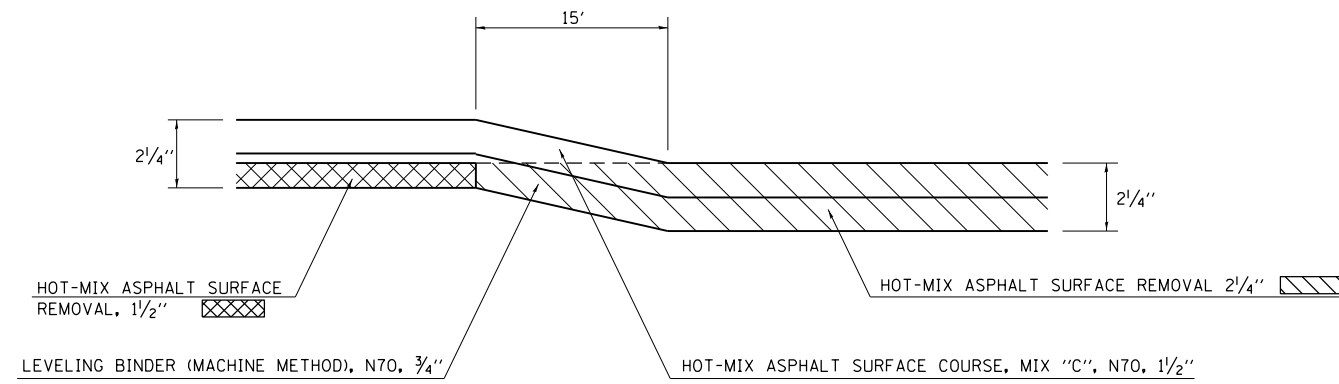

MILLING TRANSITION DETAIL

STA. 832+64 TO STA. 832+79

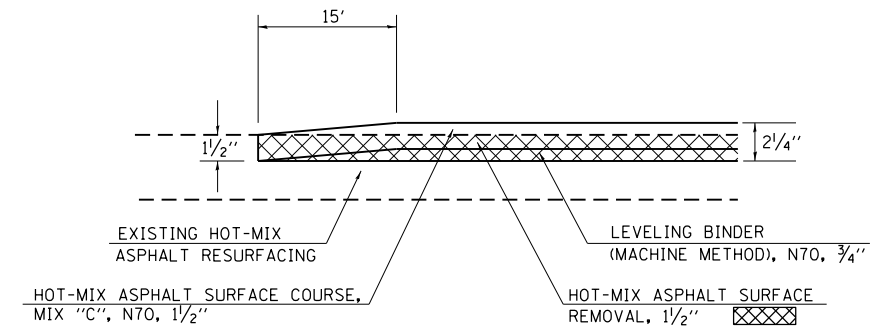

PAVING TRANSITION DETAIL

STA. 1010+75 TO STA. 1010+90

FILE NAME =	USER NAME = steffenmk	DESIGNED -	REVISED -
ci:\pw\work\p\idot\steffenmk\d0242568\0774258-sht-details.dgn		DRAWN -	REVISED -
Default	PLOT SCALE = 100.0000' / in.	CHECKED -	REVISED -
	PLOT DATE = 9/29/2014	DATE -	REVISED -

**STATE OF ILLINOIS
DEPARTMENT OF TRANSPORTATION**

CONSTRUCTION DETAILS

SCALE: N/A SHEET 1 OF 1 SHEETS STA. TO STA.

F.A.P. RTE.	SECTION	COUNTY	TOTAL SHEETS	SHEET NO.
824	(13,14,14-1Z)RS-3	CUMBERLAND	15	8
				CONTRACT NO. 74258
ILLINOIS FED. AID PROJECT				

ENTRANCE LENGTH SCHEDULE			INCIDENTAL HOT-MIX ASPHALT SURFACING	AGGREGATE SURFACE COURSE, TYPE B
SIDE	STATION	TYPE	LENGTH (FEET)	LENGTH (FEET)
RT	835+65	CE	10	
LT	836+47	CE	10	
LT	837+61	FE		10
RT	837+75	CE	10	
RT	841+35	PRA	22	
LT	841+76	FE		10
LT	853+16	FE		10
LT	868+01	FE		10
RT	868+01	FE		10
LT	870+00	FE		10
LT	885+43	FE		10
LT	893+47	FE		10
RT	893+47	FE		10
LT	903+61	PE	6	
LT	903+81	MBT		5
LT	90806	FE		10
RT	918+19	PRA	6	
LT	918+44	PRA	6	
LT	924+25	PE	6	
LT	924+48	MBT	5	
LT	930+39	PRA	16	
RT	930+83	PRA	16	
LT	937+65	PE	6	
LT	937+82	MBT	5	
LT	951+38	FE		10
LT	970+44	CE	6	
LT	970+70	MBT	5	
LT	973+26	CE		10
LT	985+19	PE	30	
LT	986+56	PE		10
LT	986+96	PE	30	
LT	988+77	PE		10
LT	989+41	PE		10
LT	991+21	PE	10	
LT	993+07	PE	10	
LT	996+20	FE		10

RESURFACING SCHEDULE																	
STATION TO	STATION	FOOT	WIDTH	AREA	TEMPORARY RAMPS	HOT-MIX ASPHALT SURFACE REMOVAL 1 1/2"	HOT-MIX ASPHALT SURFACE REMOVAL, 2 1/4"	BITUMINOUS MATERIALS (PRIME COAT)	HOT-MIX ASPHALT SURFACE COURSE, MIX "C", N70	LEVELING BINDER (MACHINE METHOD), N70	HOT-MIX ASPHALT SHOULDERS	HOT-MIX ASPHALT SHOULDERS, 6 1/2"	EXCAVATING AND GRADING EXISTING SHOULDER	SHOULDER RUMBLE STRIP, 8 INCH	AGGREGATE WEDGE SHOULDER, TYPE B		
STATION TO	STATION	FOOT	FOOT	SQ YD	SQ YD	SQ YD	SQ YD	POUND	TON	TON	TON	TON	UNIT	FOOT	TON		
771+40	TO 822+35	5095	24	13586.7	33.3	-	13586.7	10190.0	1521.7	570.6	-	4170.2	93.8	7136.0	214.6		
822+35	TO 831+43	908	44	4439.1	-	-	4439.1	2996.4	203.4	101.7	254.2	-	-	-	43.1		
831+43	TO 832+64	121	24	322.7	-	-	322.7	242.0	36.1	13.6	-	-	-	-	-		
832+64	TO 832+79	15	24	40.0	-	-	40.0	30.0	4.5	1.7	-	13.3	0.3	24.0	0.7		
832+79	TO 984+81	15202	24	40538.7	-	40538.7	-	30404.0	4540.3	1702.6	-	13323.6	299.8	23399.2	695.4		
984+81	TO 993+32	851	31	2931.2	-	2931.2	-	1978.6	222.4	95.3	89.4	378.2	8.5	680.8	38.4		
993+32	TO 1010+75	1743	24	4648.0	-	4648.0	-	3486.0	520.6	195.2	-	1549.3	34.9	2788.8	82.7		
1010+75	TO 1010+90	15	24	40.0	13.3	40.0	-	30.0	4.5	1.7	-	13.3	0.3	24.0	0.7		
TOTALS:		23950	-	66546	47	48158	18389	49357	7054	2682	344	19448	438	34053	1076		

PAVEMENT MARKING SCHEDULE							
STATION TO	STATION	LENGTH (FEET)	SHORT TERM PAVEMENT MARKING (FOOT)	WORK ZONE PAVEMENT MARKING REMOVAL (SQ FT)	TEMPORARY PAVEMENT MARKING - LINE 4" (FOOT)	PAINT PAVEMENT MARKING - LINE 4" (FOOT)	RAISED REFLECTIVE PAVEMENT MARKER (EACH)
771+40	TO 1007+24	23584	9996.5	833.0	53064	53064	295
1007+24	TO 1010+90	366	146.4	12.2	1189.5	1189.5	5
TOTALS		23950	10143	845	54254	54254	300

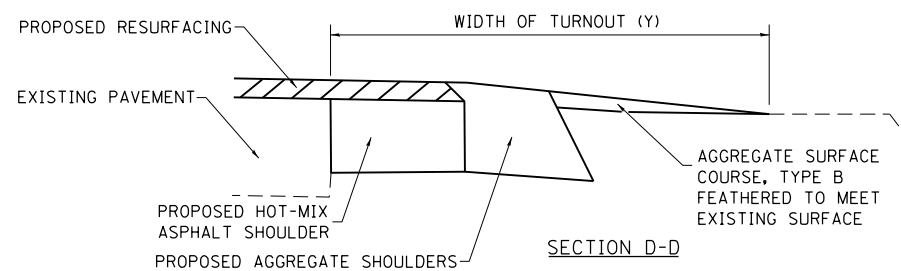
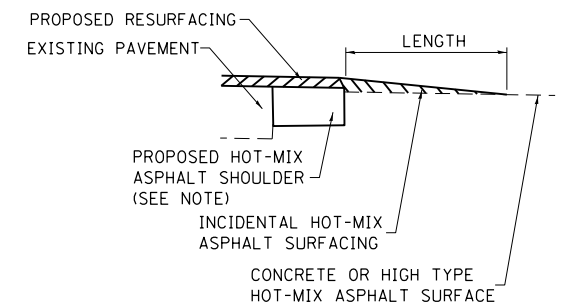
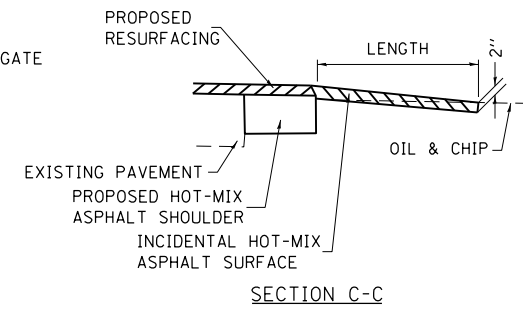
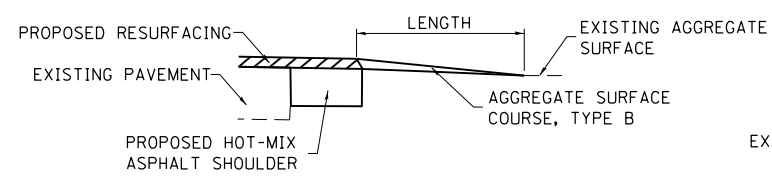
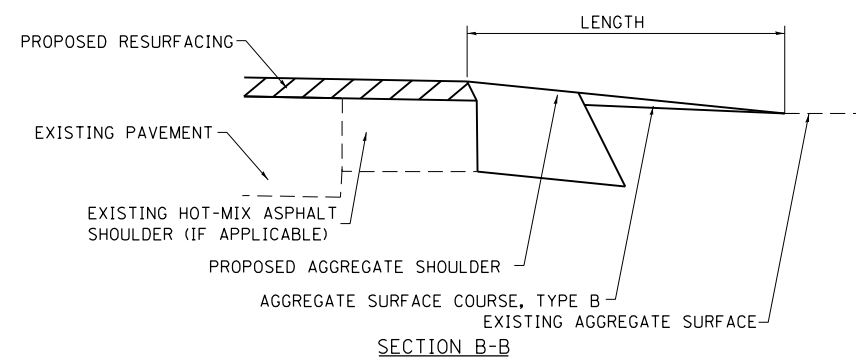
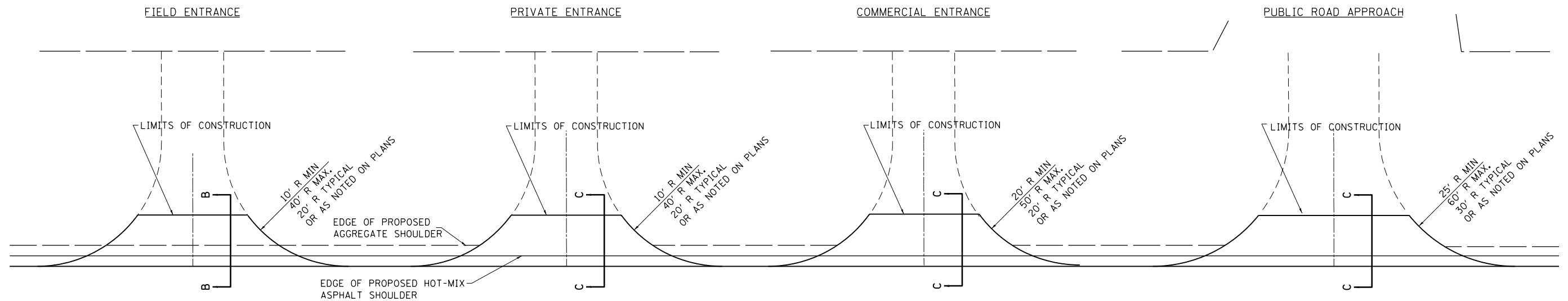

TYPICAL SECTION AT MAILBOX TURNOUT
NOTE: SEE STANDARD 406201 FOR MAILBOX TURNOUT DETAILS

NOTES

LENGTH = 10' UNLESS OTHERWISE NOTED ON PLANS

THE THICKNESS OF THE HOT-MIX ASPHALT SHOULDERS THROUGH COMMERCIAL ENTRANCES (HOT-MIX ASPHALT) AND PUBLIC ROADS SHALL BE 10". THE COST OF THE EXTRA THICKNESS SHALL BE INCLUDED WITH THE HOT-MIX ASPHALT SHOULDERS PAY ITEM.

HOT-MIX ASPHALT SHOULDERS SHALL NOT BE CONSTRUCTED THROUGH A PCC ENTRANCE OR PCC PUBLIC ROAD APPROACH.

THE COST OF EXCAVATION IS INCLUDED IN THE PAY ITEM INCIDENTAL HOT-MIX ASPHALT SURFACING.

THE COST OF THE BITUMINOUS MATERIALS AND AGGREGATE (PRIME COAT) FOR ENTRANCES AND PUBLIC ROAD APPROACHES SHALL BE INCLUDED IN THE PAY ITEM INCIDENTAL HOT-MIX ASPHALT SURFACING.

SIDE	STATION	TYPE	INCIDENTAL HOT-MIX ASPHALT SURFACING	
			TON	TON
RT	835+65	CE	5.1	
LT	836+47	CE	6.9	
LT	837+61	FE		0.8
RT	837+75	CE	3.0	
RT	841+35	PRA	14.0	
LT	841+76	FE		0.9
LT	853+16	FE		0.8
LT	868+01	FE		0.8
RT	868+01	FE		0.8
LT	870+00	FE		0.8
LT	885+43	FE		0.8
LT	893+47	FE		0.8
RT	893+47	FE		0.8
LT	903+61	PE	0.7	
LT	903+81	MBT		0.4
LT	908+06	FE		0.9
RT	918+19	PRA	1.2	
LT	918+44	PRA	1.2	
LT	924+25	PE	0.7	
LT	924+48	MBT	0.6	
LT	930+39	PRA	3.7	
RT	930+83	PRA	3.7	
LT	937+65	PE	0.6	
LT	937+82	MBT	0.4	
LT	951+38	FE		0.8

SIDE	STATION	TYPE	INCIDENTAL HOT-MIX ASPHALT SURFACING	
			TON	TON
LT	970+44	CE	1.0	
LT	970+70	MBT	0.5	
LT	973+26	CE		2.0
LT	985+19	PE	2.2	
LT	986+56	PE		0.7
LT	986+96	PE	1.9	
LT	988+77	PE		0.7
LT	989+41	PE		0.7
LT	991+21	PE	0.9	
LT	993+07	PE	0.6	
LT	996+20	FE		0.8
	TOTALS		49	14

FE=FIELD ENTRANCE
PE=PRIVATE ENTRANCE
CE=COMMERCIAL ENTRANCE
PRA - PUBLIC ROAD APPROACH
MBT - MAILBOX TURNOUT

FILE NAME =	USER NAME = steffernk	DESIGNED - 08-03-99	REVISED - 03-13-07
c:\pw\work\p1dot\steffernk\d0242568\074258-sht-sch.dgn		DRAWN -	REVISED -
	PLOT SCALE = 100.0000' / 1"	CHECKED -	REVISED -
	PLOT DATE = 9/29/2014	DATE -	REVISED -

**STATE OF ILLINOIS
DEPARTMENT OF TRANSPORTATION**

**ENTRANCE SCHEDULE AND MAILBOX TURNOUT DETAILS
SHOULDERS (PROPOSED)**

SCALE: N/A SHEET NO. 1 OF 1 SHEETS STA. TO STA.

F.A.P. RTE.	SECTION	COUNTY	TOTAL SHEETS	SHEET NO.
824	(13,14,14-12)RS-3	CUMBERLAND	15	10
FED. ROAD DIST. NO. ILLINOIS FED. AID PROJECT			CONTRACT NO. 74258	

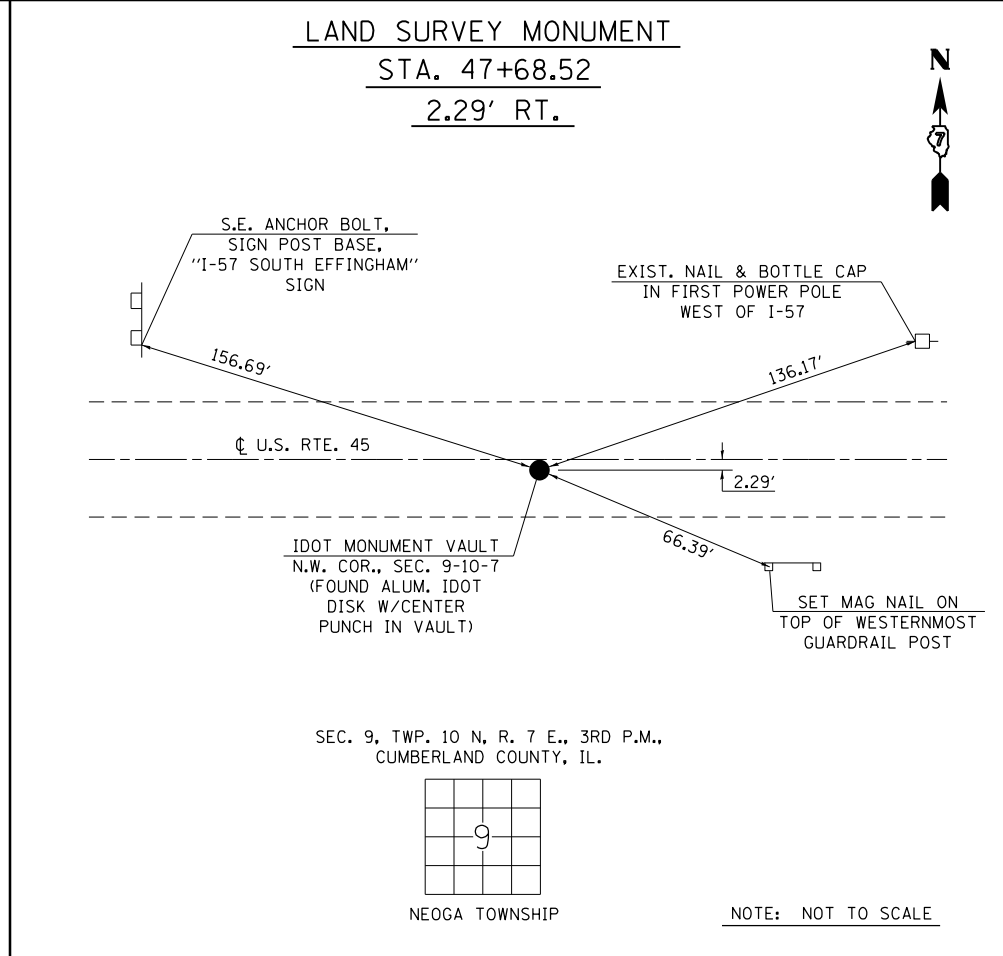
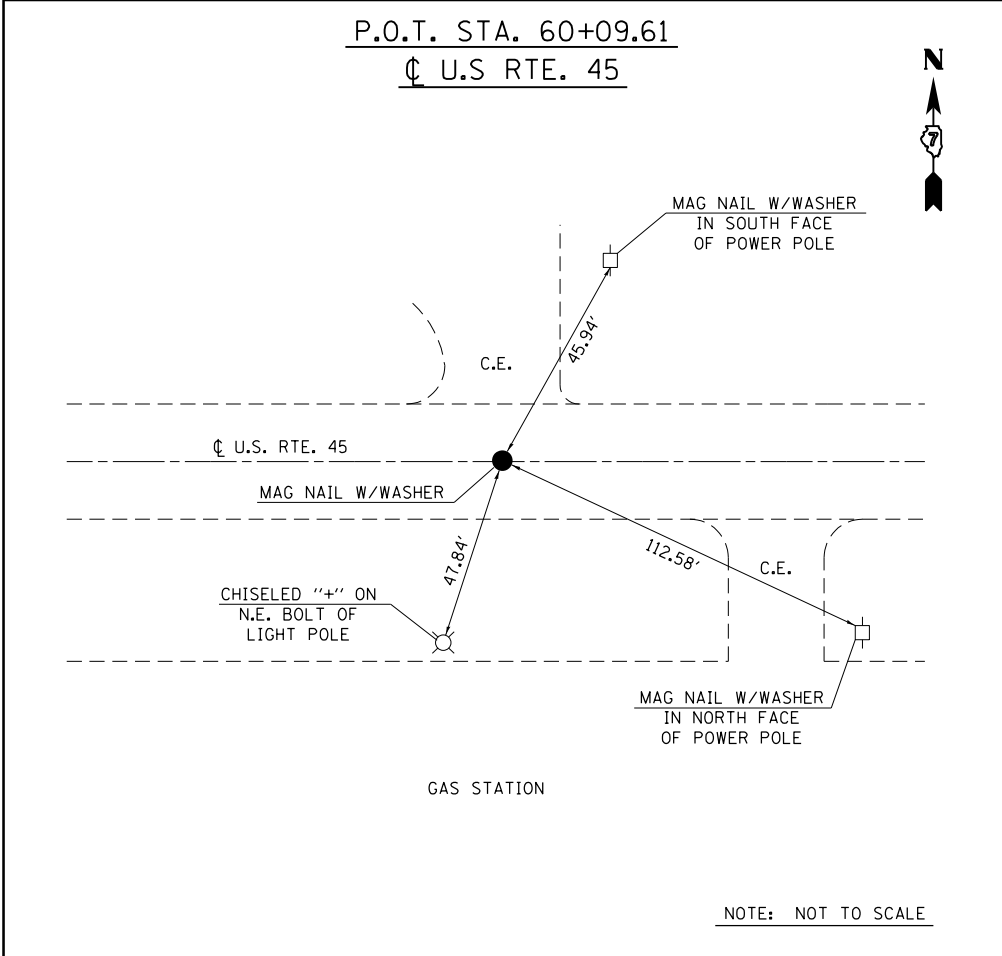
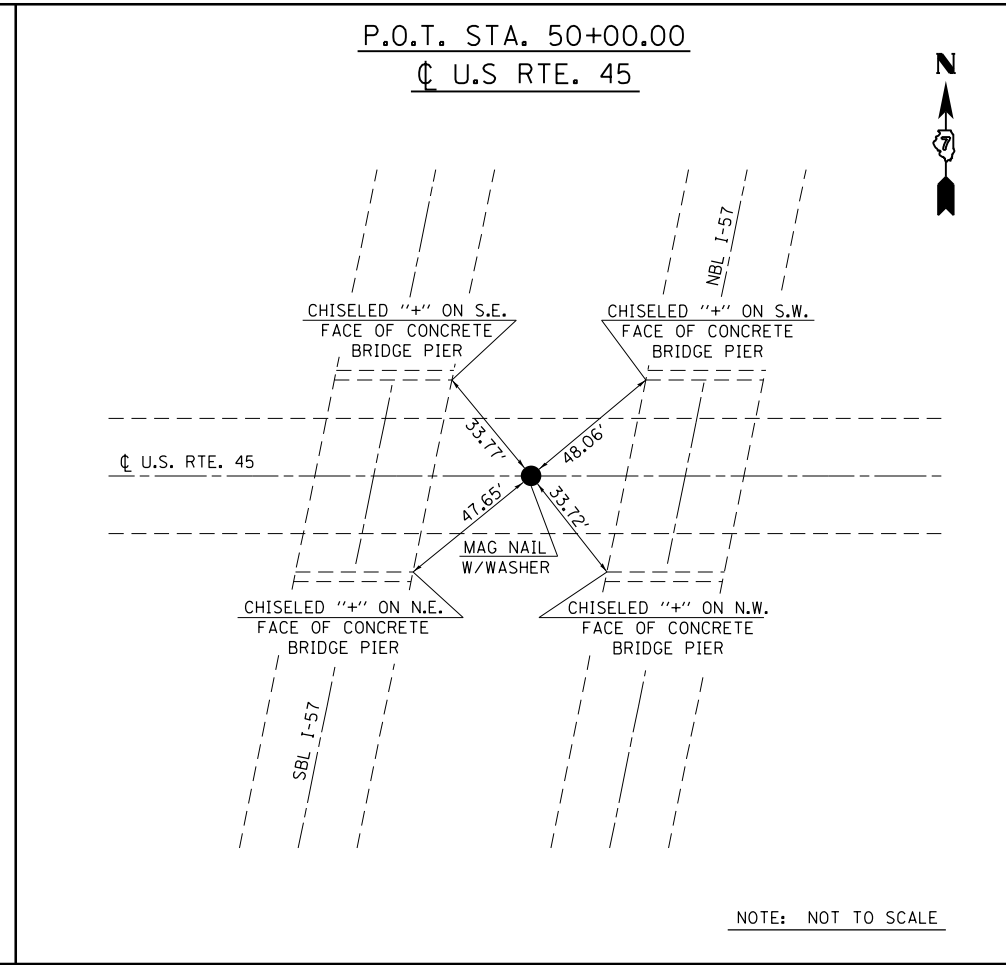
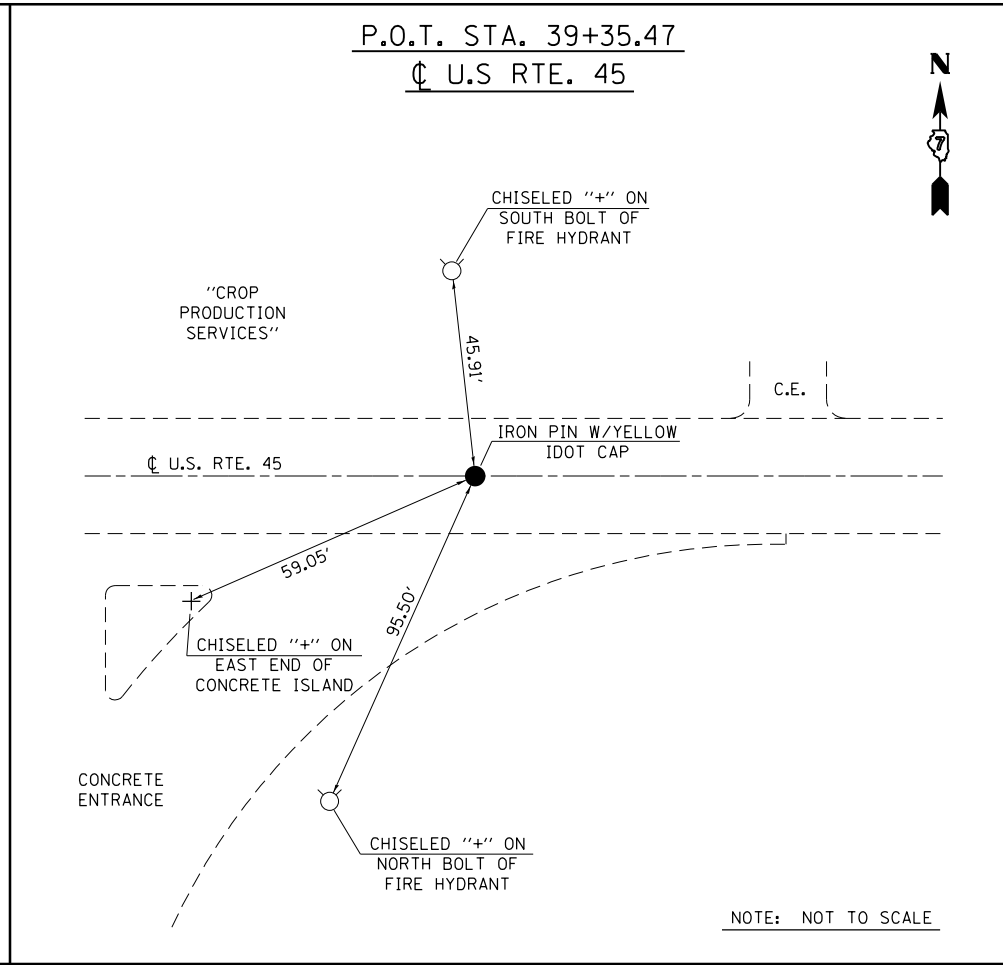
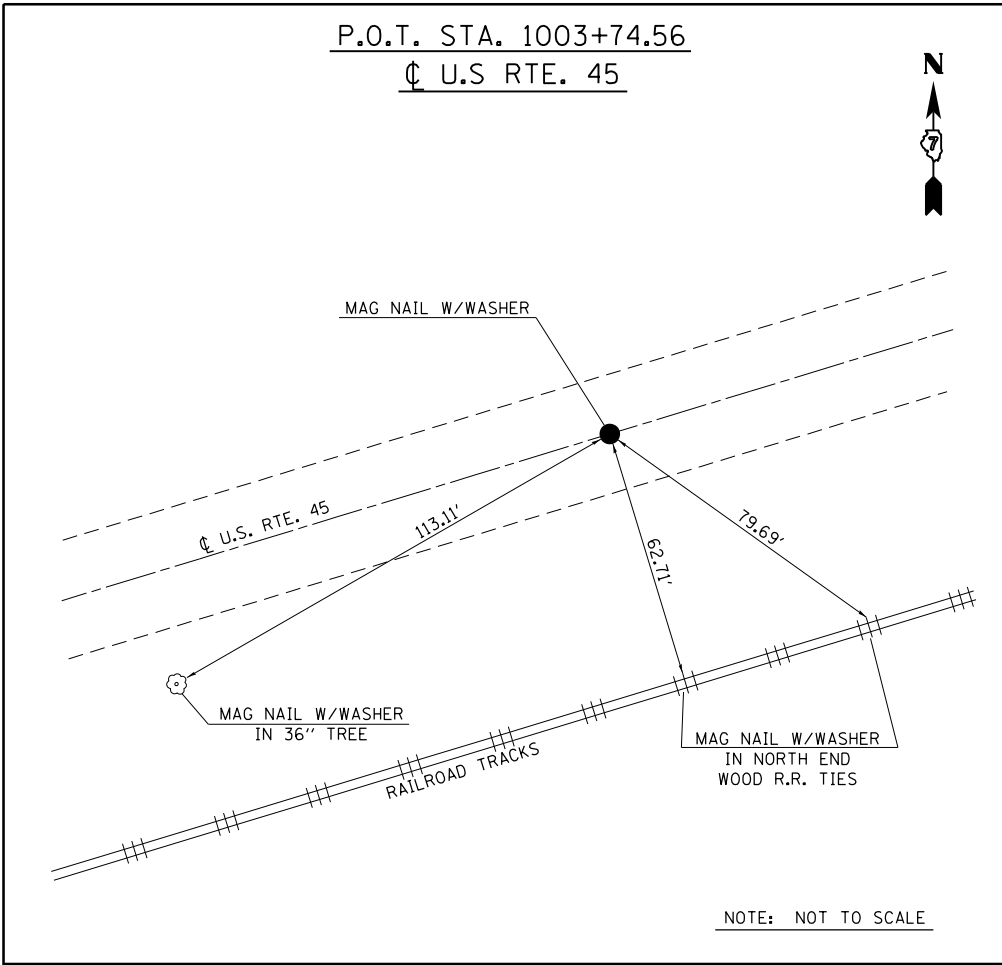

SURVEY MARKER SCHEDULE

STATION	PROTECTING OR RESETTING SURVEY MARKERS (EACH)	PERMANENT SURVEY MARKERS, TYPE 1 (EACH)
1003+74.56	1	1
60+09.61	1	1
50+00	1	1
47+68.52	1	-
39+35.47	1	1
	5	4

FILE NAME =	USER NAME = steffenmk	DESIGNED -	REVISED -
ci:\pw\work\p\idot\steffenmk\d0242568\074258-sht-ties.dgn		DRAWN -	REVISED -
Default	PLOT SCALE = 100.0000' / in.	CHECKED -	REVISED -
	PLOT DATE = 9/29/2014	DATE -	REVISED -

**STATE OF ILLINOIS
 DEPARTMENT OF TRANSPORTATION**

RECOVERY TIE POINTS

SCALE: N/A SHEET 1 OF 1 SHEETS STA. TO STA.

F.A.P. RTE.	SECTION	COUNTY	TOTAL SHEETS	SHEET NO.
824	(13,14,14-12)RS-3	CUMBERLAND	15	11
CONTRACT NO. 74258				
ILLINOIS FED. AID PROJECT				

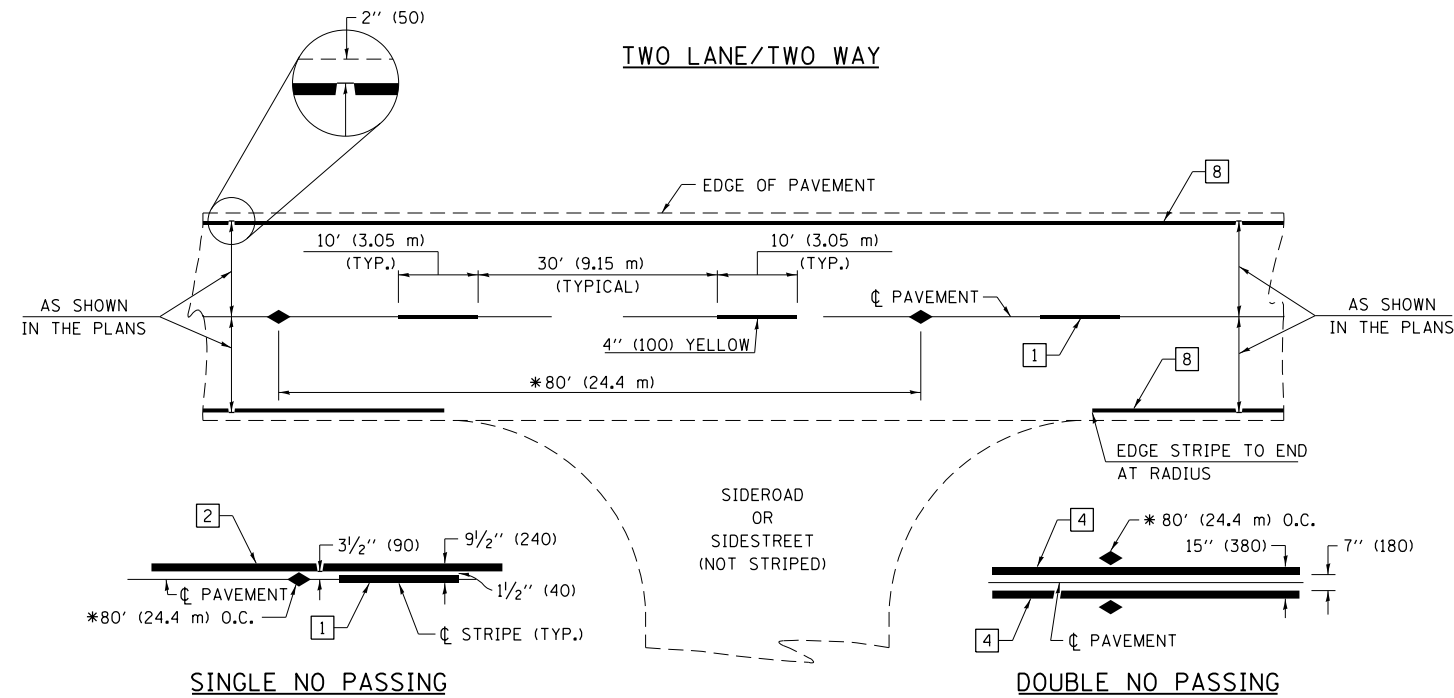

* REDUCE TO 40' (12.2 m) O.C. ON CURVES WITH POSTED OR ADVISORY SPEEDS OF 45 mph (70 km/h) OR LESS.

PAVEMENT MARKING LEGEND

- 1 4" (100) SKIP-DASH (YELLOW)
 - 2 4" (100) SOLID (YELLOW)
 - 3 12" (300) DIAGONAL (YELLOW)
 - 4 4" (100) DOUBLE YELLOW (NARROW)
 - 5 12" (300) SOLID WHITE
 - 6 RESERVED
 - 7 6" (150) SKIP-DASH (WHITE)
 - 8 4" (100) SOLID (WHITE)
 - 9 12" (300) DIAGONAL (WHITE)
 - 10 6" (150) SOLID (WHITE)
 - 11 24" (600) STOP BAR (WHITE)
 - 12 8" (200) SOLID (WHITE)
 - 13 4" (100) PARKING WHITE
-

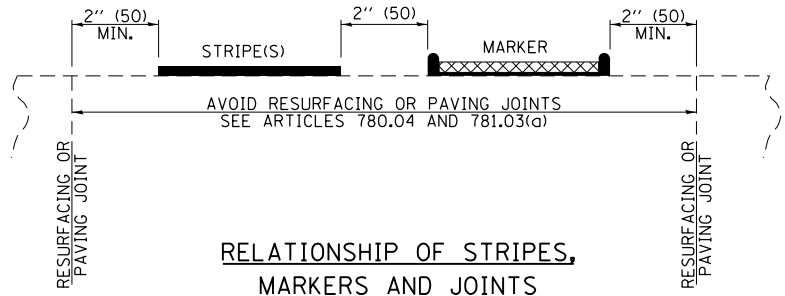

TYPICAL PAVEMENT MARKERS LEGEND

- ◆ TWO-WAY AMBER MARKER
- ▶ ONE-WAY AMBER MARKER
- ▷ ONE-WAY CRYSTAL MARKER

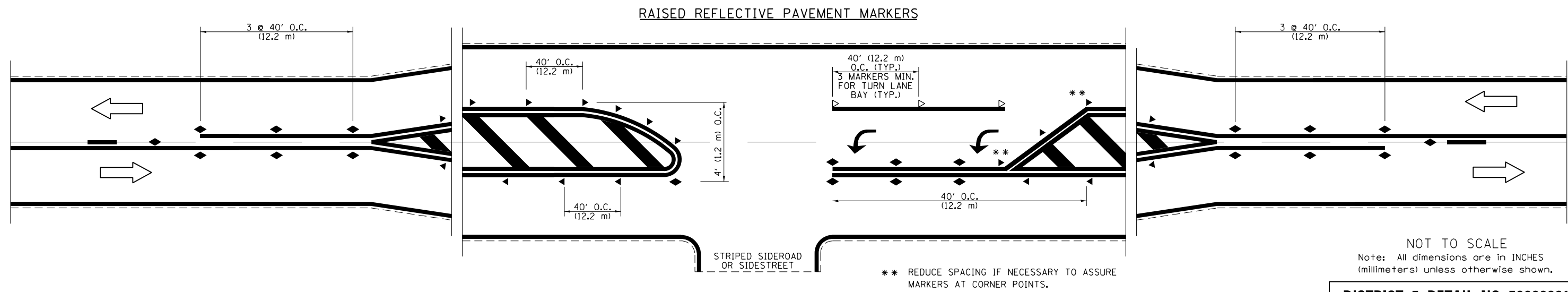

NOT TO SCALE
Note: All dimensions are in INCHES (millimeters) unless otherwise shown.

FILE NAME =	USER NAME = steffenmk	DESIGNED -	REVISED -
ei:\pwork\pwork\stevfemk\d0242568\074258-sht-details.dgn		DRAWN -	REVISED -
	PLOT SCALE = 100.0000' / 1in.	CHECKED -	REVISED -
	PLOT DATE = 9/29/2014	DATE -	REVISED -

**STATE OF ILLINOIS
DEPARTMENT OF TRANSPORTATION**

**PAVEMENT MARKING AND RAISED REFLECTIVE PAVEMENT MARKERS
(RURAL & URBAN APPLICATIONS)**

SCALE: N/A SHEET NO. 1 OF 4 SHEETS STA. TO STA.

DISTRICT 7 DETAIL NO. 78000001				
F.A.P. RTE.	SECTION	COUNTY	TOTAL SHEETS	SHEET NO.
824	(13,14,14-1Z)RS-3	CUMBERLAND	15	12
			CONTRACT NO. 74258	
ILLINOIS FED. AID PROJECT				

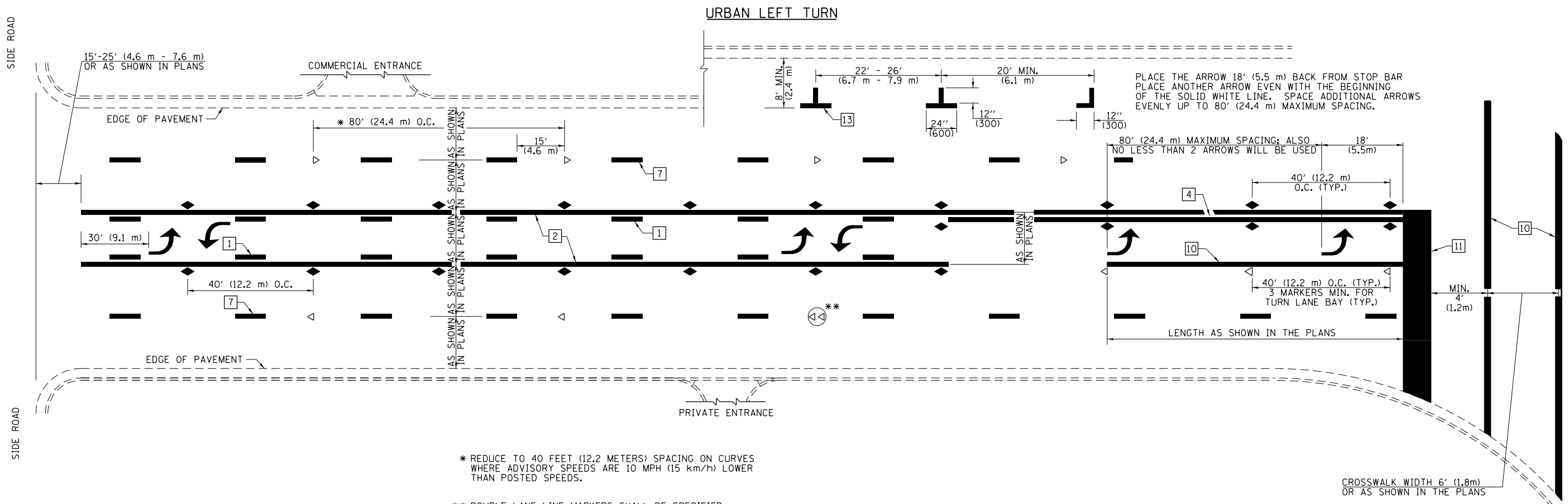

* REDUCE TO 40 FEET (12.2 METERS) SPACING ON CURVES WHERE ADVISORY SPEEDS ARE 10 MPH (15 km/h) LOWER THAN POSTED SPEEDS.

** DOUBLE LANE LINE MARKERS SHALL BE SPECIFIED AND SPACED AS SHOWN IN HIGHWAY STANDARD 781001 FOR MULTI-LANE DIVIDED AND UNDIVIDED HIGHWAYS.

PAVEMENT MARKING LEGEND

- 1 4" (100) SKIP-DASH (YELLOW)
- 2 4" (100) SOLID (YELLOW)
- 3 12" (300) DIAGONAL (YELLOW)
- 4 4" (100) DOUBLE YELLOW (NARROW)
- 5 12" (300) SOLID WHITE
- 6 RESERVED
- 7 6" (150) SKIP-DASH (WHITE)
- 8 4" (100) SOLID (WHITE)
- 9 12" (300) DIAGONAL (WHITE)
- 10 6" (150) SOLID (WHITE)
- 11 24" (600) STOP BAR (WHITE)
- 12 8" (200) SOLID (WHITE)
- 13 4" (100) PARKING WHITE

GENERAL NOTES

1. TURN ARROW PAIRS SHALL BE PLACED AT 250' (75 m) INTERVALS AND SHALL BE EVENLY SPACED BETWEEN BOTH ENDS OF THE BIDIRECTIONAL LEFT TURN LANE. USE A MINIMUM OF TWO PAIRS PER BLOCK.
2. THE SOLID YELLOW PAVEMENT MARKINGS [2] SHOULD GENERALLY START OR END NEAR THE RADIUS POINT OF EACH STREET RETURN EXCEPT WHERE ONE OR BOTH ENDS WOULD INCLUDE STOP BARS.
3. THE SKIP-DASH PAVEMENT MARKINGS [1] OR [7] SHOULD BE CENTERED BETWEEN BOTH ENDS OF EACH CITY BLOCK AND SHALL BE PLACED SO THEY LINE UP ACROSS FROM EACH OTHER.
4. USE LARGE ARROW SIZE FOR BOTH RURAL AND URBAN LOCATIONS. (SEE LAST PAGE OF SECTION 780x FOR SYMBOLS TABLE)
5. LANE LINE EXTENSIONS SHALL BE THE SAME COLOR AND WIDTH AS THE LANE LINE BEING EXTENDED.

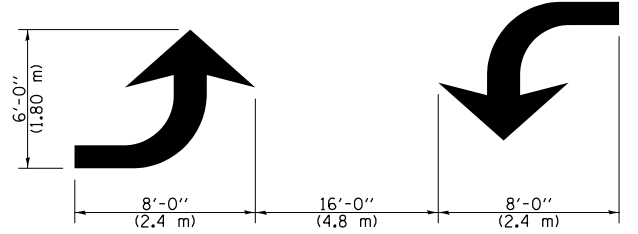
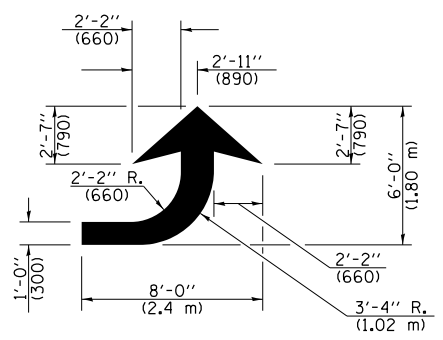
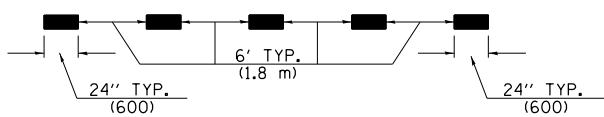
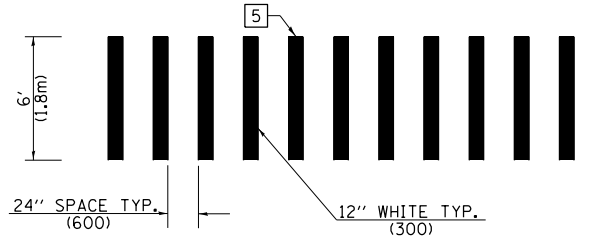

NOT TO SCALE
 Note: All dimensions are in INCHES (millimeters) unless otherwise shown.

DISTRICT 7 DETAIL NO. 7800001

FILE NAME =	USER NAME = steffenmk	DESIGNED -	REVISED -	STATE OF ILLINOIS DEPARTMENT OF TRANSPORTATION	PAVEMENT MARKING AND RAISED REFLECTIVE PAVEMENT MARKERS (RURAL & URBAN APPLICATIONS)			F.A.P. RTE.	SECTION	COUNTY	TOTAL SHEETS	SHEET NO.
ei:\pw\work\p\idot\stevfemk\d0242568\074258-sht-details.dgn	PLOT SCALE = 100.0000' / in.	DRAWN -	REVISED -					824	(13,14,14-1Z)RS-3	CUMBERLAND	15	13
	PLOT DATE = 9/29/2014	CHECKED -	REVISED -		SCALE: N/A			SHEET NO. 2 OF 4 SHEETS		CONTRACT NO. 74258		
		DATE -	REVISED -		STA.		TO STA.		ILLINOIS FED. AID PROJECT			

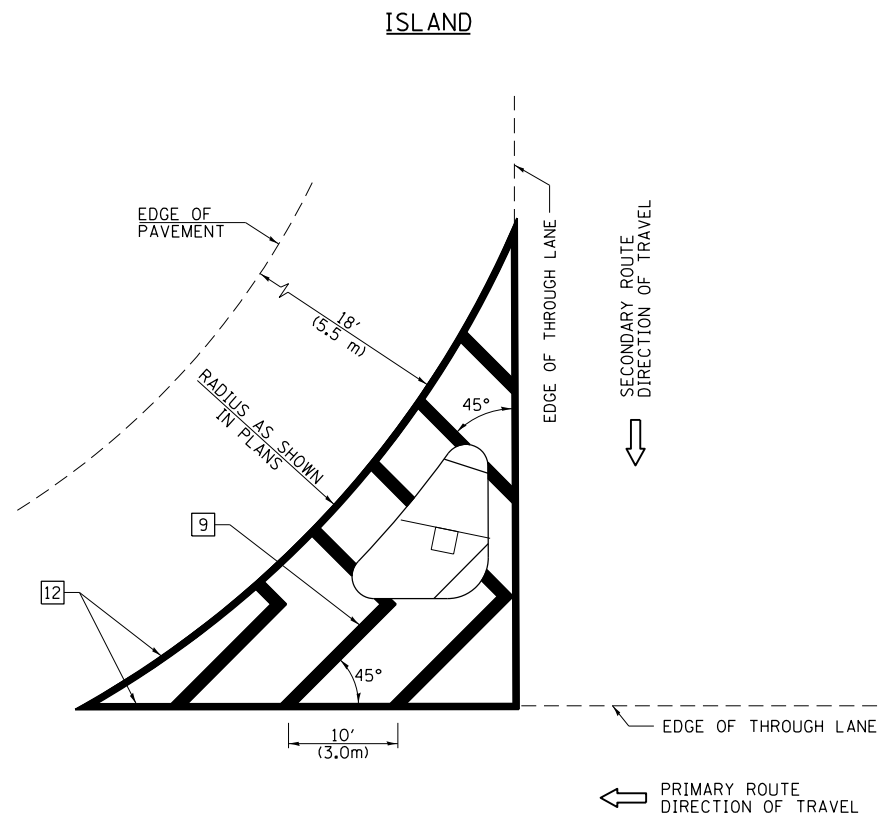

GENERAL NOTES

1. RAISED AND CORRUGATED MEDIANS SHALL BE OUTLINED WITH [2] IF PRESENT.
2. SOME OF THE INFORMATION INCLUDED WITH THIS DETAIL MAY NOT BE APPLICABLE TO THIS IMPROVEMENT.
3. PAVEMENT MARKINGS ARE TO BE EXTENDED THROUGH OMISSIONS WHEN APPLICABLE.
4. FINAL PAVEMENT MARKINGS SHALL BE IN PLACE PRIOR TO PLACING ANY RAISED REFLECTIVE PAVEMENT MARKERS.
5. THE FOLLOWING CRITERIA SHALL BE USED FOR SELECTING THE DIAGONAL PAVEMENT MARKING SPACING:

< 30 MPH (< 50 km/h)	15' (4.5 m)
30-45 MPH (50-75 km/h)	20' (6.0 m)
> 45 MPH (> 75 km/h)	30' (9.0 m)

PAVEMENT MARKING LEGEND

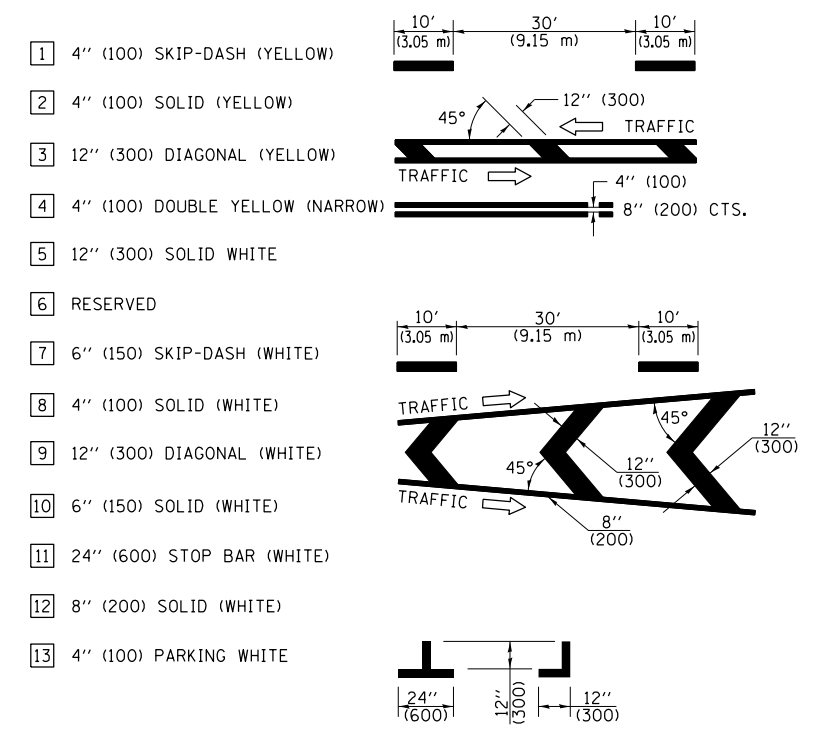

RURAL LEFT TURN STRIPING

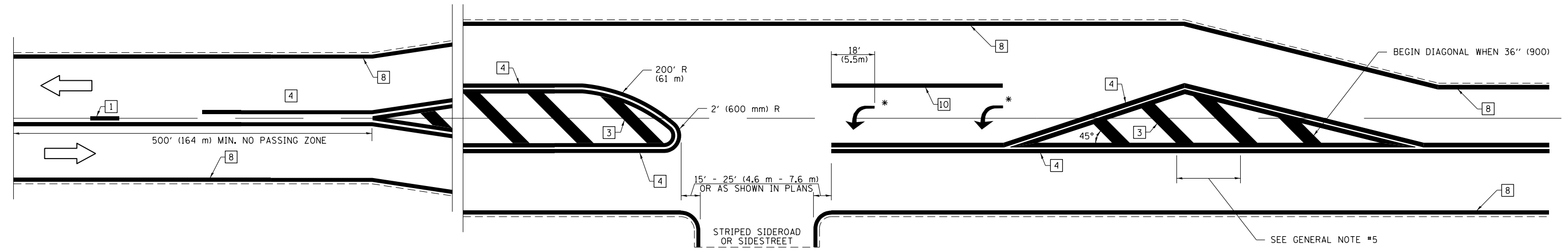

* PLACE AN ARROW 18' (5.5 m) BACK FROM STOP BAR. PLACE ANOTHER ARROW EVEN WITH THE BEGINNING OF THE SOLID WHITE LINE. SPACE ADDITIONAL ARROWS EVENLY UP TO 80' (24.4 m) MAXIMUM SPACING. USE MINIMUM OF 2 ARROWS.

NOT TO SCALE
Note: All dimensions are in INCHES (millimeters) unless otherwise shown.

DISTRICT 7 DETAIL NO. 7800001

FILE NAME =	USER NAME = steffenmk	DESIGNED -	REVISED -
ei:\pwork\pwork\stevfenmk\d0242568\074258-sht-details.dgn		DRAWN -	REVISED -
	PLOT SCALE = 100.0000' / 1in.	CHECKED -	REVISED -
	PLOT DATE = 9/29/2014	DATE -	REVISED -

**STATE OF ILLINOIS
DEPARTMENT OF TRANSPORTATION**

PAVEMENT MARKING AND RAISED REFLECTIVE PAVEMENT MARKERS (RURAL & URBAN APPLICATIONS)			
SCALE: N/A	SHEET NO. 3 OF 4 SHEETS	STA.	TO STA.

F.A.P. RTE.	SECTION	COUNTY	TOTAL SHEETS	SHEET NO.
824	(13,14,14-1Z)RS-3	CUMBERLAND	15	14
				CONTRACT NO. 74258
ILLINOIS FED. AID PROJECT				

PAVEMENT MARKINGS AT RAILROAD-HIGHWAY GRADE CROSSING

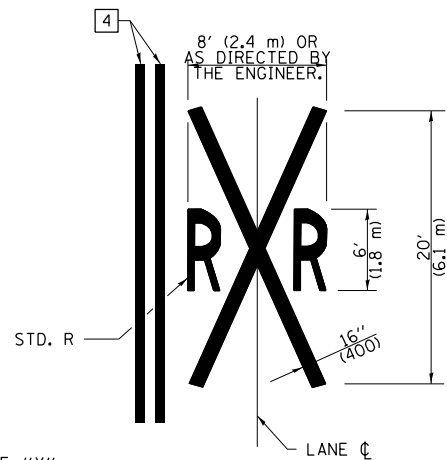
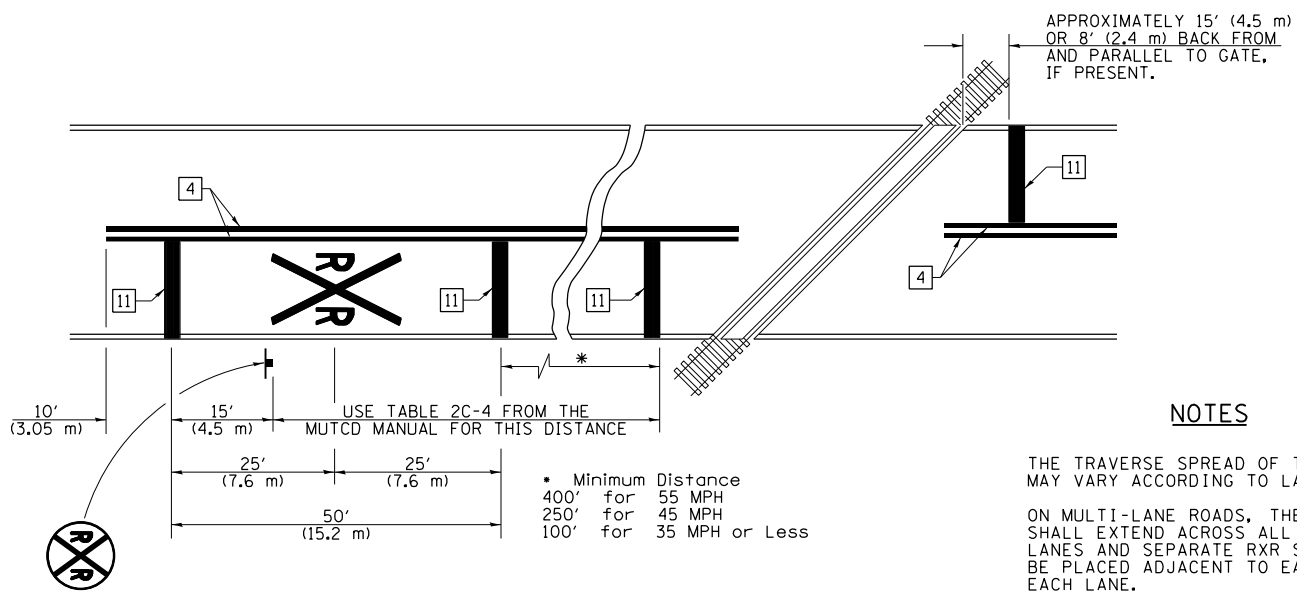

NOTES

THE TRAVERSE SPREAD OF THE "X" MAY VARY ACCORDING TO LANE WIDTH.

ON MULTI-LANE ROADS, THE STOP LINES SHALL EXTEND ACROSS ALL APPROACH LANES AND SEPARATE RXR SYMBOLS SHALL BE PLACED ADJACENT TO EACH OTHER IN EACH LANE.

WHEN THE PAVEMENT MARKING SYMBOL IS USED, A PORTION OF THE SYMBOL SHOULD BE LOCATED DIRECTLY ADJACENT TO THE ADVANCE WARNING SIGN (W10-1) AS PLACED BY TABLE II-1, CONDITION B OF THE MUTCD.

PAVEMENT MARKING LEGEND

- 1 4" (100) SKIP-DASH (YELLOW)
- 2 4" (100) SOLID (YELLOW)
- 3 12" (300) DIAGONAL (YELLOW)
- 4 4" (100) DOUBLE YELLOW (NARROW)
- 5 12" (300) SOLID WHITE
- 6 RESERVED
- 7 6" (150) SKIP-DASH (WHITE)
- 8 4" (100) SOLID (WHITE)
- 9 12" (300) DIAGONAL (WHITE)
- 10 6" (150) SOLID (WHITE)
- 11 24" (600) STOP BAR (WHITE)
- 12 8" (200) SOLID (WHITE)
- 13 4" (100) PARKING WHITE

RAILROAD CROSSING WITH INTERCONNECT ONLY

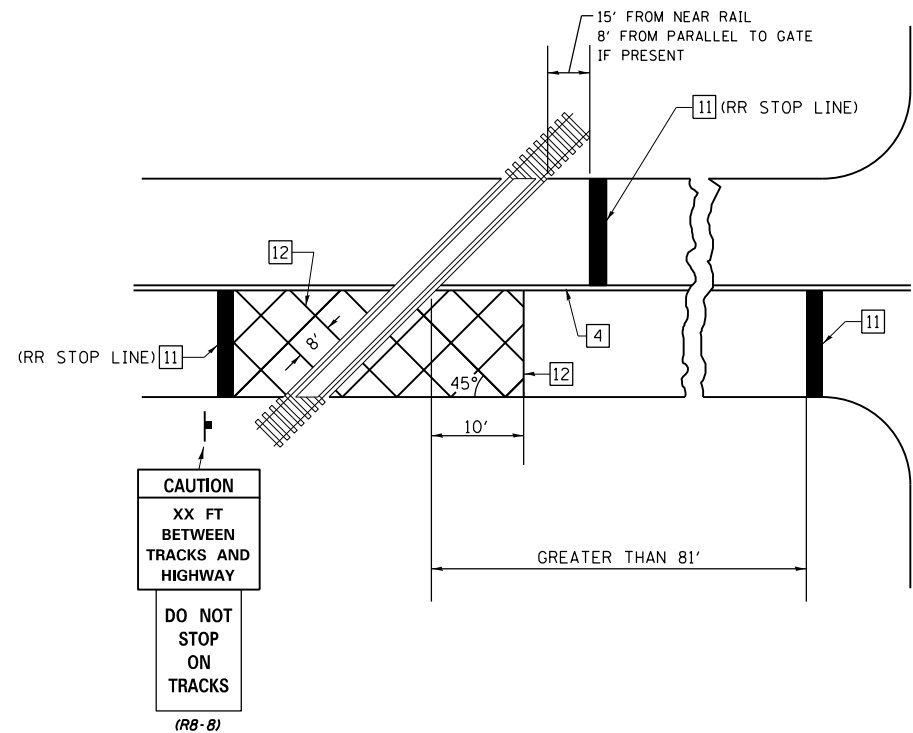

RAILROAD CROSSING WITH INTERCONNECT AND PRE-SIGNALS

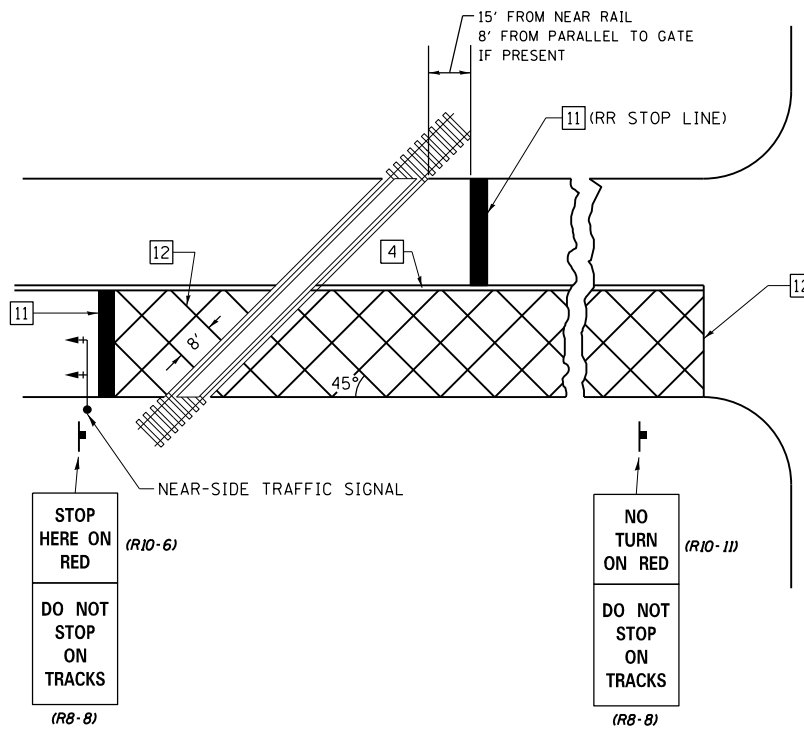

GENERAL NOTES

- SUPPLEMENTAL PAVEMENT MARKINGS TO BE INSTALLED ONLY ON APPROACHES TO INTERSECTIONS CONTROLLED BY TRAFFIC SIGNALS WHICH ARE INTERCONNECTED WITH THE RAILROAD WARNING SIGNALS.
- EXTEND PAVEMENT MARKINGS TO THE INTERSECTION ONLY WHERE NEAR-SIDE TRAFFIC SIGNALS ARE USED.

SUPPLEMENTAL PAVEMENT MARKING TREATMENT FOR RAILROAD-HIGHWAY GRADE CROSSING

NOT TO SCALE
Note: All dimensions are in INCHES (millimeters) unless otherwise shown.

DISTRICT 7 DETAIL NO. 7800001

FILE NAME =	USER NAME = steffenmk	DESIGNED -	REVISED -
c:\pwork\pwork\stevfenmk\d0242568\0774258-sht-details.dgn		DRAWN -	REVISED -
	PLOT SCALE = 100.0000' / 1"	CHECKED -	REVISED -
	PLOT DATE = 9/29/2014	DATE -	REVISED -

STATE OF ILLINOIS
DEPARTMENT OF TRANSPORTATION

PAVEMENT MARKING AND RAISED REFLECTIVE PAVEMENT MARKERS
(RURAL & URBAN APPLICATIONS)

SCALE: N/A SHEET NO. 4 OF 4 SHEETS STA. TO STA.

F.A.P. RTE.	SECTION	COUNTY	TOTAL SHEETS	SHEET NO.
824	(13,14,14-1Z)RS-3	CUMBERLAND	15	15
				CONTRACT NO. 74258
ILLINOIS FED. AID PROJECT				