

FOR INFORMATION ONLY

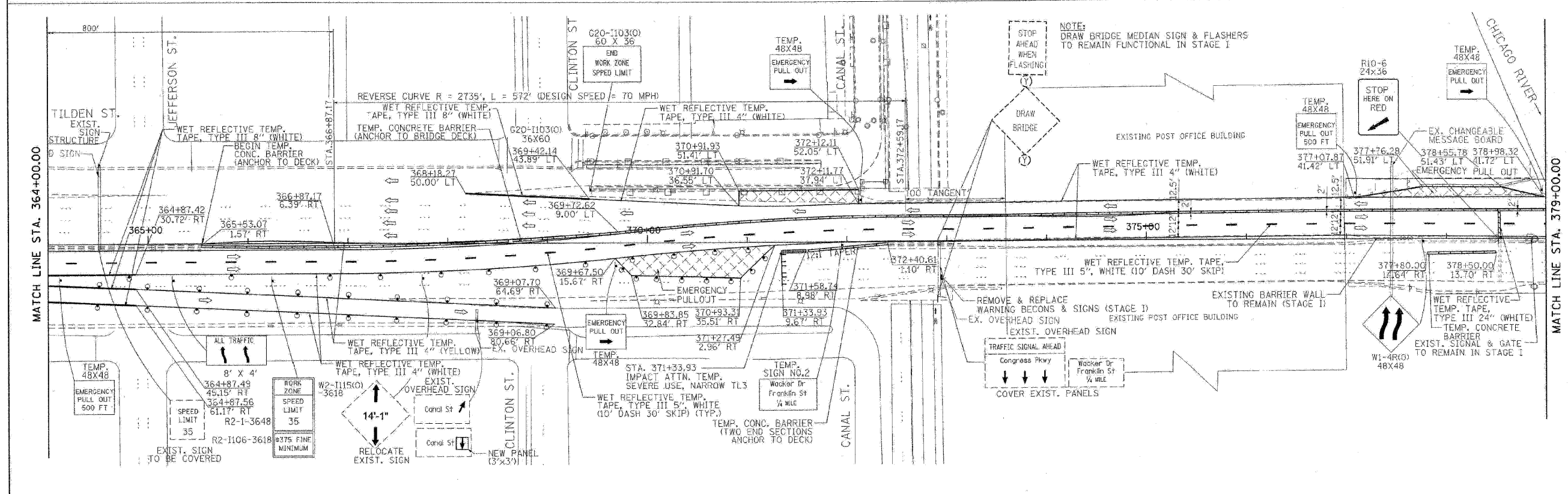
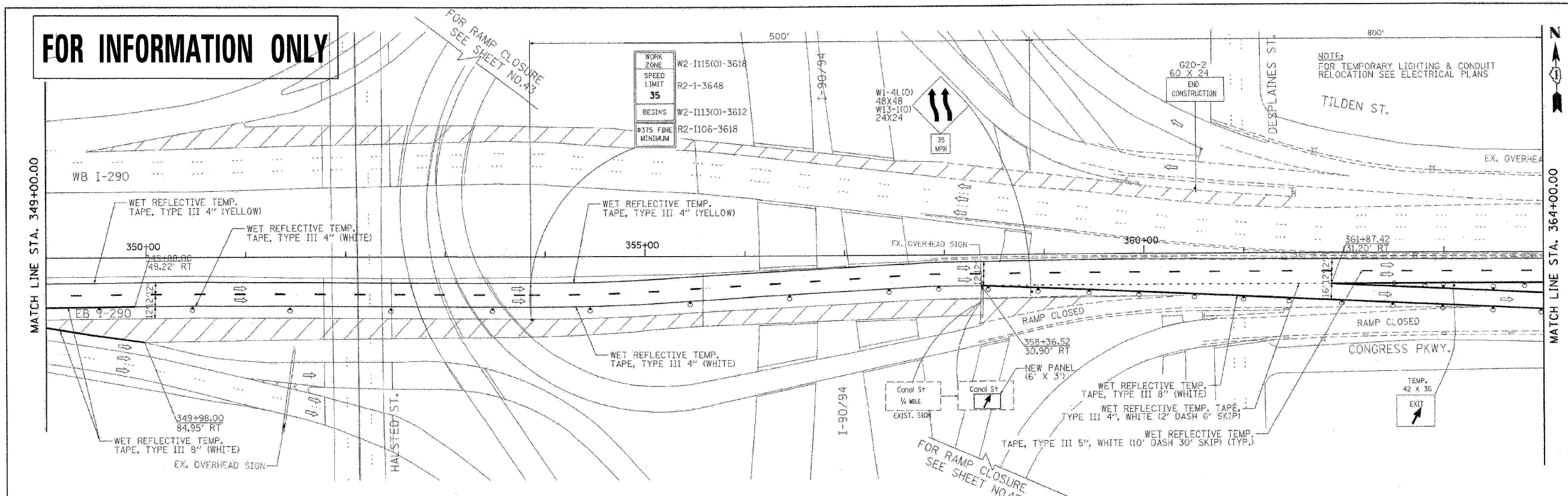

PB Americas, Inc. 230 WEST MONROE STREET, SUITE 900 CHICAGO, IL. 60606	USER NAME = BURFR	DESIGNED = DM	REVISED =	STATE OF ILLINOIS DEPARTMENT OF TRANSPORTATION	CONGRESS PARKWAY OVER SOUTH BRANCH OF THE CHICAGO RIVER SUGGESTED STAGES OF CONSTRUCTION AND TRAFFIC CONTROL PLANS - STAGE I	F.A.P. SECTION COUNTY TOTAL SHEET SHEETS NO.
	FILE NAME = #FILENAME#	DRAWN = MS	REVISED =			389 2424-2B-R COOK 398 35
	PLOT SCALE = #SCALE#	CHECKED = DS	REVISED =			CONTRACT NO. 60D61
	PLOT DATE = #DATE#	DATE = 5/08/09	REVISED =			FED. ROAD DIST. NO. 1 (ILLINOIS) FED. AID PROJECT

FILE NAME =	DESIGNED = AJP	REVISED =
...p\p\in_abc_c3_290_mot.st_2.05_580d61.dgn	DRAWN = TMB	REVISED =
USER NAME = jmjewski	CHECKED = JJT	REVISED =
PLOT DATE = 1/25/2018	DATE = 1/25/10	REVISED =

benesch

STATE OF ILLINOIS
DEPARTMENT OF TRANSPORTATION

MAINTENANCE OF TRAFFIC
PLAN - STAGE 2

SCALE: 1"=50' SHEET NO. 33 OF 40 SHEETS STA. TO STA.

F.A.I. SECTION COUNTY TOTAL SHEET SHEETS NO.
290 (2525, ETC., 2727)RS-8 COOK 201 81
FED. ROAD DIST. NO. (ILLINOIS) FED. AID PROJECT
CONTRACT NO. 60K11