

FILE NAME = M:\191-130\_1DOT\_IL64VPADD\_Sheets\0160J11-ahc-intersec 14' Spacing.dgn

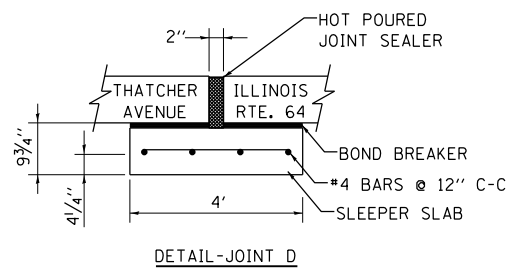
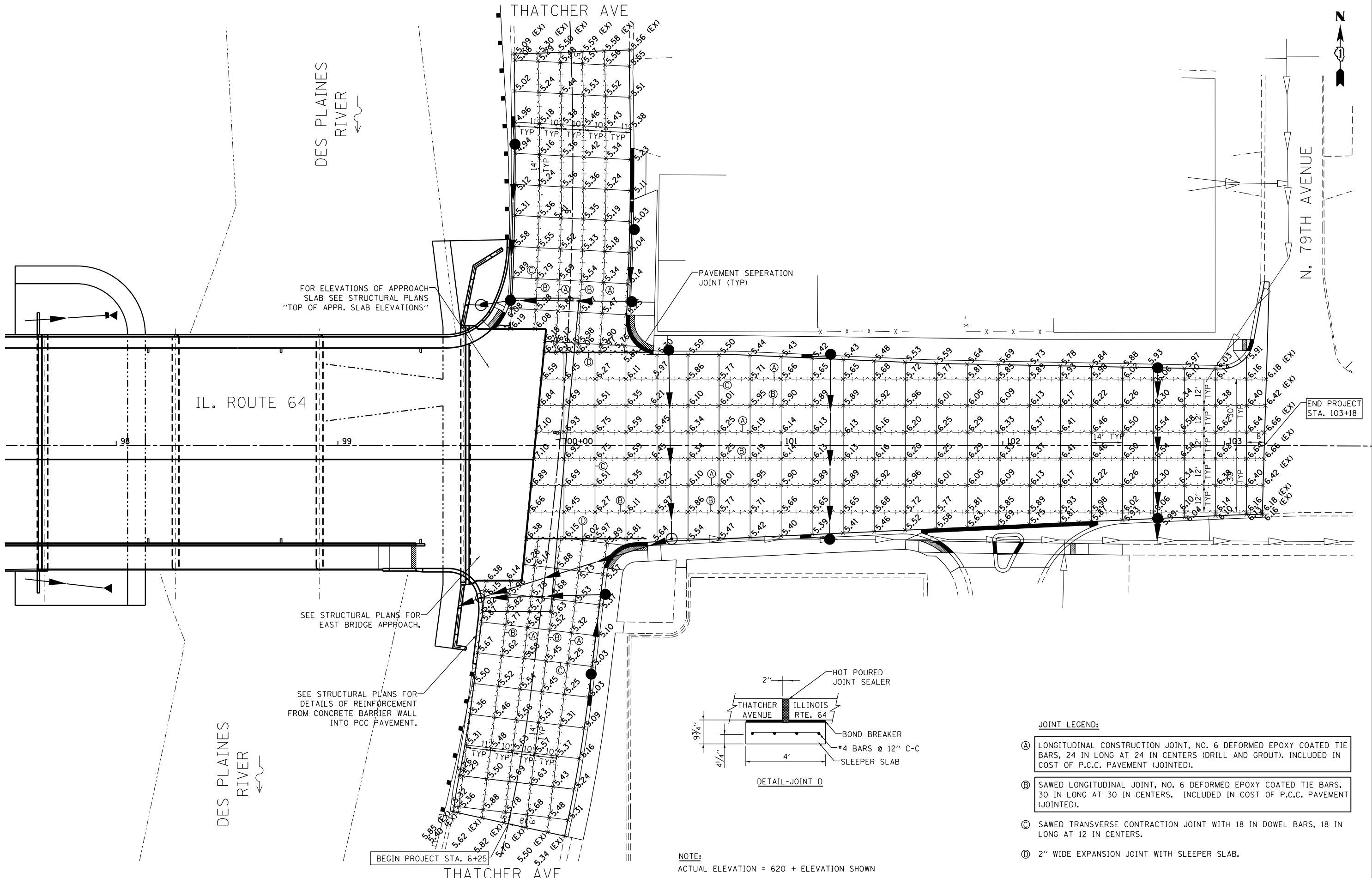

- JOINT LEGEND:**
- (A) LONGITUDINAL CONSTRUCTION JOINT, NO. 6 DEFORMED EPOXY COATED TIE BARS, 24 IN LONG AT 24 IN CENTERS (DRILL AND GROUT). INCLUDED IN COST OF P.C.C. PAVEMENT (JOINTED).
  - (B) SAWED LONGITUDINAL JOINT, NO. 6 DEFORMED EPOXY COATED TIE BARS, 30 IN LONG AT 30 IN CENTERS. INCLUDED IN COST OF P.C.C. PAVEMENT (JOINTED).
  - (C) SAWED TRANSVERSE CONTRACTION JOINT WITH 18 IN DOWEL BARS, 18 IN LONG AT 12 IN CENTERS.
  - (D) 2" WIDE EXPANSION JOINT WITH SLEEPER SLAB.

**Bollinger, Lach & Associates, Inc.**  
ITASCA, ILLINOIS

USER NAME = cesario	DESIGNED - MTC	REVISED -
PLOT SCALE = 40.0000' / in.	DRAWN - MTC	REVISED -
PLOT DATE = 8/16/2013	CHECKED - JIP	REVISED -
	DATE - 06/07/2013	REVISED -

**STATE OF ILLINOIS  
DEPARTMENT OF TRANSPORTATION**

**ILLINOIS ROUTE 64 (NORTH AVE) OVER THE DES PLAINES RIVER  
INTERSECTION JOINTING PLAN**

SCALE: 1"=20' SHEET 1 OF 1 SHEETS STA. TO STA.

F.A.P. RTE.	SECTION	COUNTY	TOTAL SHEETS	SHEET NO.
307	541Y-3-B	COOK	143	39
CONTRACT NO. 60J11				
ILLINOIS FED. AID PROJECT				