

**BEARING SEAT
ELEVATION TABLE - STAGE II**

Beam No.	℄ Brg.
1	624.58
2	624.71
3	624.84
4	624.96
5	625.06
6	625.16
7	625.26
8	625.36
9	625.36
10	625.26

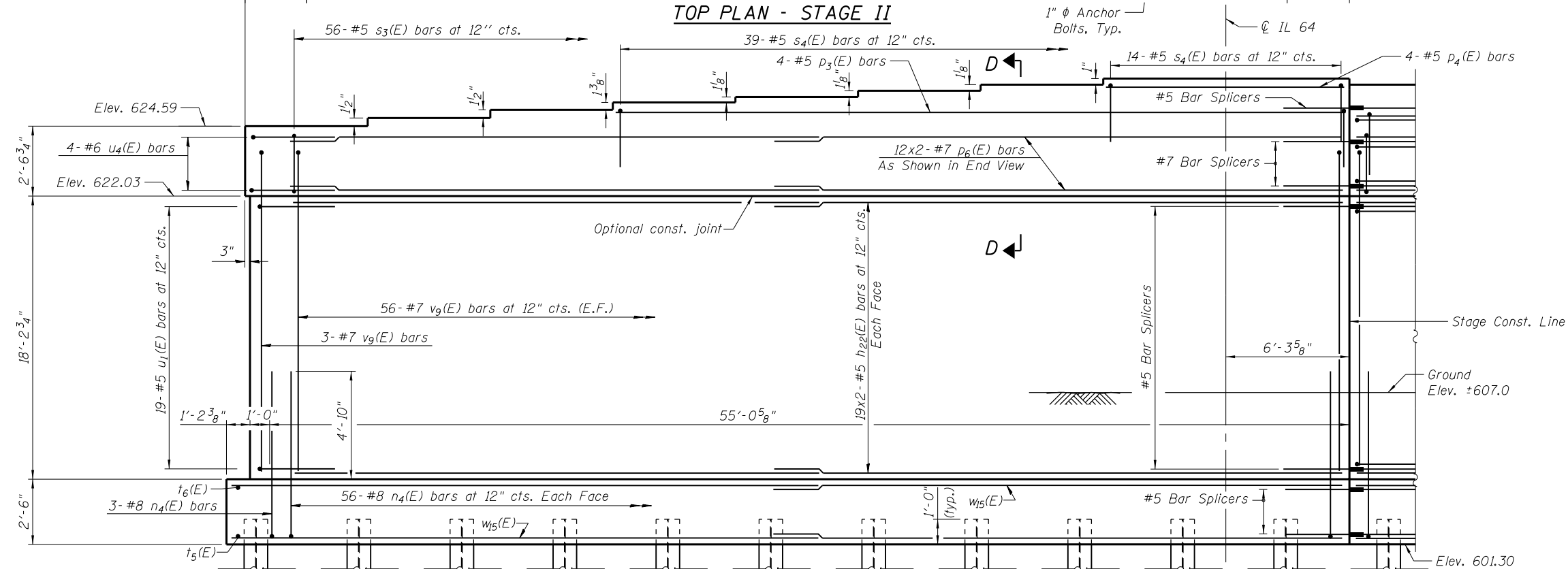

PILE DATA - STAGE II

Type: HP 12x53 with Pile Shoes
 Nominal Required Bearing: 419 kips
 Factored Resistance Available: 230 kips
 Est. Length: 40'
 No. Production Piles: 22
 No. Test Piles: 0

↓ Denotes Battered Pile (1:12)

Notes:
 Space reinforcement in cap to miss anchor bolts.
 Pour steps monolithically with cap.
 See sheet 52 of 62 for details of piles.
 See sheet 53 of 62 for Bar Splicer details.
 See sheet 48 of 62 for anchor bolt locations.
 End View and Section D-D.
 Bars indicated thus 12x2-#7 etc. indicates 12 lines of bars with 2 lengths per line.
 E.F. Denotes Each Face.

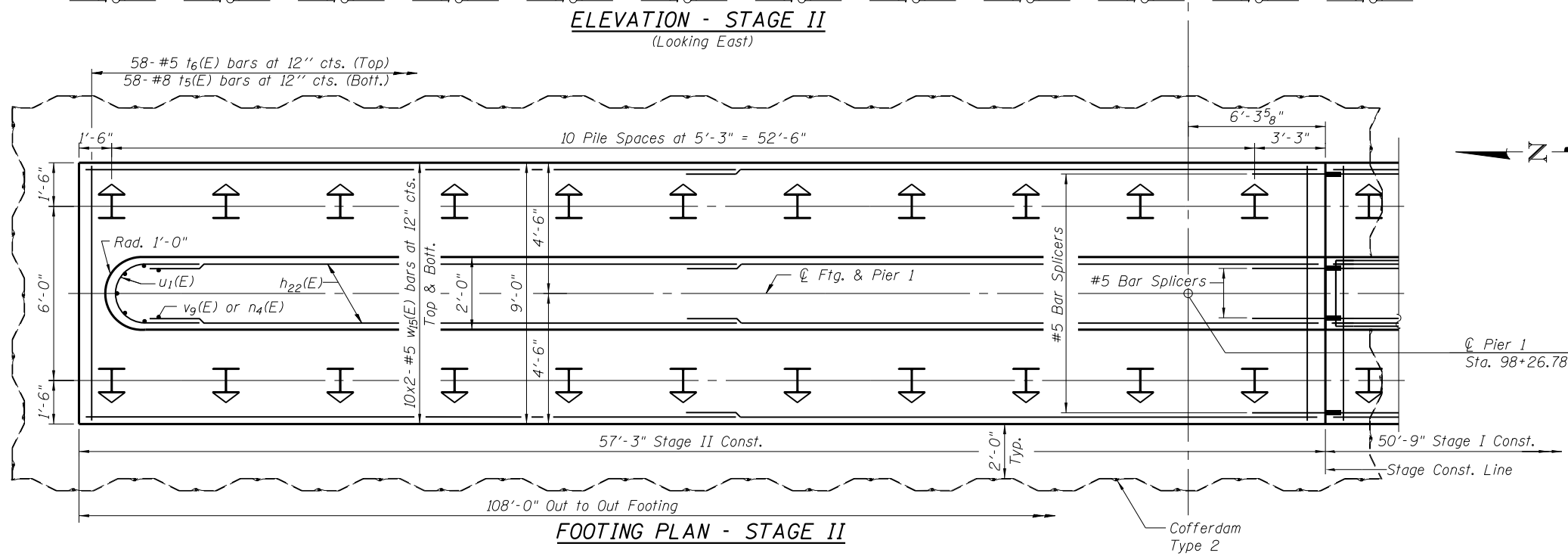

MINIMUM BAR LAP

#5 Bars = 2'-11"
 #7 Bars = 4'-8"

FILE NAME = W:\191-130-1001-IL64\CADD_Sheets\Structure\166011-Str-37A_Pier 1.dgn

Bollinger, Lach & Associates, Inc.
 ITASCA, ILLINOIS

USER NAME =	DESIGNED - JMT	REVISED
PLOT SCALE =	CHECKED - JJI	REVISED
PLOT DATE = 8/16/2013	DRAWN - GM	REVISED
	CHECKED - JJI	REVISED

**STATE OF ILLINOIS
DEPARTMENT OF TRANSPORTATION**

**PIER 1 - STAGE II
STRUCTURE NO. 016-3035**
 SHEET NO. 47 OF 62 SHEETS

F.A.P. RTE.	SECTION	COUNTY	TOTAL SHEETS	SHEET NO.
307	541Y-3-B	COOK	143	108
CONTRACT NO. 60J11				
ILLINOIS FED. AID PROJECT				