

0 50 100
SCALE: 1" = 50'-0"

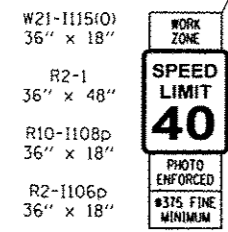
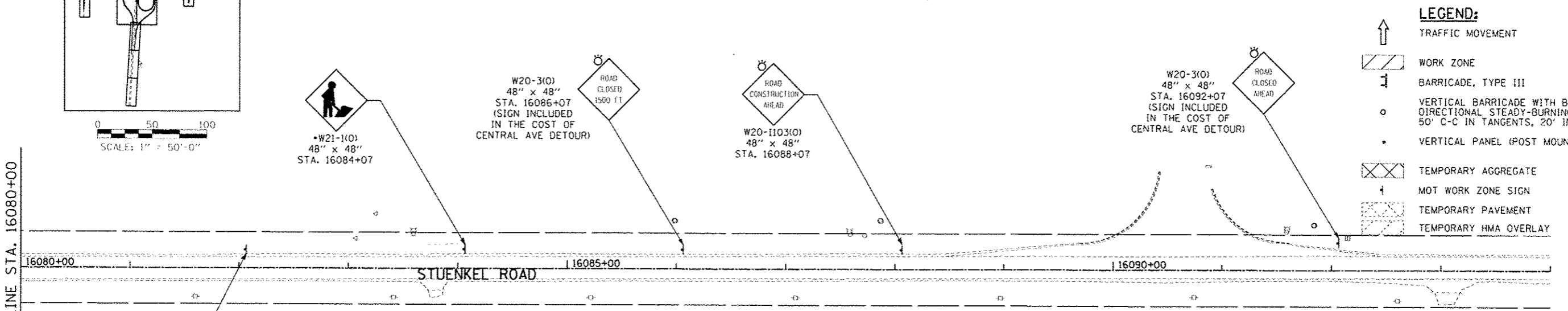

STA. 16082+07

- NOTES:**
- SEE STUENKEL ROAD MAINTENANCE OF TRAFFIC - DETOUR PLAN FOR ADVANCED SIGNING.
 - THE EXISTING R.O.W. IS NOT DEPICTED WITHIN THE PROJECT LIMITS FOR CLARITY.

| | | | | | | | | | | |
|---------------------|-----------|----------------|----------------------|---|---|---------------------|-----------|--------------------------------|--------------|-----------|
| TYLIN INTERNATIONAL | USER NAME | DESIGNED - JTP | REVISED - 10/18/2013 | STATE OF ILLINOIS DEPARTMENT OF TRANSPORTATION | STUENKEL ROAD AT I-57 RIDGELAND AVENUE TO CENTRAL AVENUE MAINTENANCE OF TRAFFIC STAGE 2B - STUENKEL ROAD | F.A. RTE. | SECTION | COUNTY | TOTAL SHEETS | SHEET NO. |
| | PLT SCALE | DRAWN - JTP | REVISED - 12/04/2013 | | | 57 | 99-14B-R1 | WILL | 679 | 118 |
| | PLT DATE | CHECKED - JPM | REVISED | | | CONTRACT NO. 60L69 | | ILLINOIS FED. AID PROJECT | | |
| DATE - 05/10/2013 | | | | REVISED | SCALE: 1" = 50' | SHEET 2 OF 4 SHEETS | | STA. 16066+00 TO STA. 16081+00 | | |