

**LEGEND:**

- TRAFFIC MOVEMENT
- WORK ZONE
- BARRICADE, TYPE III
- VERTICAL BARRICADE WITH BI-DIRECTIONAL STEADY-BURNING LIGHT, 50' C-C IN TANGENTS, 20' IN TAPERS
- VERTICAL PANEL (POST MOUNTED)
- TEMPORARY AGGREGATE
- MOT WORK ZONE SIGN
- TEMPORARY PAVEMENT

0 50 100  
SCALE: 1" = 50'-0"

**NOTES:**

- SEE STUENKEL ROAD MAINTENANCE OF TRAFFIC - DETOUR PLAN FOR ADVANCED SIGNING.
- THE EXISTING R.O.W. IS NOT DEPICTED WITHIN THE INTERSECTION FOR CLARITY.

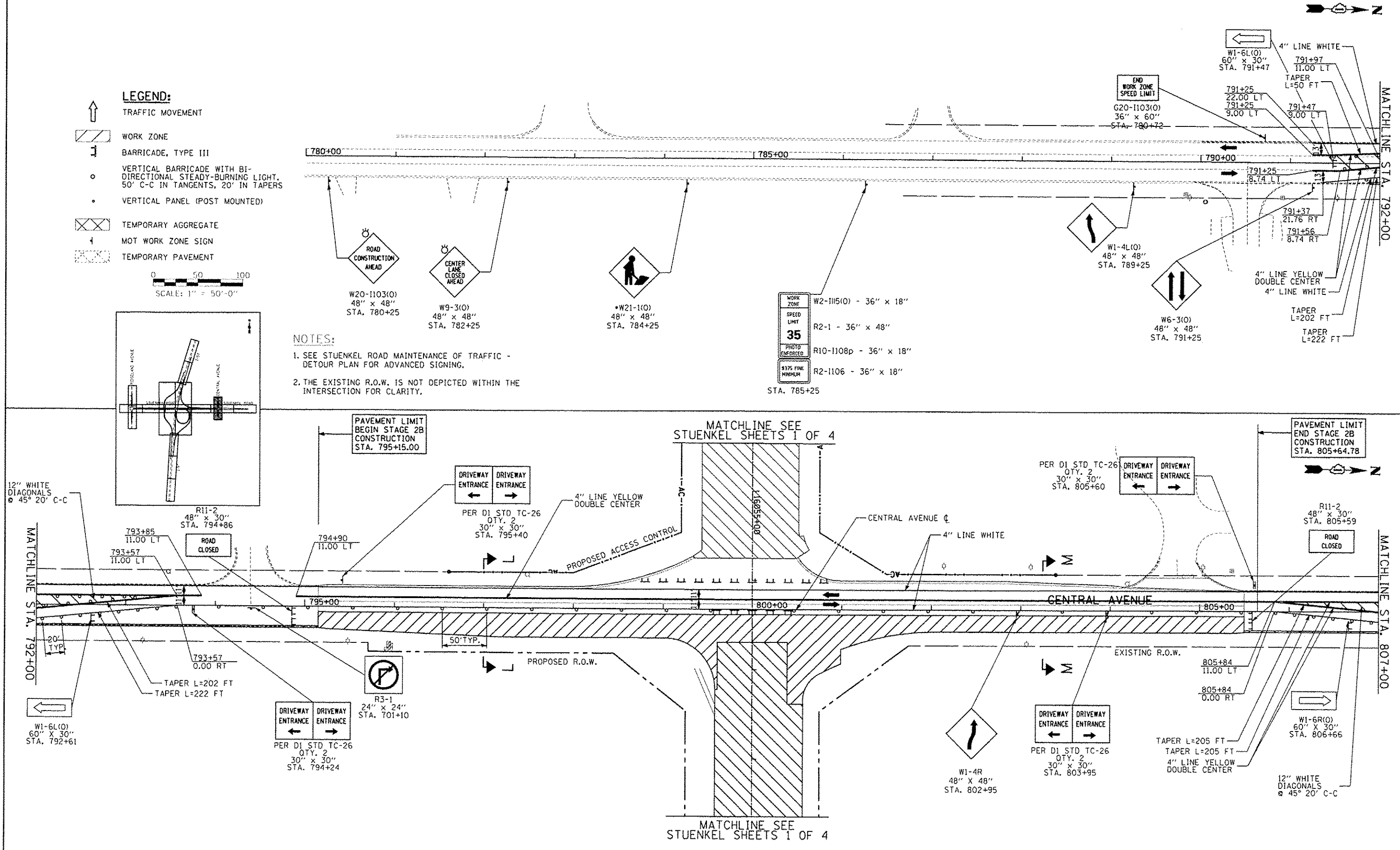

**TYLIN INTERNATIONAL**

USER NAME	DESIGNED - JTP	REVISED - 10/18/2013
PROJ. SCALE	DRAWN - JTP	REVISED - 12/04/2013
PROJ. DATE	CHECKED - JPM	REVISED -
	DATE - 05/10/2013	REVISED -

STATE OF ILLINOIS
DEPARTMENT OF TRANSPORTATION

**STATE OF ILLINOIS  
DEPARTMENT OF TRANSPORTATION**

**STUENKEL ROAD AT I-57 RIDGELAND AVENUE TO CENTRAL AVENUE  
MAINTENANCE OF TRAFFIC STAGE 2B - CENTRAL AVENUE**

F.A. RTE.	SECTION	COUNTY	TOTAL SHEETS	SHEET NO.
57	99-1HB-R1	WILL	679	119
CONTRACT NO. 60L69			ILLINOIS/FED. AID PROJECT	