







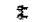

**LEGEND:**

-  TRAFFIC MOVEMENT
-  TEMPORARY CONCRETE BARRIER
-  TYPE III BARRICADE WITH FLASHING LIGHTS
-  PAVEMENT MARKING TAPE, TYPE III (SEE PLANS FOR LINE COLOR)
-  DRUM WITH STEADY BURN MONODIRECTIONAL LIGHT
-  VERTICAL PANEL (POST MOUNTED)
-  IMPACT ATTENUATORS, TEMPORARY (NON-REDIRECTIVE), TEST LEVEL 3
-  WORK ZONE AREA
-  TEMPORARY PAVEMENT

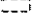
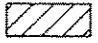

0 50 100  
SCALE: 1" = 50'-0"

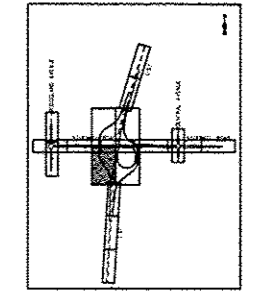
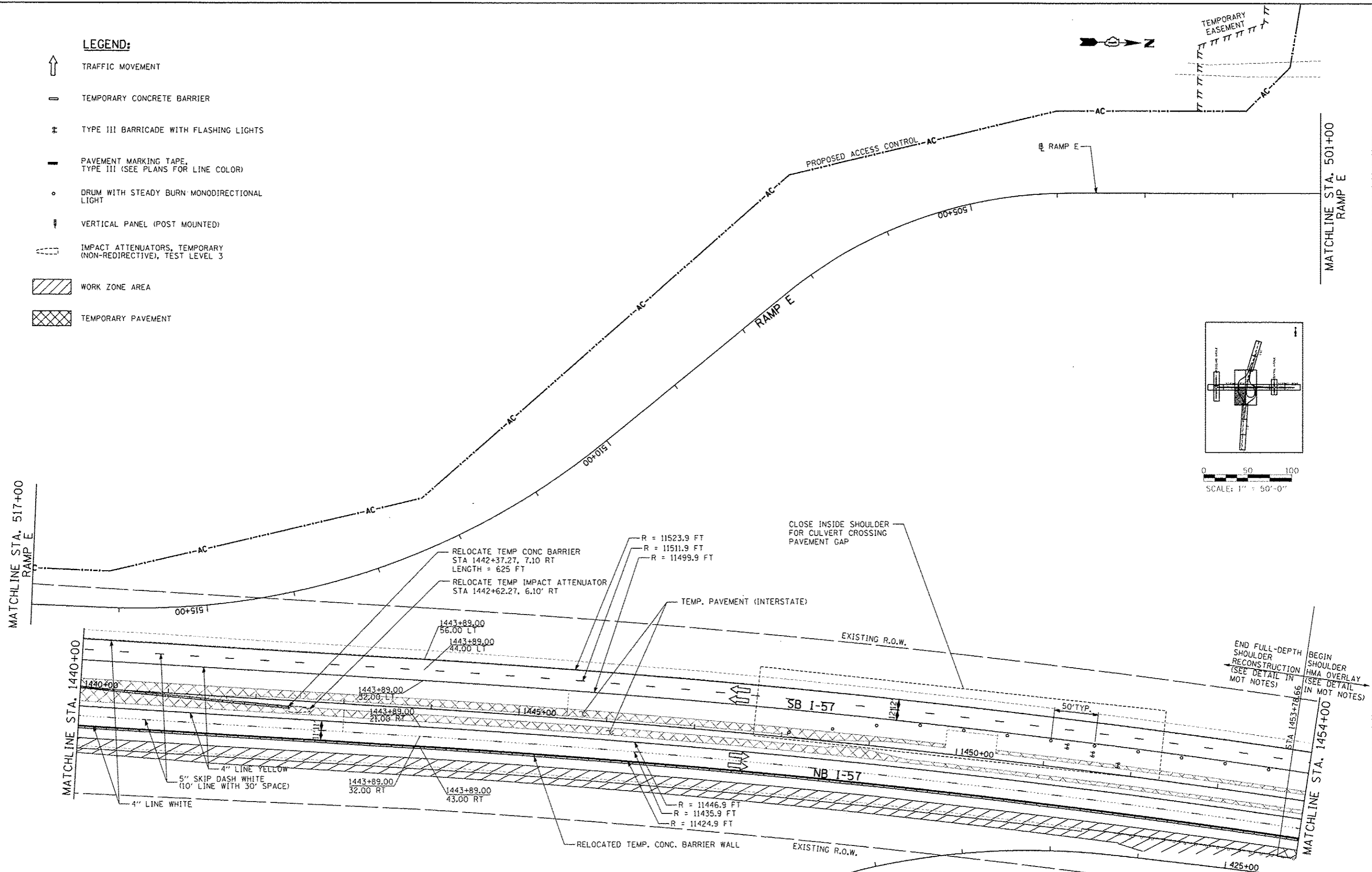
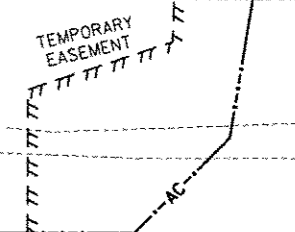
**TYLIN INTERNATIONAL**

USER NAME	DESIGNED - JTP	REVISED - 10/18/2013
PL01 SCALE	DRAWN - JTP	REVISED -
PL01 DATE	CHECKED - JPM	REVISED -
	DATE - 05/10/2013	REVISED -

**STATE OF ILLINOIS  
DEPARTMENT OF TRANSPORTATION**

**STUENKEL ROAD AT I-57 RIDGELAND AVENUE TO CENTRAL AVENUE  
MAINTENANCE OF TRAFFIC PLAN - I-57 PRE-STAGE 1B**

F.A.I. RTE.	SECTION	COUNTY	TOTAL SHEETS	SHEET NO.
57	99-1HB-R1	WILL	679	129
CONTRACT NO. 60L69			ILLINOIS FED. AID PROJECT	

SCALE: 1" = 50' SHEET 3 OF 6 SHEETS STA. 1440+00 TO STA. 1454+00