

MATCHLINE STA. 530+00
RAMP E

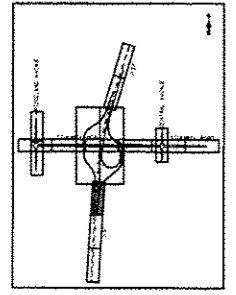
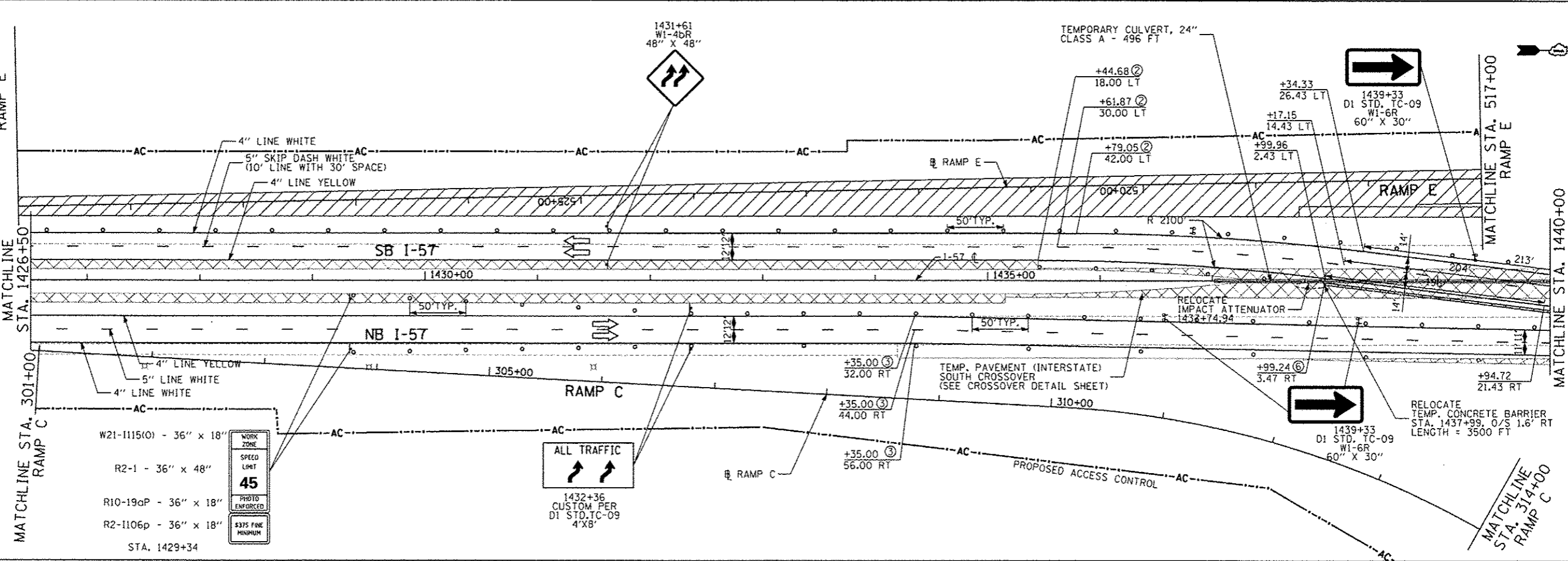

SCALE: 1" = 50'-0"

- ① BEGIN REVERSE CURVE OR WEAVE/ LANE WIDENING
- ② END REVERSE CURVE OR WEAVE/ LANE WIDENING
- ③ BEGIN REVERSE CURVE OR WEAVE/ LANE NARROWING
- ④ END REVERSE CURVE OR WEAVE/ LANE NARROWING
- ⑤ BEGIN GLARE SCREENS ON BARRIER
- ⑥ END GLARE SCREENS ON BARRIER

LEGEND:

- ↑ TRAFFIC MOVEMENT
- TEMPORARY CONCRETE BARRIER
- ⊕ TYPE III BARRICADE WITH FLASHING LIGHTS
- PAVEMENT MARKING TAPE, TYPE III (SEE PLANS FOR LINE COLOR)
- DRUM WITH STEADY BURN MONODIRECTIONAL LIGHT
- ↓ VERTICAL PANEL (POST MOUNTED)
- IMPACT ATTENUATORS, TEMPORARY (NON-REDIRECTIVE), TEST LEVEL 3
- ▨ WORK ZONE AREA
- ▩ TEMPORARY PAVEMENT
- HIGH TENSION CABLE MEDIAN BARRIER
- HIGH TENSION CABLE MEDIAN TERMINAL

TYLIN INTERNATIONAL	USER NAME	DESIGNED	JTP	REVISED	10/18/2013	STATE OF ILLINOIS DEPARTMENT OF TRANSPORTATION	STUENKEL ROAD AT I-57 RIDGELAND AVENUE TO CENTRAL AVENUE MAINTENANCE OF TRAFFIC PLAN - I-57 STAGE 1	F.A. RTE.	SECTION	COUNTY	TOTAL SHEETS	SHEET NO.
	PLT SCALE	DRAWN	JTP	REVISED	12/04/2013			57	99-INB-RI	WILL	679	134
	PLT DATE	CHECKED	JPM	REVISED				CONTRACT NO. 60L69		ILLINOIS FED. AID PROJECT		
		DATE	05/10/2013	REVISED				SCALE: 1" = 50'	SHEET 2 OF 6 SHEETS	STA. 1426+50 TO STA. 1440+00		