

LEGEND

- TT BARRICADE, TYPE III
- DETOUR ROUTE
- (X) SIGN PANEL / SIGN PANEL ASSEMBLY
- ⦿ AMBER BEACON

NOTES

SEE STANDARD TC-21 DETOUR SIGNING FOR ADDITIONAL DETAILS AND SPACING.

ALL RIDGELAND AVE. AND STUENKEL RD. DETOUR SIGNS ARE INCLUDED IN THE COST OF THE PAY ITEM - "DETOUR SIGNING"

DETOURS ARE PAID FOR AT THE CONTRACT LUMP SUM PRICE FOR "DETOUR SIGNING".

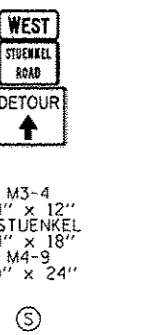
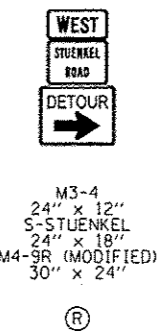
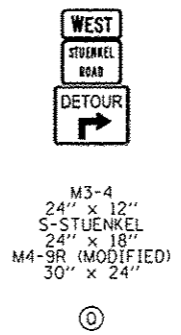
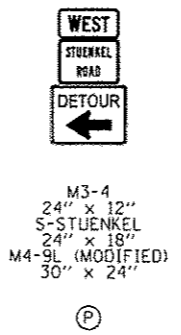
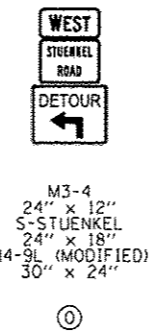
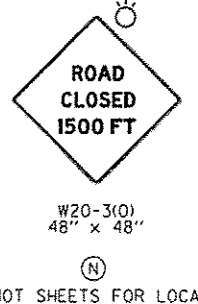
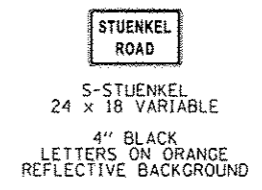
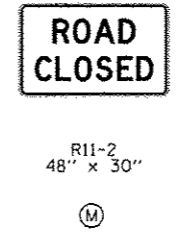
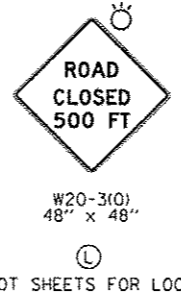
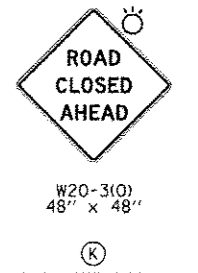
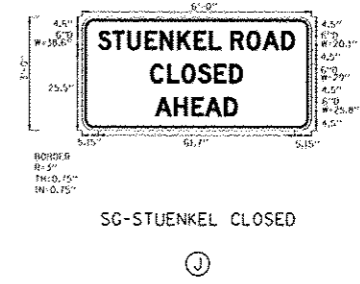
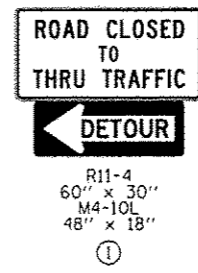
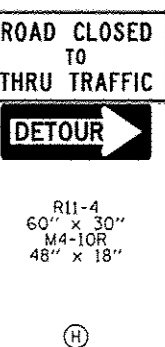
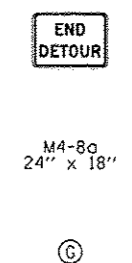
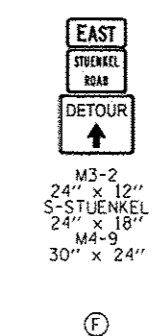
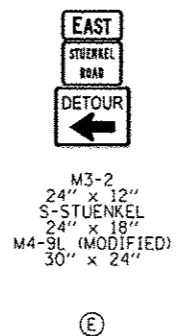
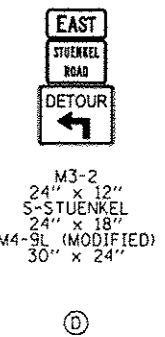
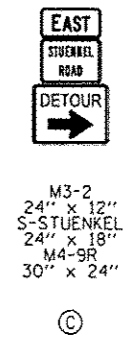
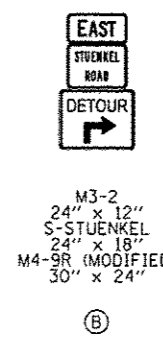

TYLIN INTERNATIONAL	USER NAME	DESIGNED - JTP	REVISED - 10/18/2013	STATE OF ILLINOIS DEPARTMENT OF TRANSPORTATION	STUENKEL ROAD AT I-57 RIDGELAND AVENUE TO CENTRAL AVENUE		F.A.I. RTE.	SECTION	COUNTY	TOTAL SHEETS	SHEET NO.
	PLT SCALE	DRAWN - JTP	REVISED - 12/04/2013		STUENKEL ROAD MOT - DETOUR PLAN		57	99-1H8-R1	WILL	679	140L
	PLT DATE	CHECKED - JPM	REVISED -		SCALE: N.T.S.	SHEET 1 OF 1 SHEETS	STA. TO STA.	ILLINOISIFIED AID PROJECT			