

DATE	
BY	
REVISED	
SURVEY	
NOTED	
NOTE BOOK	
AREAS CHECKED	

DATE	
BY	
REVISED	
SURVEY	
NOTED	
NOTE BOOK	
AREAS CHECKED	

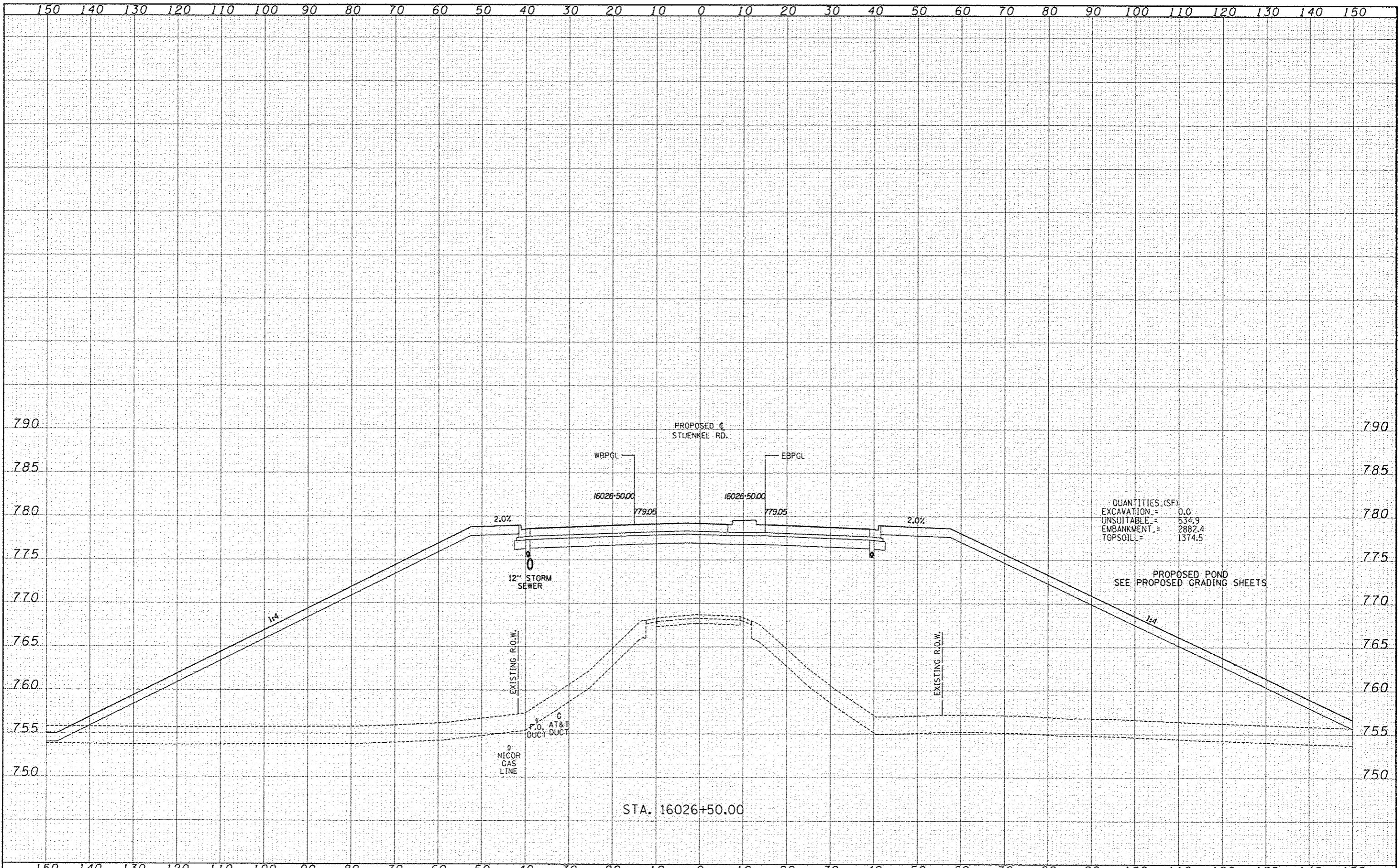

QUANTITIES (SF)
 EXCAVATION = 0.0
 UNSUITABLE = 534.9
 EMBANKMENT = 2882.4
 TOPSOIL = 1374.5

PROPOSED POND
 SEE PROPOSED GRADING SHEETS

STA. 16026+50.00

TYLINTERNATIONAL

USER NAME	DESIGNED	JDF	REVISED	
	DRAWN	JDF	REVISED	
PLT SCALE	CHECKED	JPM	REVISED	
PLT DATE	DATE	5/10/2013	REVISED	

STATE OF ILLINOIS
 DEPARTMENT OF TRANSPORTATION

I-57 AT STUENKEL ROAD (NEW INTERCHANGE)
 PROPOSED STUENKEL ROAD CROSS SECTIONS

F.A.I. RTE.	SECTION	COUNTY	TOTAL SHEETS	SHEET NO.
57	99-1HB-R1	WILL	679	445
			CONTRACT NO. 60L69	

SCALE: 1" = 10' SHEET NO. OF SHEETS STA. 16026+50.00 TO STA. 16026+50.00 FED. ROAD DIST. NO. ILLINOIS FED. AID PROJECT

P:\6026\1-57_0_3\stuenkel\11\road\16026+50.00\16026+50.00.dgn