

DATE	
BY	
DESIGNED	
DRAWN	
CHECKED	
DATE	
PROJECT	
SCALE	
SHEET NO.	
TOTAL SHEETS	

DATE	
BY	
DESIGNED	
DRAWN	
CHECKED	
DATE	
PROJECT	
SCALE	
SHEET NO.	
TOTAL SHEETS	

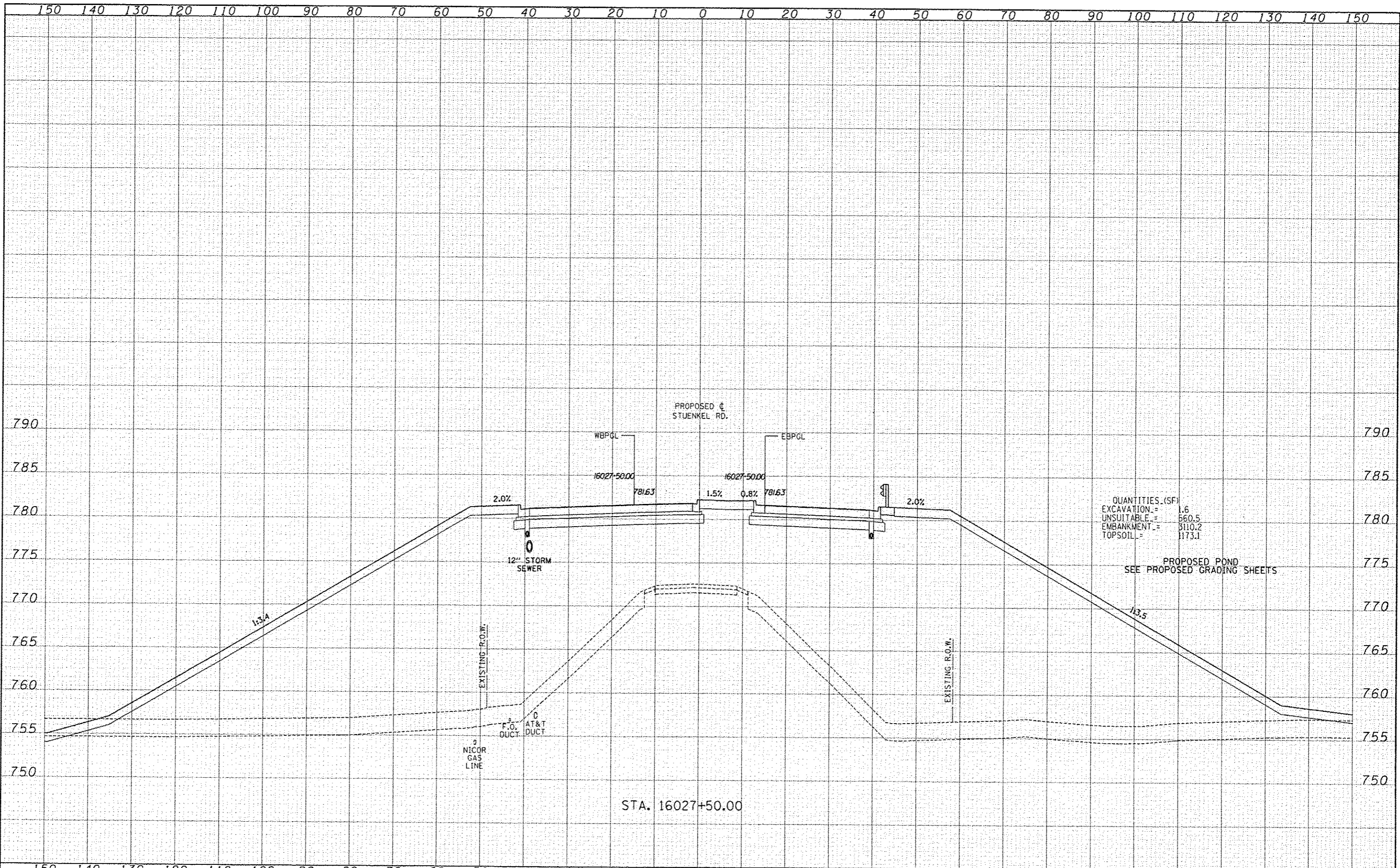

QUANTITIES (SF)
 EXCAVATION = 1.6
 UNSUITABLE = 560.5
 EMBANKMENT = 3110.2
 TOPSOIL = 1173.1

PROPOSED POND
 SEE PROPOSED GRADING SHEETS

STA. 16027+50.00

TYLIN INTERNATIONAL USER NAME: _____ PROJECT: _____ SHEET NO.: _____ TOTAL SHEETS: _____	DESIGNED: JDF DRAWN: JDF CHECKED: JPM DATE: 5/10/2013	REVISED: _____ REVISED: _____ REVISED: _____ REVISED: _____	STATE OF ILLINOIS DEPARTMENT OF TRANSPORTATION		I-57 AT STUENKEL ROAD (NEW INTERCHANGE) PROPOSED STUENKEL ROAD CROSS SECTIONS		F.A.I. RTE.: 57 SECTION: 99-IHB-RJ COUNTY: WILL CONTRACT NO.: 60L69	TOTAL SHEETS: 679 SHEET NO.: 447
	SCALE: 1" = 30' H SHEET NO. OF SHEETS: STA. 16027+50.00 TO STA. 16027+50.00			FED. ROAD DIST. NO.: ILLINOIS FED. AID PROJECT				

P:\6027\1270 57 @ Stuenkel\Road\M_3\Interchange\N_3 Stuenkel 50X5 5111.dgn