

DATE	
BY	
REVISED	
SURVEY	
PLANNING	
DESIGN	
CONSTRUCTION	
OPERATION	
MAINTENANCE	
REPAIRS	
REVISIONS	
NO.	

DATE	
BY	
REVISED	
SURVEY	
PLANNING	
DESIGN	
CONSTRUCTION	
OPERATION	
MAINTENANCE	
REPAIRS	
REVISIONS	
NO.	

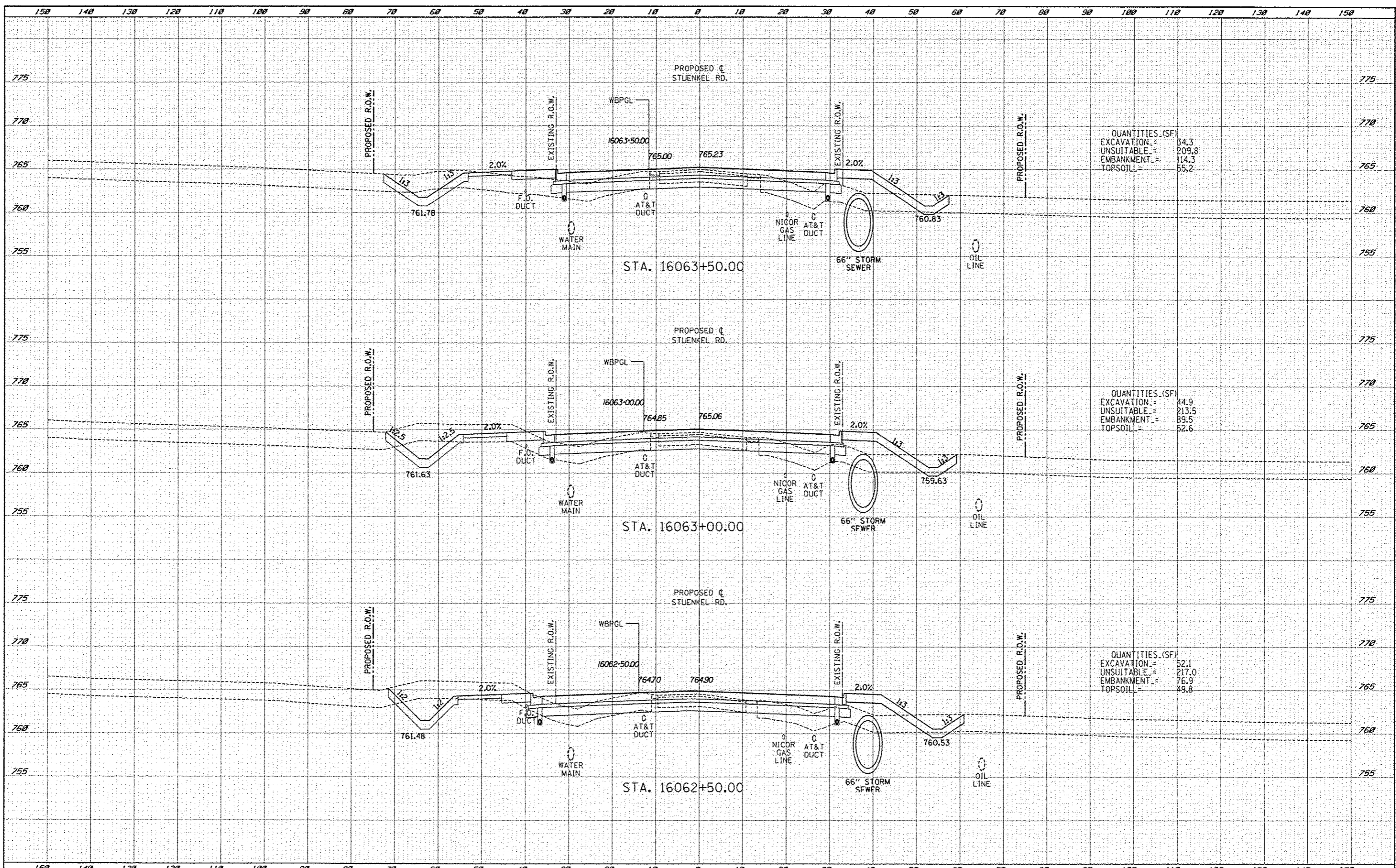

QUANTITIES (SF)

EXCAVATION	54.3
UNSUITABLE	209.8
EMBANKMENT	114.3
TOPSOIL	55.2

QUANTITIES (SF)

EXCAVATION	44.9
UNSUITABLE	213.5
EMBANKMENT	89.5
TOPSOIL	52.6

QUANTITIES (SF)

EXCAVATION	52.1
UNSUITABLE	217.0
EMBANKMENT	76.9
TOPSOIL	49.8

TYLIN INTERNATIONAL

USER NAME		DESIGNED	JDF	REVISED	10/18/13
PR. OF. DATE		DRAWN	JDF	REVISED	
		CHECKED	JPM	REVISED	
		DATE	5/10/2013	REVISED	

**STATE OF ILLINOIS
DEPARTMENT OF TRANSPORTATION**

I-57 AT STUENKEL ROAD (NEW INTERCHANGE) PROPOSED STUENKEL ROAD CROSS SECTIONS		F.A.I. R.T.E.	SECTION	COUNTY	TOTAL SHEETS	SHEET NO.
SCALE: 1" = 10'		57	99-1HB-R1	WILL	679	482
SHEET NO. OF SHEETS		STA. 16062+50.00 TO STA. 16063+50.00		CONTRACT NO. 60L69		
FED. ROAD DIST. NO.		ILLINOIS FED. AID PROJECT				

D:\6226120_57 @ Stuenkel\Road\NC3\Interchange\NC3_Stuenkel_58X5_S10.dgn