

DATE	
BY	
APPROVED	
SURVEY	
NOTE BOOK	
AREAS CHECKED	

DATE	
BY	
APPROVED	
SURVEY	
NOTE BOOK	
AREAS CHECKED	

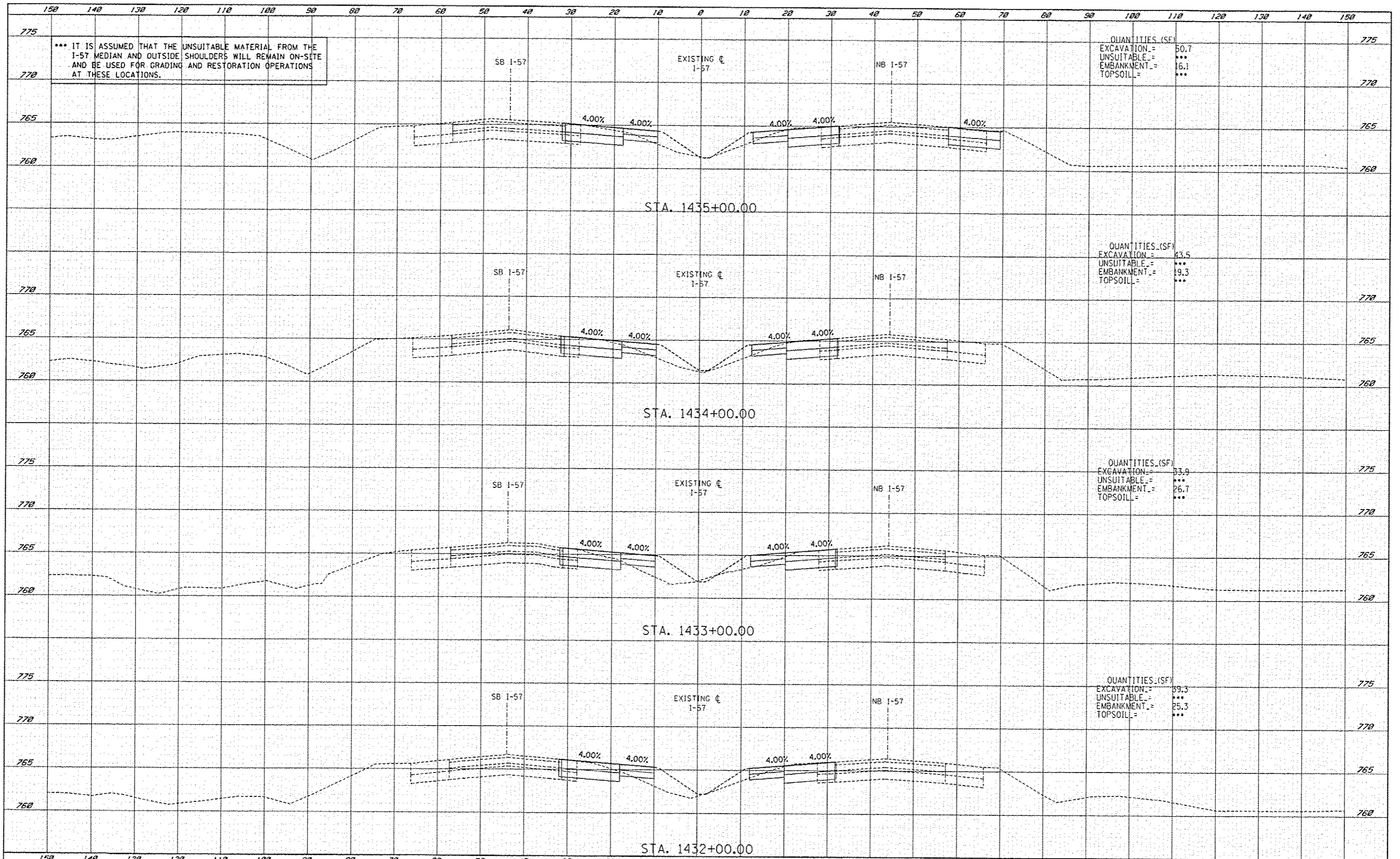

QUANTITIES (SF)
 EXCAVATION = 50.7
 UNSUITABLE = ***
 EMBANKMENT = 16.1
 TOPSOIL = ***

QUANTITIES (SF)
 EXCAVATION = 43.5
 UNSUITABLE = ***
 EMBANKMENT = 19.3
 TOPSOIL = ***

QUANTITIES (SF)
 EXCAVATION = 33.9
 UNSUITABLE = ***
 EMBANKMENT = 26.7
 TOPSOIL = ***

QUANTITIES (SF)
 EXCAVATION = 59.3
 UNSUITABLE = ***
 EMBANKMENT = 25.3
 TOPSOIL = ***

TYLIN INTERNATIONAL	USER NAME :	DESIGNED : JDF	REVISED Δ ADDENDUM 1 1/03/14	STATE OF ILLINOIS DEPARTMENT OF TRANSPORTATION	I-57 AT STUENKEL ROAD (NEW INTERCHANGE) I-57 MOT CROSS SECTIONS		F.A.I. RITE:	SECTION	COUNTY	TOTAL SHEETS	SHEET NO.
	PLOT SCALE :	DRAWN : JDF	REVISED		57	99-1MB-R1	WILL	679	613C		
	PLOT DATE :	CHECKED : JPM	REVISED		SCALE: 1" = 10' H 1" = 8' V	SHEET NO. OF SHEETS	STA. 1432+00.00 TO STA. 1435+00.00	FED. ROAD DIST. NO.	ILLINOIS FED. AID PROJECT	CONTRACT NO. 6069	
		DATE : 5/10/2013	REVISED								

P:\6022612(I-57_@_Stuenkel)\Road\3(Interchange)\C3.57.XS.SHT.dgn

