

LEGEND

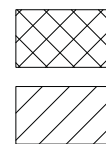

TEMPORARY PAVEMENT

CONSTRUCTION WORK ZONE



DIRECTION OF TRAFFIC FLOW



DRUM OR TYPE II BARRICADE WITH BI-DIRECTIONAL STEADY-BURN LIGHT IN 2-LANE SECTIONS
MONO-DIRECTIONAL STEADY BURN LIGHT IN MULTI-LANE SECTIONS (TYP.)



TYPE II DIRECTION INDICATOR BARRICADE WITH MONO-DIRECTIONAL STEADY BURN LIGHT



DOUBLE VERTICAL PANEL WITH BI-DIRECTIONAL STEADY-BURN LIGHT



TYPE III BARRICADE WITH FLASHING LIGHTS



FLASHING ARROW BOARD

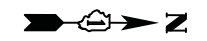

NOTES:

1. DRUMS OR TYPE II BARRICADES SHALL BE SPACED AT 50' C-C IN TANGENTS, 20' C-C IN TAPERS, AND 10' C-C IN RADII.

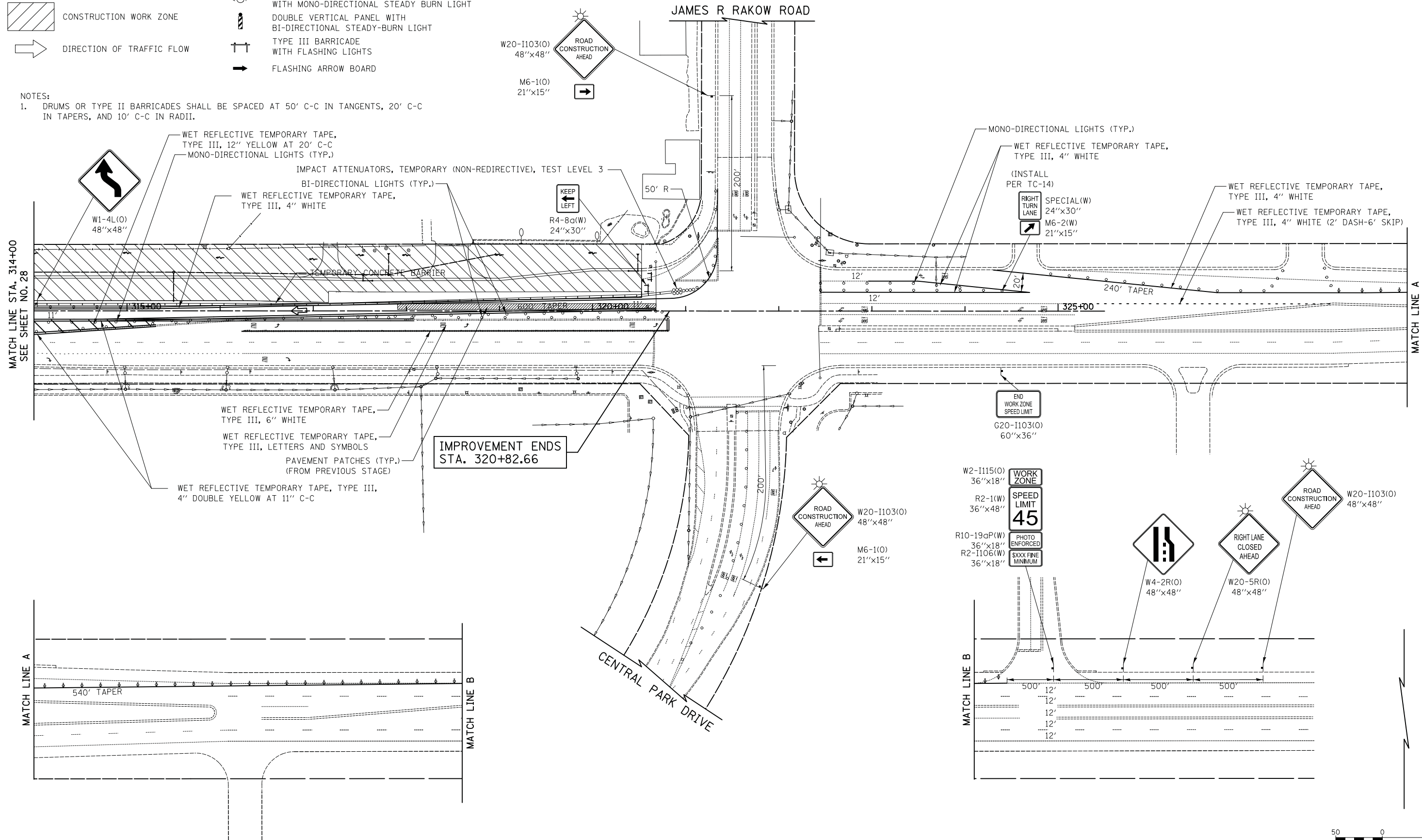

MATCH LINE STA. 314+00
SEE SHEET NO. 28

MATCH LINE A

MATCH LINE A

MATCH LINE B

MATCH LINE B

ILLINOIS ROUTE 31



FILE NAME = ...\\06-MOT\2278NG_MOT_S2_03.dgn

USER NAME = kwh

PLOT SCALE = 50.0000' / in.

PLOT DATE = 9/6/2013

DESIGNED - KWH

DRAWN - PML

CHECKED - GAB

DATE - 06/24/2013

REVISED -

REVISED -

REVISED -

REVISED -

**STATE OF ILLINOIS
DEPARTMENT OF TRANSPORTATION**

MAINTENANCE OF TRAFFIC - STAGE 2A & B

SCALE: 1" = 50'

SHEET NO. 10 OF 13 SHEETS

STA. 314+00 TO STA. 320+82.66

F.A.P. RTE. SECTION COUNTY TOTAL SHEETS SHEET NO.

3887 18W&RS-5 (12) MCHENRY 151 29

CONTRACT NO. 60V72

FED. ROAD DIST. NO. 1 ILLINOIS FED. AID PROJECT