

PROFILE SURVEYED _____ DATE _____
 NOTE BOOK _____
 NO. _____
 GRADES CHECKED _____
 STRUCTURE NOTATIONS OKWD
 PLAN SURVEYED _____ DATE _____
 NOTE BOOK _____
 NO. _____
 ALIGNMENT CHECKED _____
 RT. OF WAY CHECKED _____
 CAD FILE NAME _____
CHRISTOPHER B. BURKE ENGINEERING LTD.
 9575 West Higgins Road, Suite 600
 Rosemont, Illinois 60018
 (647) 923-5930

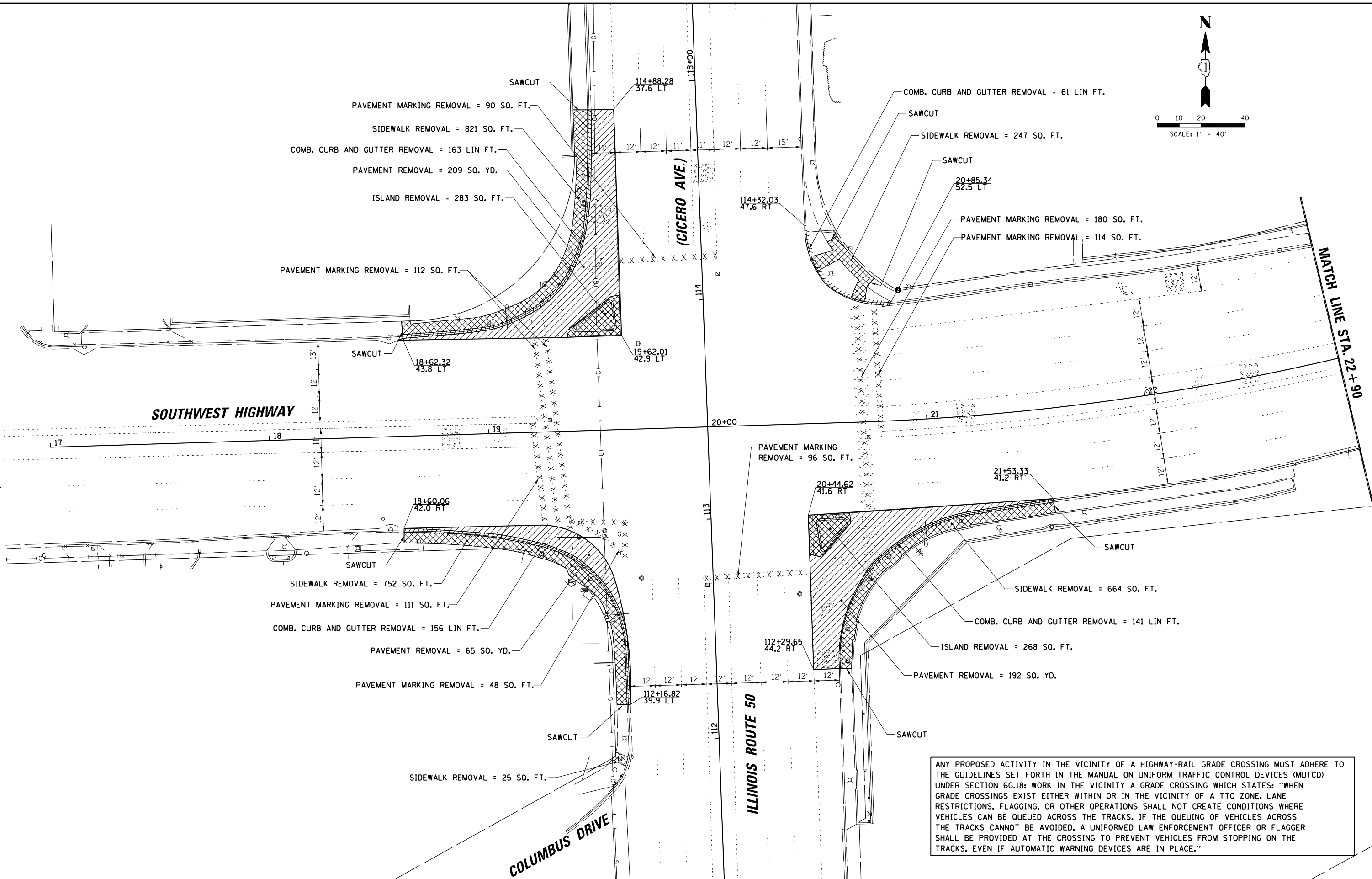
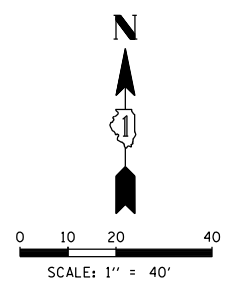

ANY PROPOSED ACTIVITY IN THE VICINITY OF A HIGHWAY-RAIL GRADE CROSSING MUST ADHERE TO THE GUIDELINES SET FORTH IN THE MANUAL ON UNIFORM TRAFFIC CONTROL DEVICES (MUTCD) UNDER SECTION 6C.18: WORK IN THE VICINITY A GRADE CROSSING WHICH STATES: "WHEN GRADE CROSSINGS EXIST EITHER WITHIN OR IN THE VICINITY OF A TTC ZONE, LANE RESTRICTIONS, FLAGGING, OR OTHER OPERATIONS SHALL NOT CREATE CONDITIONS WHERE VEHICLES CAN BE QUEUED ACROSS THE TRACKS. IF THE QUEUING OF VEHICLES ACROSS THE TRACKS CANNOT BE AVOIDED, A UNIFORMED LAW ENFORCEMENT OFFICER OR FLAGGER SHALL BE PROVIDED AT THE CROSSING TO PREVENT VEHICLES FROM STOPPING ON THE TRACKS, EVEN IF AUTOMATIC WARNING DEVICES ARE IN PLACE."

FILE NAME =	USER NAME = ejensen	DESIGNED - LJ	REVISED -
N:\dot\130116\Work Order 13018 - IL585W	Wg\Traffic\REM_IL50-Swhg_01.sht	DRAWN - FPB / FCP	REVISED -
	PLOT SCALE = 48"	CHECKED - GMZ	REVISED -
	PLOT DATE = 12/11/2013	DATE -	REVISED -

STATE OF ILLINOIS
DEPARTMENT OF TRANSPORTATION

REMOVAL PLAN (SHEET 1 OF 2)
ILLINOIS ROUTE 50 (CICERO AVE.) AND SOUTHWEST HIGHWAY
 SCALE: _____ SHEET NO. _____ OF _____ SHEETS _____ STA. _____ TO STA. _____

F.A.P. RTE.	SECTION	COUNTY	TOTAL SHEETS	SHEET NO.
350	461TS-2(13)	COOK	42	11
FED. ROAD DIST. NO.			ILLINOIS FED. AID PROJECT	
CONTRACT NO. 60X25				