

DATE: _____ BY: _____
 SURVEYED: _____ ALIGNED: _____
 PLAN: _____ NOTE BOOK: _____
 NO. _____
 ENGINEERING LTD.
CHRISTOPHER B. BURKE
 8575 West Higgins Road, Suite 600
 Rosemont, Illinois 60018
 (617) 923-5500
 DATE: _____ BY: _____
 SURVEYED: _____ GRADES CHECKED: _____
 PROFILE: _____ ELEM. NOTED: _____
 NO. _____ STRUCTURE NOTATIONS: OKWD

HORIZONTAL CONTROL					
POINT	NORTHING	EASTING	STATION	OFFSET	TYPE
CP 3501	1,842,589.88	1,146,269.83	114+37.48	305.18 RT	
CP 3650	1,842,401.64	1,146,038.73	112+57.80	67.36 RT	X-CUT
CP 3652	1,842,532.32	1,145,825.55	113+96.17	140.9 LT	X-CUT

PROP. CURVE 1
 PI STA. = 21+91.68
 $\Delta = 12^\circ 51' 03''$ (LT)
 $R = 5^\circ 06' 57''$
 $R = 1,120.00'$
 $T = 126.13'$
 $L = 251.20'$
 $E = 7.08'$
 $e = N/A$
 $T.R. = N/A$
 $S.E. RUN = N/A$
 $P.C. STA = 20+65.55$
 $P.T. STA = 23+16.75$

ANY PROPOSED ACTIVITY IN THE VICINITY OF A HIGHWAY-RAIL GRADE CROSSING MUST ADHERE TO THE GUIDELINES SET FORTH IN THE MANUAL ON UNIFORM TRAFFIC CONTROL DEVICES (MUTCD) UNDER SECTION 6G.18; WORK IN THE VICINITY A GRADE CROSSING WHICH STATES: "WHEN GRADE CROSSINGS EXIST EITHER WITHIN OR IN THE VICINITY OF A TTC ZONE, LANE RESTRICTIONS, FLAGGING, OR OTHER OPERATIONS SHALL NOT CREATE CONDITIONS WHERE VEHICLES CAN BE QUEUED ACROSS THE TRACKS. IF THE QUEUING OF VEHICLES ACROSS THE TRACKS CANNOT BE AVOIDED, A UNIFORMED LAW ENFORCEMENT OFFICER OR FLAGGER SHALL BE PROVIDED AT THE CROSSING TO PREVENT VEHICLES FROM STOPPING ON THE TRACKS, EVEN IF AUTOMATIC WARNING DEVICES ARE IN PLACE."

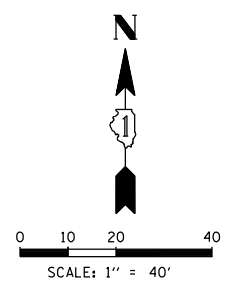
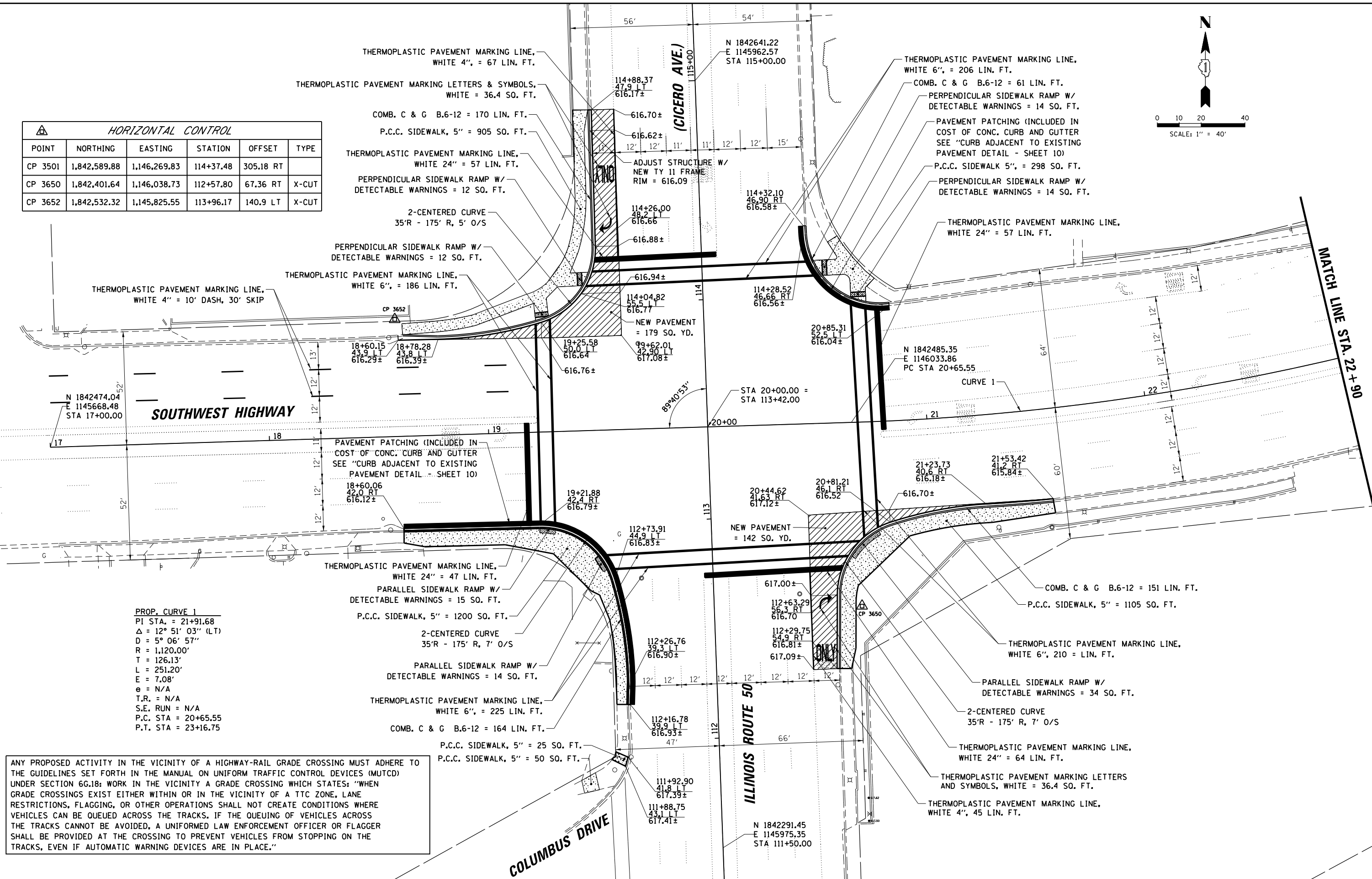

FILE NAME = N:\dot\130116\Work Order 13018 - IL585M\Traffic\RDWY-MOD_IL50-Swhy_01.sht	USER NAME = fbariso	DESIGNED - LJ	REVISED -	STATE OF ILLINOIS DEPARTMENT OF TRANSPORTATION	ROADWAY AND SIDEWALK MODIFICATION PLAN (SHEET 1 OF 2) ILLINOIS ROUTE 50 (CICERO AVE.) AND SOUTHWEST HIGHWAY	F.A.P. RTE. = 350	SECTION = 461TS-2(13)	COUNTY = COOK	TOTAL SHEETS = 42	SHEET NO. = 13		
PLOT SCALE = 48'	CHECKED - GMZ	REVISIED -	SCALE: _____			SHEET NO. _____	OF SHEETS _____	STA. _____	TO STA. _____	CONTRACT NO. 60X25		
PLOT DATE = 1/22/2014	DATE -	REVISIED -	FED. ROAD DIST. NO. _____ ILLINOIS FED. AID PROJECT _____									