

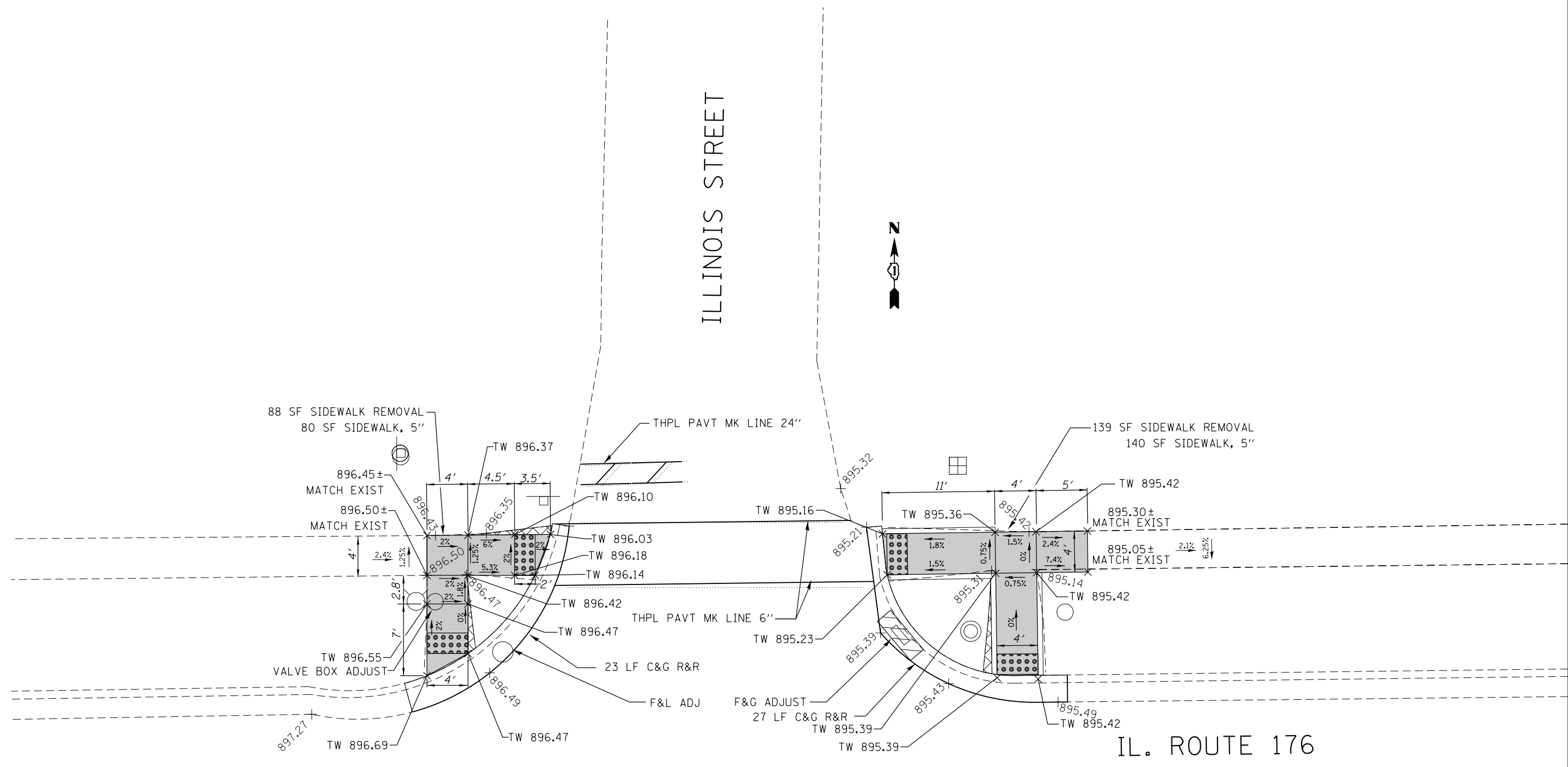

ILLINOIS STREET

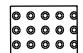

**LEGEND**

-  DETECTABLE WARNINGS
-  SIDEWALK REMOVAL, REPLACE W/ TOP SOIL & SOD
-  CLASS D PATCH
- TW TOP OF WALK PROPOSED ELEVATION

REF: BM ELEV. 898.68  
 "X" CUT IN WEST BOLT OF FIRE HYDRANT IN NORTH WEST CORNER OF IL 176 AND ILLINOIS ST.

FILE NAME = c:\pwork\pwork\pencepl\d0362927\0107	USER NAME = PencePL 14-sh1-CrystalLake.dgn	DESIGNED - DRAWN -	REVISED - PLP 01/16/2014 REVISED - REVISED - REVISED -	<b>STATE OF ILLINOIS DEPARTMENT OF TRANSPORTATION</b>	<b>ROADWAY PLAN - IL 176 (US 14 TO IL 31) AT ILLINOIS ST (NORTH)</b>			F.A. RTE.	SECTION	COUNTY	TOTAL SHEETS	SHEET NO.
Default	PLOT SCALE = 10.0000' / in. PLOT DATE = 1/22/2014	CHECKED - DATE -	DATE -					VAR	2013-0581	MCHENRY	58	17
				SCALE: 1:5		SHEET OF SHEETS		STA. TO STA.		ILLINOIS FED. AID PROJECT		