

PLAN	SURVEYED	DATE
	PLOTTED	
	GRADES CHECKED	
	BY	
	NOTE BOOK NO.	
	FILE NAME	

PROFILE	SURVEYED	DATE
	PLOTTED	
	GRADES CHECKED	
	BY	
	NOTE BOOK NO.	
	FILE NAME	

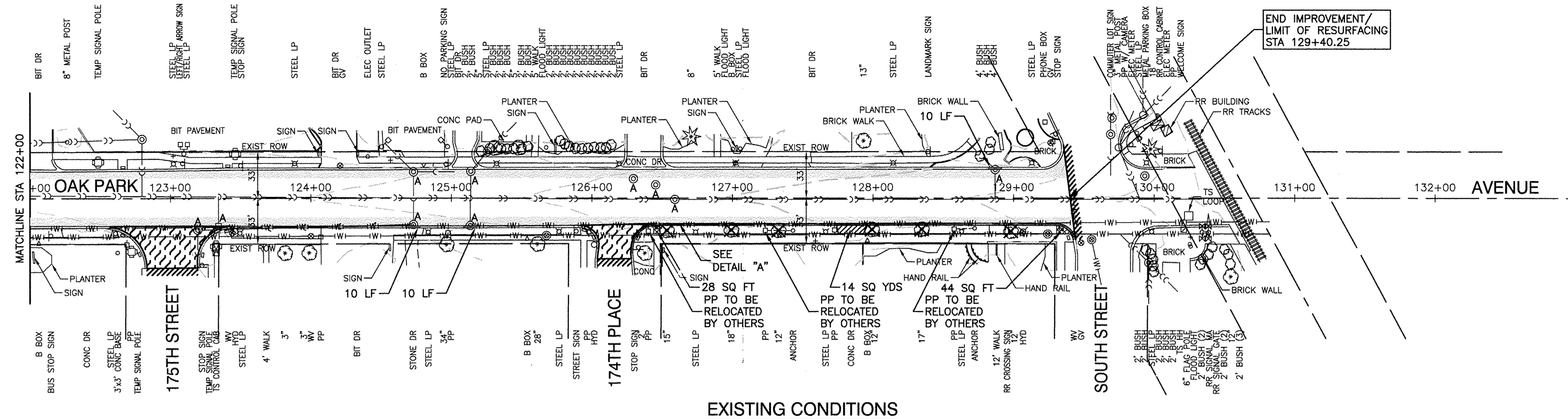

EXISTING CONDITIONS

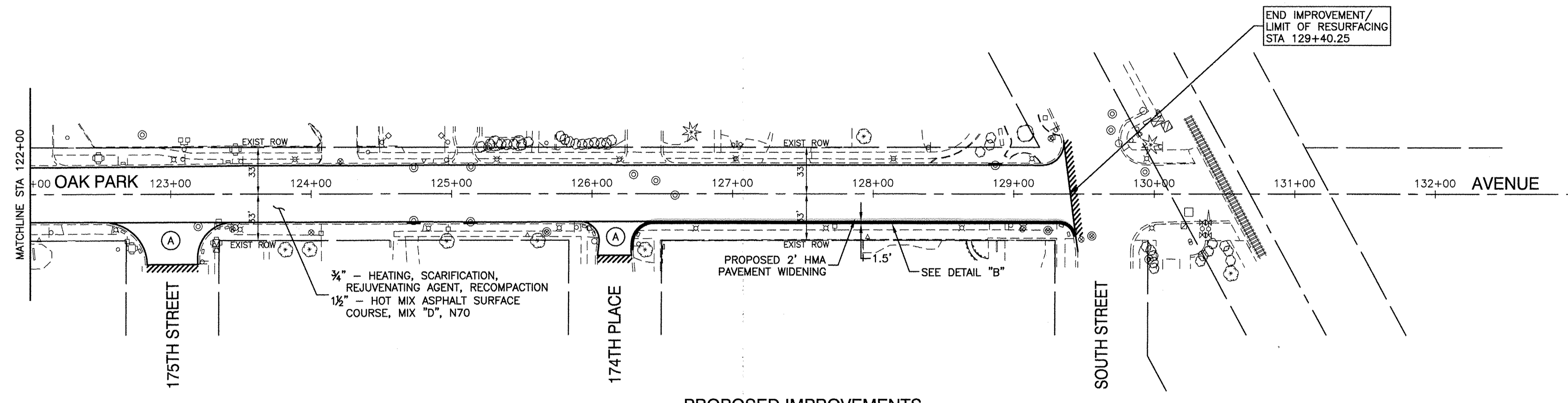

PROPOSED IMPROVEMENTS

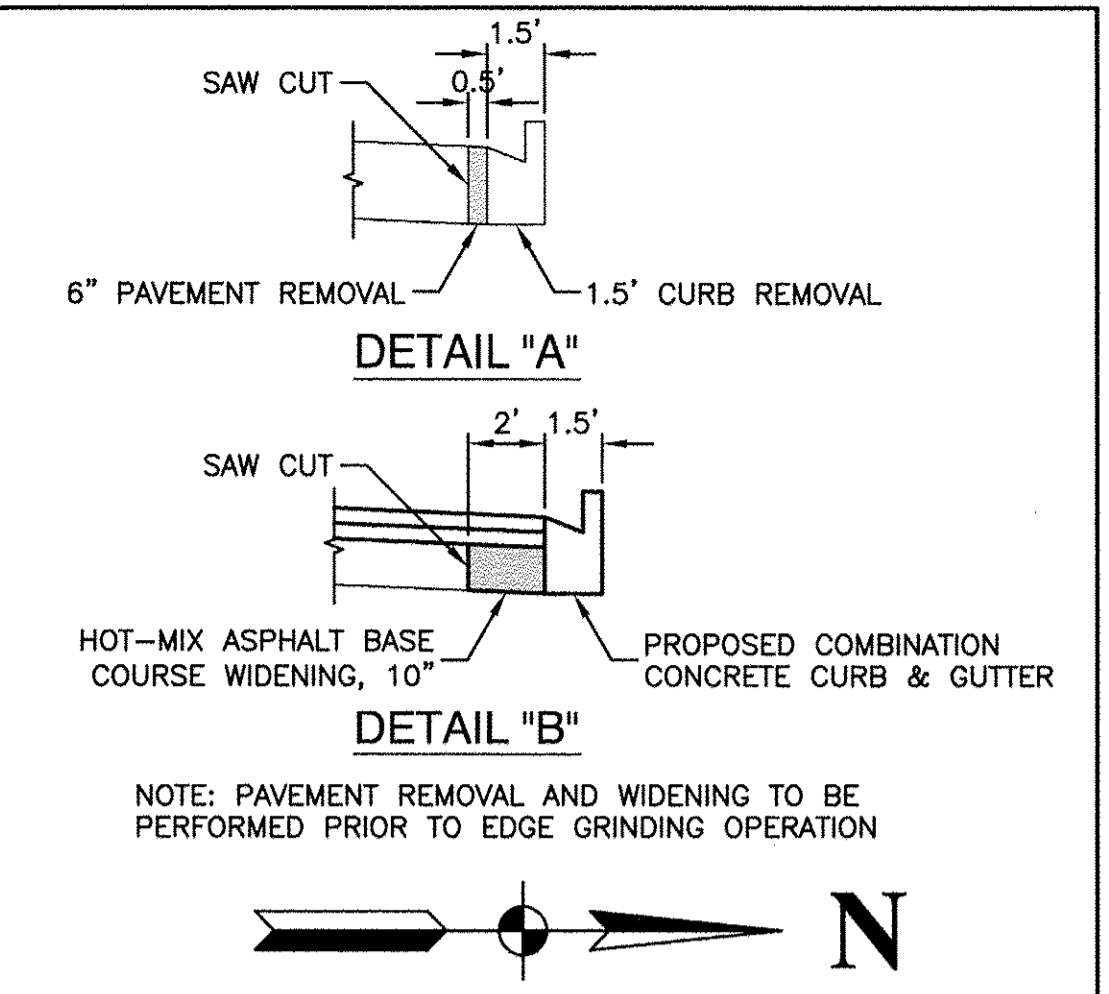

NOTE: PAVEMENT REMOVAL AND WIDENING TO BE PERFORMED PRIOR TO EDGE GRINDING OPERATION

- LEGEND**
- CONCRETE SIDEWALK REMOVAL
 - HOT-MIX ASPHALT SURFACE REMOVAL, SPECIAL
 - DRIVEWAY PAVEMENT REMOVAL
 - HOT-MIX ASPHALT SURFACE REMOVAL, 2"
 - HOT-MIX ASPHALT SURFACE REMOVAL, BUTT JOINT
 - CURB REMOVAL
 - COMBINATION CONCRETE CURB AND GUTTER REPLACEMENT
 - STRUCTURE TO BE ADJUSTED
 - STRUCTURE TO BE RECONSTRUCTED
 - EXISTING TREE REMOVAL
 - HOT-MIX ASPHALT MULTI-USE PATH
-AGGREGATE BASE COURSE, TYPE B, 6"
-HOT-MIX ASPHALT SURFACE COURSE, IL-9.5, MIX "D", N50, 2"
 - HOT-MIX ASPHALT SURFACE COURSE, IL-9.5, MIX "D", N70, 1 1/2"
LEVELING BINDER (MACHINE METHOD), N70, 3/4"
 - P.C.C. SIDEWALK, 5"
 - DETECTABLE WARNINGS

FILE NAME = 13308-PLPR-01 - IDOT PLPR06

USER NAME =	DESIGNED - JPH	REVISED -
	CHECKED - PKB	REVISED -
PLOT SCALE =	DRAWN - RG	REVISED -
PLOT DATE = 12-02-13	CHECKED - AG	REVISED -

STATE OF ILLINOIS
DEPARTMENT OF TRANSPORTATION

OAK PARK AVENUE
ROADWAY IMPROVEMENTS
PLAN & PROFILE

SCALE: H 1"=50' V 1"=5'
SHEET NO. 10 OF 35 SHEETS
STA. TO STA.

F.A.U. RTE. 2774	SECTION 13-00115-00-RS	COUNTY COOK	TOTAL SHEETS 35	SHEET NO. 10
FED. ROAD DIST. NO. 1		ILLINOIS		FED. AID PROJECT CMM-4003 (249)
CONTRACT NO. 61A01				