

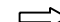





**LEGEND**

-  CONSTRUCTION ZONE THIS STAGE
-  DIRECTION OF TRAVEL
-  TEMPORARY PAVEMENT (SEE TYPICAL SECTION FOR WIDENING)
-  BARRICADE, TYPE III
-  DRUM WITH STEADY BI-DIRECTIONAL BURNING LIGHT
-  ARROW BOARD
-  DIRECTION INDICATOR BARRICADE
-  VERTICAL PANEL

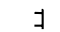

USE STANDARD 701701 & 701201 TO CONSTRUCT CORNER ISLANDS

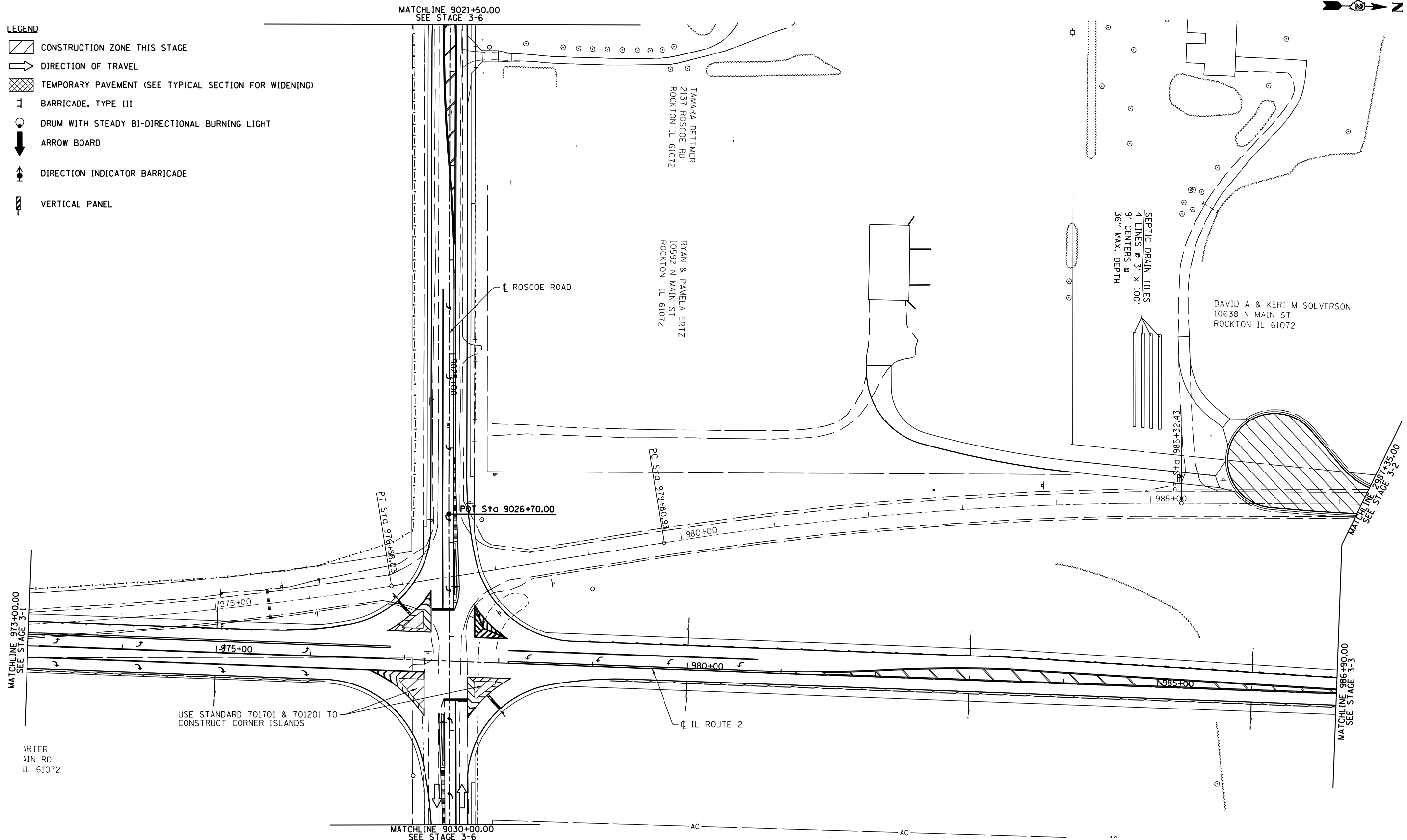
ARTERIAL ROAD  
IL 61072

NOTE: NO DROP-OFF GREATER THAN 12" SHALL BE WITHIN 3' OF TRAFFIC FOR GREATER THAN 48 HOURS. IF THE DROP-OFF IS NOT CORRECTED IN THE TIME-FRAME, SAID AREA SHALL BE PROTECTED WITH BARRIER WALL AND IMPACT ATTENUATORS, APPROVED BY IDOT AT NO ADDITIONAL COST TO IDOT.

FILE NAME =	USER NAME =	DESIGNED - RDT	REVISED -	<b>STATE OF ILLINOIS DEPARTMENT OF TRANSPORTATION</b>	<b>ILLINOIS ROUTE 2 STAGE 3</b>			F.A.P. RTE.	SECTION	COUNTY	TOTAL SHEETS	SHEET NO.
et:\pwork\pwork\undbladerr\d0331856	0264H70-sh-t-staging03-02.dgn	DRAWN - RDT	REVISED -		734	77R-1	WINNEBAGO	179	64			
	PLOT SCALE =	CHECKED - JAC	REVISED -		CONTRACT NO. 64H70			ILLINOIS FED. AID PROJECT				
	PLOT DATE =	DATE - 10/05/2012	REVISED -		SCALE: 1"=50'	SHEET NO. 64 OF 179 SHEETS	STA. 973+00	TO STA. 986+90				