

*a14 bars in skew portion of slab shall be ordered full length & cut to fit. Balance of bar to be used in opposite end of culvert.

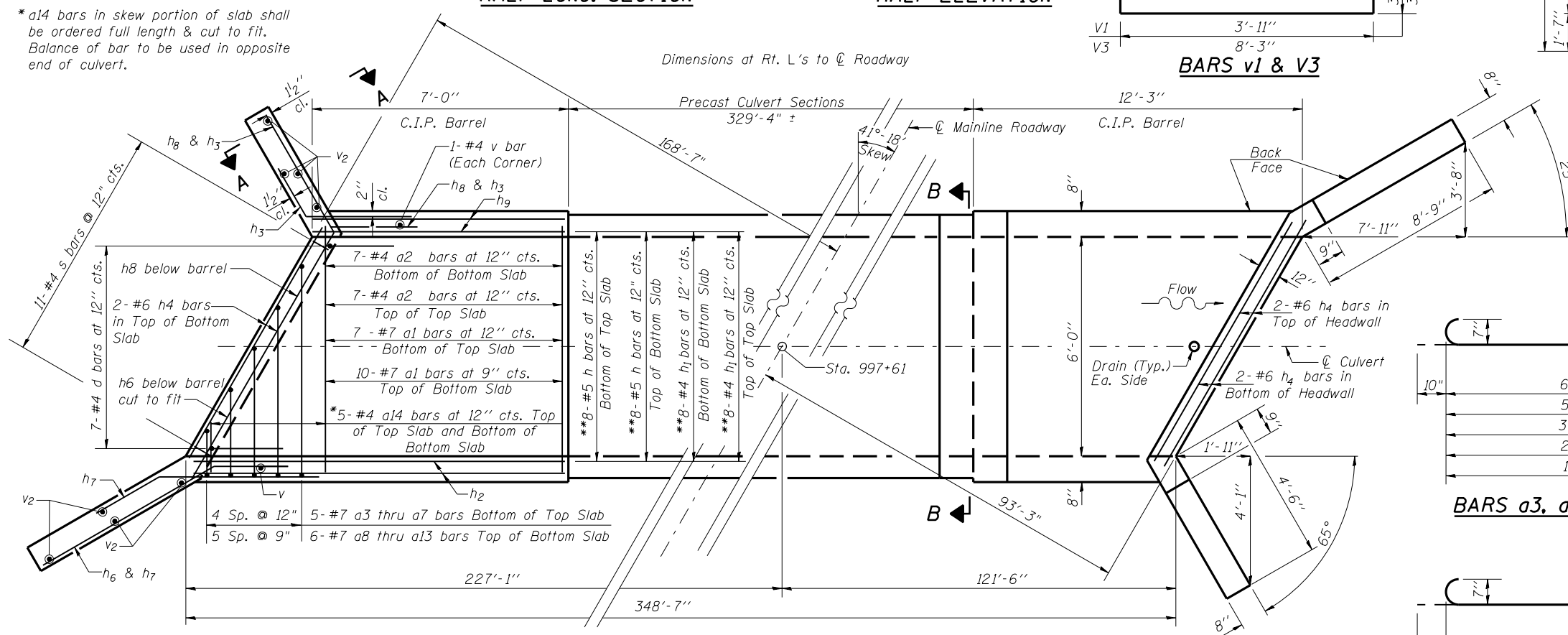

NOTES

A distance of half the length of the wingwall but not less than six feet of the barrel shall be poured monolithically with the wingwalls.
 Reinforcement Bars shall conform to the requirements of ASTM A706 Grade 60.
 All construction joints shall be bonded.
 See next Sheet for Sections A-A and B-B and drain details.

**h and h1 bars in skew portion of slab shall be ordered full length and cut to fit. Balance of bar to be used in opposite end of culvert.

BILL OF MATERIAL

Bar	No.	Size	Length	Shape
a1	34	#7	8'-10"	[Symbol]
a2	34	#4	7'-1"	[Symbol]
a3	2	#7	8'-2"	[Symbol]
a4	2	#7	7'-0"	[Symbol]
a5	2	#7	5'-10"	[Symbol]
a6	2	#7	4'-9"	[Symbol]
a7	2	#7	3'-7"	[Symbol]
a8	2	#7	7'-7"	[Symbol]
a9	2	#7	6'-8"	[Symbol]
a10	2	#7	5'-10"	[Symbol]
a11	2	#7	5'-0"	[Symbol]
a12	2	#7	4'-2"	[Symbol]
a13	2	#7	3'-3"	[Symbol]
a14	10	#4	7'-9"	[Symbol]
d	14	#4	4'-6"	[Symbol]
h	16	#5	18'-9"	[Symbol]
h1	16	#4	18'-9"	[Symbol]
h2	16	#5	12'-0"	[Symbol]
h3	12	#4	8'-0"	[Symbol]
h4	12	#6	7'-6"	[Symbol]
h5	60	#4	1'-0"	[Symbol]
h6	14	#6	11'-9"	[Symbol]
h7	12	#6	8'-0"	[Symbol]
h8	14	#4	7'-6"	[Symbol]
h9	16	#5	6'-9"	[Symbol]
s	22	#4	4'-7"	[Symbol]
v	46	#4	3'-11"	[Symbol]
v1	54	#5	9'-11"	[Symbol]
v2	16	#4	7'-1"	[Symbol]
v3	12	#4	15'-7"	[Symbol]
Concrete Box Culverts		Cu. Yd.	16.6	
Reinforcement Bars		Pound	3600	