

TEMPORARY WATER FILLED BARRIER LAYOUT – STAGE I

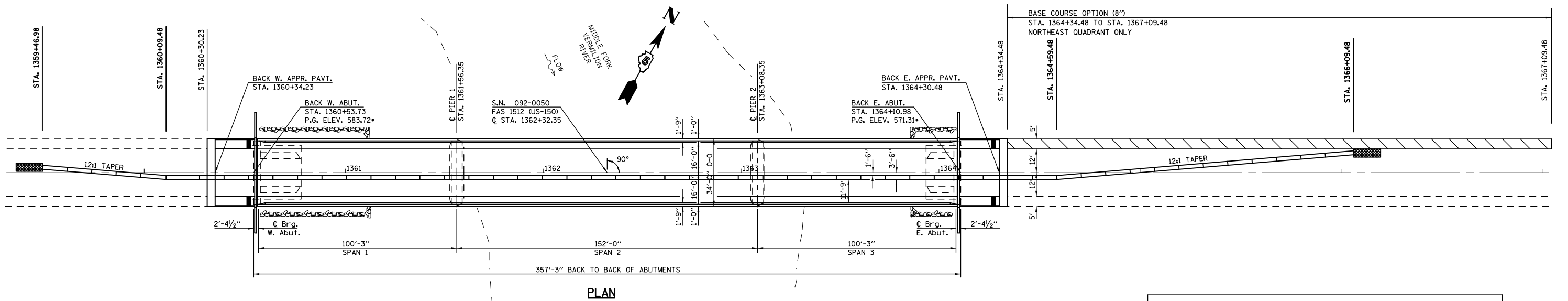

PLAN

NOTES:

THE FINAL LOCATION OF ALL TRAFFIC CONTROL ITEMS SHALL BE VERIFIED BY THE ENGINEER.

REFER TO HIGHWAY STANDARD 701321 FOR ADDITIONAL STAGING DETAILS.

SEE SPECIAL PROVISIONS FOR ADDITIONAL DETAILS ASSOCIATED WITH TEMPORARY WATER FILLED BARRIER.

THE CONTRACTOR SHALL PROVIDE AND MAINTAIN ACCESS TO COMMERCIAL AND PRIVATE PROPERTIES ABUTTING THE HIGHWAY IN ACCORDANCE WITH ARTICLE 107.09 OF THE STANDARD SPECIFICATIONS.

REFLECTORS AND VERTICAL PANELS AT 25' CTS. FOR BARRIER, BRIDGE RAIL AND GUARDRAIL SHALL BE INCLUDED IN THE COST FOR TRAFFIC CONTROL AND PROTECTION STANDARD 701321.

EXISTING OR TEMPORARY PAVEMENT MARKINGS SHALL BE ON BOTH SIDES OF THE OPEN LANE FROM STOP BAR TO STOP BAR. PAVEMENT MARKINGS THAT CONFLICT WITH STAGED TRAFFIC MARKINGS SHALL BE REMOVED. REMOVAL OF EXISTING AND TEMPORARY PAVEMENT MARKINGS AND PLACEMENT OF TEMPORARY PAVEMENT MARKINGS SHALL BE INCLUDED IN THE COST FOR TRAFFIC CONTROL AND PROTECTION STANDARD 701321.

PRIOR TO ROUTING TRAFFIC ONTO THE SHOULDERS AS SHOWN IN THE STAGING PLANS, THE CONTRACTOR SHALL SECURE THE GRATINGS ON SHOULDER INLETS AS DIRECTED BY THE ENGINEER. THIS WORK SHALL BE PAID FOR ACCORDING TO ARTICLE 109.04 OF THE STANDARD SPECIFICATIONS.

SYMBOLS	
	TEMPORARY WATER FILLED BARRIER
	IMPACT ATTENUATOR
	BASE COURSE (OPTION)

SCHEDULE FOR BASE COURSE (OPTION)*	
STA. 1364+34.48 TO 1367+09.48 LT.	153.0 SQ YD
TOTAL: 153.0 SQ YD	

* EXCAVATION REQUIRED TO PLACE BASE COURSE SHALL BE INCLUDED WITH THE COST OF THE BASE COURSE (OPTION). SEE SPECIAL PROVISIONS

TEMPORARY WATER FILLED BARRIER LAYOUT – STAGE II

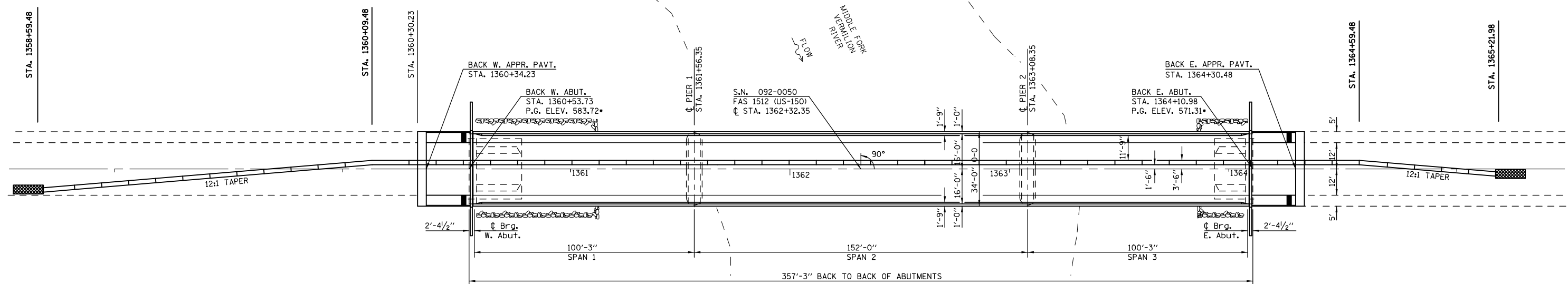

PLAN

FILE NAME =	USER NAME = ceerlockjd	DESIGNED - TJB	REVISED -	STATE OF ILLINOIS DEPARTMENT OF TRANSPORTATION	TEMPORARY WATER FILLED BARRIER LAYOUT S.N. 092-0050			F.A.S. RTE.	SECTION	COUNTY	TOTAL SHEETS	SHEET NO.	
ei:\pwwork\pwwork\ceerlockjd\0280772\B	ridge Repairs SN 092-0050.dgn	DRAWN - TJB	REVISED -		SCALE:	SHEET NO. 17 OF 25 SHEETS	STA.	TO STA.	1512	36BDR	VERMILION	34	22
PLOT SCALE = 40.0001' / in.		CHECKED -	REVISED -					CONTRACT NO. 70965					
PLOT DATE = 2/25/2013		DATE - 2-21-2012	REVISED -		FED. ROAD DIST. NO. ILLINOIS FED. AID PROJECT								