

SEC. 28, T22N, R-5E, 3RD PM

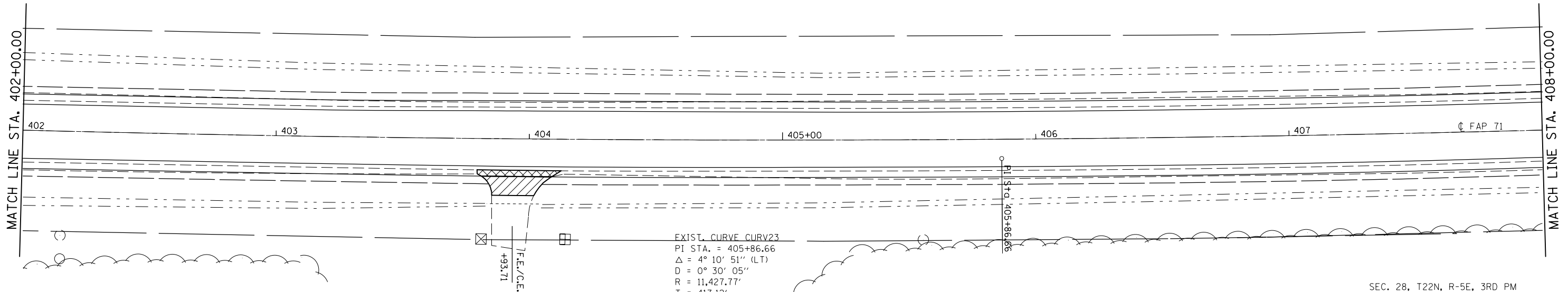
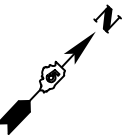

EXIST. CURVE CURV23
 PI STA. = 405+86.66
 Δ = 4° 10' 51" (LT)
 D = 0° 30' 05"
 R = 11,427.77'
 T = 417.12'
 L = 833.87'
 E = 7.61'
 e = -----
 T.R. = -----
 S.E. RUN = -----
 P.C. STA. = 401+69.54
 P.T. STA. = 410+03.41

SEC. 28, T22N, R-5E, 3RD PM

- PAVEMENT REMOVAL
- HOT-MIX ASPHALT SURFACE REMOVAL, SPECIAL

• DEWITT / MCLEAN

FILE NAME =	USER NAME = castrub	DESIGNED -	REVISED -
ei:\pwork\pwork\castrub\d0313174\057084-sh1-DblPin.1.dgn		DRAWN -	REVISED -
	PLOT SCALE = 40.0000' / in.	CHECKED -	REVISED -
#MODELNAME#	PLOT DATE = 1/3/2014	DATE -	REVISED -

**STATE OF ILLINOIS
DEPARTMENT OF TRANSPORTATION**

PLAN SHEET			
SCALE:	SHEET	OF	SHEETS
			STA. 396+00.00 TO STA. 408+00.00

F.A.P. RTE.	SECTION	COUNTY	TOTAL SHEETS	SHEET NO.
71	(122,121)I	*	199	49
CONTRACT NO. 70984			ILLINOIS FED. AID PROJECT	