

STAGE I TRAFFIC CONTROL BRIDGE REPLACEMENT

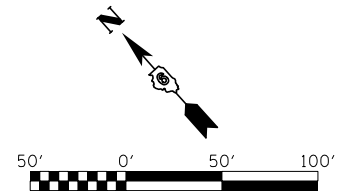

STAGE I NOTES

1. ERECT SIGNS, TRAFFIC SIGNALS, TEMPORARY BARRIERS, ETC. UTILIZING THE APPLICABLE DETAILS OF TRAFFIC CONTROL STANDARDS 701321 AND 701331 WITH BARRIER SPACING AS NOTED ON THE PLANS.
2. CONSTRUCT RUNAROUND DETOUR UTILIZING TRAFFIC CONTROL STANDARDS 701321 AND 701331.
3. CONSTRUCT THE PROPOSED CULVERT AT STA. 509+62.
4. CONSTRUCT GUARDRAIL IN AREA ALONG IL RTE 10 BETWEEN BEGINNING AND END OF RUNAROUND LIMITS.
5. PLACE PAVEMENT MARKING LINE TO ALLOW FOR A 12'-0" TRAFFIC LANE.
6. REMOVE THE EXISTING BRIDGE, PAVEMENT AND GUARDRAIL, AT LOCATIONS AS NOTED ON THE PLANS. CONSTRUCT REMAINING CULVERT AT STA. 509+62.
7. CONSTRUCT SN 054-0515 AT STA. 511+50.
8. CONSTRUCT TEMPORARY RAMPS AT NEW BRIDGE AND INSTALL TEMPORARY IMPACT ATTENUATORS AT ENDS OF PARAPET.
9. MOVE TRAFFIC BACK TO IL RTE 10.

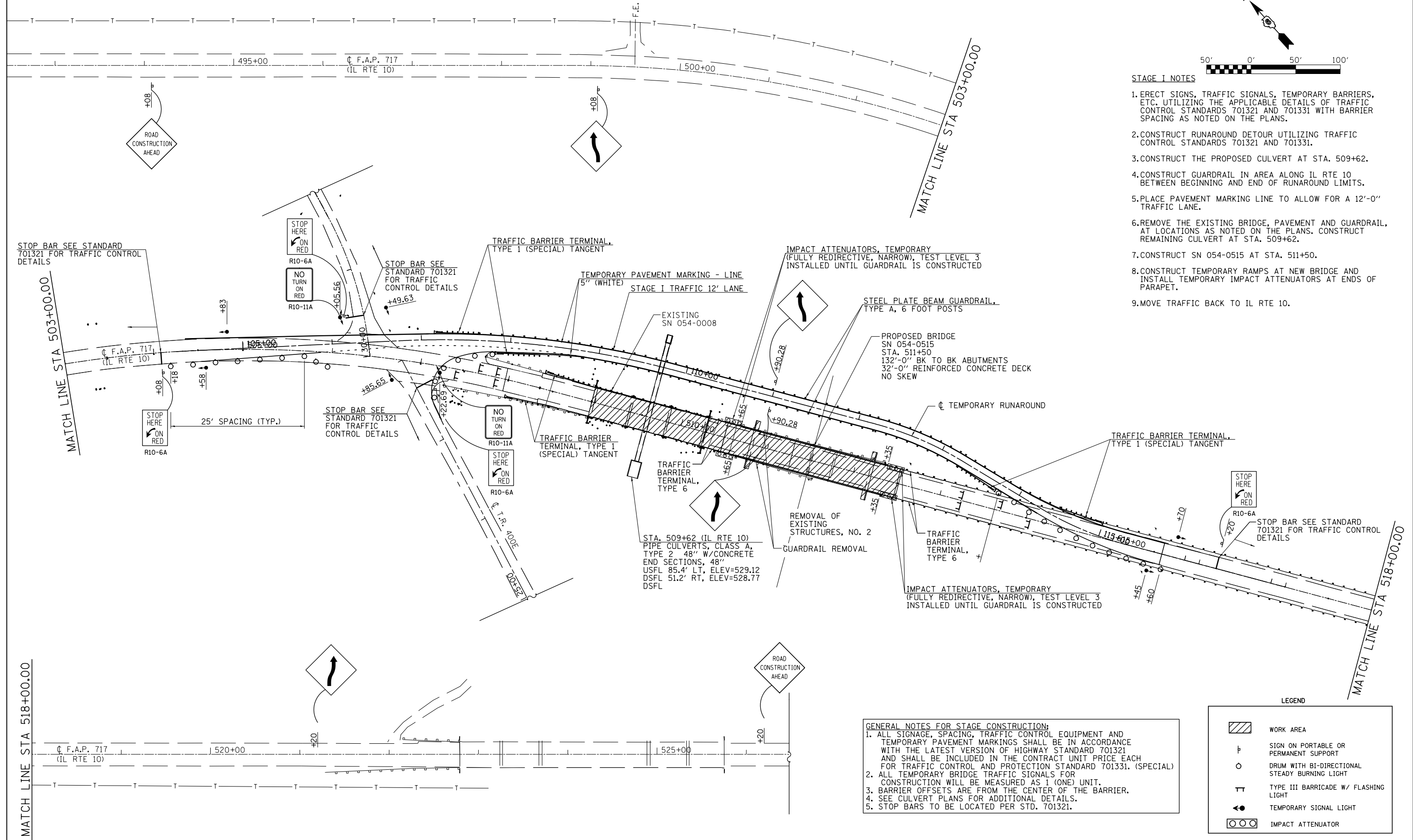

GENERAL NOTES FOR STAGE CONSTRUCTION:

1. ALL SIGNAGE, SPACING, TRAFFIC CONTROL EQUIPMENT AND TEMPORARY PAVEMENT MARKINGS SHALL BE IN ACCORDANCE WITH THE LATEST VERSION OF HIGHWAY STANDARD 701321 AND SHALL BE INCLUDED IN THE CONTRACT UNIT PRICE. EACH FOR TRAFFIC CONTROL AND PROTECTION STANDARD 701331. (SPECIAL)
2. ALL TEMPORARY BRIDGE TRAFFIC SIGNALS FOR CONSTRUCTION WILL BE MEASURED AS 1 (ONE) UNIT.
3. BARRIER OFFSETS ARE FROM THE CENTER OF THE BARRIER.
4. SEE CULVERT PLANS FOR ADDITIONAL DETAILS.
5. STOP BARS TO BE LOCATED PER STD. 701321.

LEGEND

	WORK AREA
	SIGN ON PORTABLE OR PERMANENT SUPPORT
	DRUM WITH BI-DIRECTIONAL STEADY BURNING LIGHT
	TYPE III BARRICADE W/ FLASHING LIGHT
	TEMPORARY SIGNAL LIGHT
	IMPACT ATTENUATOR

FILE NAME =	USER NAME = *USER*	DESIGNED -	REVISED -	STATE OF ILLINOIS DEPARTMENT OF TRANSPORTATION	STAGE I CONSTRUCTION - FAP 717 (IL RTE 10) - BRIDGE			F.A.P. RTE. 717	SECTION (102B-1,102CR,102BR-2)RS-5	COUNTY LOGAN	TOTAL SHEETS 218	SHEET NO. 35
*FILE#		DRAWN -	REVISED -		SCALE:	SHEET NO. 3 OF 5 SHEETS	STA.	TO STA.	CONTRACT NO. 72B82			
		CHECKED -	REVISED -		ILLINOIS FED. AID PROJECT							
		DATE -	REVISED -									