

CURVE DATA
 P.I. STA= 594+70
 $\Delta = 61^{\circ}-01'-00''$
 $D = 28^{\circ}-00'-00''$
 $R = 206.6'$
 $T = 121.8'$
 $L = 217.9'$
 $E = 33.2'$
 $S.E. = 0.071'/'$ (MATCH EXISTING)
 P.C. STA= 593+48.2
 P.T. STA= 595+91.8
 SE TRANSITION 128'
 STA. 592+62.9 TO STA. 593+90.9
 STA. 595+49.1 TO STA. 596+77.1

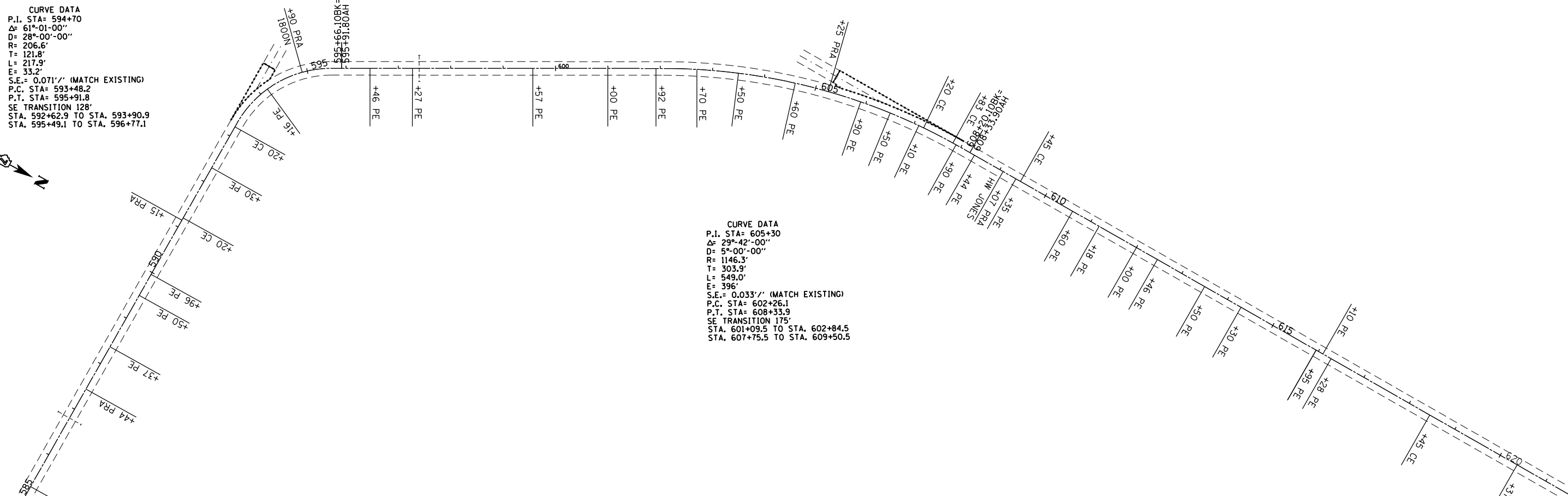

CURVE DATA
 P.I. STA= 605+30
 $\Delta = 29^{\circ}-42'-00''$
 $D = 5^{\circ}-00'-00''$
 $R = 1146.3'$
 $T = 303.9'$
 $L = 549.0'$
 $E = 396'$
 $S.E. = 0.033'/'$ (MATCH EXISTING)
 P.C. STA= 602+26.1
 P.T. STA= 608+33.9
 SE TRANSITION 175'
 STA. 601+09.5 TO STA. 602+84.5
 STA. 607+75.5 TO STA. 609+50.5

FILE NAME =	USER NAME = steffenmk	DESIGNED -	REVISED -
c:\pwwork\pwwork\stefmk\d0249366\074512-sh1-plan.dgn		DRAWN -	REVISED -
PLOT SCALE = 200.0000' / in.		CHECKED -	REVISED -
PLOT DATE = 12/5/2013		DATE -	REVISED -

**STATE OF ILLINOIS
 DEPARTMENT OF TRANSPORTATION**

PLAN SHEET
STA 555+00 TO STA 620+00

SCALE: 100 SHEET NO. 7 OF 12 SHEETS STA. TO STA.

F.A.P. RTE.	SECTION	COUNTY	TOTAL SHEETS	SHEET NO.
328	(8,910)RS-2	Wayne	23	18
CONTRACT NO. 74512			ILLINOIS FED. AID PROJECT	