

SUGGESTED SEQUENCE OF CONSTRUCTION

PRESTAGE CONSTRUCTION

- PRESTAGE CONSTRUCTION SHALL CONSIST OF: CONSTRUCTING THE 10" WIDENING OF THE OUTSIDE SHOULDERS (NORTHBOUND AND SOUTHBOUND) OF I-255 TO THE LIMITS SHOWN IN THE PLANS; PLACING THE PROTECTIVE SHIELD ON THE STRUCTURE; AND ANY MISCELLANEOUS WORK NECESSARY TO FACILITATE THE CONSTRUCTION OF THE PAVEMENT WIDENING FOR STAGE CONSTRUCTION.
- THE WIDENING SHALL CONSIST OF HOT-MIX ASPHALT BASE COURSE -10".
- TRAFFIC CONTROL FOR THIS WORK WILL BE DONE IN ACCORDANCE WITH THE APPLICABLE PORTIONS OF TRAFFIC CONTROL AND PROTECTION, STANDARDS 701400, 701401, 701411, 701456, AND 701501 AND AS SHOWN IN THE PLANS. A MINIMUM OF TWO LANES OF TRAFFIC WILL BE MAINTAINED AT ALL TIMES REGARDLESS OF THE CONTRACTOR'S CONSTRUCTION ACTIVITIES.

STAGE 1 CONSTRUCTION

- STAGE 1 CONSTRUCTION SHALL CONSIST OF: WIDENING OF THE INSIDE SHOULDERS (NORTHBOUND AND SOUTHBOUND) TO THE LIMITS SHOWN IN THE PLANS; CLASS A PAVEMENT PATCHING; ANY MISCELLANEOUS WORK NECESSARY TO FACILITATE THE CONSTRUCTION OF THE PAVEMENT WIDENING FOR STAGE 2 CONSTRUCTION; STAGE 1 BRIDGE CONSTRUCTION AS DETAILED IN THE PLANS, AND HMA RESURFACING TRANSITIONING ON THE APPROACH PAVEMENT.
- THE WIDENING SHALL CONSIST OF HOT-MIX ASPHALT BASE COURSE -10".
- TRAFFIC CONTROL FOR THIS WORK WILL BE DONE IN ACCORDANCE WITH THE APPLICABLE PORTIONS OF TRAFFIC CONTROL AND PROTECTION, STANDARDS 701400, 701402 AND, 701411, AND AS SHOWN IN THE PLANS. A MINIMUM OF TWO LANES OF TRAFFIC WILL BE MAINTAINED AT ALL TIMES REGARDLESS OF THE CONTRACTOR'S CONSTRUCTION ACTIVITIES.

STAGE 2 CONSTRUCTION

- STAGE 2 CONSTRUCTION SHALL CONSIST OF: CLASS A PAVEMENT PATCHING; STAGE 2 BRIDGE CONSTRUCTION AS DETAILED IN THE PLANS, HMA RESURFACING TRANSITIONS ON APPROACH PAVEMENT, AND GUARDRAIL IMPROVEMENTS.
- TRAFFIC CONTROL FOR THIS WORK WILL BE DONE IN ACCORDANCE WITH THE APPLICABLE PORTIONS OF TRAFFIC CONTROL AND PROTECTION, STANDARDS 701400, 701411, AND 701402. A MINIMUM OF TWO LANES OF TRAFFIC WILL BE MAINTAINED AT ALL TIMES REGARDLESS OF THE CONTRACTOR'S CONSTRUCTION ACTIVITIES.

NOTES

- CHANGEABLE MESSAGE BOARDS SHALL BE PLACED 2 WEEKS PRIOR TO CONSTRUCTION AND AT THE DIRECTION OF THE ENGINEER.
- THE CONTRACTOR WILL BE ALLOWED THE OPTION OF USING SAND MODULE IMPACT ATTENUATORS FOR THIS PROJECT.

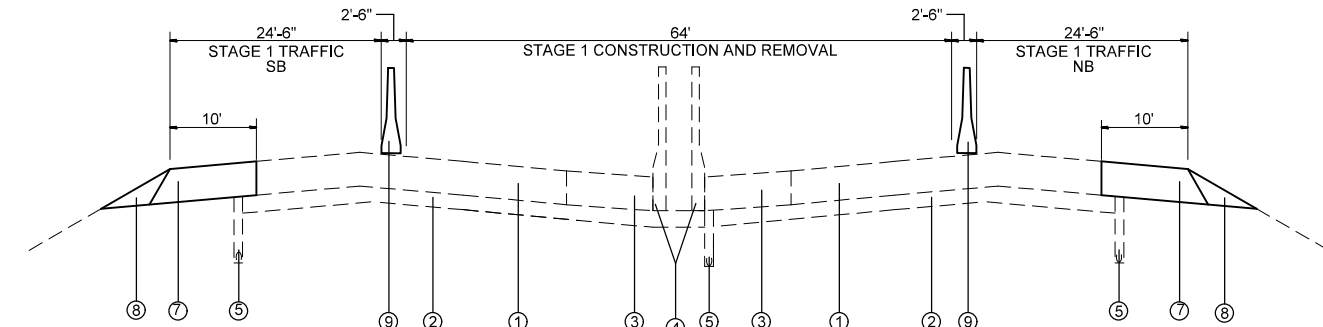

STAGE 1 TRAFFIC

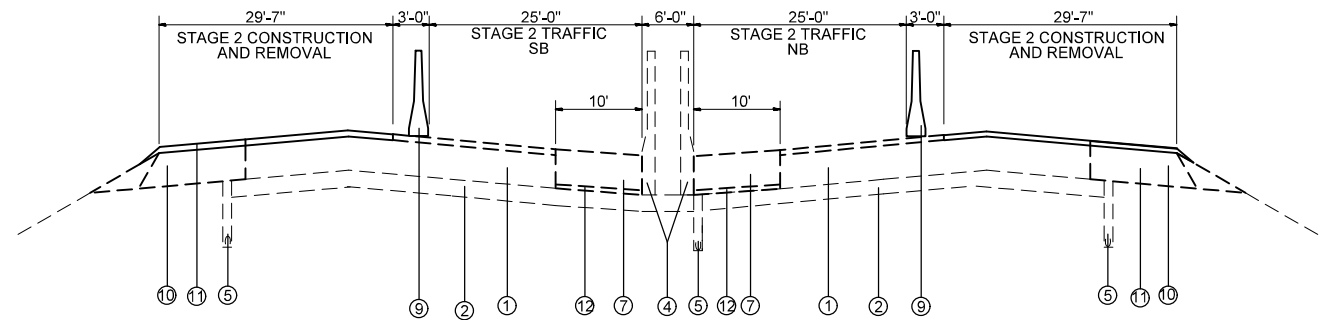

STAGE 2 TRAFFIC

LEGEND

- ① EXISTING CRPCC PAVEMENT - 10"
- ② EXISTING STABILIZED SUBBASE - 4"
- ③ EXISTING HMA SHOULDERS - 10"
- ④ EXISTING CONCRETE MEDIAN BARRIER
- ⑤ EXISTING UNDERDRAINS - 4"
- ⑥ EXISTING AGGREGATE SHOULDER
- ⑦ PROPOSED HMA BASE COURSE - 10"
- ⑧ PROPOSED AGGREGATE SHOULDER, TYPE A
- ⑨ TEMPORARY CONCRETE BARRIER
- ⑩ PROPOSED HMA SHOULDERS
- ⑪ PROPOSED AGGREGATE TYPE C
- ⑫ HMA BASE COURSE PLACED FOR STAGE 1 TRAFFIC

STAGING SCHEDULE

LOCATION	HOT-MIX ASPHALT BASE COURSE-10" SQ YD	PAVED SHOULDER REMOVAL SQ YD	TEMPORARY CONCRETE BARRIER FOOT	RELOCATE TEMPORARY CONCRETE BARRIER FOOT	IMPACT ATTENUATOR, TEMPORARY (NON-REDIRECTIVE) EACH	IMPACT ATTENUATOR, RELOCATE (NON-REDIRECTIVE) EACH
STAGE I	3236.5	3236.5	1837.5		2	
STAGE II	2490.5	2490.5		2025		2
TOTAL	5727	5727	1837.5	2025	2	2

PEAK HOUR LANE CLOSURE SCHEDULE

SOUTHBOUND	SOUTHBOUND												DAYS											
	12:00 AM	1:00 AM	2:00 AM	3:00 AM	4:00 AM	5:00 AM	6:00 AM	7:00 AM	8:00 AM	9:00 AM	10:00 AM	11:00 AM		12:00 PM	1:00 PM	2:00 PM	3:00 PM	4:00 PM	5:00 PM	6:00 PM	7:00 PM	8:00 PM	9:00 PM	10:00 PM
	1 LANE OPEN												SUNDAY											
	1 LANE OPEN			2 LANES OPEN			1 LANE OPEN			1 LANE OPEN			MONDAY											
	1 LANE OPEN			2 LANES OPEN			1 LANE OPEN			1 LANE OPEN			TUESDAY											
	1 LANE OPEN			2 LANES OPEN			1 LANE OPEN			1 LANE OPEN			WEDNESDAY											
	1 LANE OPEN			2 LANES OPEN			1 LANE OPEN			1 LANE OPEN			THURSDAY											
	1 LANE OPEN						ALL LANES OPEN						FRIDAY											
	1 LANE OPEN												SATURDAY											
NORTHBOUND	NORTHBOUND												DAYS											
	12:00 AM	1:00 AM	2:00 AM	3:00 AM	4:00 AM	5:00 AM	6:00 AM	7:00 AM	8:00 AM	9:00 AM	10:00 AM	11:00 AM		12:00 PM	1:00 PM	2:00 PM	3:00 PM	4:00 PM	5:00 PM	6:00 PM	7:00 PM	8:00 PM	9:00 PM	10:00 PM
	1 LANE OPEN												SUNDAY											
	1 LANE OPEN			2 LANES OPEN			1 LANE OPEN			1 LANE OPEN			MONDAY											
	1 LANE OPEN			2 LANES OPEN			1 LANE OPEN			1 LANE OPEN			TUESDAY											
	1 LANE OPEN			2 LANES OPEN			1 LANE OPEN			1 LANE OPEN			WEDNESDAY											
	1 LANE OPEN			2 LANES OPEN			1 LANE OPEN			1 LANE OPEN			THURSDAY											
	1 LANE OPEN						ALL LANES OPEN						FRIDAY											
	1 LANE OPEN												SATURDAY											

FOR CLARIFICATION PURPOSES: EXCEPT FOR THE BRIDGE REPAIR WORK WHICH NECESSITATES THE STAGING SHOWN IN THE PLANS, ALL LANES MUST BE OPEN FROM 12 NOON TO 12 MIDNIGHT ON FRIDAYS. IN ADDITION, WITH THE EXCEPTION OF THE BRIDGE REPAIR WORK STAGING, THE RESIDENT ENGINEER SHALL COORDINATE ALL LANE CLOSURES WITH GRIZZLY STADIUM IN ORDER TO MINIMIZE DISRUPTION ON GAME DAYS.

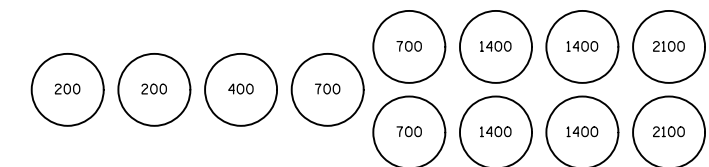

TEMPORARY SAND MODULE IMPACT ATTENUATOR LAYOUT
(IF OPTION USED)

FILE NAME =	USER NAME = #USER#	DESIGNED -	REVISED -	STATE OF ILLINOIS DEPARTMENT OF TRANSPORTATION	TRAFFIC CONTROL AND STAGE CONSTRUCTION NOTES	F.A.I. RTE.	SECTION	COUNTY	TOTAL SHEETS	SHEET NO.	
#FILE#		DRAWN -	REVISED -			255	82-4HVB-I	ST. CLAIR	46	13	
		PLOT SCALE = #SCALE#	REVISIED -			CONTRACT NO. 76D51					
		PLOT DATE = #DATE#	REVISIED -			SCALE:	SHEET NO. 1 OF 10 SHEETS	STA.	TO STA.	FED. ROAD DIST. NO.	ILLINOIS FED. AID PROJECT