

EXISTING AIRPORT COORDINATE TABLE			
LOCATION	LATTITUDE N.	LONGITUDE W.	ELEVATION
RUNWAY 6	40° 55' 15.1063"	88° 37' 54.0035"	648.6
RUNWAY 24	40° 55' 40.9458"	88° 36' 58.4819"	665.9



**LEGEND**

EXISTING	PROPOSED	DESCRIPTION
		AIRPORT BUILDINGS
		HOUSES AND OUTBUILDINGS
		GROUND CONTOURS
		OVERHEAD POWER LINE
		CONTRACTOR'S ACCESS ROUTE TO SITE
		CONTRACTOR'S STAGING, STORAGE AND PERSONNEL VEHICLE PARKING SITE

**NOTE:**  
1.) CONTRACTOR SHALL USE HAUL ROAD AT THE ALIGNMENT AS SHOWN.

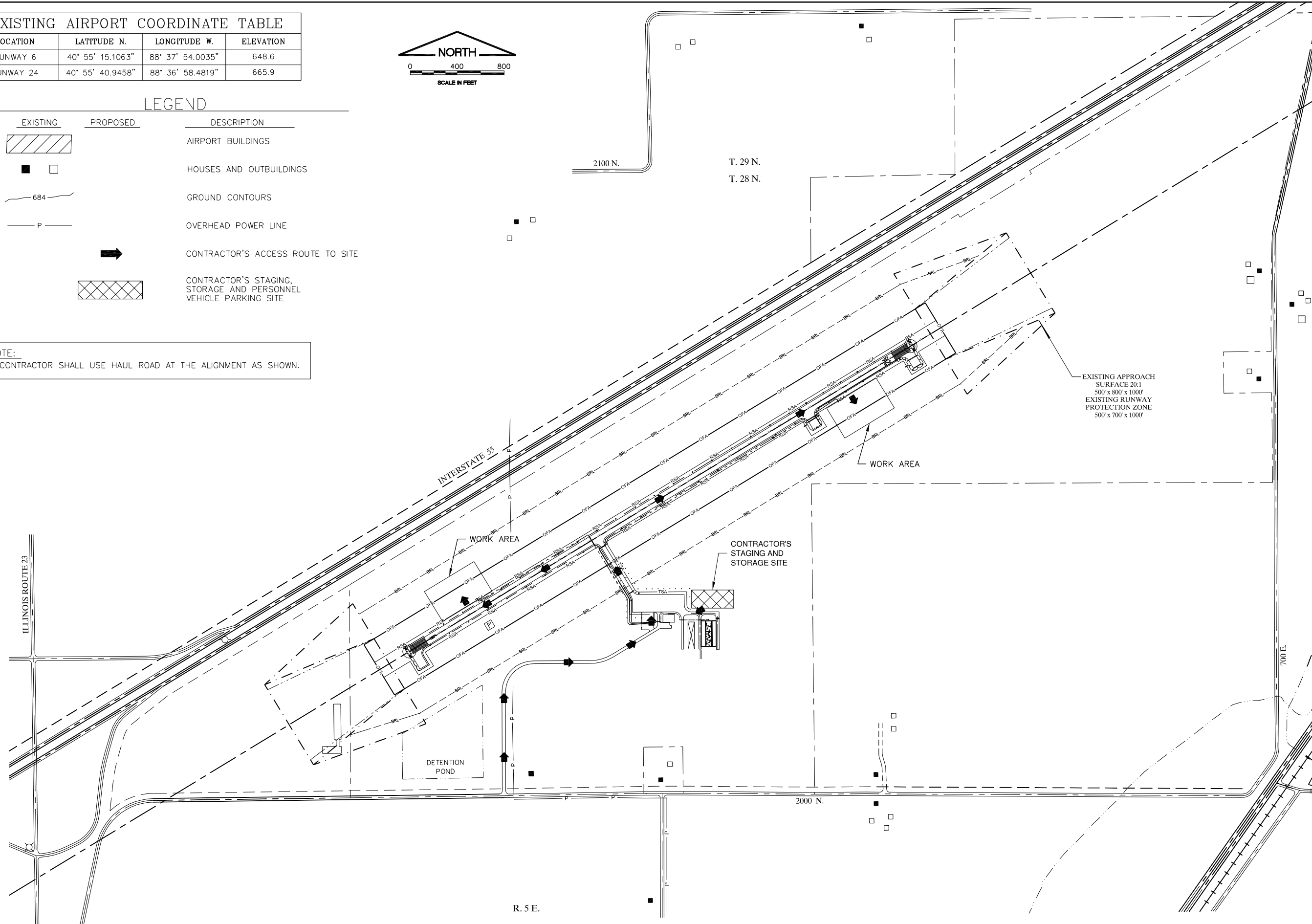

FILE: SITE PLAN.dwg  
UPDATE BY: Jason Frank  
PLOT DATE: 11/15/2013 1:41 PM

BASELINE  
PontBASE

**P0017**

REVISIONS		
NUMBER	BY	DATE

0 1 2  
THIS BAR IS EQUAL TO 2" AT FULL SCALE (34X22).

**PONTIAC MUNICIPAL AIRPORT  
PONTIAC, ILLINOIS  
INSTALL VISUAL NAVIGATIONAL AID (PAPI) SYSTEM  
SITE PLAN**

© Copyright CMT, Inc.

**CMT**  
CRAWFORD, MURPHY & TILLY, INC.  
CONSULTING ENGINEERS  
License No. 184-000613

DESIGN BY:	WDP
DRAWN BY:	CMT
CHECKED BY:	JEF
APPROVED BY:	CET
DATE:	NOVEMBER 15, 2013
JOB No:	1305403
IL. PROJ. NO. PNT-4340 AIP PROJ. NO. 3-17-SBGP-XX	
SHEET 02	OF 11 SHEETS

K:\Pontiac\130540300\Draw\Sheets