

GENERAL NOTES

- ALL RUNWAYS, TAXIWAYS, AND APRONS SHALL BE KEPT OPEN TO AIRPORT TRAFFIC DURING CONSTRUCTION EXCEPT AS NOTED IN THE CONSTRUCTION ACTIVITY PLAN.
- WHEN CONFLICTS ARISE BETWEEN CONSTRUCTION ACTIVITIES AND AIRCRAFT OPERATIONS AND SAFETY, AIRCRAFT OPERATIONS AND SAFETY SHALL TAKE PRECEDENCE AND SHALL GOVERN. FINAL AUTHORITY IN THE APPROVAL OF CONSTRUCTION SEQUENCING LIES WITH THE AIRPORT.
- THE CONTRACTOR WILL BE PERMITTED TO STORE EQUIPMENT AND MATERIALS AT THE LOCATIONS SHOWN ON THE CONSTRUCTION ACTIVITY PLAN. THE MAXIMUM HEIGHT OF EQUIPMENT, MATERIALS AND STOCKPILES SHALL BE 25' ABOVE GROUND ELEVATION. AT NO POINT SHALL EQUIPMENT OR MATERIALS BE ALLOWED TO BE STORED ON RUNWAYS.
- MEN, VEHICLES AND EQUIPMENT WILL NOT BE ALLOWED WITHIN THE FOLLOWING AREAS:
 - 250' FROM THE CENTERLINE OF RUNWAY 3/21 WHEN ACTIVE.
 - 93' FROM THE CENTERLINE OF AN ACTIVE TAXIWAY.
- ALL CONSTRUCTION TRAFFIC OPERATING ON OR CROSSING A TAXIWAY OR RUNWAY OPEN TO AIRCRAFT TRAFFIC SHALL BE UNDER CONTROL BY AN ESCORT OR A FLAGMAN IN RADIO CONTACT WITH AIR AND GROUND TRAFFIC AT ALL TIMES. CONTRACTOR SHALL PROVIDE THE ESCORT/FLAGMAN AND RADIO EQUIPMENT AT NO EXTRA COST TO THE CONTRACT.
- ABANDONED EQUIPMENT OR OTHER RUBBISH SHALL BE DISPOSED OF BY THE CONTRACTOR OFF OF AIRPORT PROPERTY UNLESS OTHERWISE DIRECTED BY THE AIRPORT.
- ROADS OR STORAGE AREAS SHALL BE MAINTAINED AND REPAIRED IN KIND BY THE CONTRACTOR TO THE SATISFACTION OF THE ENGINEER AND THE AIRPORT. NO ADDITIONAL COMPENSATION SHALL BE MADE TO THE CONTRACTOR FOR THIS WORK.
- EXISTING TURF AREAS DISTURBED BY THE CONTRACTOR'S OPERATIONS SHALL BE RESTORED BY HIM AT HIS EXPENSE TO THE SATISFACTION OF THE ENGINEER AND THE AIRPORT.
- THE CONTRACTOR SHALL BE RESPONSIBLE FOR CONTINUOUSLY CLEANING ACTIVE AIRFIELD PAVEMENTS WHICH ARE CROSSED BY HIS VEHICLES ACCESSING THE WORK OR DEPARTING THE WORK IMMEDIATELY FOLLOWING SAID VEHICLE.
- IT WILL BE NECESSARY FOR THE CONTRACTOR TO MAKE HIS OWN FIELD INVESTIGATION TO DETERMINE THE EXACT LOCATION OF THE UNDERGROUND UTILITIES AT CRITICAL POINTS SO AS TO AVOID ANY DAMAGE. ANY UTILITY, INCLUDING AIRFIELD ELECTRICAL CABLE AND LIGHTS, DAMAGED BY THE CONTRACTOR SHALL BE REPAIRED BY HIM AT HIS OWN EXPENSE IN A MANNER WHICH IS SATISFACTORY TO THE ENGINEER AND TO THE OWNER OF THE UTILITY. ANY REPAIRS THAT MUST BE MADE BY THE OWNER OF THE UTILITY SHALL HAVE THE COST REIMBURSED TO THE UTILITY BY THE CONTRACTOR. AIRFIELD LIGHTING CABLES DAMAGED BY THE CONTRACTOR SHALL BE REPAIRED BY A QUALIFIED ELECTRICIAN WITH THE COSTS TO BE BORNE BY THE CONTRACTOR.
- CONTRACTOR'S ACCESS SHALL BE AS FOLLOWS:
 - THE CONTRACTOR'S ACCESS TO WORK SHALL BE AS SHOWN IN THE PLANS.
 - THE CONTRACTOR SHALL MAINTAIN A COMPLETE LIST OF PERSONNEL AUTHORIZED BY THE CONTRACTOR TO WORK ON THE AIRFIELD. THIS LIST SHALL BE PROVIDED TO THE AIRPORT AND RESIDENT ENGINEER BY THE CONTRACTOR UPON REQUEST.
 - THE CONTRACTOR SHALL USE AN EXISTING GATE(S) FOR ACCESS TO THE AIRFIELD. THE CONTRACTOR SHALL INSTALL AND MAINTAIN A HEAVY-DUTY PADLOCK ON THE ACCESS GATE. HE SHALL PROVIDE KEYS FOR HIS PADLOCK TO THE RESIDENT ENGINEER AND VRAA MAINTENANCE SUPERVISOR. NO ADDITIONAL KEYS ARE TO BE DISTRIBUTED UNLESS AUTHORIZED BY THE AIRPORT.
 - CONTRACTOR SHALL OBTAIN ALL NECESSARY PERMITS AND TEMPORARY EASEMENTS FOR THE PUBLIC ACCESS ROAD(S) SHOWN AND SHALL COMPLY WITH ALL REQUIREMENTS, LOAD RESTRICTIONS, & TRAFFIC CONTROL SIGNAGE REQUIRED BY THE CITY, COUNTY, TOWNSHIP, OR I.D.O.T.
 - DURING ADVERSE WEATHER THE CONTRACTOR SHALL MAINTAIN ACCESS TO THE WORK AT NO ADDITIONAL COST TO THE CONTRACT. NO EXTENSION OF THE CONTRACT TIME WILL BE CONSIDERED FOR DELAYS DUE TO LACK OF ADEQUATE ACCESS TO THE WORK SITE.
 - THE CONTRACTOR SHALL BE RESPONSIBLE FOR KEEPING THE ACCESS GATE(S) CLOSED DURING WORK HOURS. THE CONTRACTOR CONTROL ACCESS AT THE GATE SHOULD THERE BE A NEED TO KEEP GATES OPEN AND UNLOCKED.
 - THE CONTRACTOR SHALL CLOSE AND LOCK THE ACCESS GATE(S) UPON LEAVING THE SITE.
 - ALL COSTS RELATING TO CONTRACTOR'S ACCESS AND SECURITY SHALL BE THE RESPONSIBILITY OF THE CONTRACTOR.
 - THE CONTRACTOR SHALL STORE EQUIPMENT AND MATERIALS IN SUCH A WAY AS NOT TO VIOLATE AIRPORT PART 77 SURFACES, OR RUNWAY AND TAXIWAY SAFETY AREAS.
 - THE CONTRACTOR SHALL BE RESPONSIBLE FOR CLEANING ACTIVE AIRFIELD PAVEMENTS WHICH ARE CROSSED BY HIS VEHICLES.

FILE: Site Plan.dwg
 UPDATE BY: TJ Heavisides
 PLOT DATE: 1/13/2014 12:03 PM
 DNVBase_StatePlane

VE049

REVISIONS

NUMBER	BY	DATE

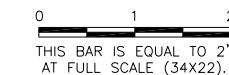

VERMILION REGIONAL AIRPORT AUTHORITY
 VERMILION REGIONAL AIRPORT
 DANVILLE, ILLINOIS
 REHABILITATE LIGHTS ON RUNWAY 16/34
 SITE PLAN

© Copyright CMT, Inc.
CMT
 CRAWFORD, MURPHY & TILLY, INC.
 CONSULTING ENGINEERS
 License No. 184-000613

DESIGN BY:	TJH
DRAWN BY:	CMT
CHECKED BY:	AJB
APPROVED BY:	CET
DATE:	JANUARY 3, 2014
JOB No:	13042-01
IL PROJ. NO.	DNV-4234
PROJ. NO.	3-17-SBGP-XX
SHEET	03 OF 14 SHEETS



AREA OF CONSTRUCTION

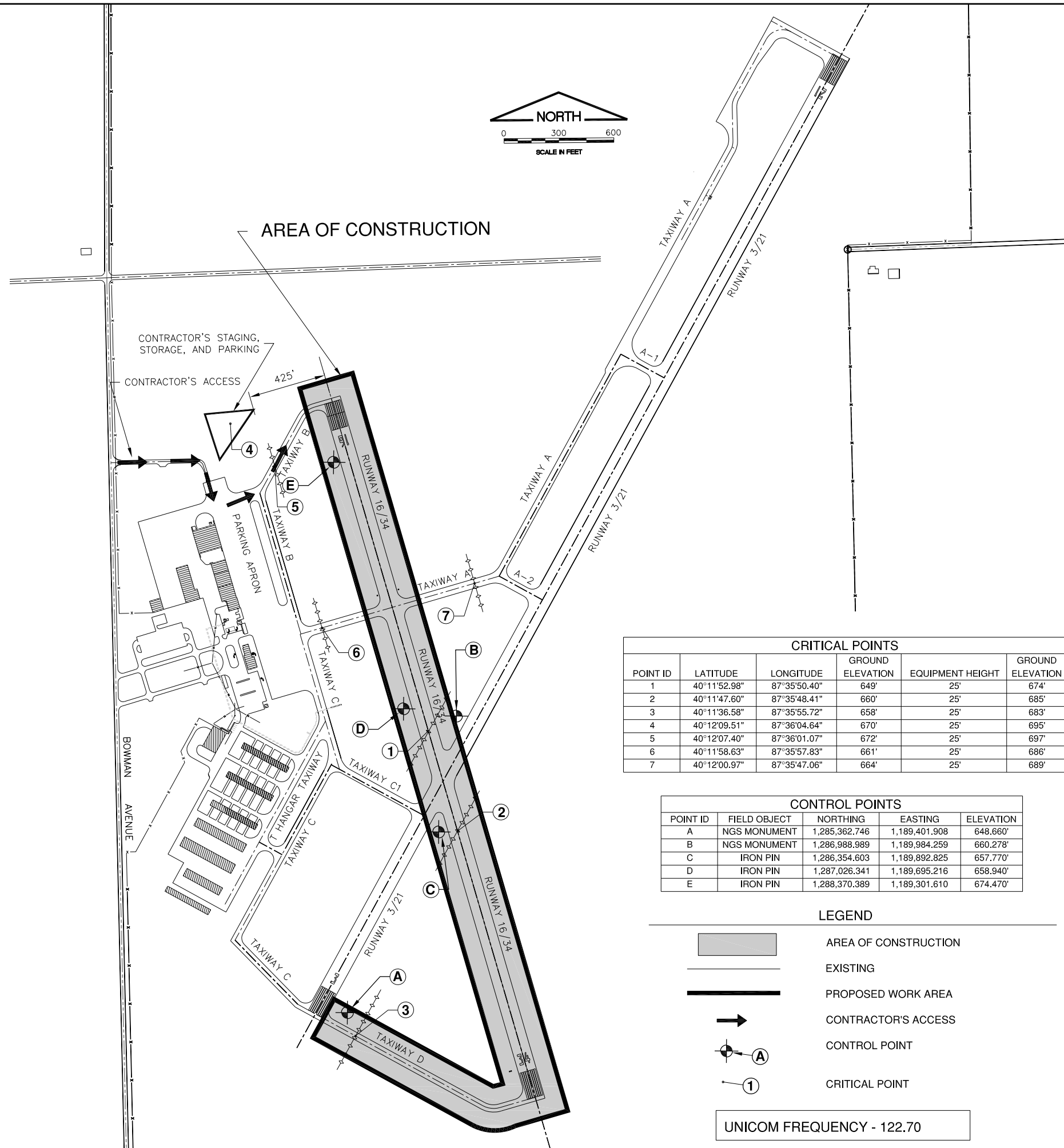

CRITICAL POINTS					
POINT ID	LATITUDE	LONGITUDE	GROUND ELEVATION	EQUIPMENT HEIGHT	GROUND ELEVATION
1	40°11'52.98"	87°35'50.40"	649'	25'	674'
2	40°11'47.60"	87°35'48.41"	660'	25'	685'
3	40°11'36.58"	87°35'55.72"	658'	25'	683'
4	40°12'09.51"	87°36'04.64"	670'	25'	695'
5	40°12'07.40"	87°36'01.07"	672'	25'	697'
6	40°11'58.63"	87°35'57.83"	661'	25'	686'
7	40°12'00.97"	87°35'47.06"	664'	25'	689'

CONTROL POINTS				
POINT ID	FIELD OBJECT	NORTHING	EASTING	ELEVATION
A	NGS MONUMENT	1,285,362.746	1,189,401.908	648.660'
B	NGS MONUMENT	1,286,988.989	1,189,984.259	660.278'
C	IRON PIN	1,286,354.603	1,189,892.825	657.770'
D	IRON PIN	1,287,026.341	1,189,695.216	658.940'
E	IRON PIN	1,288,370.389	1,189,301.610	674.470'

- LEGEND
- AREA OF CONSTRUCTION
 - EXISTING
 - PROPOSED WORK AREA
 - CONTRACTOR'S ACCESS
 - CONTROL POINT
 - CRITICAL POINT

UNICOM FREQUENCY - 122.70

K:\Downtown\1304201\Drawn\Sheets