

**VE050**

REVISIONS		
NUMBER	BY	DATE

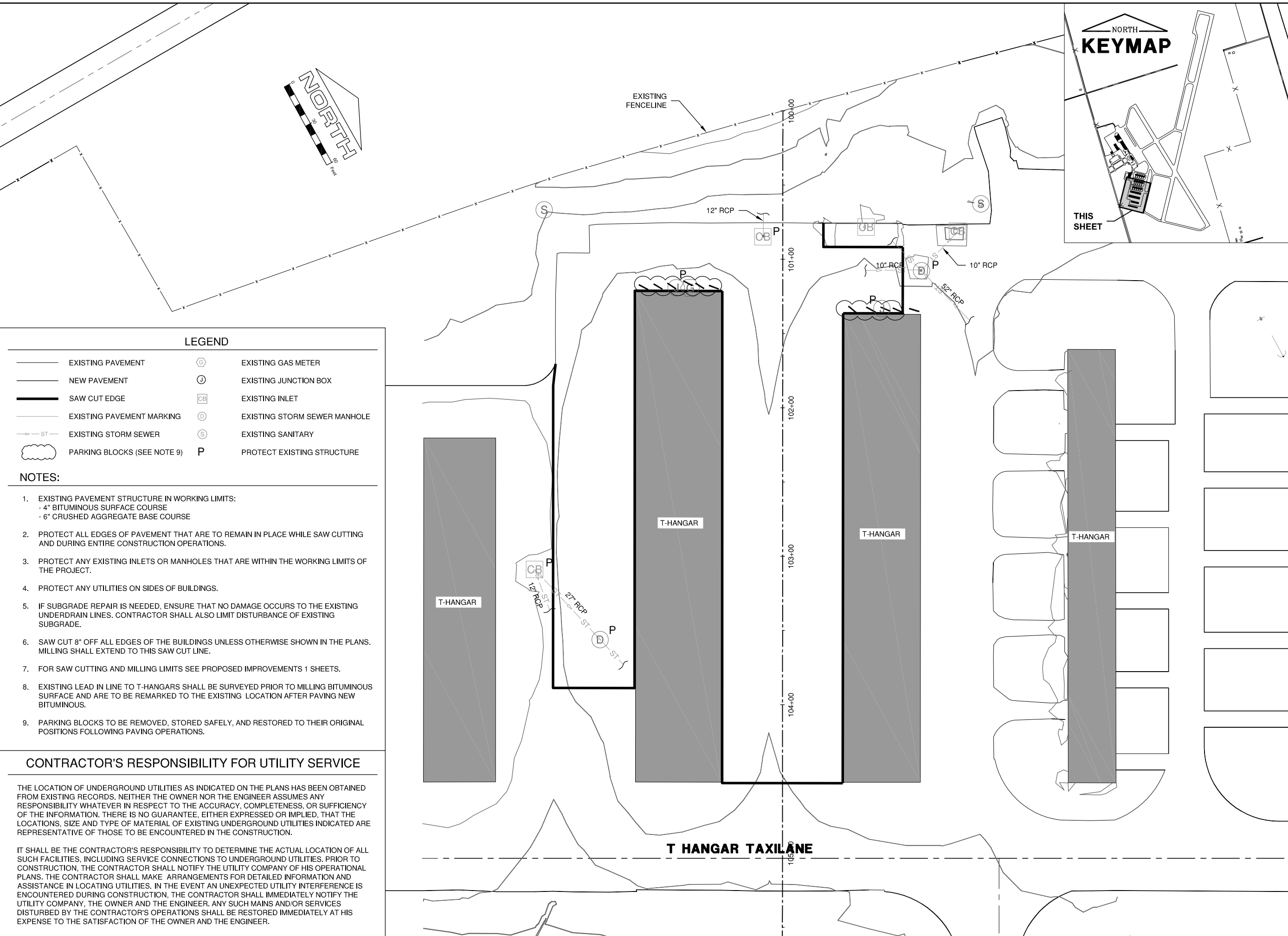
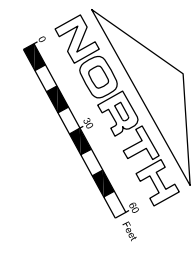
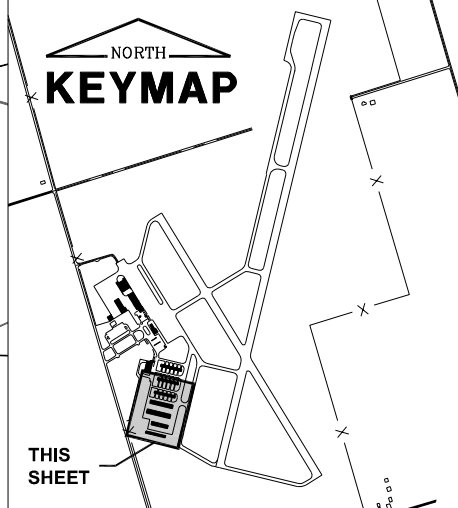
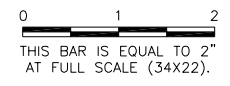

**LEGEND**

	EXISTING PAVEMENT		EXISTING GAS METER
	NEW PAVEMENT		EXISTING JUNCTION BOX
	SAW CUT EDGE		EXISTING INLET
	EXISTING PAVEMENT MARKING		EXISTING STORM SEWER MANHOLE
	EXISTING STORM SEWER		EXISTING SANITARY
	PARKING BLOCKS (SEE NOTE 9)		PROTECT EXISTING STRUCTURE

**NOTES:**

- EXISTING PAVEMENT STRUCTURE IN WORKING LIMITS:  
 - 4" BITUMINOUS SURFACE COURSE  
 - 6" CRUSHED AGGREGATE BASE COURSE
- PROTECT ALL EDGES OF PAVEMENT THAT ARE TO REMAIN IN PLACE WHILE SAW CUTTING AND DURING ENTIRE CONSTRUCTION OPERATIONS.
- PROTECT ANY EXISTING INLETS OR MANHOLES THAT ARE WITHIN THE WORKING LIMITS OF THE PROJECT.
- PROTECT ANY UTILITIES ON SIDES OF BUILDINGS.
- IF SUBGRADE REPAIR IS NEEDED, ENSURE THAT NO DAMAGE OCCURS TO THE EXISTING UNDERDRAIN LINES. CONTRACTOR SHALL ALSO LIMIT DISTURBANCE OF EXISTING SUBGRADE.
- SAW CUT 8" OFF ALL EDGES OF THE BUILDINGS UNLESS OTHERWISE SHOWN IN THE PLANS. MILLING SHALL EXTEND TO THIS SAW CUT LINE.
- FOR SAW CUTTING AND MILLING LIMITS SEE PROPOSED IMPROVEMENTS 1 SHEETS.
- EXISTING LEAD IN LINE TO T-HANGARS SHALL BE SURVEYED PRIOR TO MILLING BITUMINOUS SURFACE AND ARE TO BE REMARKED TO THE EXISTING LOCATION AFTER PAVING NEW BITUMINOUS.
- PARKING BLOCKS TO BE REMOVED, STORED SAFELY, AND RESTORED TO THEIR ORIGINAL POSITIONS FOLLOWING PAVING OPERATIONS.

**CONTRACTOR'S RESPONSIBILITY FOR UTILITY SERVICE**

THE LOCATION OF UNDERGROUND UTILITIES AS INDICATED ON THE PLANS HAS BEEN OBTAINED FROM EXISTING RECORDS. NEITHER THE OWNER NOR THE ENGINEER ASSUMES ANY RESPONSIBILITY WHATSOEVER IN RESPECT TO THE ACCURACY, COMPLETENESS, OR SUFFICIENCY OF THE INFORMATION. THERE IS NO GUARANTEE, EITHER EXPRESSED OR IMPLIED, THAT THE LOCATIONS, SIZE AND TYPE OF MATERIAL OF EXISTING UNDERGROUND UTILITIES INDICATED ARE REPRESENTATIVE OF THOSE TO BE ENCOUNTERED IN THE CONSTRUCTION.

IT SHALL BE THE CONTRACTOR'S RESPONSIBILITY TO DETERMINE THE ACTUAL LOCATION OF ALL SUCH FACILITIES, INCLUDING SERVICE CONNECTIONS TO UNDERGROUND UTILITIES. PRIOR TO CONSTRUCTION, THE CONTRACTOR SHALL NOTIFY THE UTILITY COMPANY OF HIS OPERATIONAL PLANS. THE CONTRACTOR SHALL MAKE ARRANGEMENTS FOR DETAILED INFORMATION AND ASSISTANCE IN LOCATING UTILITIES. IN THE EVENT AN UNEXPECTED UTILITY INTERFERENCE IS ENCOUNTERED DURING CONSTRUCTION, THE CONTRACTOR SHALL IMMEDIATELY NOTIFY THE UTILITY COMPANY, THE OWNER AND THE ENGINEER. ANY SUCH MAINS AND/OR SERVICES DISTURBED BY THE CONTRACTOR'S OPERATIONS SHALL BE RESTORED IMMEDIATELY AT HIS EXPENSE TO THE SATISFACTION OF THE OWNER AND THE ENGINEER.

VERMILION REGIONAL AIRPORT  
 VERMILION REGIONAL AIRPORT AUTHORITY  
 DANVILLE, ILLINOIS

REHABILITATE T-HANGAR TAXIWAY PAVEMENTS  
 EXISTING CONDITIONS & REMOVALS

© Copyright CMT, Inc.  
  
**CMT**  
 CRAWFORD, MURPHY & TILLY, INC.  
 CONSULTING ENGINEERS  
 License No. 184-000613

DESIGN BY:	AJB
DRAWN BY:	CMT
CHECKED BY:	TJH
APPROVED BY:	CET
DATE:	JANUARY 3, 2014
JOB No:	13042-02
IL. PROJ. NO. DNV-4270	
SHEET 06 OF 11 SHEETS	