

# CONSTRUCTION PLANS FOR SPARTA COMMUNITY AIRPORT

## HUNTER FIELD SPARTA, IL

SUMMARY OF QUANTITIES			
ITEM	DESCRIPTION	ESTIMATED QUANTITY	UNIT
AR201661	CLEAN & SEAL BITUMINOUS CRACKS	200	LF
AR401661	BITUMINOUS CRACK SEALING	700	LF
AR605540	CLEAN & SEAL JOINTS	900	LF
AR608510	EXISTING ASPHALT SURFACE TREATMENT	19500	SY
AR620510	PAVEMENT MARKING	3600	SF
AR910200	ROADWAY SIGN	2	EACH
AR910410	PARKING BLOCK	9	EACH

**IL PROJ. SAR-4545 IDOT CONTRACT SP024  
SBG PROJ. NO: 3-17-SBGP-105**

**REHABILITATE GA APRON, TAXILANE PAVEMENTS  
& PARKING LOT/ENTRANCE ROAD:  
APPLY SEAL COAT, CRACK SEAL, & REMARK**

Sheet List Table		
Sheet Index	Sheet No.	Sheet Title
G1000	01	COVER SHEET
GC101	02	SITE PLAN
GC102	03	CONSTRUCTION ACTIVITY PLAN 1
GC103	04	CONSTRUCTION ACTIVITY PLAN 2
GC104	05	CONSTRUCTION ACTIVITY PLAN 3
GC501	06	PHASING NOTES
CD101	07	EXISTING CONDITIONS & REMOVALS 1
CP101	08	PROPOSED IMPROVEMENTS 1
CP102	09	PROPOSED IMPROVEMENTS 2
CM101	10	PROPOSED MARKING IMPROVEMENTS
CM501	11	MARKING AND SIGNAGE DETAILS

JANUARY 9, 2017

**811** Know what's below. Call before you dig. COMMON GROUND ALLIANCE  
www.call811.com or Phone: 811

THE LOCATION, SIZE AND TYPE OF MATERIAL OF EXISTING UNDERGROUND UTILITIES INDICATED ON THE PLANS IS NOT REPRESENTED AS BEING ACCURATE, SUFFICIENT OR COMPLETE. IT SHALL BE THE CONTRACTOR'S RESPONSIBILITY TO DETERMINE THE ACTUAL LOCATION OF ALL SUCH FACILITIES, INCLUDING SERVICE CONNECTIONS TO UNDERGROUND UTILITIES, PRIOR TO CONSTRUCTION. THE CONTRACTOR SHALL NOTIFY THE UTILITY COMPANIES OF HIS OPERATIONAL PLANS AND SHALL OBTAIN FROM THE RESPECTIVE UTILITY COMPANIES DETAILED INFORMATION AND ASSISTANCE RELATIVE TO THE LOCATION OF THEIR FACILITIES AND THE WORKING SCHEDULE OF THE COMPANIES FOR REMOVAL OR ADJUSTMENT WHERE REQUIRED. IN THE EVENT AN UNEXPECTED UTILITY INTERFERENCE IS ENCOUNTERED DURING CONSTRUCTION, THE CONTRACTOR SHALL IMMEDIATELY NOTIFY THE UTILITY COMPANY OF JURISDICTION. THE ENGINEER SHALL ALSO BE IMMEDIATELY NOTIFIED. ANY SUCH MAINS AND SERVICES SHALL BE RESTORED TO SERVICE AT ONCE AND PAID FOR BY THE CONTRACTOR AT NO ADDITIONAL COST TO THE CONTRACT.

CALL 911 IN THE EVENT IN WHICH DAMAGE RESULTS IN THE RELEASE OF NATURAL GAS.

**DESIGN INFORMATION**

**PAVEMENT DESIGN**

AIRCRAFT SINGLE WHEEL GEAR  
DEPARTURE WEIGHT = 12,500 LBS.

MAXIMUM EQUIPMENT HEIGHT = 25'  
GROUND FREQUENCY 123.075

SPARTA COMMUNITY AIRPORT

TOWNSHIP: 4 SOUTH  
RANGE: 5 WEST  
SECTION: 31  
COUNTY: RANDOLPH

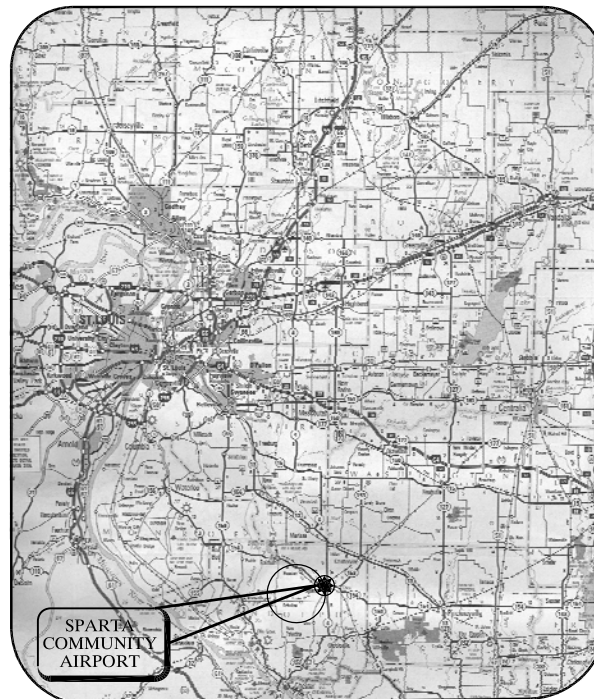

LOCATION MAP

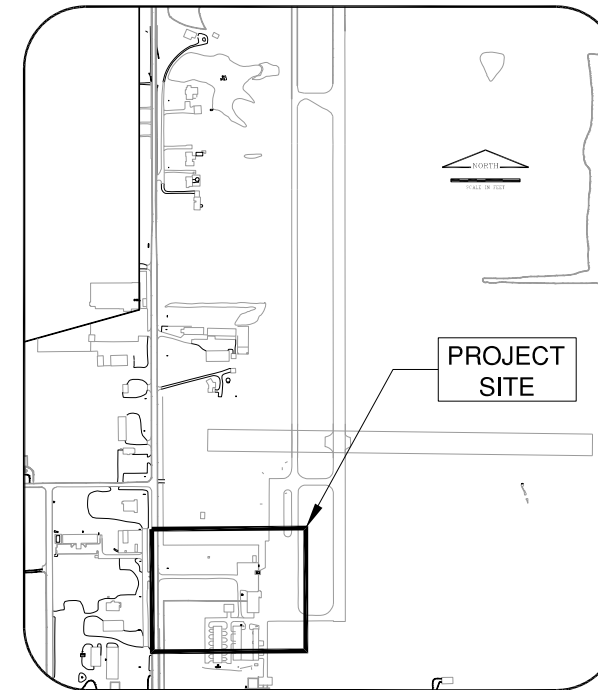

SITE PLAN

**SPARTA COMMUNITY AIRPORT**  
SPARTA COMMUNITY AUTHORITY  
HUNTER FIELD  
SPARTA, ILLINOIS

APPROVED *[Signature]*  
DATE 8-18-16

January 12, 2017  
**CHRISTOPHER B. GROTH**  
062-056232  
LICENSED PROFESSIONAL ENGINEER OF ILLINOIS  
*[Signature]*  
Exp. 11-30-2017

**CMT**

■ SPRINGFIELD, IL ■ AURORA, IL ■ ST. LOUIS, MO

SUBMITTED BY *[Signature]*  
DATE January 12, 2017

CMT JOB NUMBER: 16412-01-00





JANUARY 9, 2017 -  
100% SUBMITTAL

REHABILITATE GA APRON,  
TAXILANE PAVEMENTS &  
PARKING LOT/ENTRANCE ROAD

OWNER



HUNTER FIELD  
SPARTA COMMUNITY AIRPORT  
SPARTA, IL

MARK	DATE	DESCRIPTION

AIP PROJ. NO: 3-17-SBGP-105  
IL PROJ. SAR-4545 IDOT CONTRACT SP024  
CMT PROJECT NO: 16412-01-00  
CAD DWG FILE: 16412-01-GC103.DWG  
DESIGNED BY: CBG  
DRAWN BY: DPA  
CHECKED BY: AJB  
APPROVED BY: CBG  
COPYRIGHT: CRAWFORD, MURPHY & TILLY, INC. 2015

SHEET TITLE  
**CONSTRUCTION  
ACTIVITY PLAN 2**

GC103  
SHEET 04 OF 11

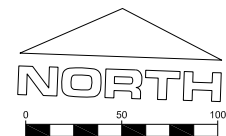

CONTROL POINT TABLE				
POINT	NORTHING	EASTING	ELEVATION	TOP OF OBSTRUCTION
1	2409.70	14892.46	526.0	551.0
2	2159.33	14892.27	525.0	550.0
3	2159.33	14721.98	527.0	552.0
4	2410.80	14615.28	528.0	553.0
5	2797.93	14764.34	529.0	554.0

**LEGEND**

- LOW PROFILE BARRICADES AND FLASHERS
- CONTRACTOR ACCESS
- WORK AREA

- NOTES**
- CONTRACTOR SHALL NOTIFY THE AIRPORT 72 HOURS PRIOR TO THE INITIATION OF ANY WORK WITHIN PHASE 2 WHICH REQUIRES CLOSURE OF ANY HANGARS.
  - ALL WORK AREAS SHALL BE SWEEPED AND CLEANED TO THE SATISFACTION OF THE AIRPORT PRIOR TO RE-OPENING PAVEMENT TO AIRCRAFT OPERATIONS AT THE END OF EACH WORK DAY.
  - EXACT REPAIR LOCATIONS WITHIN THE AREA SHALL BE DESIGNATED BY THE AIRPORT PRIOR TO THE START OF CONSTRUCTION.

Path: K:\Sparta\Aip\16412\01\Draws\Sheets\16412-01-GC103.dwg  
 Date: Monday, January 23, 2017 11:52:10 AM

JANUARY 9, 2017 -  
100% SUBMITTAL

REHABILITATE GA APRON,  
TAXILANE PAVEMENTS &  
PARKING LOT/ENTRANCE ROAD

OWNER



HUNTER FIELD  
SPARTA COMMUNITY AIRPORT  
SPARTA, IL

MARK	DATE	DESCRIPTION

AIP PROJ. NO: 3-17-SBGP-105  
IL PROJ. SAR-4545 IDOT CONTRACT SP024  
CMT PROJECT NO: 16412-01-00  
CAD DWG FILE: 16412-01-GC104.DWG  
DESIGNED BY: CBG  
DRAWN BY: DPA  
CHECKED BY: AJB  
APPROVED BY: CBG  
COPYRIGHT: CRAWFORD, MURPHY & TILLY, INC. 2015

SHEET TITLE  
**CONSTRUCTION  
ACTIVITY PLAN 3**

GC104  
SHEET 05 OF 11



**LEGEND**

- LOW PROFILE BARRICADES AND FLASHERS
- CONTRACTOR ACCESS
- WORK AREA

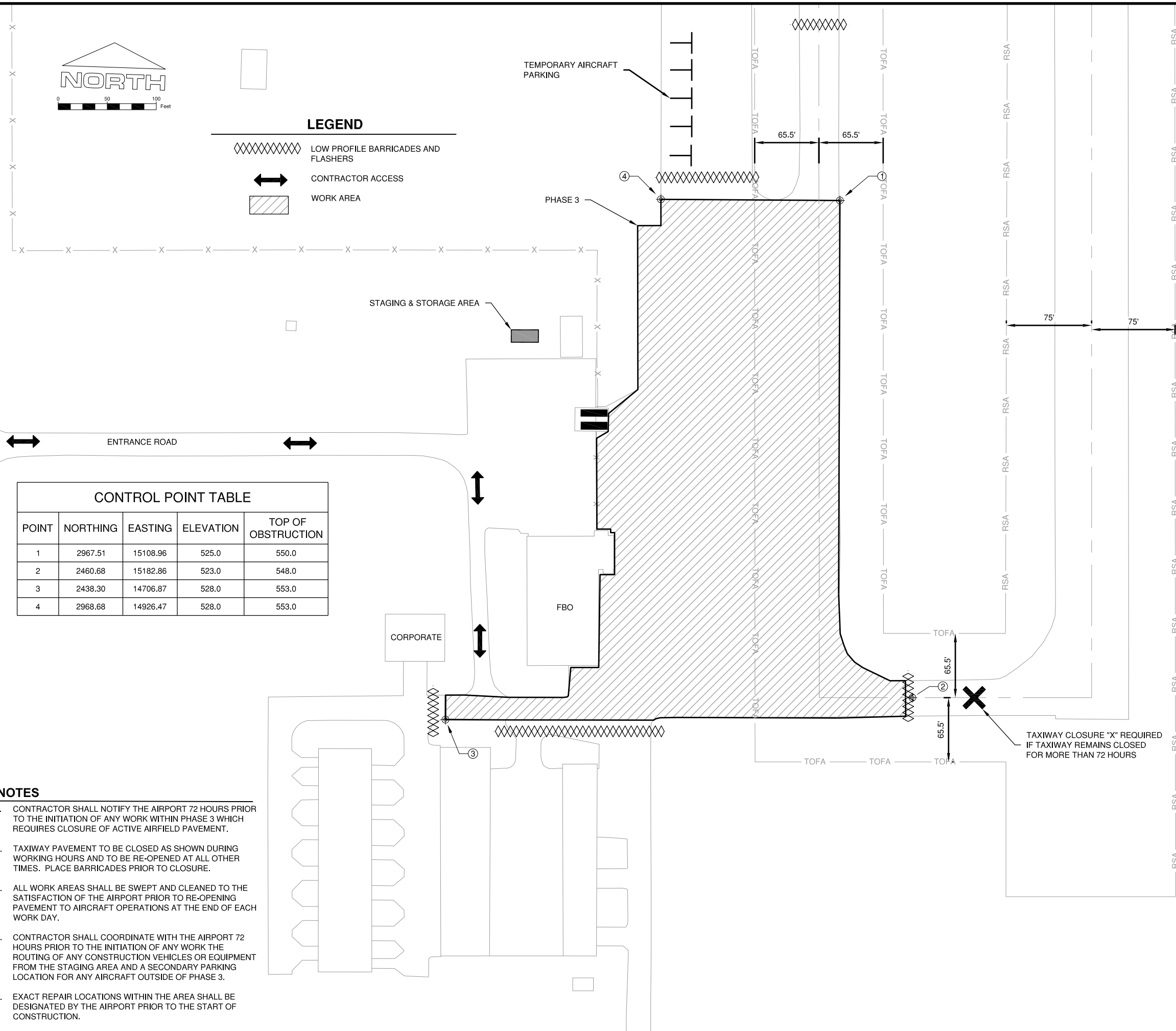

**CONTROL POINT TABLE**

POINT	NORTHING	EASTING	ELEVATION	TOP OF OBSTRUCTION
1	2967.51	15108.96	525.0	550.0
2	2460.68	15182.86	523.0	548.0
3	2438.30	14706.87	528.0	553.0
4	2968.68	14926.47	528.0	553.0

**NOTES**

1. CONTRACTOR SHALL NOTIFY THE AIRPORT 72 HOURS PRIOR TO THE INITIATION OF ANY WORK WITHIN PHASE 3 WHICH REQUIRES CLOSURE OF ACTIVE AIRFIELD PAVEMENT.
2. TAXIWAY PAVEMENT TO BE CLOSED AS SHOWN DURING WORKING HOURS AND TO BE RE-OPENED AT ALL OTHER TIMES. PLACE BARRICADES PRIOR TO CLOSURE.
3. ALL WORK AREAS SHALL BE SWEEPED AND CLEANED TO THE SATISFACTION OF THE AIRPORT PRIOR TO RE-OPENING PAVEMENT TO AIRCRAFT OPERATIONS AT THE END OF EACH WORK DAY.
4. CONTRACTOR SHALL COORDINATE WITH THE AIRPORT 72 HOURS PRIOR TO THE INITIATION OF ANY WORK THE ROUTING OF ANY CONSTRUCTION VEHICLES OR EQUIPMENT FROM THE STAGING AREA AND A SECONDARY PARKING LOCATION FOR ANY AIRCRAFT OUTSIDE OF PHASE 3.
5. EXACT REPAIR LOCATIONS WITHIN THE AREA SHALL BE DESIGNATED BY THE AIRPORT PRIOR TO THE START OF CONSTRUCTION.

**GENERAL**

- A. THE CONTRACTOR AND ALL SUBCONTRACTORS SHALL FOLLOW THE REQUIREMENTS OF THE AIRPORT'S APPROVED CONSTRUCTION SAFETY AND PHASING PLAN (CSPP), FAA AC 150/5370-2F, AND ALL AIRPORT SAFETY AND SECURITY REQUIREMENTS. THE CSPP SHALL CONSIST OF THE SITE PLAN, CSPP NOTES AND CONSTRUCTION ACTIVITY PLAN.
- B. PRIOR TO THE START OF CONSTRUCTION THE CONTRACTOR SHALL SUBMIT TO THE AIRPORT FOR APPROVAL A SAFETY PLAN COMPLIANCE DOCUMENT (SPCD) IN ACCORDANCE WITH FAA AC 150/5370-2F. NO CONSTRUCTION ACTIVITY SHALL BEGIN UNTIL THE AIRPORT HAS APPROVED THE SPCD.
- C. THE CSPP COVERS OPERATIONAL SAFETY. THE CONTRACTOR SHALL BE RESPONSIBLE FOR THE INDIVIDUAL SAFETY OF HIS/HER PERSONNEL AND MEETING OSHA REQUIREMENTS.
- D. A MINIMUM OF 10 DAYS PRIOR TO THE PRECONSTRUCTION MEETING THE CONTRACTOR SHALL PROVIDE A LIST OF SUBCONTRACTORS AND MATERIAL SUPPLIERS.
- E. THE CONTRACTOR SHALL EXERCISE BEST MANAGEMENT PRACTICES, IN ACCORDANCE WITH THE SPONSOR'S STORM WATER POLLUTION PREVENTION PLAN (SWPPP) THROUGHOUT THE LIFE OF THE PROJECT TO CONTROL WATER POLLUTION.
- F. ALL CONTRACTOR COSTS ASSOCIATED WITH THE REQUIREMENTS LISTED ON THIS SHEET SHALL BE CONSIDERED INCIDENTAL TO THE CONTRACT UNLESS A SPECIFIC PAY ITEM IS PROVIDED.
- G. THE EXISTING FEATURES SHOWN ON THESE PLANS ARE THOSE NOTED IN THE FIELD AND THOSE TAKEN FROM RECORD DRAWINGS. THIS DOES NOT GUARANTEE THAT ALL FEATURES ARE SHOWN ON THE PLANS. THERE WILL BE NO ADDITIONAL PAYMENT TO THE CONTRACTOR DUE TO VARIATIONS IN SIZE, QUANTITY, OR LOCATION OF EXISTING FEATURES.
- H. CRAWLER TYPE EQUIPMENT WILL NOT BE ALLOWED ON ANY PAVED SURFACE ON THE AIRPORT. ONLY RUBBER-TIRED VEHICLES, WHICH WILL NOT CAUSE DAMAGE TO THE PAVEMENTS, WILL BE ALLOWED WITHOUT PROVIDING SOME TYPE OF PROTECTION.
- I. THE CONTRACTOR SHALL HAVE PROPER IDENTIFICATION ON ALL EQUIPMENT AND VEHICLES ON THE AIRPORT.
- J. NO EDGE DROP GREATER THAN 3" WILL BE ALLOWED AT ANY ACTIVE RUNWAY OR TAXIWAY PAVEMENT EDGE OR SAFETY AREA. IF NECESSARY, THE CONTRACTOR WILL PLACE TEMPORARY MATERIAL TO ELIMINATE VERTICAL DROPS GREATER THAN 3" OR SLOPES GREATER THAN 5% IN THESE AREAS. THIS WORK SHALL BE SUBSIDIARY TO OTHER ITEMS IN THE PROJECT.

**1. COORDINATION**

- A. PRIOR TO THE START OF CONSTRUCTION THE CONTRACTOR SHALL ATTEND A PRECONSTRUCTION CONFERENCE WITH THE AIRPORT, ENGINEER, AND THE IDOT DIVISION OF AERONAUTICS. THE COST OF PREPARING FOR AND ATTENDING THE PRECONSTRUCTION CONFERENCE SHALL BE INCIDENTAL TO THE CONTRACT.
- B. ON OR BEFORE THE PRECONSTRUCTION CONFERENCE, THE CONTRACTOR SHALL SUBMIT A PROPOSED SCHEDULE FOR THE PROJECT. THE SCHEDULE SHALL INCLUDE A START AND COMPLETION DATE FOR EACH ITEM OF WORK. THE SCHEDULE SHALL BE UPDATED ON A WEEKLY BASIS. ALL COSTS ASSOCIATED WITH THE SCHEDULE SHALL BE INCIDENTAL TO THE CONTRACT.
- C. DURING CONSTRUCTION THE CONTRACTOR SHALL ATTEND A WEEKLY COORDINATION MEETING WITH THE AIRPORT. ALL COSTS ASSOCIATED WITH ATTENDING THE WEEKLY MEETING SHALL BE INCIDENTAL TO THE CONTRACT.

**2. PHASING**

- A. TOTAL CONTRACT TIME FOR THE PROJECT SHALL BE 14 CALENDAR DAYS.
- B. PHASING SHALL BE AS NOTED BELOW AND AS SHOWN ON THE CONSTRUCTION PHASING PLAN (CAP) SHEET.

**3. AREAS AND OPERATIONS AFFECTED BY THE CONSTRUCTION ACTIVITY**

- A. ALL RUNWAYS AND TAXIWAYS SHALL BE KEPT OPEN TO AIRCRAFT TRAFFIC DURING CONSTRUCTION EXCEPT AS NOTED ON THE CONSTRUCTION ACTIVITY PLAN.
- B. WHEN CONFLICTS ARISE BETWEEN CONSTRUCTION ACTIVITIES AND AIRCRAFT OPERATIONS AND SAFETY, AIRCRAFT OPERATIONS AND SAFETY SHALL TAKE PRECEDENCE AND SHALL GOVERN. FINAL AUTHORITY IN THE APPROVAL OF CONSTRUCTION SEQUENCING LIES WITH THE AIRPORT.
- C. ALL CONSTRUCTION TRAFFIC SHALL IMMEDIATELY YIELD TO ONCOMING AIRCRAFT AT ALL TIMES.

**4. PROTECTION OF NAVIGATION AIDS (NAVAIDS)**

- A. THE CONTRACTOR SHALL REMAIN CLEAR OF WIND CONE, BEACON AND OTHER NAVAIDS FACILITIES AT ALL TIMES.

**5. CONTRACTOR ACCESS**

- A. CONTRACTOR ACCESS SHALL BE AS NOTED BELOW AND AS SHOWN ON THE SITE PLAN AND CONSTRUCTION ACTIVITY PLAN SHEET.
- B. THE CONTRACTOR SHALL DESIGNATE AT LEAST ONE PERSON TO MONITOR THE AIRPORT UNICOM FREQUENCY OF 123.075. THE PERSON DESIGNATED SHALL HAVE THE ABILITY TO EASILY COMMUNICATE WITH OTHER CONTRACTOR PERSONNEL WORKING ON THE JOBSITE. THE CONTRACTOR SHALL PROVIDE HIS/HER OWN AIRPORT RADIO(S).
- C. THE STORAGE AND STAGING AREA WILL BE AS SHOWN ON THE SITE PLAN.
- D. THE CONTRACTOR SHALL KEEP A RECORD OF THE NAMES OF ALL EMPLOYEES ENTERING THE JOB SITE ON A DAILY BASIS. A RECORD OF EACH SUBCONTRACTOR ENTERING THE JOB SITE SHALL ALSO BE KEPT BY THE CONTRACTOR.
- E. WHEN THE CONTRACTOR IS NOT WORKING, EQUIPMENT SHALL BE STORED AT THE STAGING AREA OR WITHIN THE WORK AREA LIMITS (SEE NOTE 6).
- F. THE CONTRACTOR WILL BE PERMITTED TO STORE EQUIPMENT AND MATERIALS ONLY AT THE LOCATIONS SHOWN. PARKED EQUIPMENT AND MATERIAL STOCKPILES SHALL NOT PENETRATE SURFACES DEFINED BY F.A.R. TITLE 14 PART 77 - OBJECTS AFFECTING NAVIGABLE AIRSPACE.
- G. ALL CONSTRUCTION TRAFFIC OPERATING ON, OR CROSSING RUNWAYS, TAXIWAYS AND APRONS OPEN TO AIRCRAFT TRAFFIC SHALL BE UNDER CONTROL BY A FLAGMAN OR ESCORT WHO IS MONITORING THE AIRPORT UNICOM FREQUENCY. THE CONTRACTOR SHALL PROVIDE HIS/HER OWN FLAGMEN.
- H. THE CONTRACTOR SHALL THOROUGHLY CLEAN ALL CONSTRUCTION AREAS AND HAUL ROUTES WHICH WILL BE OPENED TO AIR TRAFFIC TO THE SATISFACTION OF THE ENGINEER.
- I. ALL PAVEMENTS, DRIVES OR ANY OTHER AREAS UTILIZED BY THE CONTRACTOR FOR HAUL ROADS OR STORAGE AREAS SHALL BE MAINTAINED AND REPAIRED TO THE SAME CONDITION OR BETTER THAN THEY WERE PRIOR TO BEGINNING CONSTRUCTION. NO ADDITIONAL COMPENSATION WILL BE MADE TO THE CONTRACTOR FOR THIS WORK.
- J. ALL VEHICLE AND EQUIPMENT OPERATORS USED BY THE CONTRACTOR SHALL BE PROPERLY TRAINED BY THE CONTRACTOR.
- K. THE CONTRACTOR SHALL NOTIFY THE LOCAL FIRE DEPARTMENT IF CONSTRUCTION ACTIVITY WILL REQUIRE THE BLOCKAGE OF EMERGENCY ACCESS TO THE AIRPORT.
- L. THE CONTRACTOR SHALL BE RESPONSIBLE FOR THE RESTORATION, SEEDING, AND MULCHING OF THE CONTRACTOR'S STORAGE AREAS AND HAUL ROADS.

**6. WILDLIFE MANAGEMENT**

- A. THE CONTRACTOR SHALL NOTIFY THE AIRPORT OR CITY IF ANY WILDLIFE IS SEEN ENTERING THE AIRPORT.
- B. THE CONTRACTOR SHALL DISPOSE OF ALL TRASH INCLUDING FOOD SCRAPS IN APPROVED CONTRACTOR PROVIDED CONTAINERS.

**7. FOREIGN OBJECT DEBRIS (FOD) MANAGEMENT**

- A. THE CONTRACTOR SHALL PICK UP ANY FOREIGN OBJECT DEBRIS (FOD) SEEN ON THE AIRFIELD PAVEMENTS.
- B. THE CONTRACTOR SHALL SECURE ALL LOOSE ITEMS FROM VEHICLES PRIOR TO DRIVING ON AIRFIELD PAVEMENTS.

**8. HAZARDOUS MATERIALS (HAZMAT) MANAGEMENT**

- A. THE CONTRACTOR SHALL DEVELOP A HAZMAT MANAGEMENT PLAN AND KEEP COPIES ON THE JOBSITE OF MATERIAL SAFETY DATA SHEETS (MSDS) FOR ALL MATERIALS HANDLED ON THE JOBSITE.

**9. NOTIFICATION OF CONSTRUCTION ACTIVITIES**

- A. THE CONTRACTOR SHALL PROVIDE A 24 HOUR EMERGENCY CONTACT PERSON AND PHONE NUMBER.
- B. THE CONTRACTOR SHALL GIVE A MINIMUM OF 72 HOURS NOTICE TO THE AIRPORT PRIOR TO CLOSING ANY PAVEMENTS SO THAT PROPER NOTAMS MAY BE ISSUED BY THE AIRPORT AND TO ALLOW FOR COORDINATION WITH THE AIRPORT TENANTS BY THE AIRPORT.
- C. FOR ANY EQUIPMENT USED BY THE CONTRACTOR WITH A HEIGHT GREATER THAN THE HEIGHTS SPECIFIED BELOW, THE CONTRACTOR SHALL SUBMIT FAA FORM 7460-1 TO THE FAA FOR AN AIRSPACE STUDY. NO EQUIPMENT WITH A HEIGHT GREATER THAN 25' SHALL BE USED INSIDE THE WORK AREA UNTIL A DETERMINATION FROM FAA IS RECEIVED.
- D. IN THE EVENT OF AN EMERGENCY, THE CONTRACTOR SHALL CALL 911.

**10. INSPECTION REQUIREMENTS**

- A. THE CONTRACTOR SHALL INSPECT THE JOBSITE DAILY TO ENSURE COMPLIANCE WITH THE CSPP. THE CHECKLIST FOUND IN APPENDIX 3 OF FAA AC 150/5370-2F MAY BE USED TO AID IN THE INSPECTIONS.

**11. UNDERGROUND UTILITIES**

- A. EXTREME CAUTION SHALL BE USED WHEN WORKING NEAR EXISTING LIGHT FIXTURES, UNDERGROUND ELECTRICAL CABLE OR DUCTS, AND ANY OTHER EXISTING AIRPORT FUTURE. SHOULD DAMAGE OCCURE TO ANY OF THESE ITEMS, THEY WILL BE REPLACED AT THE CONTRACTOR'S EXPENSE TO THE SATISFACTION OF THE ENGINEER.
- B. IT WILL BE NECESSARY FOR THE CONTRACTOR TO MAKE HIS OWN FIELD INVESTIGATION TO DETERMINE THE EXACT LOCATION OF THE UNDERGROUND UTILITIES AT CRITICAL POINTS. THE LOCATION OF UNDERGROUND UTILITIES AS INDICATED ON THE PLANS HAS BEEN OBTAINED FROM EXISTING RECORDS. NEITHER THE OWNER NOR THE ENGINEER ASSUMES ANY RESPONSIBILITY IN RESPECT TO THE ACCURACY, COMPLETENESS OR SUFFICIENCY OF THE INFORMATION.
- C. BEFORE INITIATING ANY DIGGING, DRILLING OR EXCAVATING ON THE AIRPORT PROPERTY, THE CONTRACTOR SHALL CALL 1-800-892-0123 TO ARRANGE FOR UTILITY LOCATES.

**12. PENALTIES**

- A. NONCOMPLIANCE BY THE CONTRACTOR WITH AIRPORT RULES AND REGULATIONS OR FAILURE TO COMPLY WITH THE AIRPORT'S APPROVED CSPP AND THE CONTRACTOR'S APPROVED SPCD MAY RESULT IN FINES AS ALLOWED BY LAW.

**13. SPECIAL CONDITIONS**

- A. TENANT ACCESS FROM THE HANGAR AREA TO RUNWAY 18-36 MAY IMPACT THE OPERATIONS OF THE CONTRACTOR. SEE THE COORDINATION NOTES FOR ADDITIONAL INFORMATION.

**14. RUNWAY AND TAXIWAY VISUAL AIDS**

- A. NO RUNWAYS OR TAXIWAYS WILL BE CLOSED DURING THIS PROJECT. THE TAXILANES AROUND HANGAR A WILL BE IMPACTED DURING THIS PROJECT. FOR THE CLOSURES, THE CONTRACTOR SHALL USE MARKING, LIGHTING AND SIGNS THAT FOLLOW THE REQUIREMENTS OF FAA AC 150/5370-2F. SEE CONSTRUCTION ACTIVITY NOTES ON CONSTRUCTION ACTIVITY PLAN.
- B. BARRICADES SHALL BE USED AS SHOWN ON THE CONSTRUCTION ACTIVITY PLAN SHEET.

**15. MARKING AND SIGNS FOR ACCESS ROUTES**

- A. LATH LINES SHALL BE USED ALONG THE CONTRACTOR'S ACCESS ROUTE IF NECESSARY. SEE CONSTRUCTION ACTIVITY PLAN SHEET.

**16. HAZARD MARKING AND LIGHTING**

- A. THE CONTRACTOR SHALL FURNISH, ERECT, AND MAINTAIN MARKINGS AND ASSOCIATED LIGHTING OF OPEN TRENCHES, EXCAVATIONS, TEMPORARY STOCKPILES, AND HIS/HER CONSTRUCTION EQUIPMENT.
- B. ALL CONSTRUCTION EQUIPMENT SHALL BE FLAGGED AND/OR LIGHTED IN ACCORDANCE WITH FAA ADVISORY CIRCULAR 150/5370-2F AND 150/5210-5D AT ALL TIMES WHILE OPERATING ON AIRPORT PROPERTY. THE MAXIMUM EQUIPMENT HEIGHT IS 25' INSIDE THE PROPOSED PROJECT AREA.
- C. BARRICADES SHALL BE PLACED AT THE LOCATIONS SHOWN ON THE CONSTRUCTION ACTIVITY PLAN SHEET OR AS DIRECTED BY THE ENGINEER.
- D. THE CONTRACTOR SHALL INSPECT THE BARRICADES ONCE DURING EACH WORK DAY TO INSURE PROPER PLACEMENT AND PROPER OPERATION OF THE RED LIGHTS.

**17. PROTECTION**

- A. NO WORK SHALL BE PERFORMED/REQUIRED INSIDE OF THE RUNWAY SAFETY AREAS WHICH EXTENDS 150' FROM THE RUNWAY CENTERLINE FOR RUNWAYS 18-36.
- B. NO WORK SHALL BE PERFORMED/REQUIRED INSIDE OF AN ACTIVE TAXIWAY OBSTRUCTION FREE AREA WHICH EXTENDS 65.5' FROM THE TAXIWAY CENTERLINE.
- C. ANY WORK INSIDE AN ACTIVE TAXILANE OBJECT FREE AREA SHALL BE PERFORMED SO THAT A 5' CLEARANCE IS MAINTAINED BETWEEN EQUIPMENT AND MATERIALS AND ANY PART OF AN AIRCRAFT INCLUDING WINGTIP OVERHANG. IF THE 5' CLEARANCE CANNOT BE MAINTAINED, THE CONTRACTOR SHALL MOVE ALL EQUIPMENT AND PERSONNEL FROM THE TAXILANE OBJECT FREE AREA FOR EACH PASSING AIRCRAFT. THE FULL OBJECT FREE AREA EXTENDS 40' FROM THE TAXILANE CENTERLINE.

**18. OTHER LIMITATIONS ON CONSTRUCTION**

- A. IF, DURING CONSTRUCTION, AN EMERGENCY IS DECLARED BY THE CITY, THE CONTRACTOR SHALL IMMEDIATELY CLEAR THE PAVEMENT OF ALL VEHICLES, PERSONNEL AND EQUIPMENT.
- B. BROKEN CONCRETE, BROKEN ASPHALT, AND OTHER MISCELLANEOUS DEBRIS SHALL BE DISPOSED OF OFF AIRPORT PROPERTY, UNLESS OTHERWISE SPECIFIED.

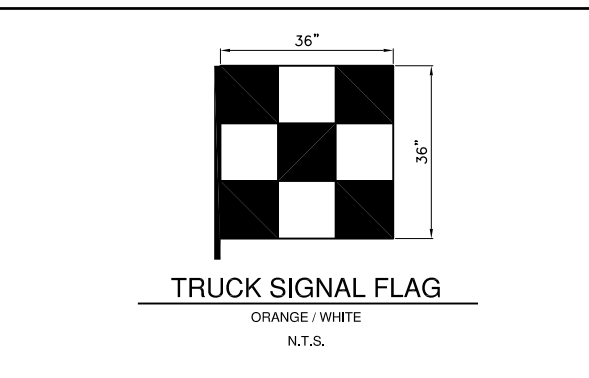
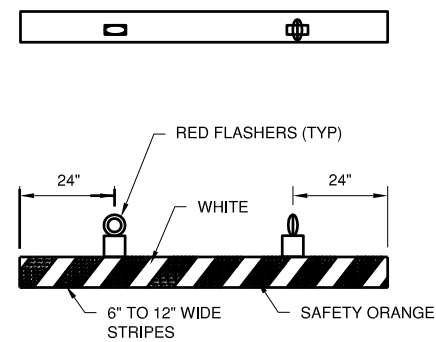

**1 LOW-PROFILE BARRICADE AND FLASHER**  
N.T.S.

**LOW PROFILE BARRICADE AND FLASHER NOTES:**

- 1. LOW PROFILE BARRICADES MUST BE PLACED AND SPACED AS SPECIFIED HEREIN. EDGE DROP-OFFS GREATER THAN 3 INCHES ARE NOT ALLOWED AT THE EDGE OF OPEN AOA PAVEMENT. BARRICADES SHALL NOT BE PLACED INSIDE ACTIVE RUNWAY, TAXIWAY OR TAXILANE SAFETY AREAS. BARRICADES MUST BE WEIGHTED TO PREVENT THEM FROM BEING DISPLACED OR BLOWN OVER.
- 2. FLASHERS MUST BE BATTERY OPERATED. LENS MUST BE RED AND BE ABLE TO ROTATE 90°.
- 3. FACING OF BARRICADE MUST BE COVERED WITH REFLECTIVE TAPE OR PAINT.
- 4. BARRICADES MUST HAVE ALTERNATE FLASHER LENSES SO THAT EVERY OTHER LENS IS ROTATED 90°.

- 5. BARRICADES MUST BE OF LOW MASS, EASILY COLLAPSIBLE UPON CONTACT WITH AN AIRCRAFT OR ANY OF ITS COMPONENTS, AND WEIGHTED OR STURDILY ATTACHED TO THE SURFACE. IF AFFIXED TO THE SURFACE, THE BARRICADE MUST BE FRANGIBLE AT GRADE LEVEL OR AS LOW AS POSSIBLE, BUT NOT TO EXCEED 3 INCHES ABOVE THE GROUND.
- 6. LOW PROFILE BARRICADES MUST BE UTILIZED FOR ANY BARRICADE LOCATED WITHIN OR ON THE EDGE OF AN ACTIVE RUNWAY OR TAXIWAY SAFETY AREA. LOW PROFILE BARRICADES SHALL NOT EXCEED 18" IN HEIGHT.
- 7. ALL BARRICADES AND FLASHERS ON BOTH LOW PROFILE AND PORTABLE BARRICADES SHALL BE INSPECTED EACH NIGHT TO ASSURE ALL FLASHERS ARE OPERATIONAL.
- 8. PORTABLE BARRICADES MAY BE USED TO DELINEATE VEHICLE HAULING ROUTES.



License No. 184-000613  
CONSULTANTS

JANUARY 9, 2017 -  
100% SUBMITTAL

REHABILITATE GA APRON,  
TAXILANE PAVEMENTS &  
PARKING LOT/ENTRANCE ROAD

OWNER



HUNTER FIELD  
SPARTA COMMUNITY AIRPORT  
SPARTA, IL

MARK	DATE	DESCRIPTION

AIP PROJ. NO: 3-17-SBGP-105  
IL PROJ. SAR-4545 IDOT CONTRACT SP024  
CMT PROJECT NO: 16412-01-00  
CAD DWG FILE: 16412-01-GC501.DWG  
DESIGNED BY: CBG  
DRAWN BY: DPA  
CHECKED BY: AJB  
APPROVED BY: CBG  
COPYRIGHT: CRAWFORD, MURPHY & TILLY, INC. 2015

SHEET TITLE  
**PHASING NOTES**



MARK	DATE	DESCRIPTION
		AIP PROJ. NO: 3-17-SBGP-105
		IL PROJ. SAR-4545 IDOT CONTRACT SP024
		CMT PROJECT NO: 16412-01-00
		CAD DWG FILE: 16412-01-CD101.DWG
		DESIGNED BY: CBG
		DRAWN BY: DPA
		CHECKED BY: RLV
		APPROVED BY: CBG
		COPYRIGHT: CRAWFORD, MURPHY & TILLY, INC. 2015

SHEET TITLE

**EXISTING  
CONDITIONS &  
REMOVALS 1**

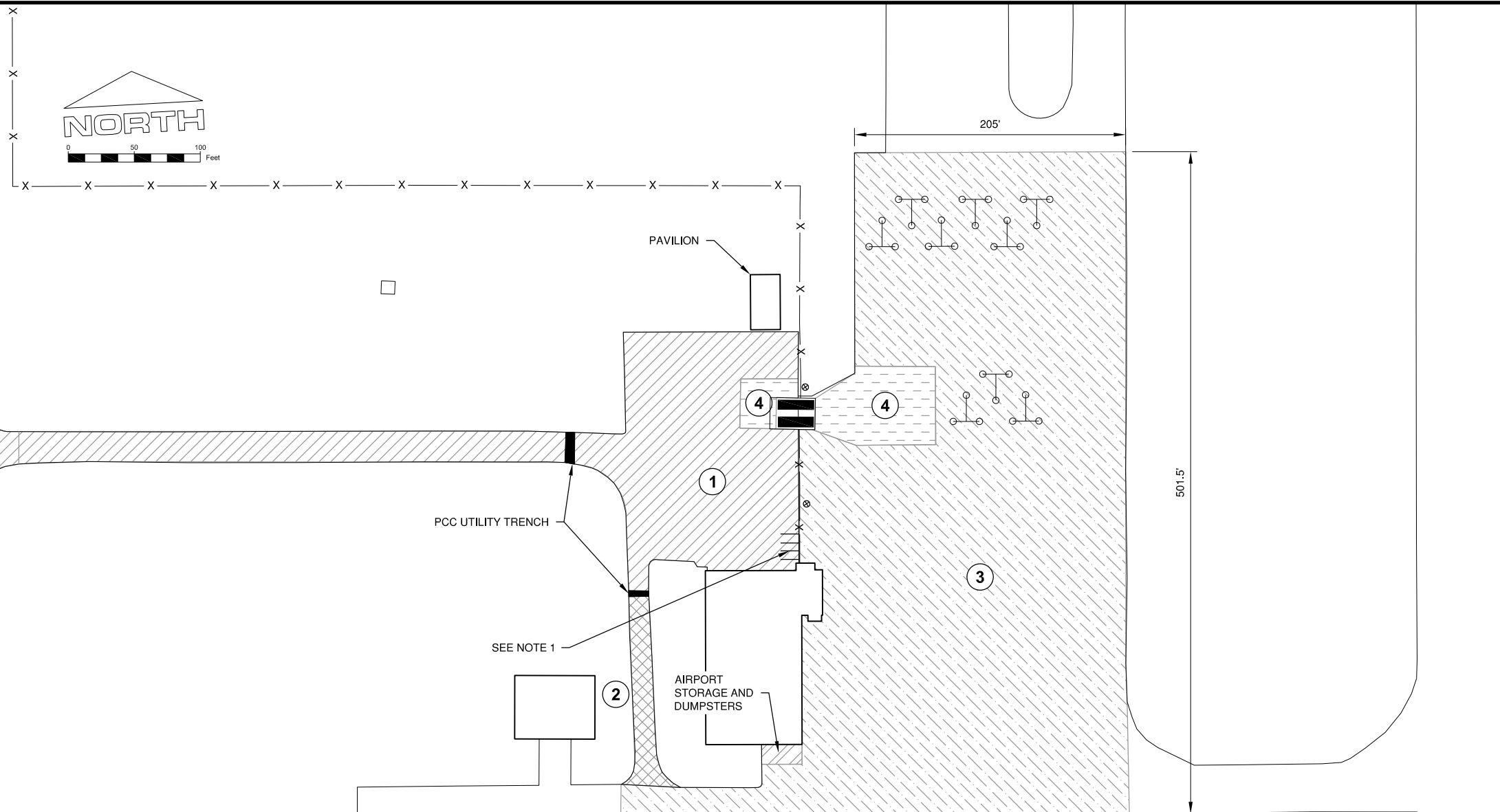

**NOTES**

- MARKING OF THE NEW ADA PARKING STALL MAY REQUIRE THE REMOVAL OF EXISTING MARKING. REMOVAL SHALL BE DONE PRIOR TO APPLYING SURFACE TREATMENT.

**PAVEMENT STRUCTURE**

- ① 8" DENSE GRADED CRUSHED AGG (1961)  
.75" BIT SURFACE TREATMENT (1961)  
4" BIT SURFACE COURSE (401) (1977)
- ② 6" DENSE GRADED CRUSHED AGG  
3" BIT SURFACE COURSE
- ③ 8" DENSE GRADED CRUSHED AGG (1961)  
.75" BIT SURFACE TREATMENT (1961)  
3" BIT SURFACE COURSE (401) (1970)  
1.5" BIT LEVELING COURSE (401) (1993)  
1.5" BIT SURFACE COURSE (401) (1993)
- ④ PCC - DEPTH UNKNOWN

**LEGEND**

- ⊗ EXISTING LIGHT POLE
- X — EXISTING FENCE
- ⊕ EXISTING TIE DOWN

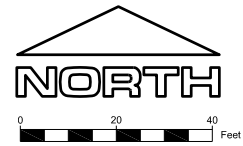

TAXIWAY A

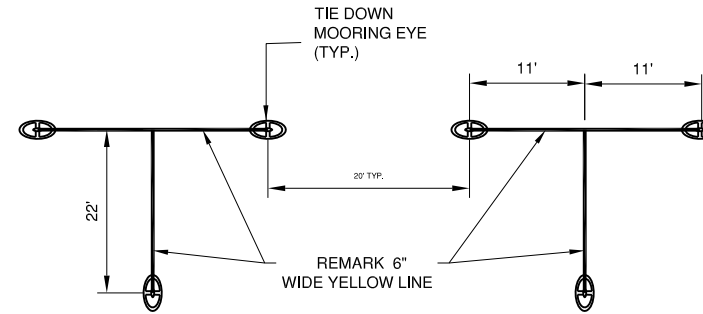
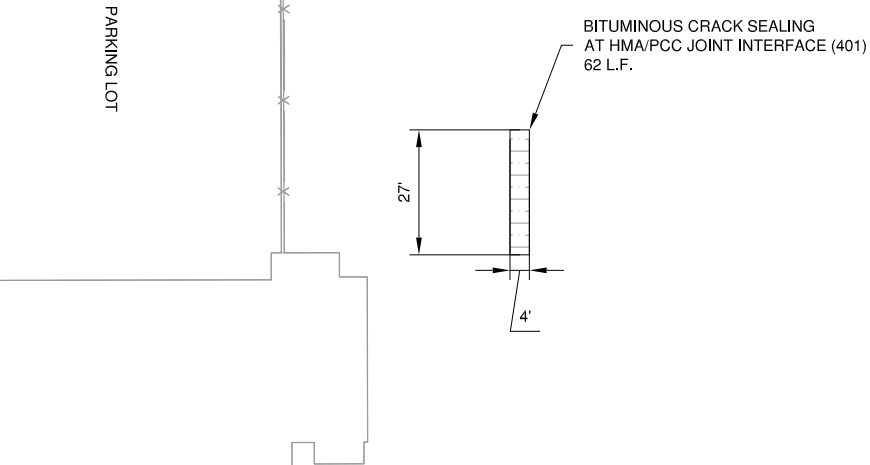
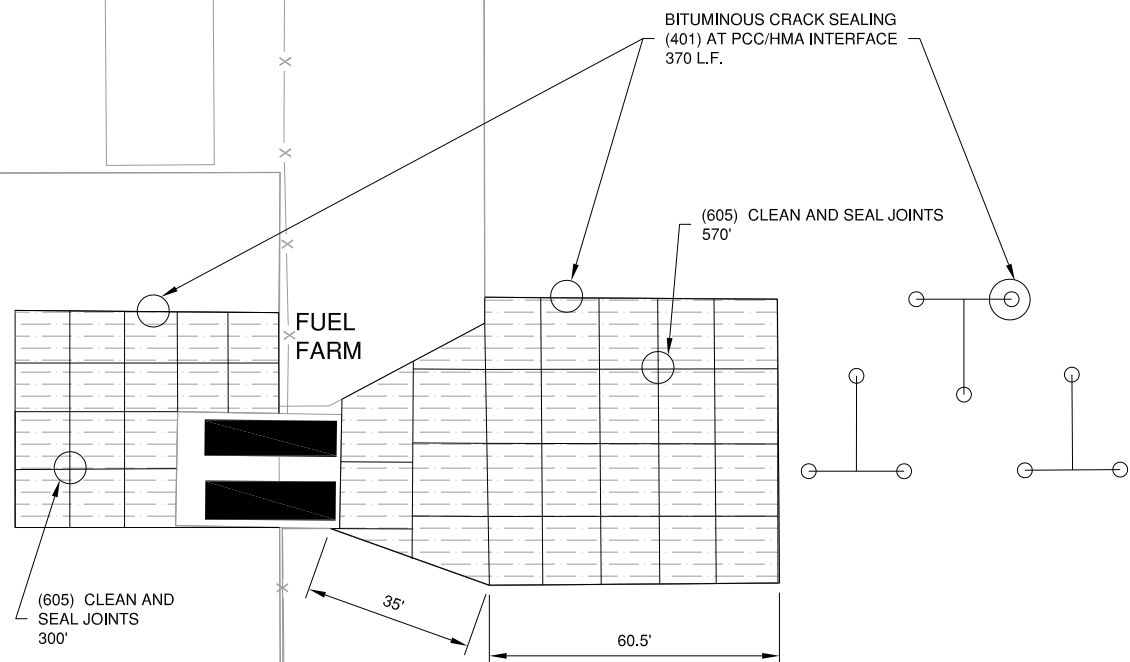
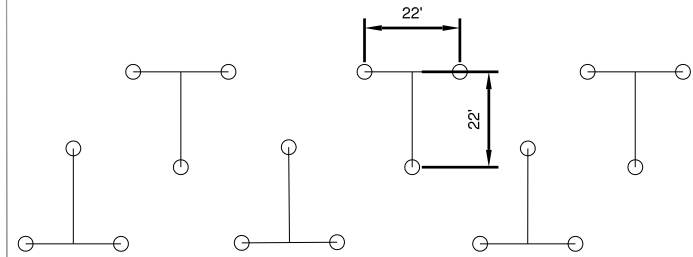

**TIE DOWN DETAIL**  
N.T.S.

**NOTES**

- EXISTING TIE DOWN MOORINGS ARE NOT BEING REMOVED, THE CONTRACTOR WILL ONLY PAINT THE DISTANCES BETWEEN THE MOORINGS.

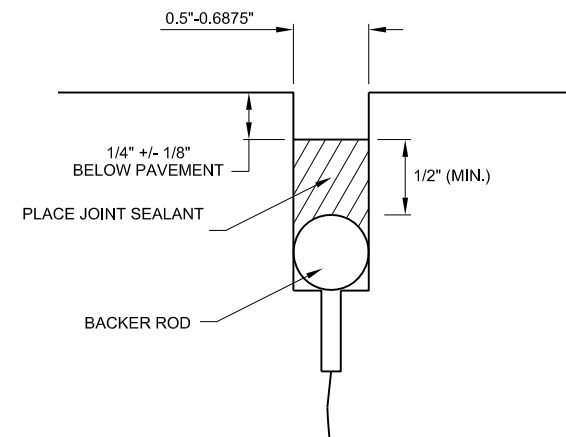

**CLEAN AND SEAL JOINT (605)**  
N.T.S.

**NOTES**

- THE CONTRACTOR SHALL CHECK THE EXISTING WIDTH OF JOINT SEAL RESERVOIRS IN ALL AREAS WHERE JOINT SEALS ARE TO BE REMOVED AND REPLACED.
- CLEAN ALL RESERVOIRS WITH WIRE BRUSH AND AIR BLAST PRIOR TO NEW SEALANT INSTALLATION.
- INSTALL SEALANT SUCH THAT HEIGHT:WIDTH RATIO IS 1:1.
- REPLACE JOINT SEALANT AT LOCATIONS AS DESIGNATED BY ENGINEER.

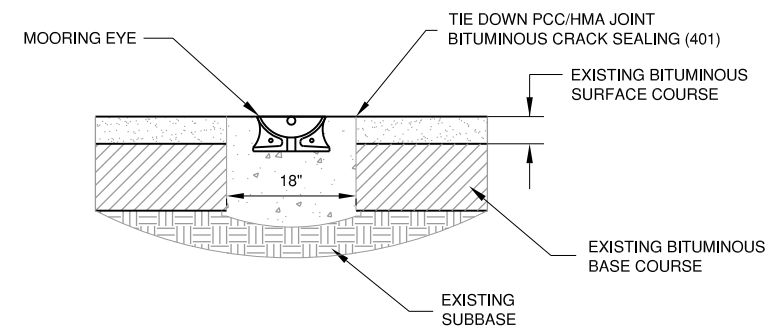

**TIE DOWN JOINTS**

**TIE DOWN JOINT NOTES:**

- THIS TASK SHALL BE PAID FOR AS PART OF ITEM AR401661.
- APPLY BITUMINOUS CRACK SEALING AT ALL TIE DOWNS WITHIN THE PROJECT LIMITS.



License No. 184-000613  
CONSULTANTS

JANUARY 9, 2017 -  
100% SUBMITTAL

REHABILITATE GA APRON,  
TAXILANE PAVEMENTS &  
PARKING LOT/ENTRANCE ROAD

OWNER



HUNTER FIELD  
SPARTA COMMUNITY AIRPORT  
SPARTA, IL

MARK	DATE	DESCRIPTION

AIP PROJ. NO:	3-17-SBGP-105
IL PROJ. SAR-4545	IDOT CONTRACT SP024
CMT PROJECT NO:	16412-01-00
CAD DWG FILE:	16412-01-CP101.DWG
DESIGNED BY:	CBG
DRAWN BY:	DPA
CHECKED BY:	AJB
APPROVED BY:	CBG
COPYRIGHT:	CRAWFORD, MURPHY & TILLY, INC. 2015

SHEET TITLE  
**PROPOSED  
IMPROVEMENTS 1**

SHEET **08** OF **11**  
CP101





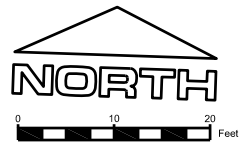

PAVILION

FUEL FARM

NEW PARKING BLOCKS (AR910410)

NEW ROADWAY SIGNS (2)

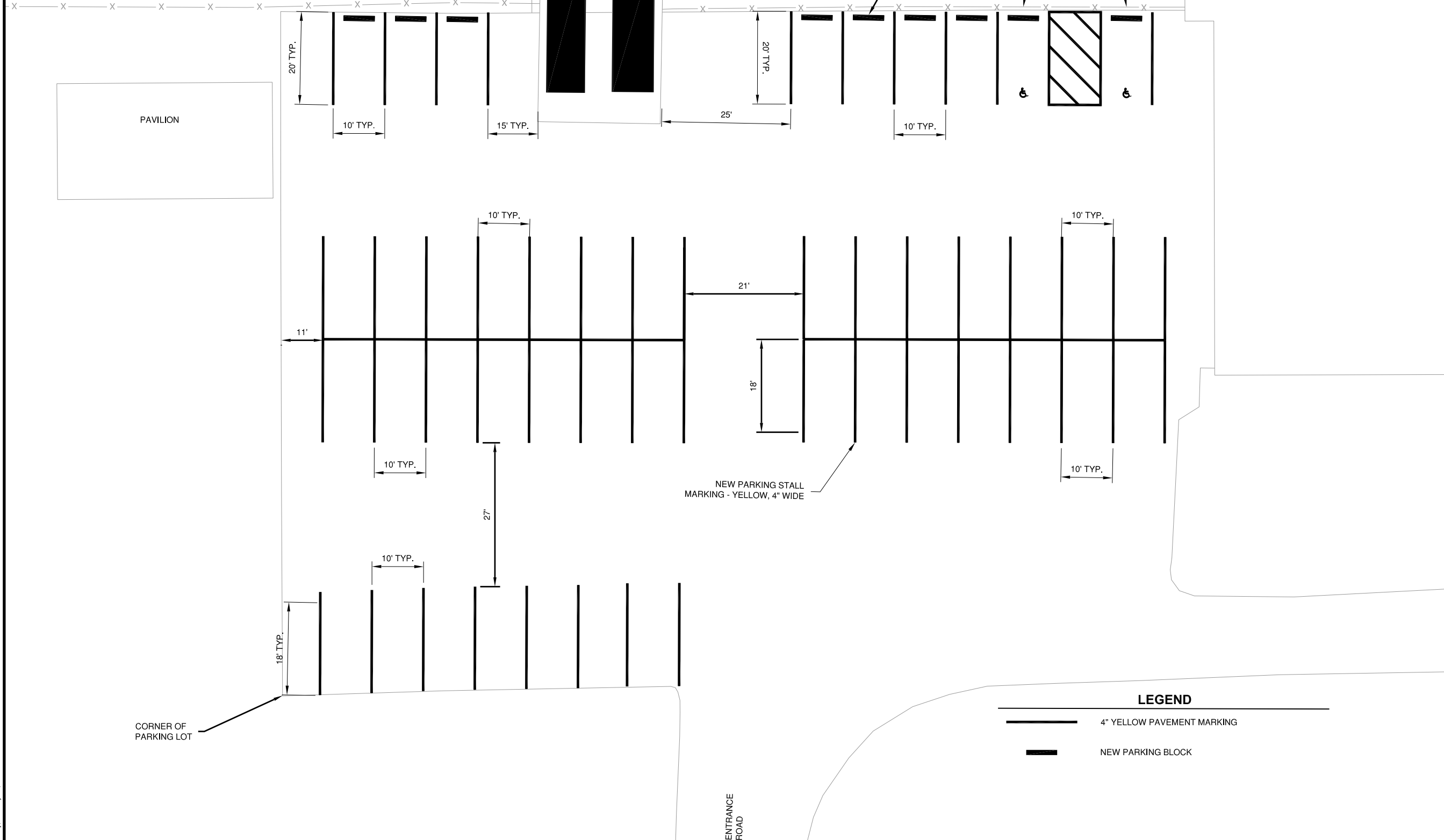

NEW PARKING STALL MARKING - YELLOW, 4" WIDE

**LEGEND**

- 4" YELLOW PAVEMENT MARKING
- NEW PARKING BLOCK



License No. 184-000613  
CONSULTANTS

JANUARY 9, 2017 -  
100% SUBMITTAL

REHABILITATE GA APRON,  
TAXILANE PAVEMENTS &  
PARKING LOT/ENTRANCE ROAD



HUNTER FIELD  
SPARTA COMMUNITY AIRPORT  
SPARTA, IL

MARK	DATE	DESCRIPTION

AIP PROJ. NO: 3-17-SBGP-105  
IL PROJ. SAR-4545 IDOT CONTRACT SP024  
CMT PROJECT NO: 16412-01-00  
CAD DWG FILE: 16412-01-CM101.DWG  
DESIGNED BY: CBG  
DRAWN BY: DPA  
CHECKED BY: AJB  
APPROVED BY: CBG  
COPYRIGHT: CRAWFORD, MURPHY & TILLY, INC. 2015

SHEET TITLE  
**PROPOSED MARKING  
IMPROVEMENTS**

CM101  
SHEET 10 OF 11

Path: K:\Sparta\Aip\16412\01\Draws\Sheets\16412-01-CM101.dwg  
Date: Monday, January 23, 2017 11:58:36 AM

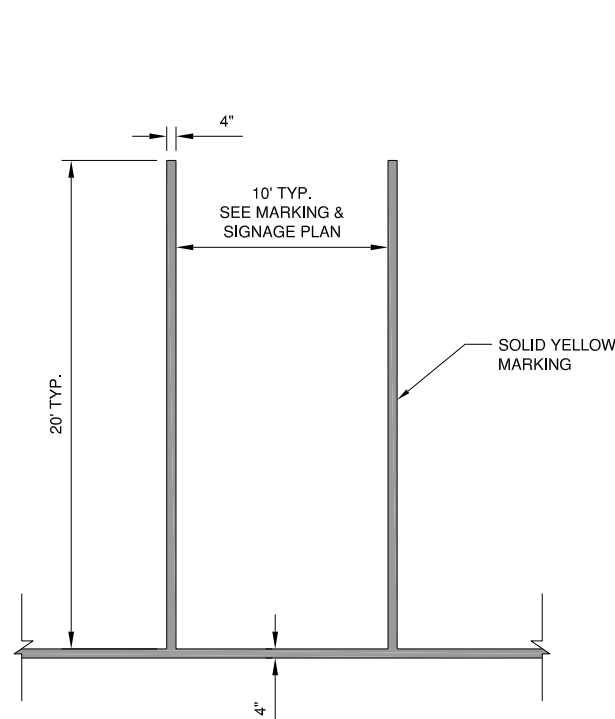

**PARKING STALL**  
NTS

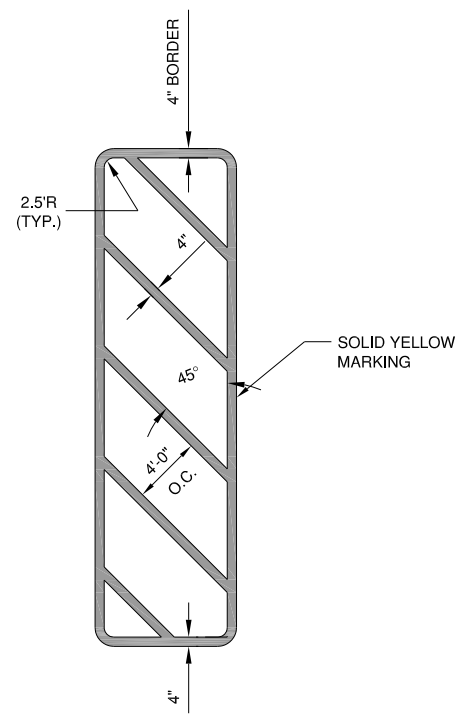

**TYPICAL CROSS HATCH MARKING**  
NTS

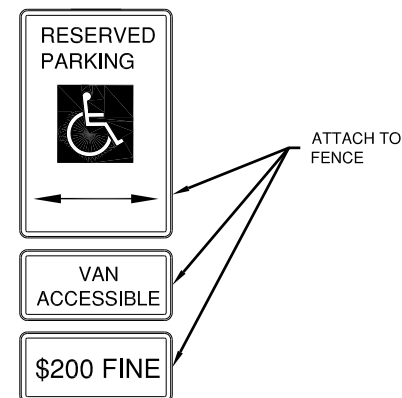

R7-8  
12" x 18"  
R7-8P  
12" x 6"  
R7-1 101  
12" x 6"

**ACCESSIBLE SIGN DETAIL**

NTS

**NOTES**

1. ALL COMPONENTS SHALL BE CONSIDERED 1 SIGN.
2. SIGN SHALL BE MOUNTED TO EXISTING FENCE.

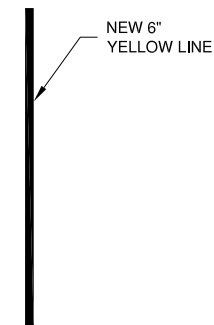

**TAXILANE MARKING CONTINUOUS**

N.T.S.

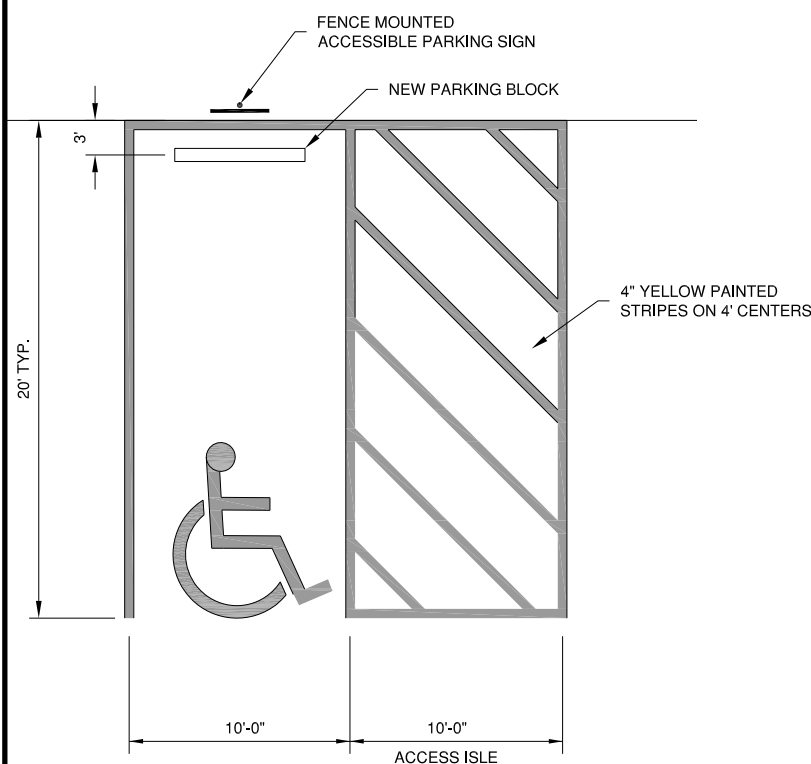

**CAR ACCESSIBLE**  
NTS

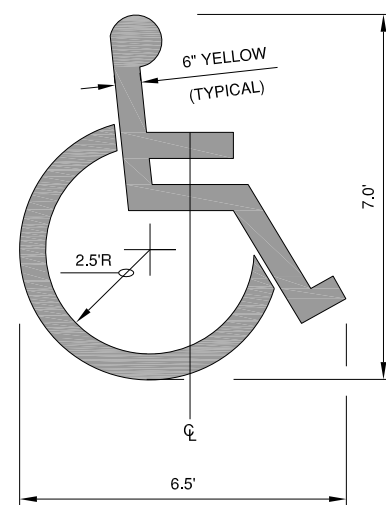

**ACCESSIBLE PARKING SYMBOL**  
LOCATE AT EDGE OF PARKING SPACE

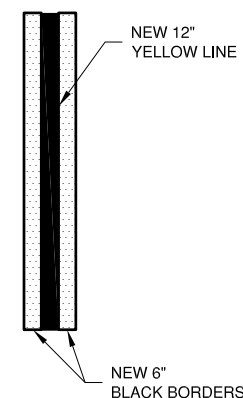

**TAXIWAY CENTERLINE CONTINUOUS**

N.T.S.

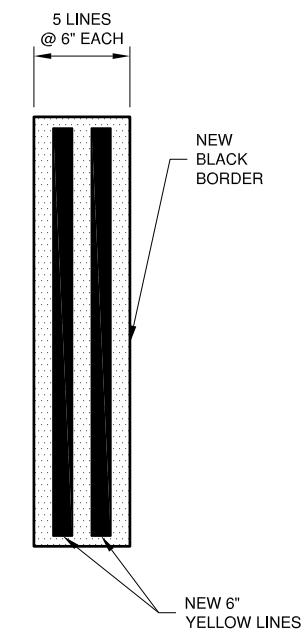

**TAXIWAY EDGE MARKING CONTINUOUS**

N.T.S.

JANUARY 9, 2017 -  
100% SUBMITTAL

REHABILITATE GA APRON,  
TAXILANE PAVEMENTS &  
PARKING LOT/ENTRANCE ROAD

OWNER



HUNTER FIELD  
SPARTA COMMUNITY AIRPORT  
SPARTA, IL

MARK	DATE	DESCRIPTION

AIP PROJ. NO: 3-17-SBGP-105  
IL PROJ. SAR-4545 IDOT CONTRACT SP024  
CMT PROJECT NO: 16412-01-00  
CAD DWG FILE: 16412-01-CM501.DWG  
DESIGNED BY: CBG  
DRAWN BY: DPA  
CHECKED BY: AJB  
APPROVED BY: CBG  
COPYRIGHT: CRAWFORD, MURPHY & TILLY, INC. 2015

**MARKING AND SIGNAGE DETAILS**